

Cover Interposer Tray
CI5020/CI5030
Machine Code: D518/D738

Field Service Manual

V1.1

May 2015



Revision History







This is the Revision History for the Cover Interposer Tray CI5030 service manual.

Version	Date	Changes
Ver. 1.1	31 Mar 2015	<p>Text, Illustrations. In procedures the order of the text and illustrations has been reversed. For each step, the text description (action) is followed by the relevant illustration. The callouts [A], [B], [C] in text refer to the illustration below, not above.</p> <p>Format revised. Edited step numbering format.</p>

Symbols, Abbreviations and Trademarks

Conventions

Symbol	What it means
	Binding screw (shoulder hexagonal head)
	Binding screw (round flathead)
	Black screw (heavy, fusing unit, TCRU)
	Bushing
	C-ring
	Clip
	Connector
	E-ring
	FFC (Flat Film Connector)
	FFC (Flat Film Connector)
	FFC (Flat Film Connector)
	Gear
	Harness clamp
	Harness clamp: metal: fusing unit
	Hook (or tab release: sensors)
	Knob screw (black)
	Knob screw (sliver)
	Pivot screw
	Screw: most common: silver
	Shoulder screw

Symbol	What it means
	Shoulder screw (black)
	Spring
	Standoff
	Stud screw
	Tapping screw (for plastic)
	Timing belt
	Washer

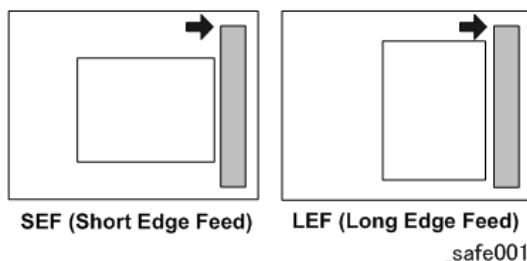

The notations "SEF" and "LEF" describe the direction of paper feed. The arrows indicate the direction of paper feed.

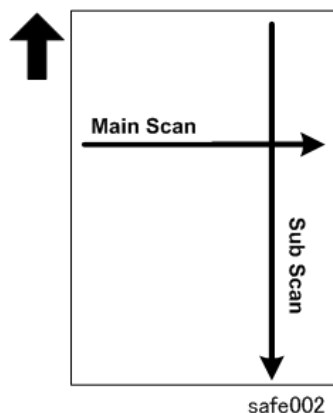

In this manual "Main Scan" means "Horizontal" and "Sub Scan" means "Vertical", both relative to the direction of paper feed.

Warnings, Cautions, Notes

In this manual, the following important symbols and notations are used.

WARNING

- A Warning indicates a potentially hazardous situation. Failure to obey a Warning could result in death or serious injury.

CAUTION

- A Caution indicates a potentially hazardous situation. Failure to obey a Caution could result in minor or moderate injury or damage to the machine or other property.

Important

- Obey these guidelines to avoid problems such as misfeeds, damage to originals, loss of valuable data and to prevent damage to the machine.

Note

- This information provides tips and advice about how to best service the machine.

Commonly Used Terms and Abbreviations

Here is a list of commonly used terms and abbreviations that are used throughout the Field Service Manual and Appendices.

Terms	Meaning
(ccw)	Counter-clockwise rotation of a drum, roller, gear, etc.
(cw)	Clockwise rotation of a drum, roller, gear, etc.
BF	Booklet Finisher SR5060 (D734)* ¹
BW	Black and white (monochrome) copying or printing
Bank	Paper Bank (1st, 2nd, 3rd Tray of the main machine)
CIT	Cover Interposer Tray CI5030 (D738)* ¹
CIT-PB	Cover Interposer Tray for Perfect Binder Type S1 (D736-2)* ¹
FIN	Finisher SR5050 (D735) (corner staple only, no booklets)* ¹
ITB	Image Transfer Belt
JG	Junction Gate

Terms	Meaning
LCIT	Large Capacity Input Tray. LCIT RT5080 (D732) or LCIT RT5070 (D733)* ¹
LD	Laser Diode (Laser Unit)
LE	Leading Edge
LSDB	Laser Synchronization Detection Board (Laser Unit)
MFU	Multi Folding Unit FD5020 (D740)* ¹
PCDU	Photoconductor Development Unit
PB	Perfect Binder GB5010 (D736)* ¹
PFU	Paper Feed Unit (Tray 1, Tray 2, Tray 3)
PTB	Paper Transport Belt (between PTR and fusing unit)
PTR	Paper Transfer Roller
RB	Ring Binder RB5020 (D737)
TCRU	Trained Customer Replacement Units
TE	Trailing Edge
TM/P	ID sensor. "ID sensor" is used in this manual. However, you may see "TM/P" in the SP codes on the operation panel.
TPU	Transit Path Unit for Perfect Binder Type S1 (D736)* ¹
TRM	Trimmer Unit 5040 (D520)* ¹
VTU	Vertical Transport Unit
* ¹ Optional peripheral devices.	

Trademarks

- Microsoft[®], and Windows[®] are registered trademarks of Microsoft Corporation in the United States and /or other countries.
- PostScript[®] is a registered trademark of Adobe Systems, Incorporated.
- PCL[®] is a registered trademark of Hewlett-Packard Company.

-
- Ethernet® is a registered trademark of Xerox Corporation.
 - PowerPC® is a registered trademark of International Business Machines Corporation.
 - Other product names used herein are for identification purposes only and may be trademarks of their respective companies. We disclaim any and all rights involved with those marks.

TABLE OF CONTENTS

Revision History.....	1
Symbols, Abbreviations and Trademarks	2
Conventions.....	2
Warnings, Cautions, Notes.....	4
Commonly Used Terms and Abbreviations.....	4
Trademarks.....	5
1. Replacement and Adjustment	
Common Procedures.....	9
Covers.....	9
1st, 2nd Trays.....	11
Feed Units.....	12
Boards.....	14
Tray Unit Control Board.....	14
Main Control Board.....	14
Motors.....	16
Vertical Transport Motor.....	16
Horizontal Transport Motor.....	16
1st, 2nd Lift Motors.....	17
1st, 2nd Feed Motors.....	17
1st, 2nd Transport Motors.....	18
1st, 2nd Pick-Up Motors.....	19
Sensors.....	22
Paper Width Switch, Set Sensors, Length Sensor.....	22
1st Transport Sensor.....	24
Feed Unit Sensors.....	24
2nd Vertical Transport, Exit Sensors.....	25
Entrance Sensor.....	26
Rollers.....	27
Separation Roller.....	27
Feed Belt Unit And Pick-Up Roller.....	27
Feed Belt.....	28

1. Replacement and Adjustment

Common Procedures

1

Covers

1. Open the vertical feed cover.

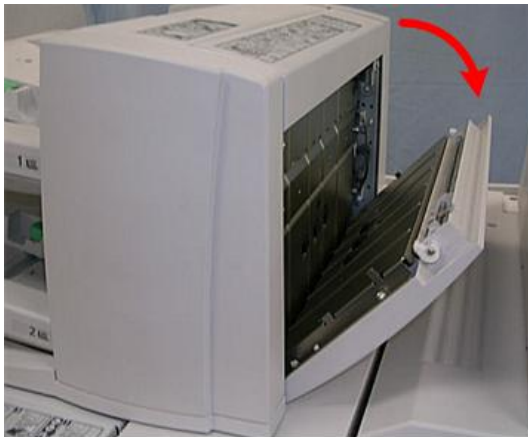

d7380001

2. Remove:

- [A] Top cover (⚙️ x2)
- [B] Inner cover with front door [C] (⚙️ x2)
- [D] 1st tray cover holder (⚙️ x1)
- [E] 1st tray cover. Slide the cover toward you to remove it from the inside pins.
- [F] Base cover (Knob ⚙️ x1)
- [G] Tray unit rear cover (⚙️ x2)

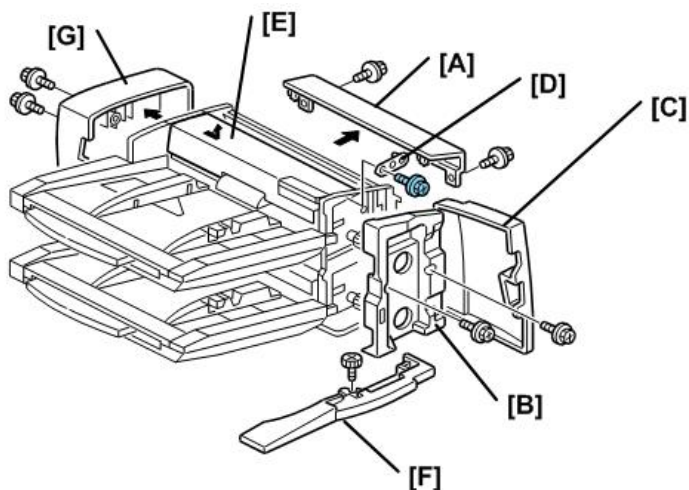

d7380002

3. Remove front door [A] (L-pins x2)

- Swing the upper L-pin [B] out of its groove and pull it up.
- Swing the lower L-pin [C] out of its groove and pull it down.

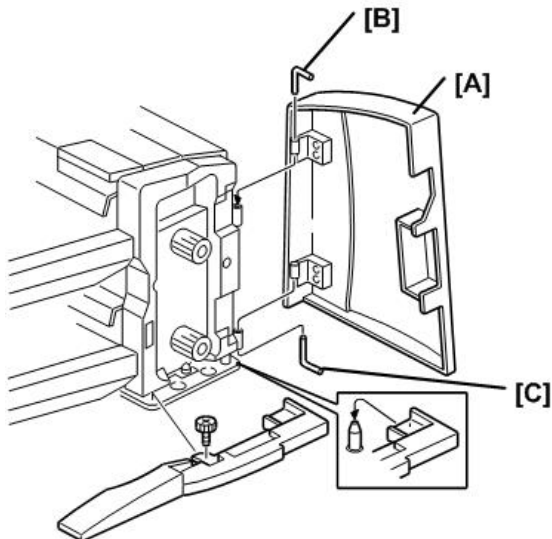

d7380003

4. Remove:

[A] Rear top cover of the feed unit (⚙️ x2)

[B] Feed unit rear upper cover (⚙️ x4)

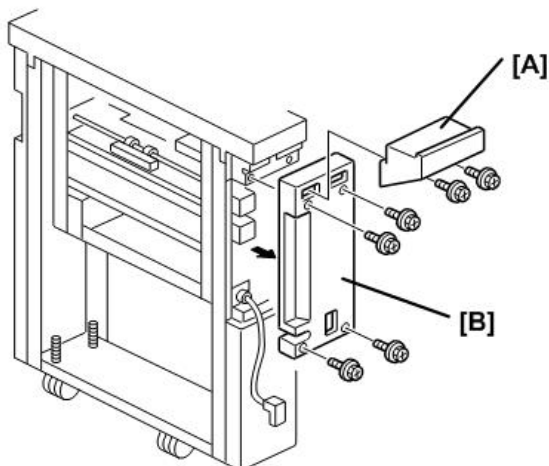

d7380004

1st, 2nd Trays

1. Remove:

- Inner cover with tray unit front door
- Tray unit rear cover

2. 1st Tray

Disconnect [A]

- 1st lift motor (🔌x1, 📦x1)
- White connectors (📦x2)

[B] 1st tray (🔌x5)

3. 2nd Tray

Remove:

- Inner cover with tray unit front door
- Tray unit rear cover

4. Disconnect [C]:

- 2nd lift motor (🔌x1, 📦x1)
- Red, blue connectors (📦x2)
- [D] 2nd tray (🔌x5)

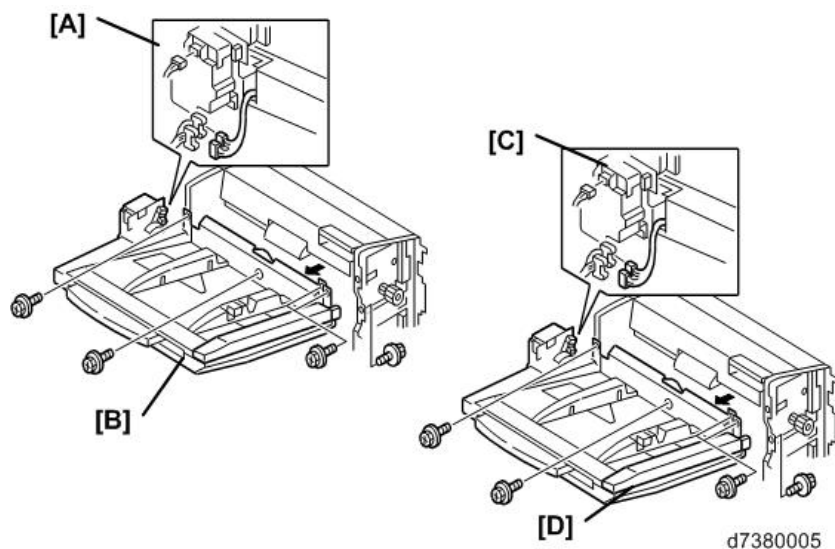

Feed Units

1st Feed Unit

Remove:

- Top cover
- Inner cover with front door
- Tray unit rear cover

[A] Stay (🔩 x5)

[B] Open the 1st tray cover and hold it open

[C] 1st feed belt unit

[D] 1st feed unit (🔩 x2, 📦 x1)

2nd Feed Unit

- Open the vertical feed cover
- Remove inner cover with tray unit front dwoor
- 2nd feed belt unit (same as [C])
- [E] 2nd feed unit (🔩 x2, 📦 x2)

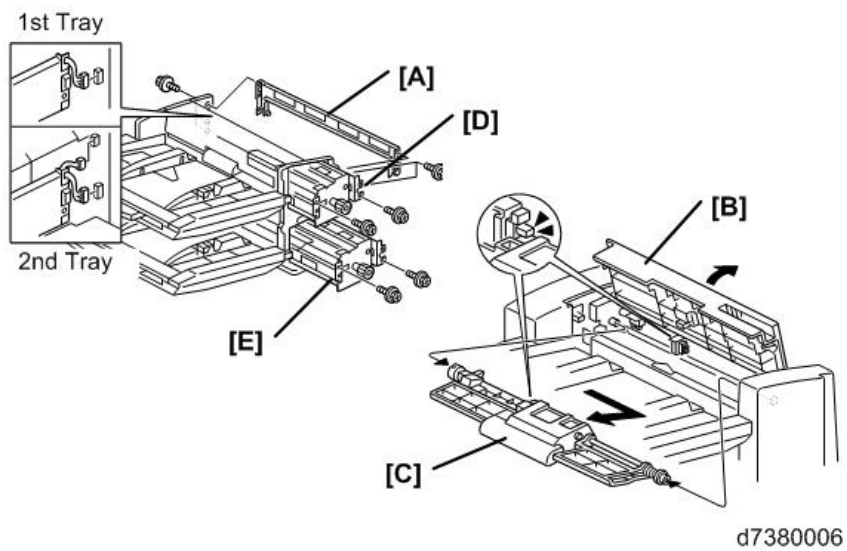

Boards

1

Tray Unit Control Board

1. Remove tray unit rear cover (🔩 x2)
[A] Board cover (🔩 x3, 🛠 x8)
[B] Tray unit control board (🔩 x 17, 🔩 x5, 🛠 x1)

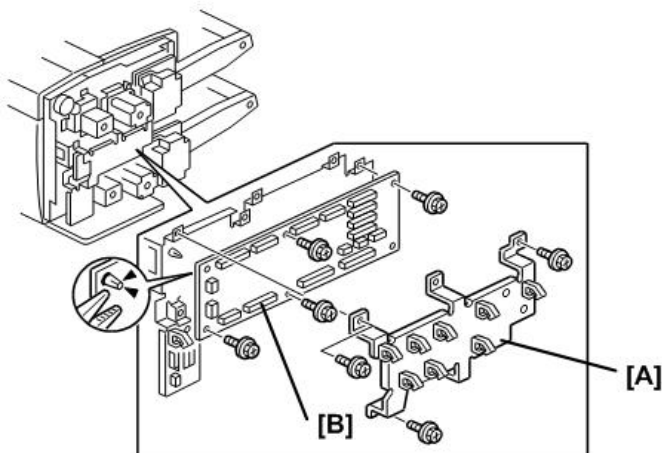

d7380007

Main Control Board

1. Remove transport unit rear upper cover.
[A] Connector bracket (🔩 x2)
[B] Main control board (🔩 x4, 🛠 x2, 🔩 x14, 🛠 x2)

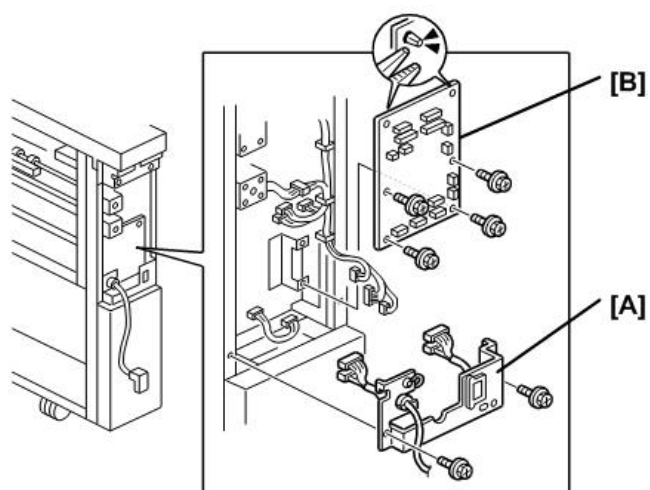

d7380008

Motors

1

Vertical Transport Motor

1. Remove transport unit rear cover.

[A] Motor unit (⚙️ x2, 📦 x1, 🔌 x1)

[B] Vertical transport motor (⚙️ x2)

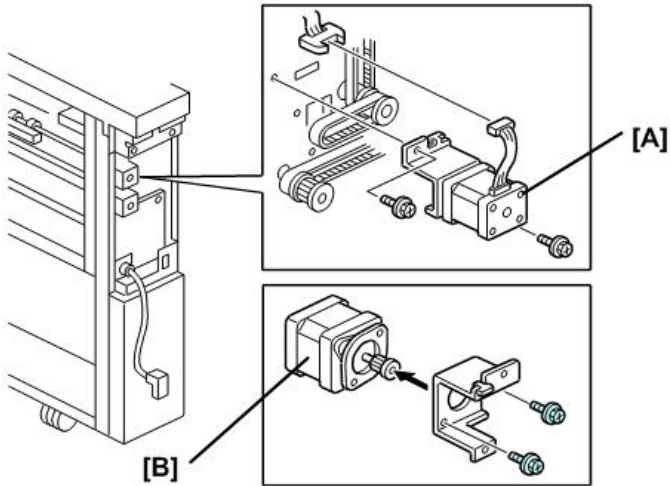

d7380009

Horizontal Transport Motor

1. Remove transport unit rear cover

[A] Motor unit (⚙️ x2, 📦 x1, 🔌 x1)

[B] Horizontal transport motor (⚙️ x2)

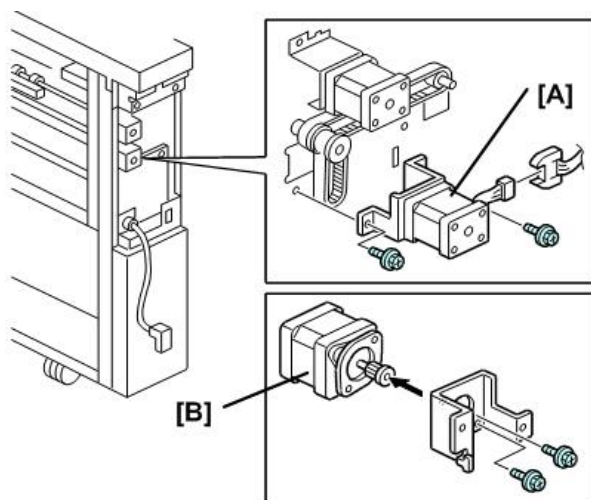

d7380010

1st, 2nd Lift Motors

1. Remove tray unit rear cover.

[A] 1st lift motor (⚙️ 2, 📦 x1)

[B] 2nd lift motor (⚙️ x2, 📦 x1)

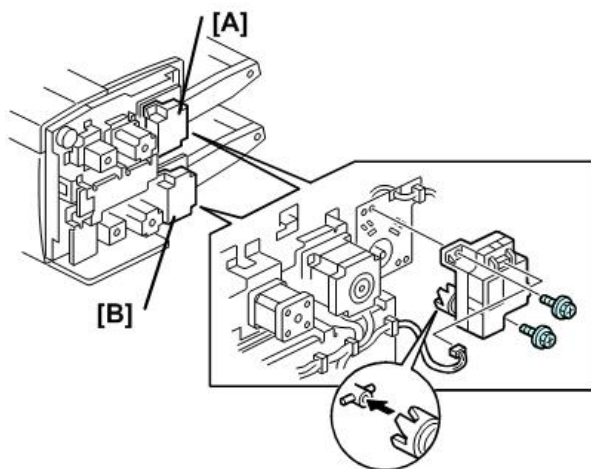

d7380011

1st, 2nd Feed Motors

1. Remove tray unit rear cover.

[A] 1st feed motor unit (⚙️ x3, ⚙️ x2, 📦 x1)

[B] 1st feed motor (⚙️ x2, 🌀 x1)

[C] 2nd feed motor unit, 2nd feed motor (⚙️ x5, 📦 x1, 🌀 x1)

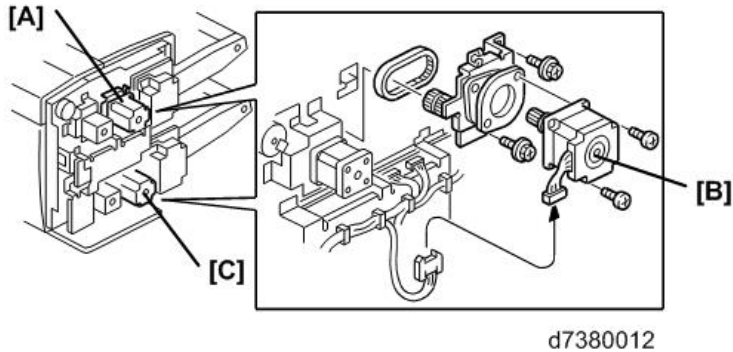

1st, 2nd Transport Motors

1. Remove tray unit rear cover.

1st Transport Motor

[A] 1st transport motor unit (⚙️ x3, 📦 x1)

[B] 1st transport motor (⚙️ x2, 🌀 x1)

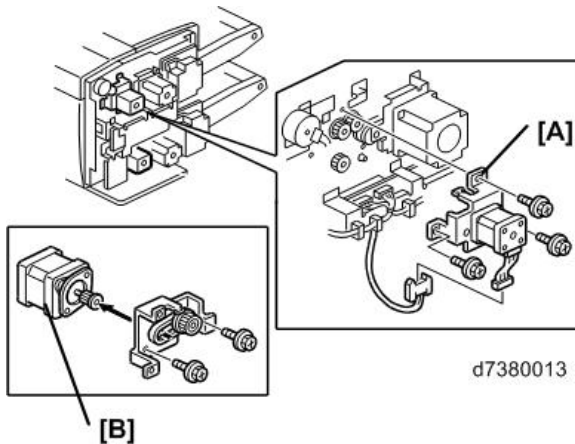

2nd Transport Motor

[A] Tray unit control board unit (Hooks, ⚙️ x3, 📦 x9)

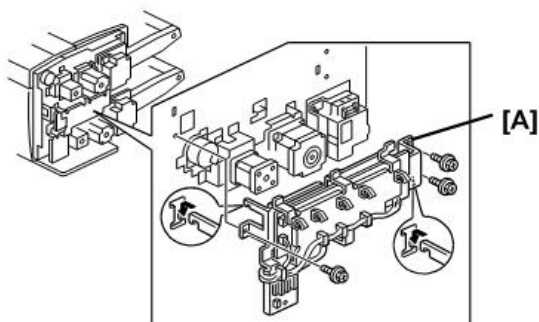

d7380040

[A] 2nd transport motor unit (⚙️ x3)

[B] 2nd transport motor (⚙️ x2, ⚙️ x1)

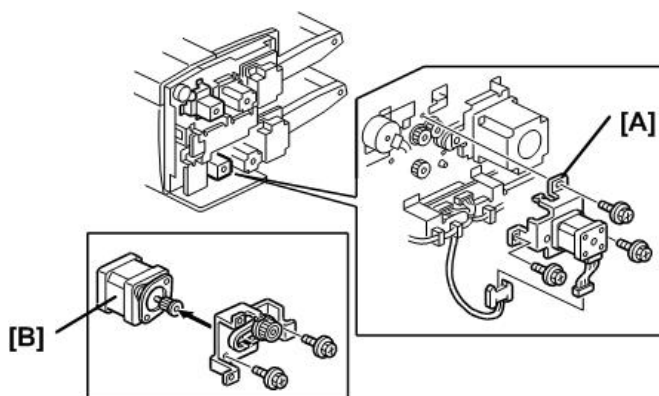

d7380041

1st, 2nd Pick-Up Motors

1st Pick-up Motor

1. Remove tray unit rear cover.

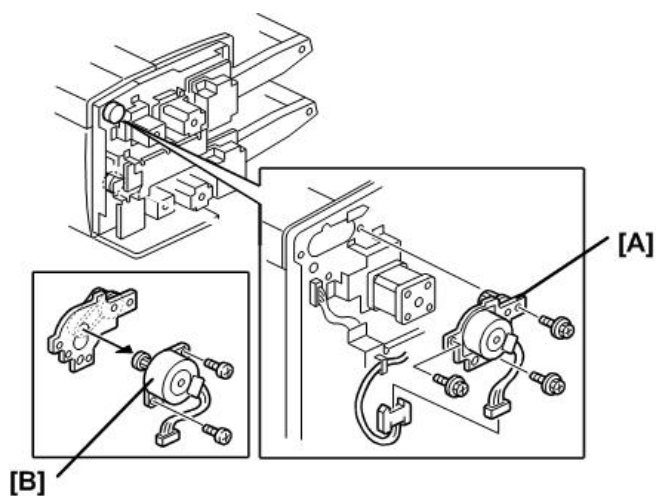

[A] 1st pick-up motor unit (⚙️ x1, ⚙️ x3)

[B] 1st pick-up motor (⚙️ x2, ⚙️ x1)





d7380014

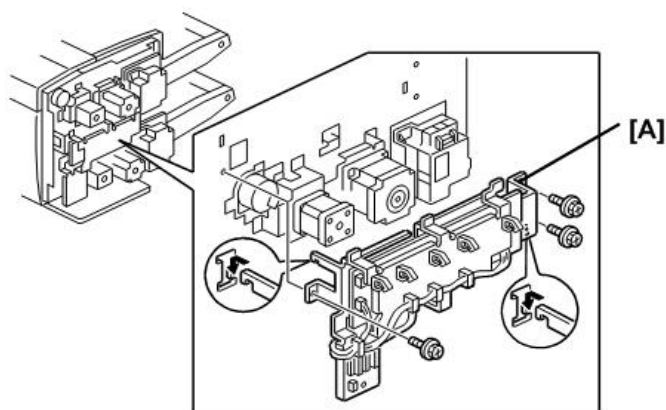

2nd Pick-up Motor

1. Tray unit control board unit (Hooks,  x3,  x9)



d7380042

[A] 2nd pick-up motor unit ( x1,  x3)

[B] 2nd pick-up motor ( x2,  x1)

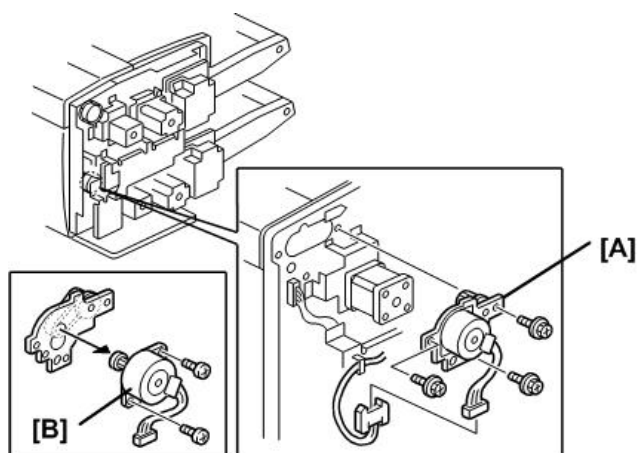

d7380043

Sensors

1

Paper Width Switch, Set Sensors, Length Sensor

1. Remove 1st or 2nd paper tray

[A] Front cover (⌀ x1)

[B] Rear cover (⌀ x1)

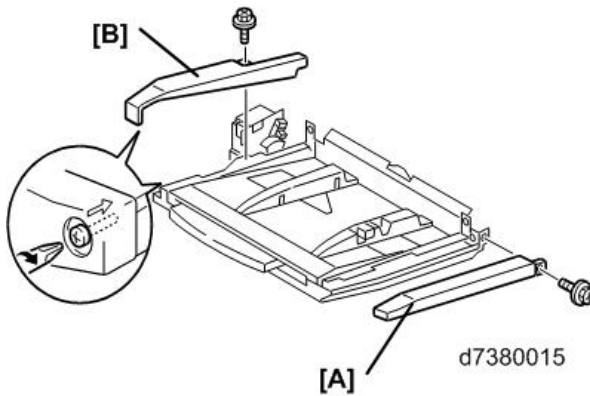

[A] Bottom cover (⌀ x2)

[B] Holder pin (⌀ x1, Spring x1)

[C] Bottom plate

1. Turn over the bottom plate so it is facing up.

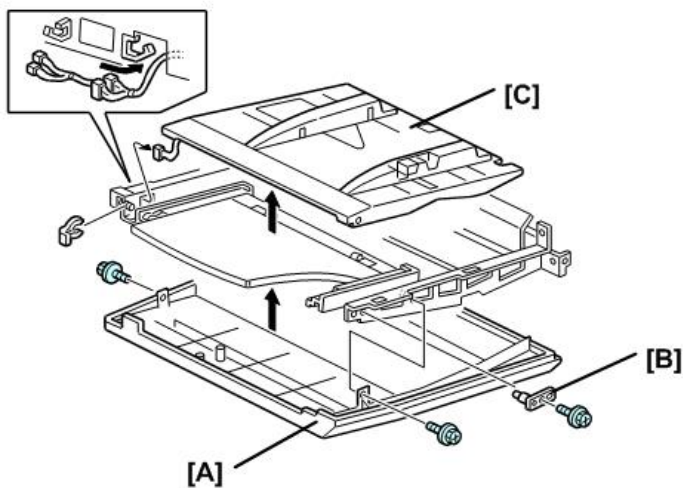

d7380016

2. Remove:

[A] Harness cover (▼ x2)

[B] Paper width switch (▼ x2, 📡 x4, 📡 x1)

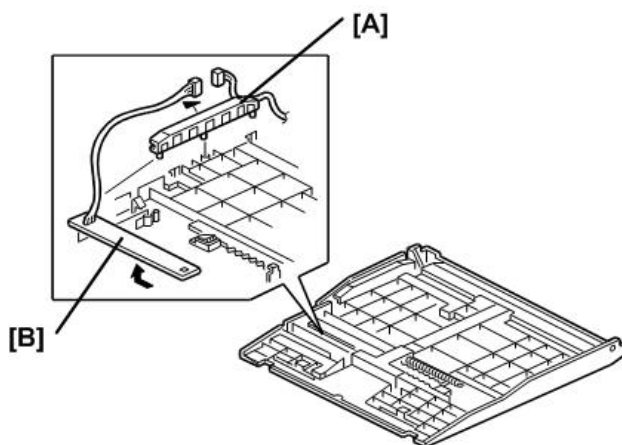

d7380017

[A] Paper set sensor (▼ x1, 📡 x1)

[B] Paper length sensor (▼ x1, 📡 x1)

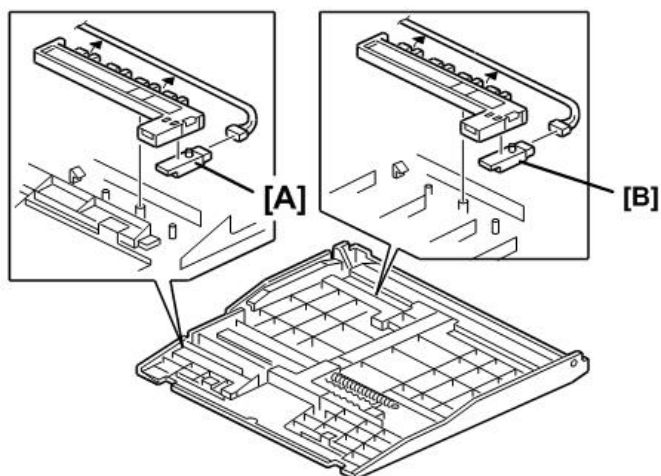

d7380018

1st Transport Sensor

1. Remove top cover, vertical feed cover, stay.

2. Remove:

[A] Upper paper guide (⚙️ x2)

[B] Sensor unit (⚙️ x2, 📦 x1, 📦 x1)

[C] 1st transport sensor (▼ x2)

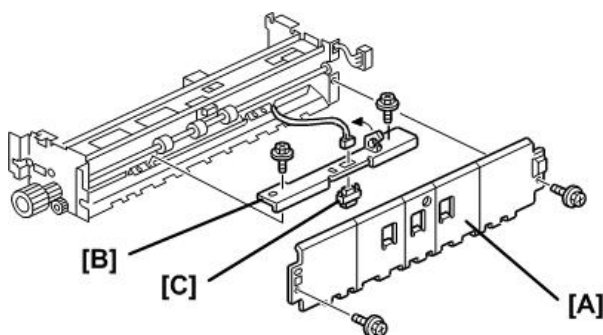

d7380019

Feed Unit Sensors

1. Remove:

[A] 1st feed unit

[B] 2nd feed unit

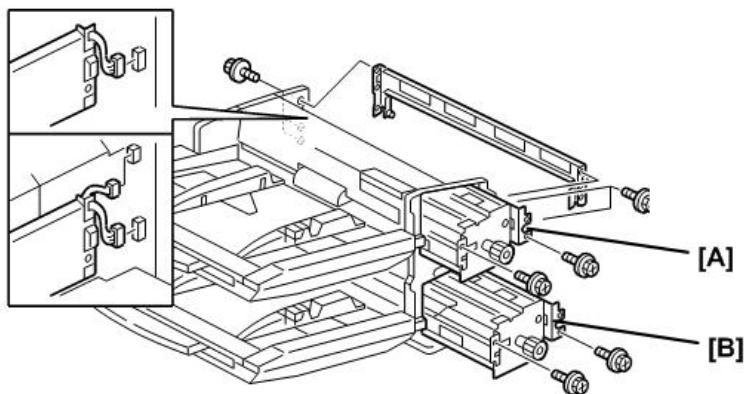

d7380020

[A] Pickup roller HP sensor bracket, sensor (⚙️ x1, 📦 x1, ▼ x2)

[B] Bottom plate position sensor bracket, sensor (⚙️ x1, 📦 x1, 📦 x1, ▼ x2)

[C] 1st Vertical transport sensor bracket, sensor (⚙️ x1, (🔌 x1, 🔦 x2)

[D] Paper Feed sensor bracket, sensor (⚙️ x1, 🌀x1, (🔌 x1, 🔦 x2)

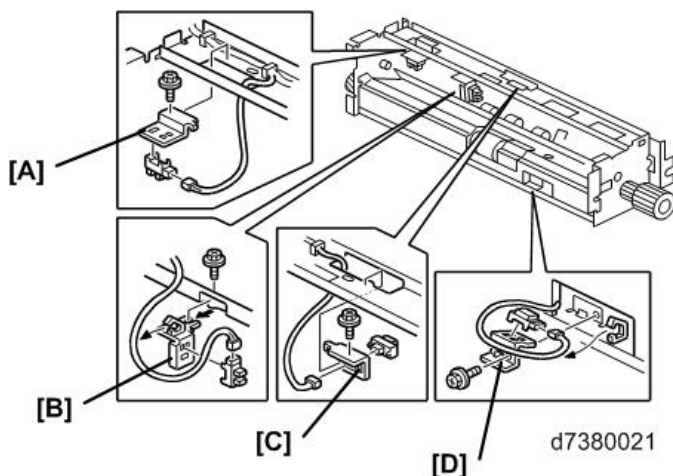

2nd Vertical Transport, Exit Sensors

1. Remove:

[A] 2nd vertical transport sensor bracket, sensor (⚙️ x1, 🌀x1, (🔌 x1, 🔦 x2)

[B] Vertical exit sensor bracket, sensor (⚙️ x2, 🌀x1, (🔌 x1, 🔦 x2)

[C] Exit sensor bracket, sensor (⚙️ x2, 🌀x1, (🔌 x1, 🔦 x2)

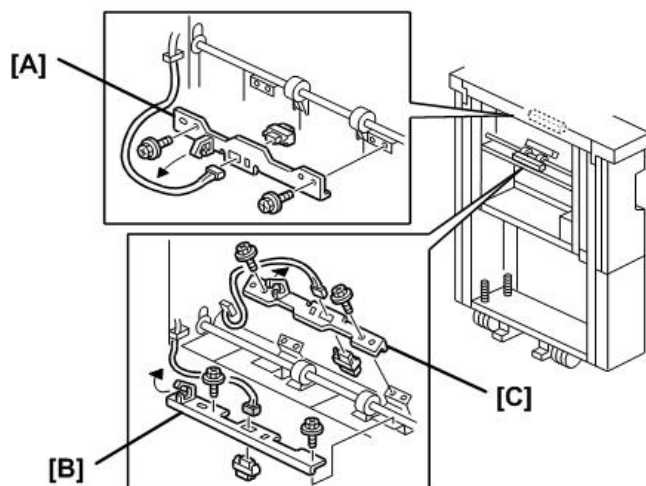

d7380022

Entrance Sensor

1. Remove:

[A] Sensor bracket (🔩 x2, 🛠 x1, 📦 x1)

[B] Entrance sensor (🔩 x2)

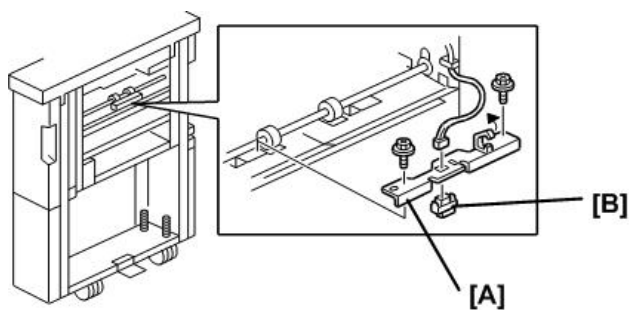

d7380023

Rollers

Separation Roller

1

1. Remove 1st (or 2nd) feed unit.

[A] Cover

[B] Separation Roller (⌀x1)

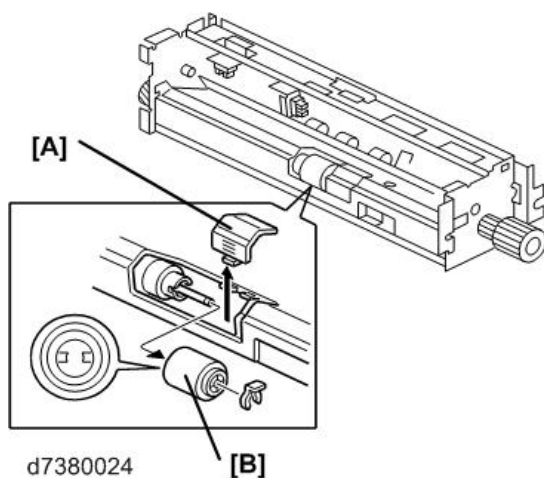

Feed Belt Unit And Pick-Up Roller

1. Open the 1st tray cover.

[A] Feed belt unit

2. The unit is spring loaded. Push it to the right to release it, and then lift it out.

[B] Pick-up roller (⌀x2, ■x2)

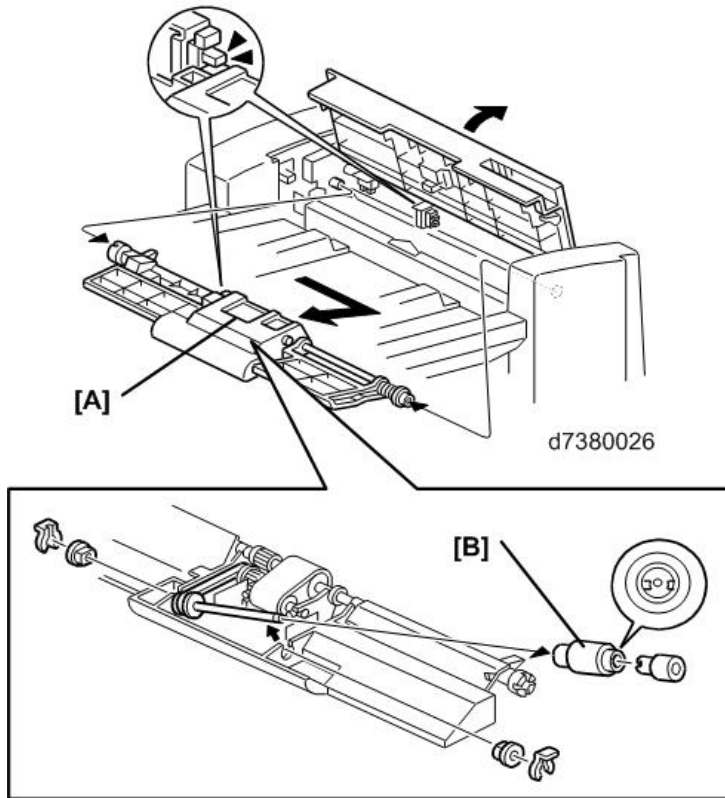

Feed Belt

1. Remove feed belt unit

[A] Pick-up roller unit.

2. Pull the unit away from the bushings in the direction of the arrow.

[B] Feed belt holder

- Hold the feed belt holder by the sides, then lift up to separate from the holder.
- Pull slowly to avoid losing the springs.

[C] Feed belt.

Re-assembly

1. Position the pick-up roller unit [A] and feed belt holder [B] as shown above.
2. On the rear side, slide out the bushing, and rotate guide plate [D] until its stepped side attaches at [E] as shown above, then snap the guide plate on.
3. On the front side, rotate guide plate [F] until its flat side is parallel with [D], then snap it on. Viewed from the bottom, the plates must be aligned.

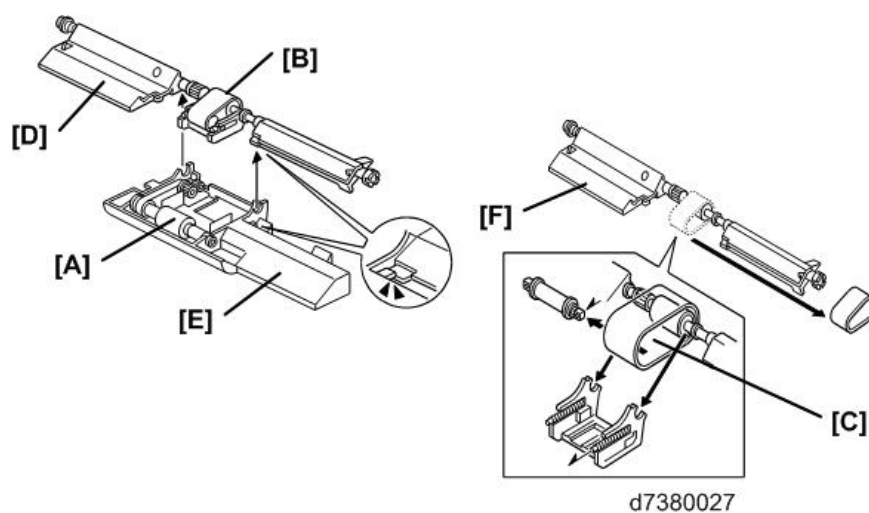

MEMO

MEMO

MEMO