

Reissued: 18-Mar-09

Model: Cover Interposer Tray CI5000	Date: 21-Nov-06	No.: RB835001e
-------------------------------------	-----------------	----------------

RTB Reissue

The items in bold italics have been added.

Subject: Cover Interposer Tray CI5000		Prepared by: T.Tadokoro	
From: PPBG QA/Service Planning Dept.			
Classification:	<input type="checkbox"/> Troubleshooting <input type="checkbox"/> Mechanical <input type="checkbox"/> Paper path <input checked="" type="checkbox"/> Other ()	<input type="checkbox"/> Part information <input type="checkbox"/> Electrical <input type="checkbox"/> Transmit/receive	<input type="checkbox"/> Action required <input type="checkbox"/> Service manual revision <input type="checkbox"/> Retrofit information

This RTB has been issued to announce the firmware release information for the Cover Interposer.

Version	Program No.	Effective Date
<i>02.070:41</i>	<i>B8355510E</i>	<i>April 2009 production</i>
02.067:40	B8355510D	Jan 2009 production
02.064:37	B8355510C	Sep 2008 production
02.050:32	B8355510B	Feb 2008 production
02.030:26	B8355510A	Nov 2007 production
01.000:20	B8355510	1st Mass production.

Version	Modified Points or Symptom Corrected
<i>02.070:41</i>	<i>Symptom corrected:</i> <ul style="list-style-type: none"> <i>During a job that involves paper feeding from the Inserter, the job cannot be completed if the Inserter cover is opened.</i> <i>During a job that involves paper feeding from the Inserter, the job cannot be completed if the paper on the feeder tray is dragged out.</i> <i>During a job that involves paper feeding from the Inserter, the job cannot be completed if a jam occurs on the Inserter or a downstream peripheral.</i>
02.067:40	Other changes: Support for Katana-C2/P1.
02.064:37	Changes: Support for Aegis-C1/P1.
02.050:32	Other changes: Support for Bellini-C3.5(Katana-C1.5).
02.030:26	Other changes: Supports the D014/D015 copier.
01.000:20	1st Mass production.

Reissued: 21-Apr-09

Model: Cover Interposer Tray CI5000	Date: 21-Nov-06	No.: RB835001f
-------------------------------------	-----------------	----------------

RTB Reissue

The items in bold italics have been added.

Subject: Cover Interposer Tray CI5000		Prepared by: T.Tadokoro	
From: PPBG QA/Service Planning Dept.			
Classification:	<input type="checkbox"/> Troubleshooting	<input type="checkbox"/> Part information	<input type="checkbox"/> Action required
	<input type="checkbox"/> Mechanical	<input type="checkbox"/> Electrical	<input type="checkbox"/> Service manual revision
	<input type="checkbox"/> Paper path	<input type="checkbox"/> Transmit/receive	<input type="checkbox"/> Retrofit information
	<input checked="" type="checkbox"/> Other ()		

This RTB has been issued to announce the firmware release information for the Cover Interposer.

Version	Program No.	Effective Date
<i>02.071:42</i>	<i>B8355510F</i>	<i>April 2009 production</i>
02.070:41	B8355510E	April 2009 production
02.067:40	B8355510D	Jan 2009 production
02.064:37	B8355510C	Sep 2008 production
02.050:32	B8355510B	Feb 2008 production
02.030:26	B8355510A	Nov 2007 production
01.000:20	B8355510	1st Mass production.

Version	Modified Points or Symptom Corrected
<i>02.071:42</i>	<i>Other changes: The Venus C2 supports the Ring Binder</i>
02.070:41	Symptom corrected: <ul style="list-style-type: none"> During a job that involves paper feeding from the Inserter, the job cannot be completed if the Inserter cover is opened. During a job that involves paper feeding from the Inserter, the job cannot be completed if the paper on the feeder tray is dragged out. During a job that involves paper feeding from the Inserter, the job cannot be completed if a jam occurs on the Inserter or a downstream peripheral.
02.067:40	Other changes: Support for Katana-C2/P1.
02.064:37	Changes: Support for Aegis-C1/P1.
02.050:32	Other changes: Support for Bellini-C3.5(Katana-C1.5).
02.030:26	Other changes: Supports the D014/D015 copier.
01.000:20	1st Mass production.

Reissued: 24-Feb-10

Model: Cover Interposer Tray CI5000	Date: 21-Nov-06	No.: RB835001g
-------------------------------------	-----------------	----------------

RTB Reissue

The items in bold italics have been added.

Subject: Cover Interposer Tray CI5000		Prepared by: Hidetoshi Kawamura	
From: PPBG Service Planning Dept.			
Classification:	<input type="checkbox"/> Troubleshooting	<input type="checkbox"/> Part information	<input type="checkbox"/> Action required
	<input type="checkbox"/> Mechanical	<input type="checkbox"/> Electrical	<input type="checkbox"/> Service manual revision
	<input type="checkbox"/> Paper path	<input type="checkbox"/> Transmit/receive	<input type="checkbox"/> Retrofit information
	<input checked="" type="checkbox"/> Other ()		

This RTB has been issued to announce the firmware release information for the Cover Interposer.

Version	Program No.	Effective Date
<i>02.073:44</i>	<i>B8355510G</i>	<i>December 2009 production</i>
02.071:42	B8355510F	April 2009 production
02.070:41	B8355510E	April 2009 production
02.067:40	B8355510D	Jan 2009 production
02.064:37	B8355510C	Sep 2008 production
02.050:32	B8355510B	Feb 2008 production
02.030:26	B8355510A	Nov 2007 production
01.000:20	B8355510	1st Mass production

Version	Modified Points or Symptom Corrected
<i>02.073:44</i>	<i>Modified Points</i> <ul style="list-style-type: none"> <i>For CI5010 /CI5000, to prevent the false positive of the following symptom. When the switch is turned on with paper set in the 1st tray, some of the paper sizes are not detected correctly.</i> <i>To prevent a false positive of the following symptom. When sending the job from Web Image Monitor, in which the job's 1st sheet is fed from the CI5000/5010, a paper set error occurs.</i>
02.071:42	Other changes: The Venus C2 supports the Ring Binder
02.070:41	Symptom corrected: <ul style="list-style-type: none"> During a job that involves paper feeding from the Inserter, the job cannot be completed if the Inserter cover is opened. During a job that involves paper feeding from the Inserter, the job cannot be completed if the paper on the feeder tray is dragged out. During a job that involves paper feeding from the Inserter, the job cannot be completed if a jam occurs on the Inserter or a downstream peripheral.
02.067:40	Other changes: Support for Katana-C2/P1.
02.064:37	Changes: Support for Aegis-C1/P1.
02.050:32	Other changes: Support for Bellini-C3.5(Katana-C1.5).

Reissued: 24-Feb-10

Model: Cover Interposer Tray CI5000	Date: 21-Nov-06	No.: RB835001g
-------------------------------------	-----------------	----------------

Version	Modified Points or Symptom Corrected
02.030:26	Other changes: Supports the D014/D015 copier.
01.000:20	1st Mass production

Reissued: 13-Oct-10

Model: Aries-C1.5/P1.5, AG-C1/P1, AGL-C1/P1, B-C3/C3.5/C4, V-C2	Date: 21-Nov-06	No.: RB835001h
--	-----------------	----------------

RTB Reissue

The items in bold italics have been added.

Subject: Cover Interposer Tray CI5000		Prepared by: J. Ohno	
From: PPBG Service Planning Dept.			
Classification:	<input type="checkbox"/> Troubleshooting	<input type="checkbox"/> Part information	<input type="checkbox"/> Action required
	<input type="checkbox"/> Mechanical	<input type="checkbox"/> Electrical	<input type="checkbox"/> Service manual revision
	<input type="checkbox"/> Paper path	<input type="checkbox"/> Transmit/receive	<input type="checkbox"/> Retrofit information
	<input checked="" type="checkbox"/> Other ()		

This RTB has been issued to announce the firmware release information for the **Cover Interposer**.

Version	Program No.	Effective Date
03.010:46	B8355510H	May 2010 production
02.073:44	B8355510G	December 2009 production
02.071:42	B8355510F	April 2009 production
02.070:41	B8355510E	April 2009 production
02.067:40	B8355510D	Jan 2009 production
02.064:37	B8355510C	Sep 2008 production
02.050:32	B8355510B	Feb 2008 production
02.030:26	B8355510A	Nov 2007 production
01.000:20	B8355510	1st Mass production.

Version	Modified Points or Symptom Corrected
03.010:46	<p><i>The Inserter is supported by the Pro C901/C901S.</i></p> <p><i>Symptoms Corrected:</i></p> <ul style="list-style-type: none"> <i>Program download to the Cover Interposer Tray CI5010 and any other downstream peripherals results in failure in the following configuration:</i> <i>Pro C901/C901S mainframe + Buffer Pass Unit Type 5000 + Cover Interposer Tray CI5010 + any downstream peripheral</i> <i>The Cover Interposer Tray CI5010 will not feed the cover sheets and the control panel indicates 'Printing' due to a data transmission error between the Cover Interposer and the Pro C901/C901S/C900/C900S.</i>
02.073:44	<p><u>Modified Points</u></p> <ul style="list-style-type: none"> For CI5010/CI5000, to prevent the false positive of the following symptom. When the switch is turned on with the papers are set at the 1st tray, some of the paper sizes are not detected correctly. To prevent the false positive of the following symptom. When sending the job from the Web Image Monitor, which the job's 1st paper is fed from the CI5000/5010, paper set error occurs.
02.071:42	<p><u>Other changes:</u></p> <p>The Venus C2 supports the Ring Binder.</p>

Reissued: 13-Oct-10

Model: Aries-C1.5/P1.5, AG-C1/P1, AGL-C1/P1, B-C3/C3.5/C4, V-C2		Date: 21-Nov-06	No.: RB835001h
Version	Modified Points or Symptom Corrected		
02.070:41	Symptom corrected: <ul style="list-style-type: none">• During a job that involves paper feeding from the Inserter, the job cannot be completed if the Inserter cover is opened.• During a job that involves paper feeding from the Inserter, the job cannot be completed if the paper on the feeder tray is dragged out.• During a job that involves paper feeding from the Inserter, the job cannot be completed if a jam occurs on the Inserter or a downstream peripheral.		
02.067:40	Other changes: Support for Katana-C2/P1.		
02.064:37	Changes: Support for Aegis-C1/P1.		
02.050:32	Other changes: Support for Bellini-C3.5(Katana-C1.5).		
02.030:26	Other changes: Supports the D014/D015 copier.		
01.000:20	1st Mass production		

Model: Cover Interposer Tray CI5000 (B835)		Date: 17-Dec-10	No.: RB835002
Subject: Modification to prevent false detection		Prepared by: T. Komori	
From: PP Service Planning Department 1G			
Classification:	<input type="checkbox"/> Troubleshooting <input checked="" type="checkbox"/> Part information <input type="checkbox"/> Action required <input type="checkbox"/> Mechanical <input type="checkbox"/> Electrical <input type="checkbox"/> Service manual revision <input type="checkbox"/> Paper path <input type="checkbox"/> Transmit/receive <input type="checkbox"/> Retrofit information <input type="checkbox"/> Product Safety <input type="checkbox"/> Other () <input type="checkbox"/> Tier 2		

Change: Paper feed sensor

Reason: To prevent false detection

Old Part Number	New Part Number	Description	Q'ty	Int	Page	Index	Note
	AW010107	PAPER FEED SENSOR	1	X/O	15	22	Add
B8353967	B8353966	BRACKET:SENSOR:EXIT	1	X/O	15	21	
B8355315	B8355319	HARNESS:SENSOR:ASS'Y	1	X/O	15	17	

The new sensor (AW010107) can detect a wider area in comparison to the former sensor (AW010122), which will lower the chances of misdetection.

Shape of the bracket and the length of the harness have also changed accordingly with this modification.

7.Original Transfer 1 (B835-57/66)

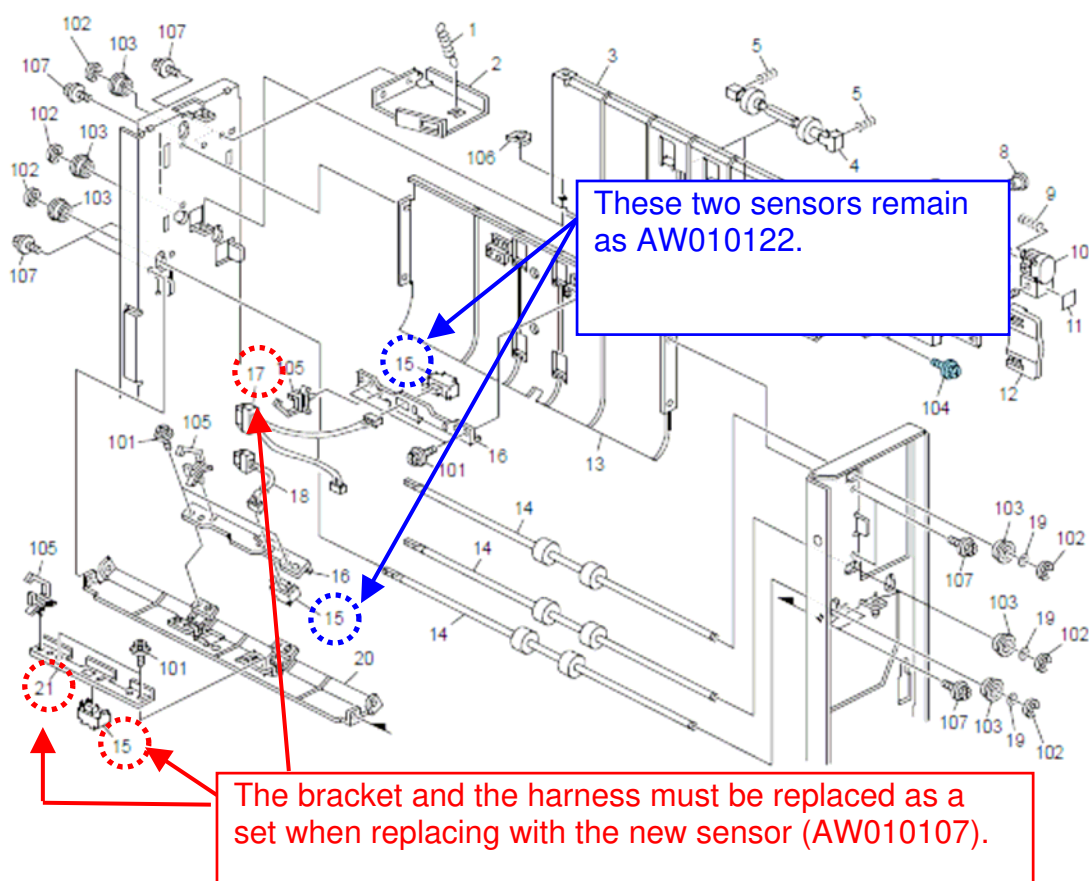

Model: Cover Interposer Tray CI5010(B835)		Date: 16-Dec-11	No.: RB835003
Subject: Part Changes; Tray ascending DC motor		Prepared by: A. Takada	
From: PP Tech Service Dept., 1st PP Tech Service Sect.			
Classification:	<input type="checkbox"/> Troubleshooting <input type="checkbox"/> Mechanical <input type="checkbox"/> Paper path <input type="checkbox"/> Product Safety	<input checked="" type="checkbox"/> Part information <input type="checkbox"/> Electrical <input type="checkbox"/> Transmit/receive <input type="checkbox"/> Other ()	<input type="checkbox"/> Action required <input type="checkbox"/> Service manual revision <input type="checkbox"/> Retrofit information <input type="checkbox"/> Tier 2

Change: Shape of the DC motor for lifting the tray

Reason: Vendor change

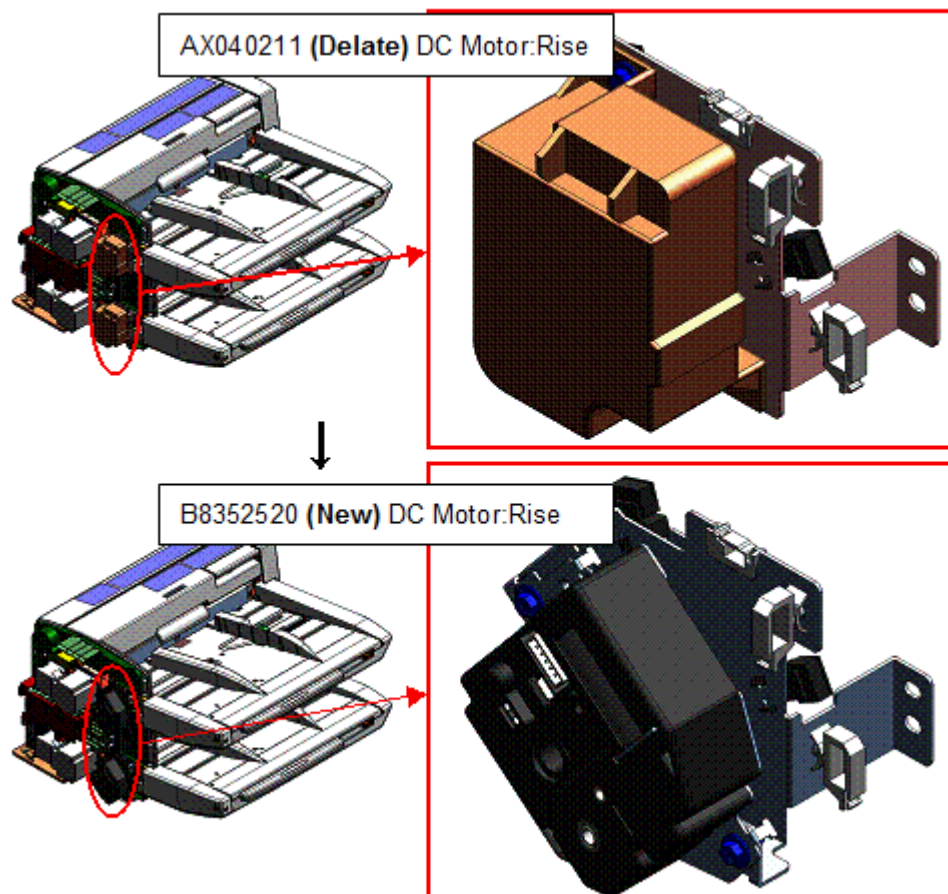

Cover Interposer Tray CI5010(B835)

Old Part Number	New Part Number	Description	Q'ty	Int	Page	Index	Note
AX040211	B8352520	DC Motor:Rise	1	O/O	5	2	A
B8352669	B8352522	Lift Motor Bracket	1	O/O	5	5	A
B8355320	B8355328	Harness - Motor No.1	1	X/O	21	5	A
B8355324	B8355329	Harness - Motor No.2	1	X/O	21	6	A

• When replacing these parts, replace all 4 parts as a set.

2.ORIGINAL TRAY 1 (B835)

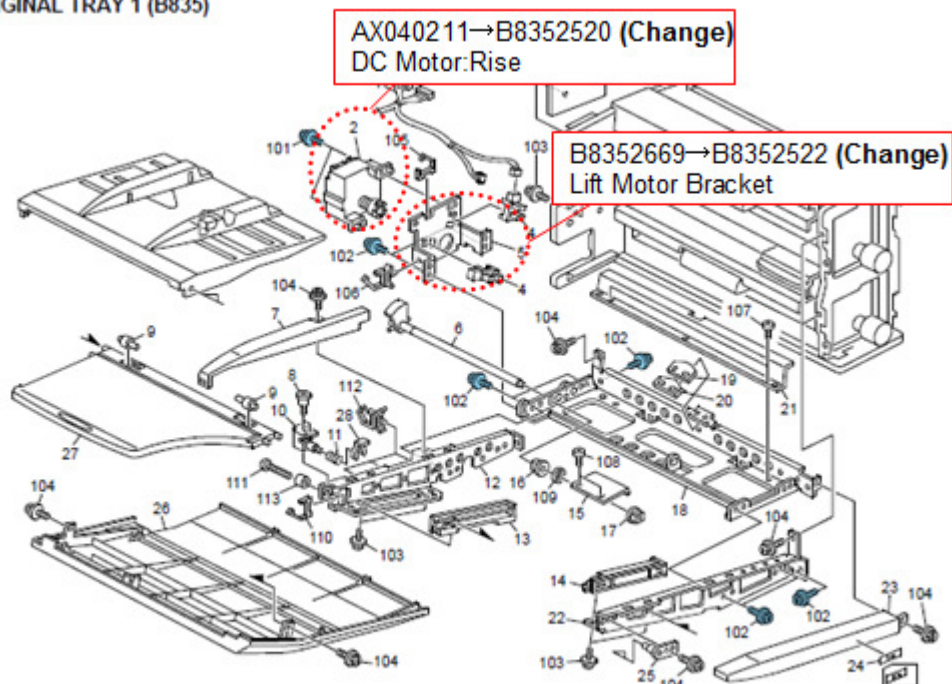

4

10.ELECTRICAL AND DRIVE 1 (B835)

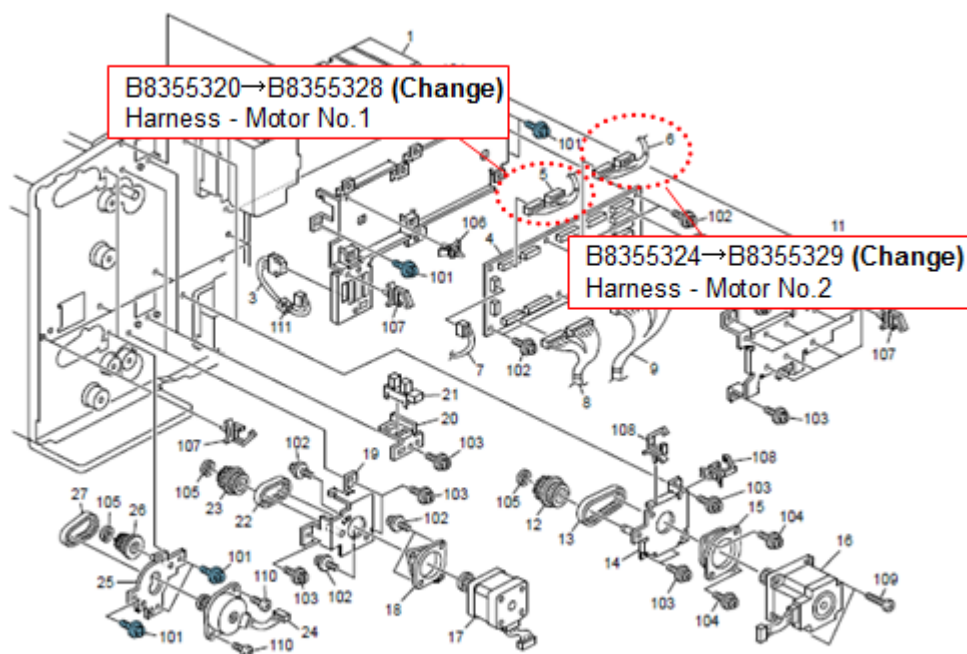

20

Model: Cover Interposer Tray CI5010 (B835)		Date: 27-Jan-12	No.: RB835004
Subject: Part Changes – shaft and bearing in the feed unit		Prepared by: T. Komori	
From: PP Service Planning Department 1G			
Classification:	<input type="checkbox"/> Troubleshooting <input type="checkbox"/> Mechanical <input type="checkbox"/> Paper path <input type="checkbox"/> Product Safety	<input checked="" type="checkbox"/> Part information <input type="checkbox"/> Electrical <input type="checkbox"/> Transmit/receive <input type="checkbox"/> Other ()	<input type="checkbox"/> Action required <input type="checkbox"/> Service manual revision <input type="checkbox"/> Retrofit information <input type="checkbox"/> Tier 2

Change: The length of the cam shaft and the quantity of the bearings in the feed unit

Reason: To reduce the load on the cam shaft and the bearings

Old Part Number	New Part Number	Description	Q'ty	I/C	Page	Index	Note
B8352782	B8352786	SHAFT:CAM:PICKUP ROLLER	1	X/O	11	11	

Overview

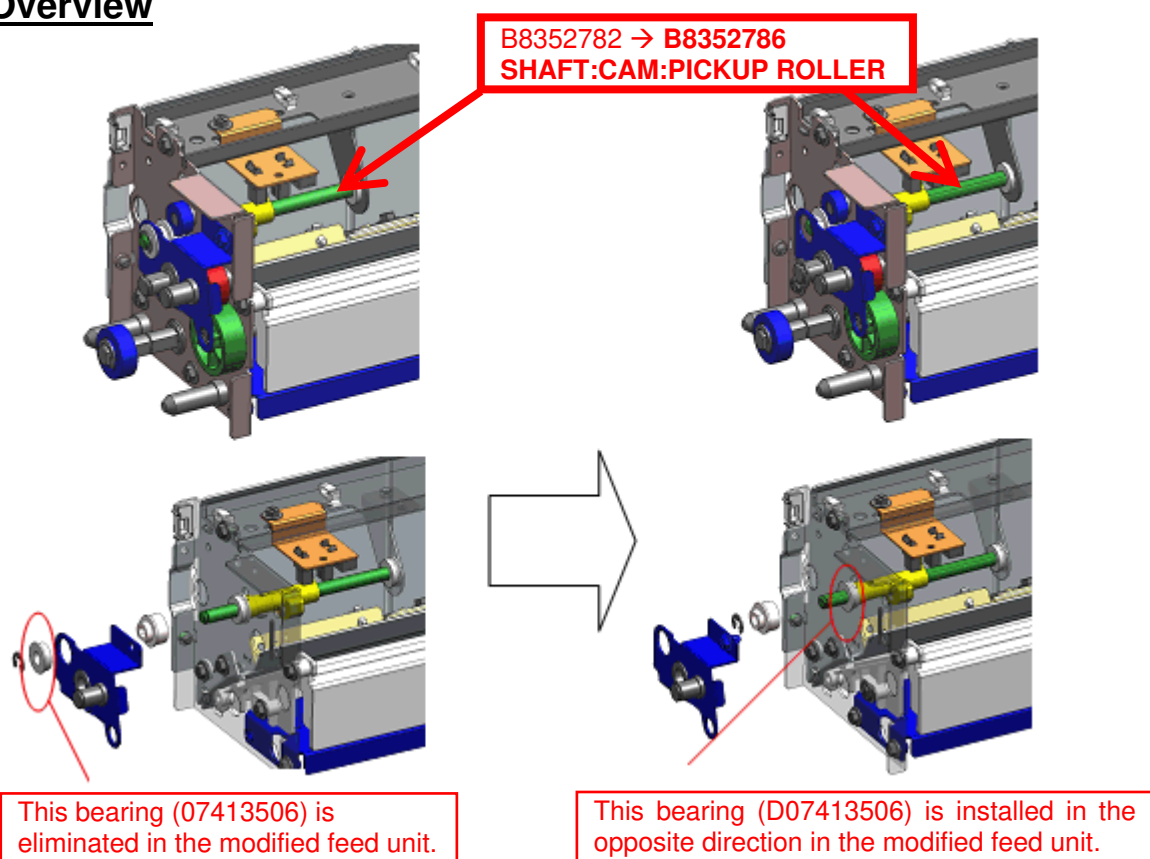

Feed unit

The photos below show the original feed unit before implementing the modification.

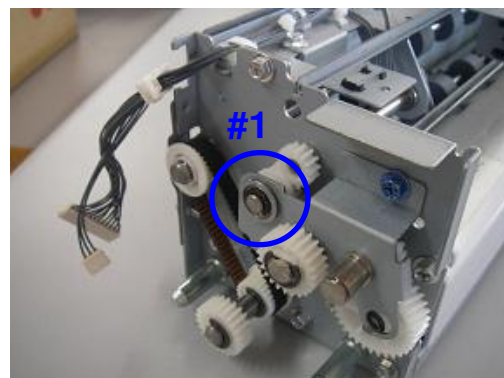
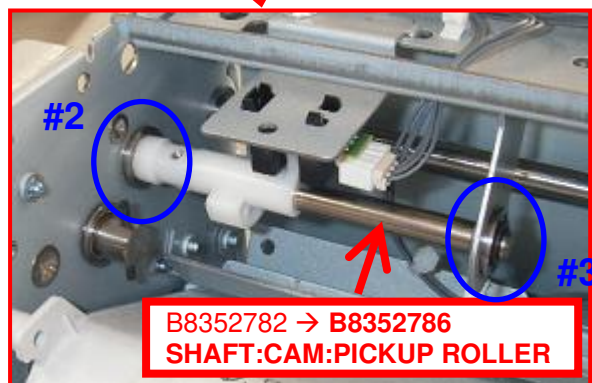
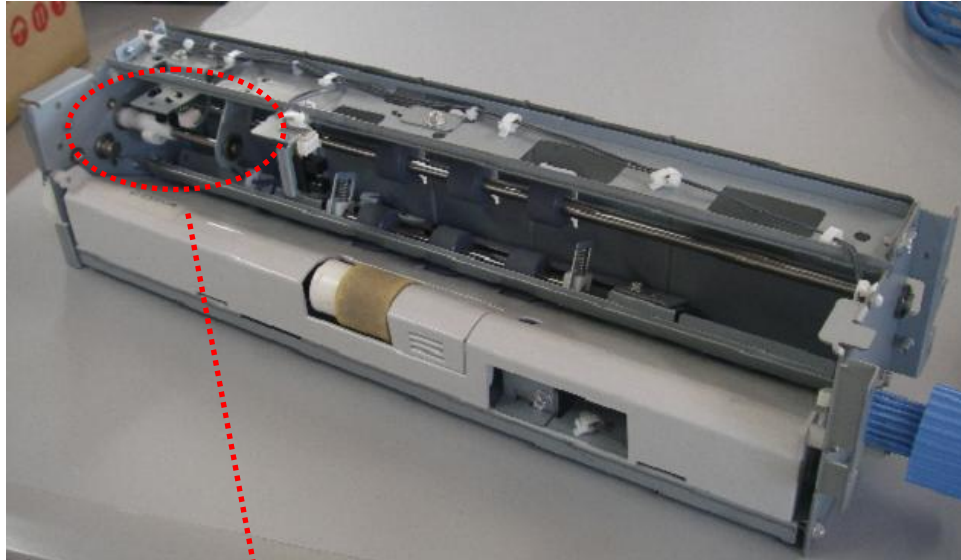

The following are the modified points of the new feed unit:

- ✓ Bearing #1 was eliminated.
- ✓ An E-ring was attached.
- ✓ The cam shaft was shortened (B8352786).
- ✓ Bearing #2 is installed in the opposite direction. (Installed from the outside of the bracket)