

**Cover Interposer Tray CI4010**  
**Machine Code: D711**  
**Field Service Manual**

18 March, 2013



---

# Safety and Symbols

---

## Replacement Procedure Safety

---

### **CAUTION**

- Turn off the main power switch and unplug the machine before beginning any of the replacement procedures in this manual.

---

## Symbols Used in this Manual

---

This manual uses the following symbols.

 : See or Refer to

 : Screws

 : Connector

 : Clip ring

 : E-ring

# TABLE OF CONTENTS

Safety and Symbols.....	1
Replacement Procedure Safety.....	1
Symbols Used in this Manual.....	1
<b>1. Replacement and Adjustment</b>	
External Covers.....	3
Feed Unit, Pick-Up Roller.....	4
Feed Belt.....	5
Guide Plate Adjustment.....	7
Main Board.....	8
Motor Replacement.....	9
Vertical Transport Motor.....	9
Bottom Plate Lift Motor.....	9
Feed Motor, Transport Motor.....	10

# 1. Replacement and Adjustment

## External Covers

1

1. Open the feed cover [A].
2. Upper front cover [B] (⚙ x 2)

### ⚙ Note

- To remove the upper front cover, screw [C] must be removed.

3. Rear upper cover [D] (⚙ x 2)
4. Slip sheet tray [E] (⚙ x 2, 📄 x 1)
5. Rear middle cover [F] (⚙ x 2)

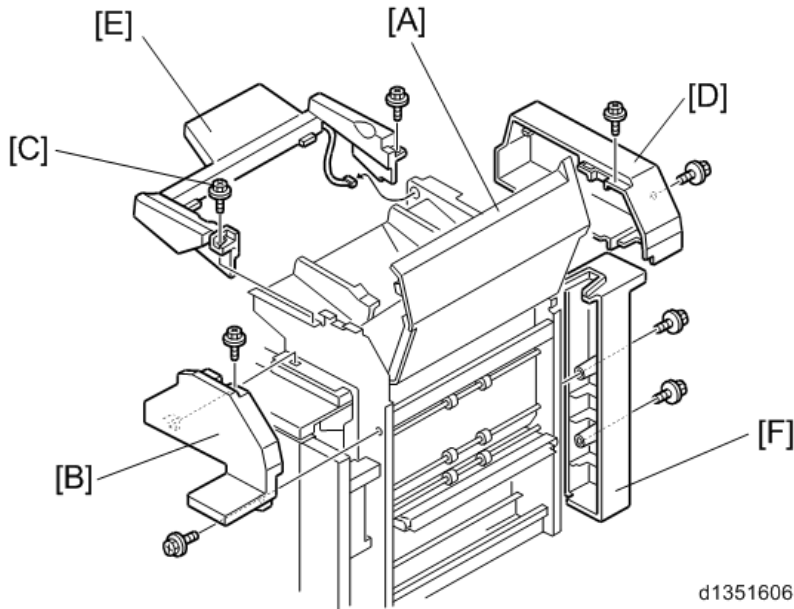

## Feed Unit, Pick-Up Roller

1

1. Open the feed cover.
2. Feed unit [A]

**Note**

- The unit is spring loaded. Push it to the right to release it, then lift it out.

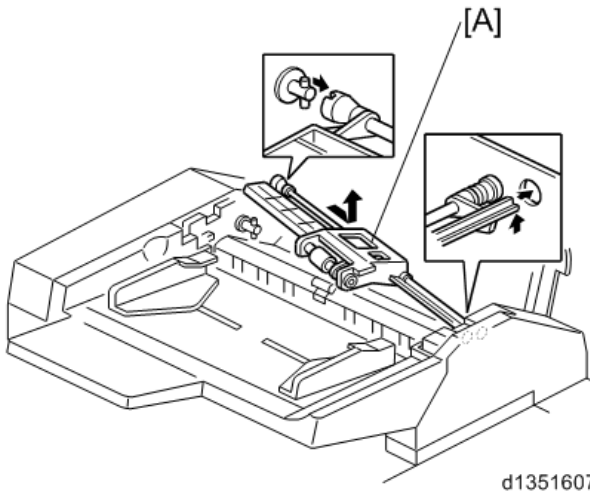

3. Pick-up roller [B] (⌀ x 2, bushings x 2)

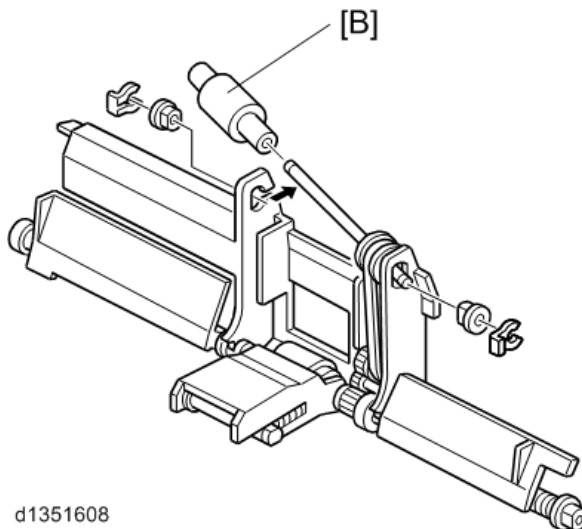

# Feed Belt

1. Feed unit (☛ page 4 "Feed Unit, Pick-Up Roller")
2. Pick-up roller unit [A]

## ↓ Note

- Pull the unit away from the bushings in the direction of the arrow.

3. Feed belt holder [B]

## ↓ Note

- Hold the feed belt holder by the sides, then lift up to separate from the holder.
- Pull slowly to avoid losing the springs.

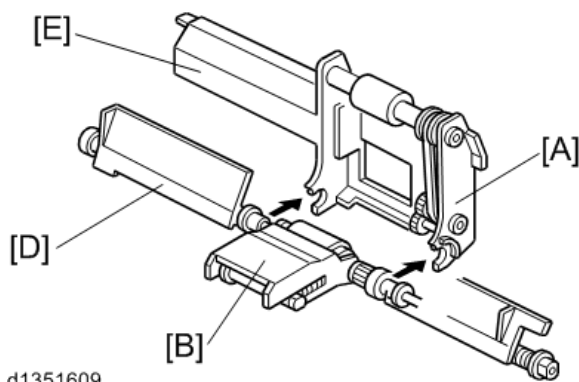

4. Feed belt [C]

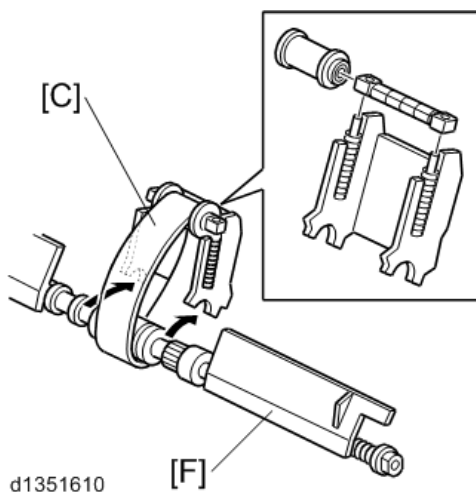

## Re-assembly

1. Position the pick-up roller unit [A] and feed belt holder [B] as shown above.

2. On the rear side, slide out the bushing, and rotate [D] until its flat side is parallel with [E], then snap it on.
3. On the front side, rotate [F] until its flat side is parallel with [D], then snap it on. Viewed from the bottom, the plates must be aligned.



# Guide Plate Adjustment

Adjust the guide plate if the holes punched in the covers or slip sheets are not correctly aligned with holes punched in the other sheets.

1. Open the feed cover.
2. Loosen the screw [A].
3. Push the table [B] left or right to change its position, then tighten the screw.

## Note

- If you want to see the scale [C], you must remove the rear cover and the support tray.

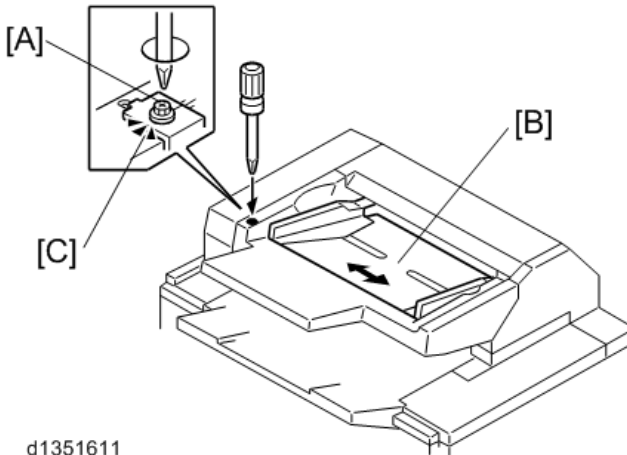

d1351611

## Main Board

1

1. Open the top cover.
2. Rear cover (⚙️ x 1)
3. Main board [A] (📏 x 9, ⚙️ x 4)

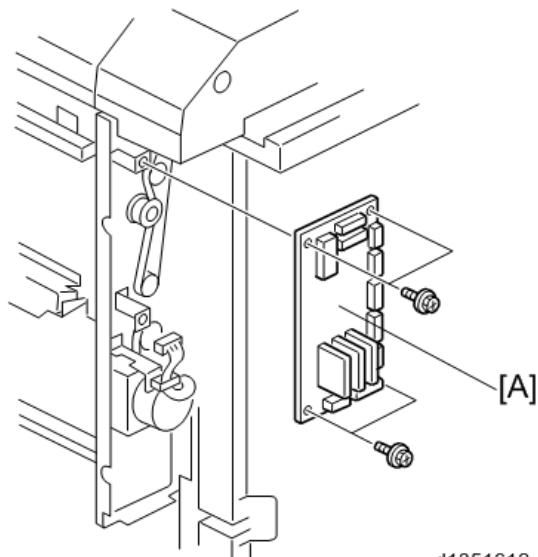

### ↓ Note

- All DIP switch settings on the main board of the cover sheet unit should be set to OFF.

# Motor Replacement

## Vertical Transport Motor

1

1. Open the top cover.
2. Rear middle cover (🔩 x 1) (📄 page 3 "External Covers")
3. Motor bracket [A] (📄 x 1, harness x 1, 🔩 x 2, timing belt x 1)
4. Motor [B] (🔩 x 2)

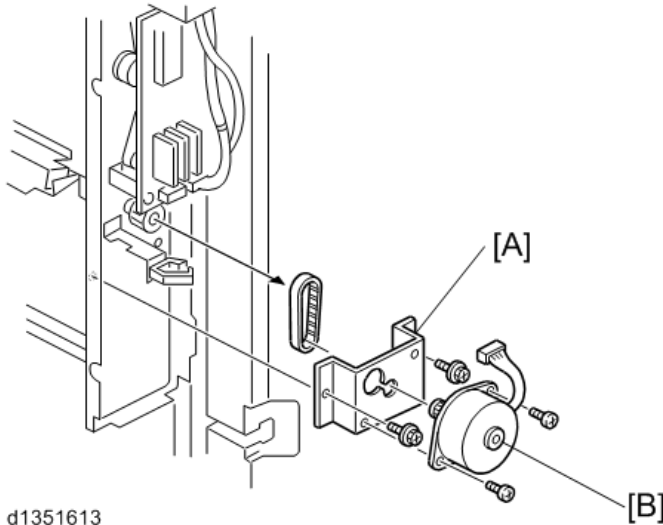

## Bottom Plate Lift Motor

1. Rear upper cover (📄 page 3 "External Covers")
2. Bottom plate lift motor [A] (harness x 2, 📄 x 1, 🔩 x 2)

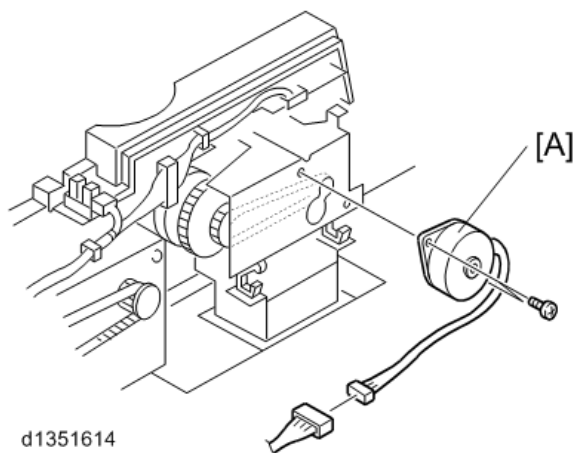

## Feed Motor, Transport Motor

### Note

- When removing the feed gear and transport gear, hold one hand under the gear to catch the pin as it falls from the hole in the shaft.

- Rear upper cover (see page 3 "External Covers")
- Feed gear [A] (⌚ x 1, pin x 1, timing belt x 1, bushing x 1)
- Transport gear [B] (⌚ x 1, pin x 1, timing belt x 1, bushing x 1)
- Motor bracket [C] (harness x 5, ⚙ x 4)

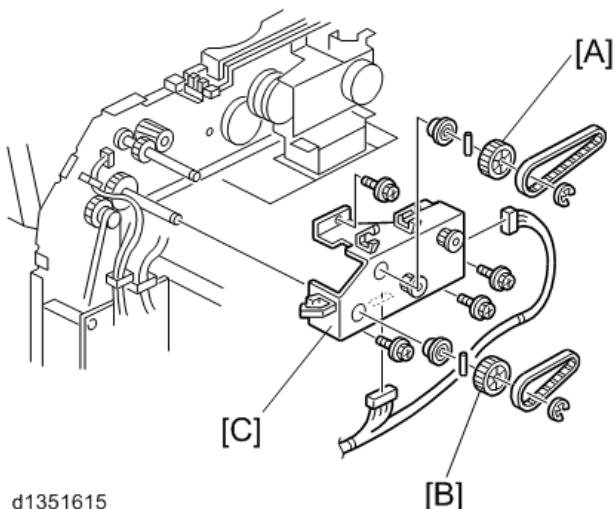

- Feed motor [D] (⌚ x 1, ⚙ x 2)
- Transport motor [E] (⌚ x 1, ⚙ x 2)

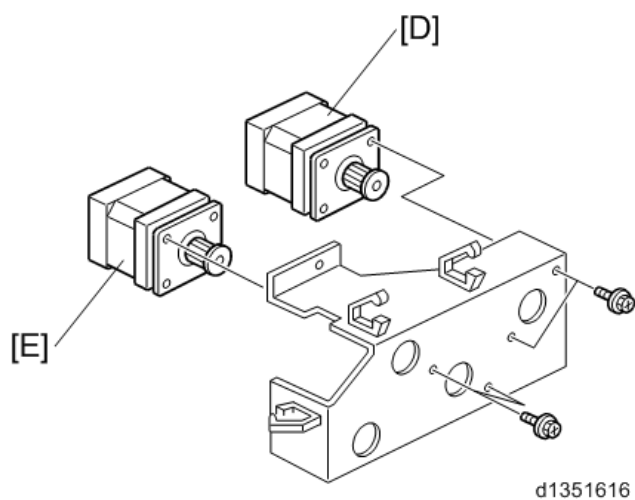

---

MEMO