

Model: Bellini-C3 Multi Bypass Tray (ALEUTIAN-B)		Date: 18-Mar-08	No.: MB833001
Modified Article: Cover: Connecting		Prepared by: S. Ishizu	
From: 2nd Tech. Support Sec. Service Support Dept.			
Reason for Modification:	<input type="checkbox"/> Parts catalog correction <input type="checkbox"/> Vendor change <input checked="" type="checkbox"/> Other <input type="checkbox"/> To facilitate assembly <input type="checkbox"/> To improve reliability <input type="checkbox"/> To meet standards <input type="checkbox"/> Part standardization <input type="checkbox"/> Product Safety ()		

Old part number	New part number	Description	Q'ty	Int	Page	Index	Note
B5121250	B8331250	Cover: Connecting	1	O/O	3	2	

Change: The shape of the cover was changed (the opening in the cover was removed).
Reason: To conform to the design of future models that do not have an ADF.

Model: Bellini-C3 Multi Bypass Tray (ALEUTIAN-B)		Date: 15-May-08	No.: MB833002
Modified Article: Feed Guide Plate		Prepared by: S. Ishizu	
From: 2nd Tech. Support Sec. Service Support Dept.			
Reason for Modification:	<input type="checkbox"/> Parts catalog correction <input type="checkbox"/> Vendor change <input type="checkbox"/> Other <input type="checkbox"/> To facilitate assembly <input checked="" type="checkbox"/> To improve reliability <input type="checkbox"/> To meet standards <input type="checkbox"/> Part standardization <input type="checkbox"/> Product Safety ()		

Old part number	New part number	Description	Int	Page	Index	Note
B8342531	B8332531	Feed Guide Plate	X/O	11	2	

Change: The shape of the guide plate was changed.

Reason: To further improve paper pick-up/paper feed performance.

Model: Bellini-C3 Multi Bypass Tray (ALEUTIAN-B)		Date: 24-Jul-08	No.: MB833003
Modified Article: Stay: Feed: Peen		Prepared by: S. Ishizu	
From: 2nd Tech. Support Sec. Service Support Dept.			
Reason for Modification:	<input type="checkbox"/> Parts catalog correction <input type="checkbox"/> Vendor change <input type="checkbox"/> Other <input type="checkbox"/> To facilitate assembly <input type="checkbox"/> To improve reliability <input type="checkbox"/> To meet standards <input checked="" type="checkbox"/> Part standardization <input type="checkbox"/> Product Safety ()		

Old part number	New part number	Description	Q'ty	Int	Page	Index	Note
B8322571	B8322569	Stay: Feed: Peen	1	O/O	9	2	

Change/ Reason: Parts standardization with the next model.

Model: Bellini-C3 Multi Bypass Tray (ALEUTIAN-B)		Date: 17-Aug-08	No.: MB833004
Modified Article: Paper feed unit		Prepared by: K. Tsutsui	
From: PPBG QA&Service Planning Center			
Reason for Modification:	<input type="checkbox"/> Parts catalog correction <input type="checkbox"/> Vendor change <input checked="" type="checkbox"/> Other <input type="checkbox"/> To facilitate assembly <input type="checkbox"/> To improve reliability <input type="checkbox"/> To meet standards <input type="checkbox"/> Part standardization <input type="checkbox"/> Product Safety ()		

Old part number	New part number	Description	Q'ty	Int	Page	Index	Note
AA100014	D0592620	Retaining Ring C – Separate	2→2	×/O	9	16	
AA100014	D0592620	Retaining Ring C - Separate	1→1	×/O	11	8	
0454006Q		Tapping:Screw:4×6	10→9	×/O	9	101	
	B2342390	Flanged Hexagonal Head Bolt 4×8	0→1	×/O	9	101	

Change: The parts type and the numbers

1. AA100014 → D0592620

These will be replaced on AF030080 (Paper feed roller: Pick up),
 AF031081 (Paper feed roller: Feed: Manualfeed),
 AF032080 (Paper feed roller: Separate)

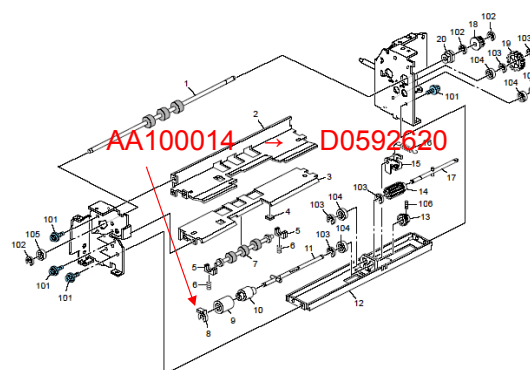
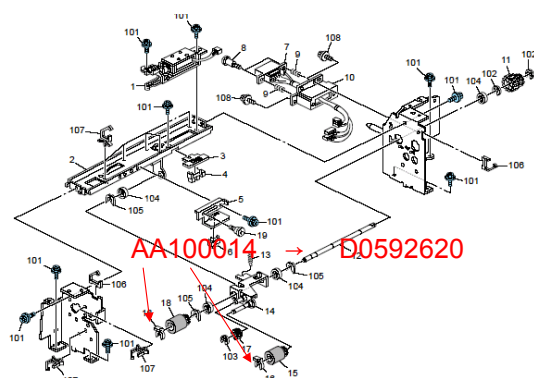

2. One 0454006Q will be replaced by B2342390.

This will be replaced on B8332576 (Paper Feed Sensor Bracket).

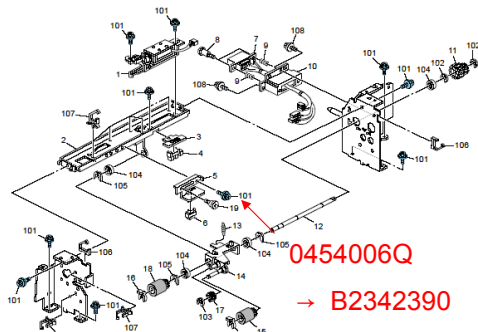

Reason: To enable use of TCRU parts

Model: Bellini-C3 Multi Bypass Tray (ALEUTIAN-B)

Date: 17-Aug-08

No.: MB833004

RCL (Japan) Production

MODEL NAME	V/Hz	DESTINATION	CODE	SERIAL NUMBER
Multi Bypass Tray BY5000	24V(from main frame)	USA	B833-17	L6080800001
Multi Bypass Tray BY5000	24V(from main frame)	EU	B833-26	Undecided

Model: Bellini-C3 Multi Bypass Tray (ALEUTIAN-B)		Date: 17-Feb-09	No.: MB833005
Modified Article: SIDE FENCE:FRONT:ASS'Y		Prepared by: T.Tadokoro	
From: PPBG QA/Service Planning Dept.			
Reason for Modification:	<input type="checkbox"/> Parts catalog correction	<input type="checkbox"/> Vendor change	<input type="checkbox"/> Other
	<input type="checkbox"/> To facilitate assembly	<input checked="" type="checkbox"/> To improve reliability	<input type="checkbox"/> To meet standards
	<input type="checkbox"/> Part standardization	<input type="checkbox"/> Product Safety	()

Old part number	New part number	Description	Q'ty	Int	Page	Index	Note
B8332680	B8332780	SIDE FENCE: FRONT: ASS'Y	1	X/O	4	1	

Change:

The two projections [A] on the front side fence were deleted and the rib on the front side fence was cut 1 mm.

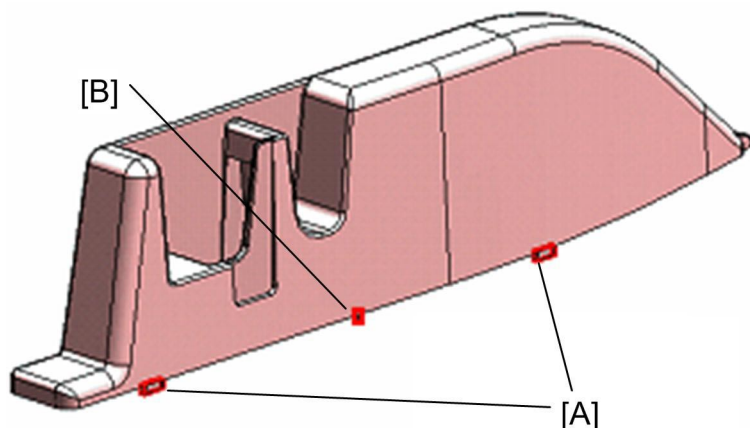

Reason:

To improve the movable range of the side fences.



Part Change Information List

Date: September 30, 2010

Model	Code	PCIL Nr.	PCIL Correction	Old part number	New part number	Description	Old Q'ty	New Q'ty	Int	3DPC	Page	Index	Set	Set Int	RTB	Note	Ref. Nr.	ECN Nr.
Katana-C1 Multi Bypass Tray BY5000	B833	201009		B8332667	B8332767	SHAFT:RISE:PRESS FIT	1	1	O/O		15	4					V1001200	



Part Change Information List

Date: March 31, 2011

Model	Code	PCIL Nr.	PCIL Correcti on	Old part number	New part number	Description	Old Q'ty	New Q'ty	Int	3DPC	Page	Index	Set	Set Int	RTB	Note	Ref. Nr.	ECN Nr.
Katana-C1 Multi Bypass Tray BY5000	B833	201103		B8335170	B8332650	PUSH SWITCH:ASSY		1	1	O/O		7	2	A		RB833001	V1001811	10060629
Katana-C1 Multi Bypass Tray BY5000	B833	201103			B8335314	HARNESS:ASSY			1			7	17			RB833001	V1002777	10060629

RICOH**Part Change Information List**

Date: August 31, 2011

Model	Code	PCIL Nr.	PCIL Correction	Old part number	New part number	Description	Old Q'ty	New Q'ty	Int	3DPC	Page	Index	Set	Set Int	RTB	Note	Ref. Nr.	ECN Nr.
Katana-C1 Multi Bypass Tray BY5000	B833	201108		AW020160	AW020204	PHOTOINTERRUPTOR:LGRC102	4	3	O/O		15	8					V1101261	11060292





Part Change Information List

Date: January 31, 2012

Model	Code	PCIL Nr.	PCIL Correction	Old part number	New part number	Description	Old Q'ty	New Q'ty	Int	3DPC	Page	Index	Set	Set Int	RTB	Note	Ref. Nr.	ECN Nr.
Katana-C1 Multi Bypass Tray BY5000	B833	201112		B8331262	B8331261	COVER:REAR	1	1	X/O		3	8	A		RB833002		V1103279	10080361
Katana-C1 Multi Bypass Tray BY5000	B833	201112		C4165301	B8335311	HARNESS:DRAWER:PLUG:ASS'Y	1	1	X/O		9	7	A		RB833002		V1103279	10080361
Katana-C1 Multi Bypass Tray BY5000	B833	201112		B8332705	B8332702	SIDE PLATE:REAR:DRIVE UNIT	1	1	X/O		15	7	A		RB833002		V1103279	10080361
Katana-C1 Multi Bypass Tray BY5000	B833	201112		AX040123	B8352520	DC MOTOR:RISING TRAY:ASS'Y:1.9W	1	1	X/O		15	15	A		RB833002		V1103279	10080361
Katana-C1 Multi Bypass Tray BY5000	B833	201112		B8335303	B8335313	HARNESS:SENSOR:ASS'Y	1	1	X/O		15	18	A		RB833002		V1103279	10080361
Katana-C1 Multi Bypass Tray BY5000	B833	201112			B8332704	BRACKET:RISING TRAY:PAPER FEED	0	1			15	19	A		RB833002		V1103279	10080361



Part Change Information List

Date: February 28, 2013

Model	Code	PCIL Number	PCIL Correction	Old part number	New part number	Description	Old Q'ty	New Q'ty	Int	3DPC	Page	Index	Set	Set Int	RTB	Note	Ref Number	ECN Number
Katana-C1 Multi Bypass Tray BY5000	B833	201302		B8322569	B8322579	STAY:FEED:PEEN	1	1	O/O		9	2					V1300088	12101816



Part Change Information List

Date: April 26, 2013

Model	Code	PCIL Number	PCIL Correction	Old part number	New part number	Description	Old Q'ty	New Q'ty	Int	3DPC	Page	Index	Set	Set Int	RTB	Note	Ref Number	ECN Number
Katana-C1 Multi Bypass Tray BY5000	B833	201304		B8332629	B8332639	SHAFT:FEED ROLLER	1	1	O/O		9	12					V1001066	10010634



Part Change Information List

Date: June 28, 2013

Model	Code	PCIL Number	PCIL Correction	Old part number	New part number	Description	Old Q'ty	New Q'ty	Int	3DPC	Page	Index	Set	Set Int	RTB	Note	Ref Number	ECN Number
Katana-C1 Multi Bypass Tray BY5000	B833	201306		B8335170	B8332650	PUSH SWITCH:ASS'Y	1	1	O/O		7	2	A		RB833001		V1300439	



Part Change Information List

Date: January 31, 2014

Model	Code	PCIL Number	PCIL Correction	Old part number	New part number	Description	Old Q'ty	New Q'ty	Int	3DPC	Page	Index	Set	Set Int	RTB	Note	Ref Number	ECN Number
Katana-C1 Multi Bypass Tray BY5000	B833	201401		B8355130	D7125130	PRINTED CIRCUIT BOARD:PAPER SIZE SENSOR:ASSY	1	1	O/O		5	10					V1301947	12090603



Part Change Information List

Date: May 12, 2017

Model	Code	PCIL Number	PCIL Correction	Old part number	New part number	Description	Old Q'ty	New Q'ty	Int	3DPC	Page	Index	Set	Set Int	RTB	Note	Ref Number	ECN Number
Katana-C1 Multi Bypass Tray BY5000	B833	201704		B8332671	B8332771	LEVER:RISE:TRAY BOTTOM PLATE	1	1	O/O	N	15	3					V1001066	10010634



Part Change Information List

Date: October 2, 2017

Model	Code	PCIL Number	PCIL Correction	Old part number	New part number	Description	Old Q'ty	New Q'ty	Int	3DPC	Page	Index	Set	Set Int	RTB	Note	Ref Number	ECN Number
Katana-C1 Multi Bypass Tray BY5000	B833	201709		B8322579	D7322579	STAY:FEED:PEEN	1	1	O/O	N	9	2					V1701414	