

**Bridge Unit BU3050
Machine Code: D584
Field Service Manual**

July, 2011
Subject to change

Safety and Symbols

Replacement Procedure Safety

CAUTION

- Turn off the main power switch and unplug the machine before beginning any of the replacement procedures in this manual.

When taking apart the bridge unit, first take the unit out of the copier.

Symbols Used in this Manual

This manual uses the following symbols.

 : See or Refer to

 : Screws

 : Connector

 : Clip ring

 : E-ring

TABLE OF CONTENTS

Safety and Symbols.....	1
Replacement Procedure Safety.....	1
1. Replacement and Adjustment	
Bridge Unit Control Board.....	3
Bridge Unit Drive Motor.....	4
Tray Exit Sensor.....	5
Relay Sensor.....	6
INDEX	7

1. Replacement and Adjustment

Bridge Unit Control Board

1

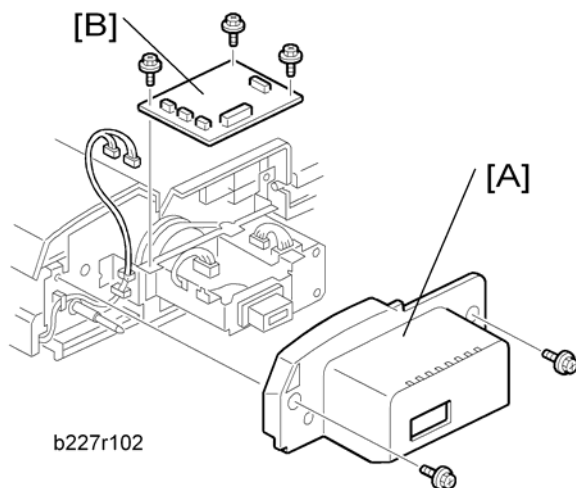

1. Bridge unit (👉 "Installation Procedure" in the base copier manual)
2. Rear cover [A] (🔩 x 2)
3. Bridge unit control board [B] (🔩 x 3, 📦 x 3)

Bridge Unit Drive Motor

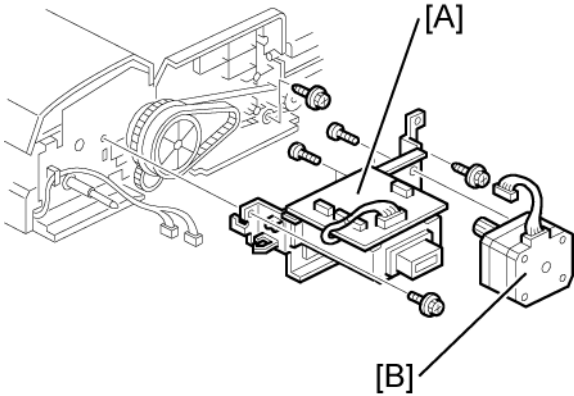

d584r100

1. Bridge unit (🔧 "Installation Procedure" in the base copier manual)
2. Rear cover (🔧 p.3 "Bridge Unit Control Board")
3. Bracket [A] (🔧 x 3, 📦 x 1)
4. Bridge unit drive motor [B] (🔧 x 2, 📦 x 1)

Tray Exit Sensor

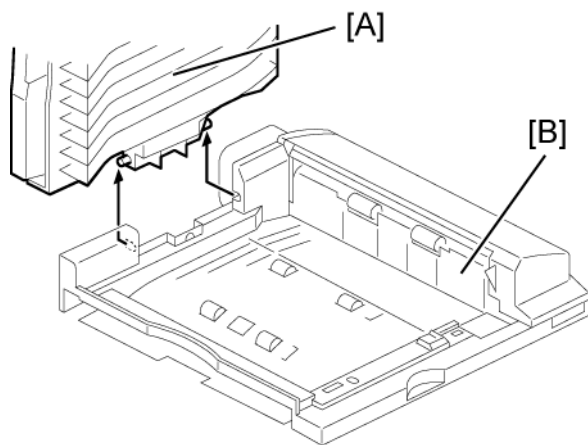

d584r103

1. Bridge unit (🔧 "Installation Procedure" in the base copier manual)
2. Rear cover (🔧 p.3 "Bridge Unit Control Board")
3. Paper tray [A]
4. Exit guide [B] (🔧 x 1)

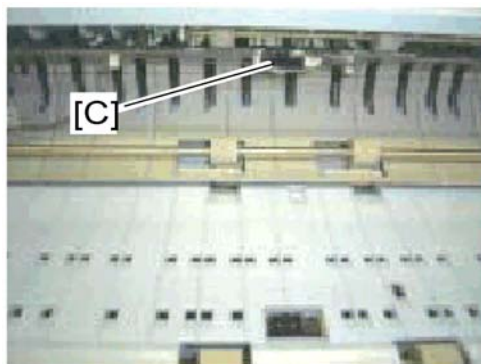

b227r503

5. Tray exit sensor [C] (🔧 x 1)

Relay Sensor

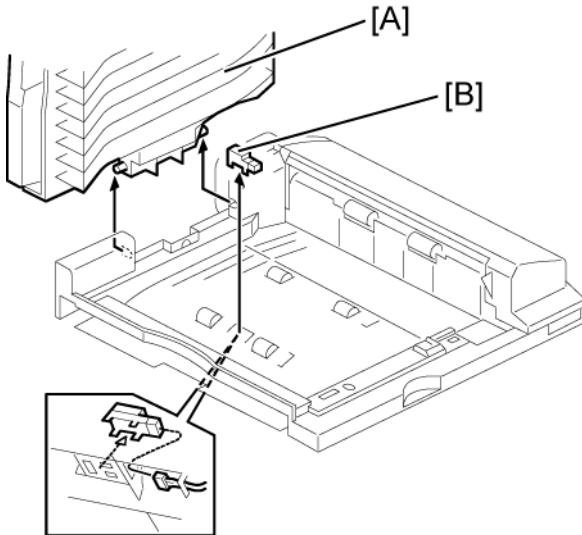

d584r101

1. Bridge unit (🔧 "Installation Procedure" in the base copier manual)
2. Paper tray [A]
3. Relay sensor [B] (🔧 x 1)

INDEX

B

Bridge Unit Control Board.....3

Bridge Unit Drive Motor.....4

R

Relay Sensor.....6

Replacement Procedure Safety..... 1

S

Safety and Symbols..... 1

T

Tray Exit Sensor.....5

MEMO