

BRIDGE UNIT

(Machine Code: A688)

1. OVERALL MACHINE INFORMATION

1.1 SPECIFICATIONS

Paper Size:	Standard sizes
	A6 lengthwise to A3
	HLT to DLT
	Non-standard sizes
Paper Weight:	Width: 100 to 305 mm
	Length: 148 to 432 mm
	52 g/m ² ~ 135 g/m ² , 16 lb ~ 42 lb

1.2 MECHANICAL COMPONENT LAYOUT

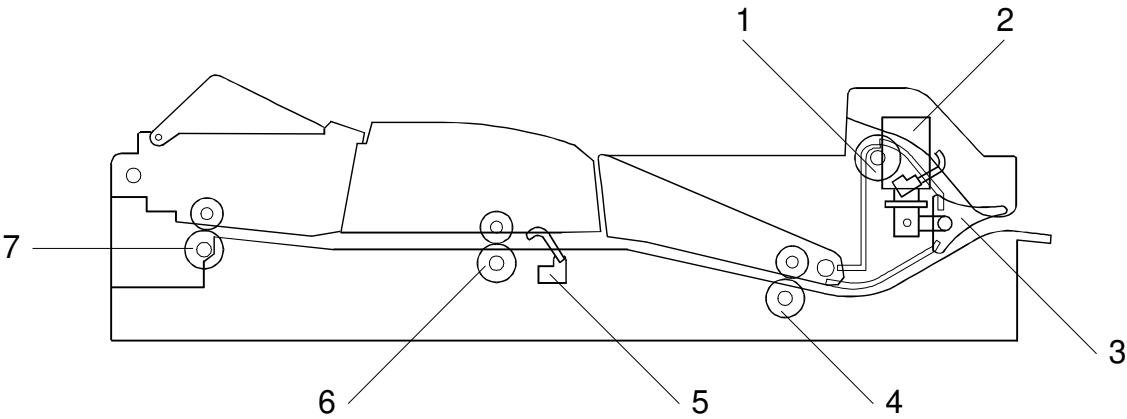

A688V500.WMF

- | | |
|---------------------------|-------------------------|
| 1. Upper Exit Roller | 5. Relay Sensor |
| 2. Junction Gate Solenoid | 6. 2nd Transport Roller |
| 3. Junction Gate | 7. Left Exit Roller |
| 4. 1st Transport Roller | |

1.3 ELECTRICAL COMPONENT LAYOUT

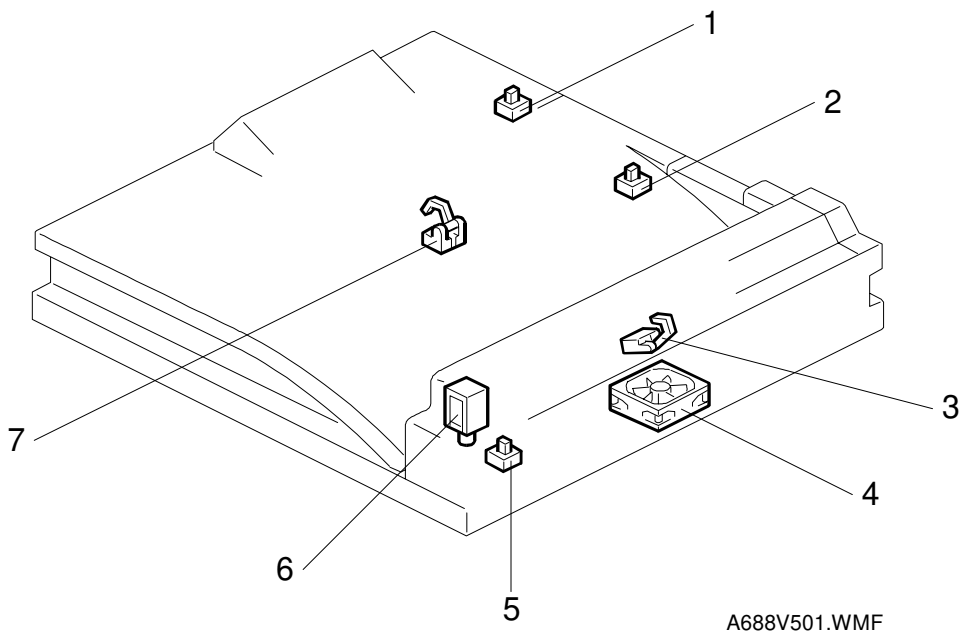

1. Left Guide Switch

2. Right Guide Switch

3. Tray Exit Sensor

4. Cooling Fan Motor
5. Tray Exit Unit Switch

6. Junction Gate Solenoid

7. Relay Sensor

1.4 ELECTRICAL COMPONENT DESCRIPTION

Symbol	Name	Function	Index No.
Motors			
M1	Cooling Fan	Cools the transport unit.	4
Sensors			
S1	Tray Exit	Checks for misfeeds.	3
S2	Relay	Checks for misfeeds.	7
Switches			
SW1	Tray Exit Unit	Detects when the tray exit unit is opened.	5
SW2	Right Guide	Detects when the right guide is opened.	2
SW3	Left Guide	Detects when the left guide is opened.	1
Solenoids			
SOL1	Junction Gate	Moves the junction gate to direct the paper to the upper or left tray.	6

Options

1.5 DRIVE LAYOUT

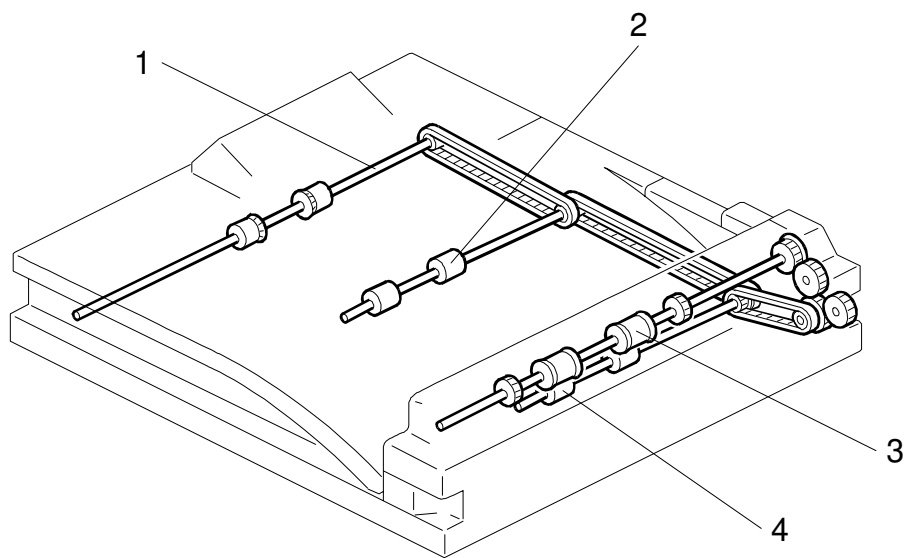

A688V502.WMF

- | | |
|-------------------------|-------------------------|
| 1. Left Exit Roller | 3. Upper Exit Roller |
| 2. 2nd Transport Roller | 4. 1st Transport Roller |

2. DETAILED DESCRIPTION

2.1 JUNCTION GATE MECHANISM

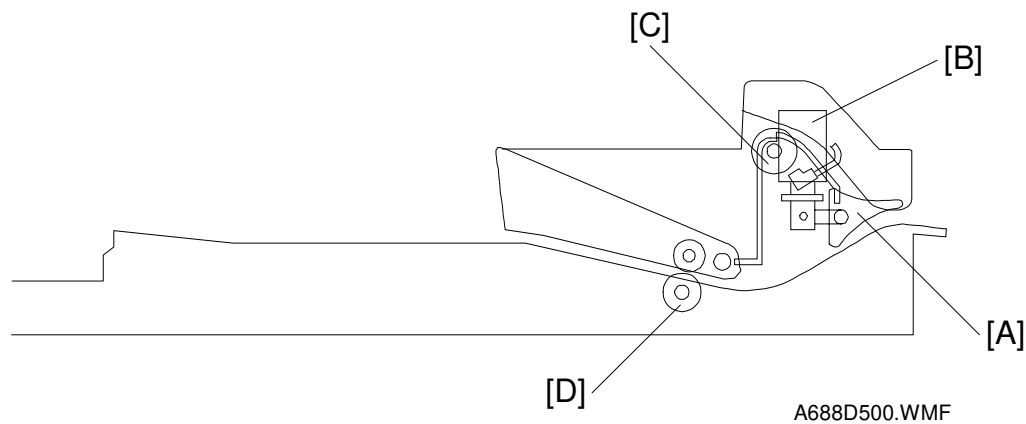

Depending on the selected mode, the copies are directed up or down by the junction gate [A], which is controlled by the junction gate solenoid [B].

When the upper tray is selected, the junction gate solenoid turns on and the paper is sent to the upper tray through the upper exit roller [C].

When the left tray or the finisher is selected, the junction gate stays off and the paper is sent to the left tray or the finisher through the transport rollers [D] and the left exit roller.

3. REPLACEMENT AND ADJUSTMENT

3.1 EXIT SENSOR REPLACEMENT

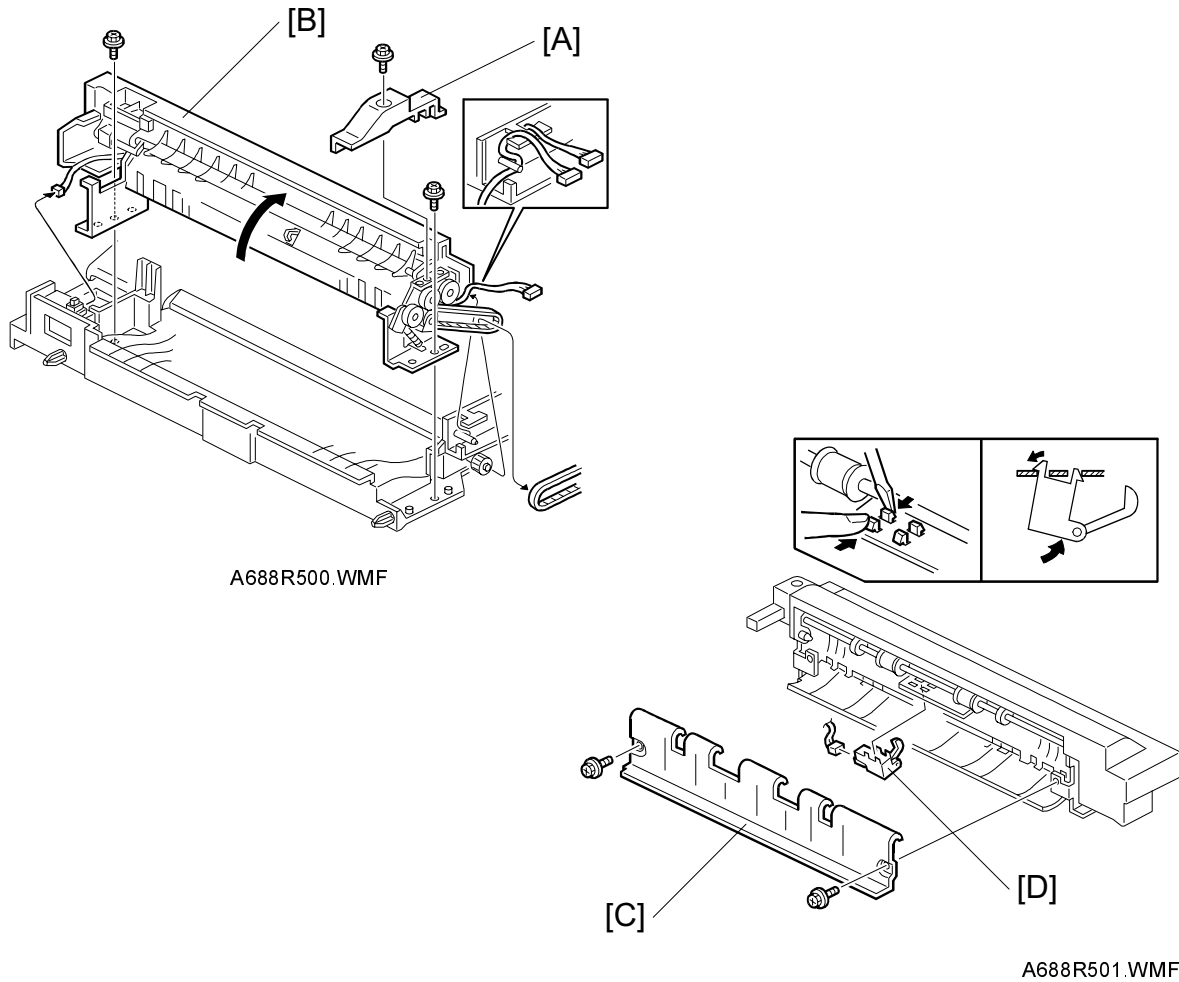

1. Remove the whole unit from the copier.
2. Remove the rear upper cover [A] (1 screw).
3. Remove the upper cover unit [B] (2 screws, 2 connectors).
4. Remove the exit guide plate [C] (2 screws).
5. Replace the exit sensor [D] (1 connector).