

Reissued:23-Apr-09

Model: PR-C1(1-Bin Tray BN3020)	Date: 1-Apr-09	No.: RD010020a
---------------------------------	----------------	----------------

RTB Reissue

The items in ***bold italics*** were corrected or added.

Subject: Guide: Tray: 1-Bin		Prepared by: M. Ishihara	
From: 1st Tech. Support Sec. Service Support Dept.			
Classification:	<input type="checkbox"/> Troubleshooting <input type="checkbox"/> Mechanical <input type="checkbox"/> Paper path <input type="checkbox"/> Product Safety	<input checked="" type="checkbox"/> Part information <input type="checkbox"/> Electrical <input type="checkbox"/> Transmit/receive <input type="checkbox"/> Other ()	<input type="checkbox"/> Action required <input type="checkbox"/> Service manual revision <input type="checkbox"/> Retrofit information <input type="checkbox"/> Tier 2

Old P/N	New P/N	Description	Q'ty	Int	Page	Index	Note
-	D3394451	Guide: Tray: 1-Bin	0-2	-	3	38	New Index
-	D3394452	Guide: 1-Bin	0-1	-	3	39	New Index

Change:

- 1) Two guides (D3394451) were added to the exit tray.
- 2) A guide (D3394452) was added to the lower frame.

Reason: To further minimize exit jams caused by paper curl.

Note: *This modification has been applied to the October 2007 production machines onward. (Machine serial No. M40782xxxxx -)*

The material of those guides is transparent Mylar.

D3394451

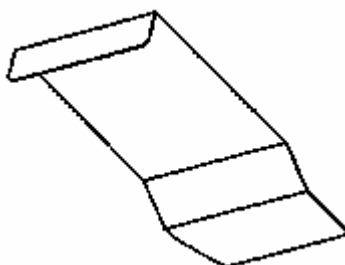

D3394452

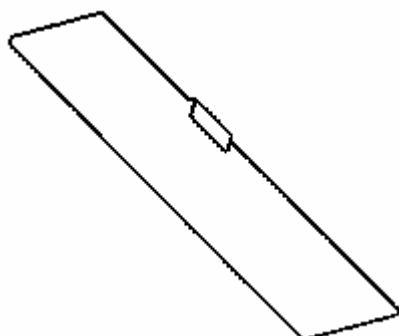

Reissued:23-Apr-09

Model: PR-C1(1-Bin Tray BN3020)

Date: 1-Apr-09

No.: RD010020a

P/N D3394451

Note: *The two guides are attached to the underside of the exit tray using double-sided tape.*

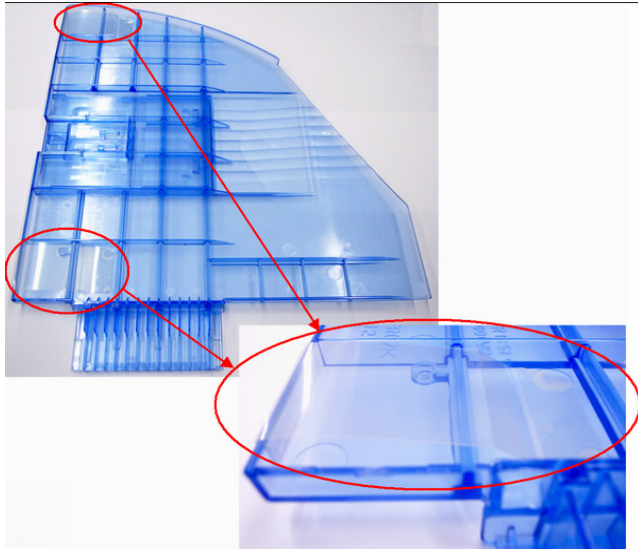
**P/N D3394452**

Note: *This guide is attached to the underside of the lower frame using double-sided tape.*

