

Model: R-C5 Duplex Unit		Date: 3-Jul-09	No.: RD369001
Subject: Parts Catalog Correction		Prepared by: S. Tomoe	
From: 2nd Tech Support Sec. Service Support Dept.			
Classification:	<input type="checkbox"/> Troubleshooting <input type="checkbox"/> Mechanical <input type="checkbox"/> Paper path <input type="checkbox"/> Product Safety	<input checked="" type="checkbox"/> Part information <input type="checkbox"/> Electrical <input type="checkbox"/> Transmit/receive <input type="checkbox"/> Other ()	<input type="checkbox"/> Action required <input type="checkbox"/> Service manual revision <input type="checkbox"/> Retrofit information <input type="checkbox"/> Tier 2

The Parts Catalog was corrected as follows:

Old part number	New part number	Description	Q'ty	Int	Page	Index	Note
	D3694674	Seal:Duplex:3X7X300	0-1		7	23	

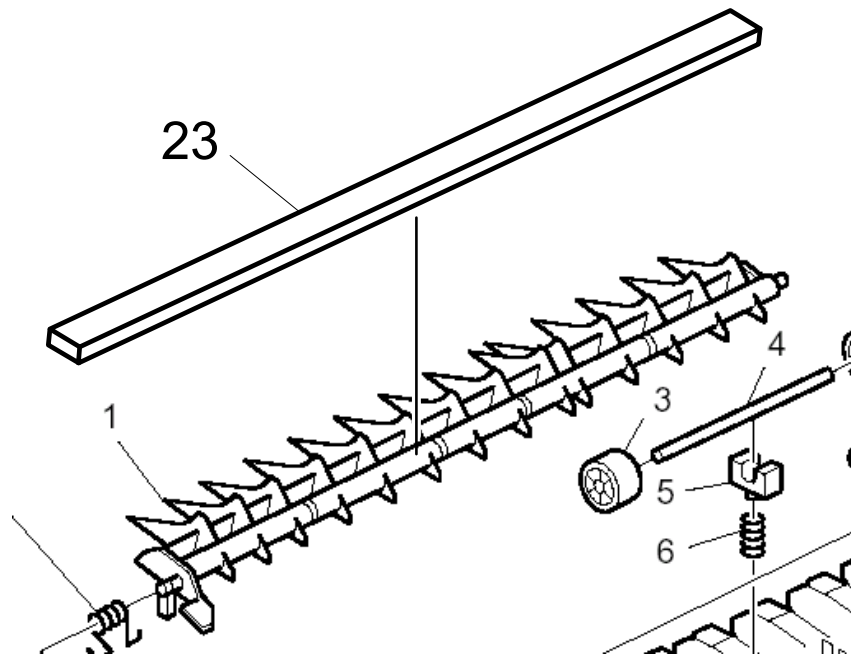

Model: R – C5 Duplex Unit		Date: 14-Jun-10	No.: RD369002
Subject: Guide Plate		Prepared by: T. Nihei	
From: 1st Overseas Tech Support Sec., 1st PQM Dept.			
Classification:	<input checked="" type="checkbox"/> Troubleshooting <input type="checkbox"/> Part information <input type="checkbox"/> Action required <input type="checkbox"/> Mechanical <input type="checkbox"/> Electrical <input type="checkbox"/> Service manual revision <input type="checkbox"/> Paper path <input type="checkbox"/> Transmit/receive <input type="checkbox"/> Retrofit information <input type="checkbox"/> Product Safety <input type="checkbox"/> Other ()		

Old part number	New part number	Description	Q'ty	Int	Page	Index	Note
D3694663	D3694677	GUIDE PLATE - OPEN/CLOSE	1-1	X/O	7	22	

Change: The shape of the guide plate was changed.

Reason: To ensure that the separation guide plate does not interfere with the movement of the fusing pressure release lever.

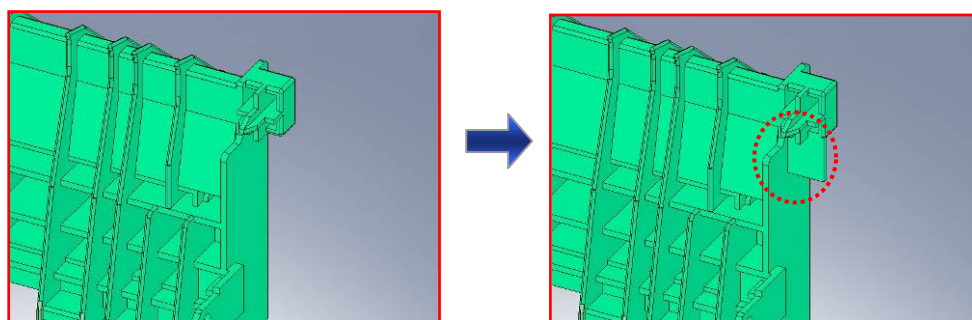

Before

After

Cut-in S/N:

Model code	Serial No.
D369-17	M7001300301~

Model: R-C5/5.5 Duplex Unit		Date: 16-Sept-10	No.: RD369003
Subject: Part Number Correction		Prepared by: T. Nihei	
From: 1st Overseas Tech Support Sec., 1st PQM Dept.			
Classification:	<input type="checkbox"/> Troubleshooting <input type="checkbox"/> Mechanical <input type="checkbox"/> Paper path <input type="checkbox"/> Product Safety	<input checked="" type="checkbox"/> Part information <input type="checkbox"/> Electrical <input type="checkbox"/> Transmit/receive <input type="checkbox"/> Other ()	<input type="checkbox"/> Action required <input type="checkbox"/> Service manual revision <input type="checkbox"/> Retrofit information <input type="checkbox"/> Tier 2

Please apply the following change to your Parts Catalogs.

Incorrect part number	Correct part number	Description	Q'ty	Int	Page	Index	Note
B0902622	08050097	RING SEPARATOR			3	7	

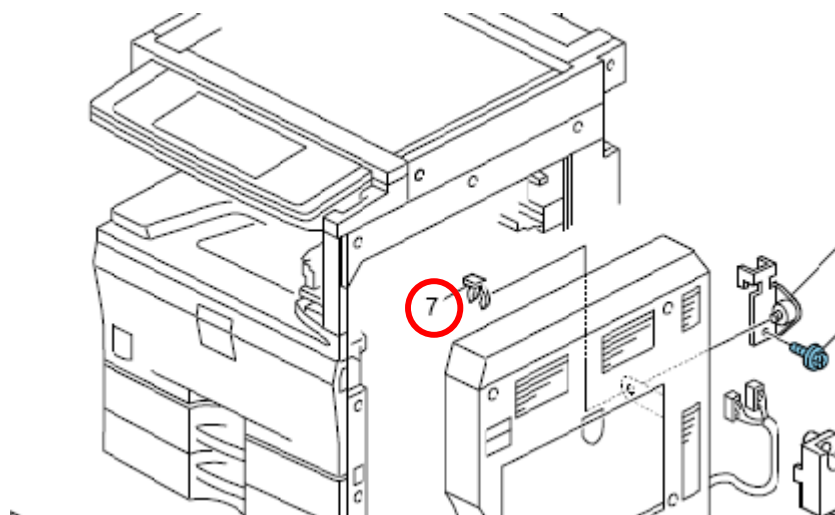

Model: R-C5 Duplex Unit		Date: 09-Jul-12	No.: RD369004
Subject: Guide Plate & Lower Gate Pawl broken		Prepared by: T. Nihei	
From: 2nd Tech Service Sect., MFP/P Tech Service Dept.			
Classification:	<input checked="" type="checkbox"/> Troubleshooting <input type="checkbox"/> Mechanical <input type="checkbox"/> Paper path <input type="checkbox"/> Product Safety	<input type="checkbox"/> Part information <input type="checkbox"/> Electrical <input type="checkbox"/> Transmit/receive <input type="checkbox"/> Other ()	<input type="checkbox"/> Action required <input type="checkbox"/> Service manual revision <input type="checkbox"/> Retrofit information <input checked="" type="checkbox"/> Tier 2

SYMPTOM

The guide plate and/or lower gate pawl may be damaged when the duplex unit is closed.

CAUSE

Sometimes, the fusing lever gets positioned under the guide plate, which causes the lower gate pawl to press against the fusing lever.

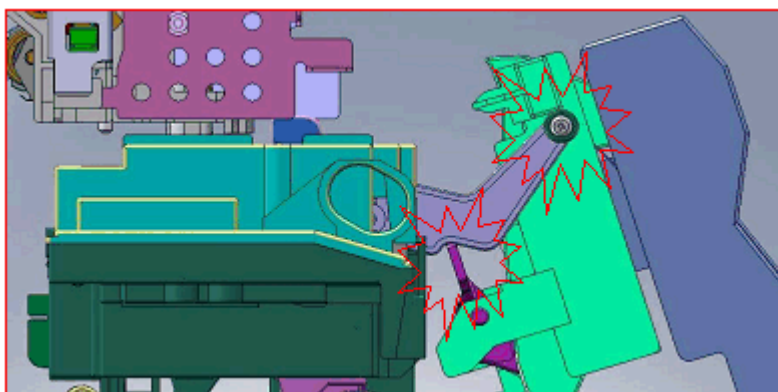

SOLUTION

Replace the guide plate with the modified part shown below.

Note:

- The shape of the guide plate was changed to ensure that the fusing lever cannot be positioned under the guide plate.
- See RTB #RD369002 for detailed parts information.

New part number	Description	Page	Index	Note
D3694677	GUIDE PLATE - OPEN/CLOSE	7	22	

Model: R-C5 Duplex Unit		Date: 26-Apr-13	No.: RD369005
Subject: Parts Catalog Correction (Spring, Harness, Screw)		Prepared by: T. Nihei	
From: 2nd Tech Service Sect., MFP/P Tech Service Dept.			
Classification:	<input type="checkbox"/> Troubleshooting <input type="checkbox"/> Mechanical <input type="checkbox"/> Paper path <input type="checkbox"/> Product Safety	<input checked="" type="checkbox"/> Part information <input type="checkbox"/> Electrical <input type="checkbox"/> Transmit/receive <input type="checkbox"/> Other ()	<input type="checkbox"/> Action required <input type="checkbox"/> Service manual revision <input type="checkbox"/> Retrofit information <input type="checkbox"/> Tier 2

Part number	Description	Q'ty	Int	Page	Index	Note
D3694689	TENSION SPRING:LINK:52N	1	-	13	14	
D3694766	SCREW:DIA5:HINGE	1	-	13	15	
D3695276	HARNESS:DUPLEX:STM	1	-	13	16	

Change/Reason: These parts were missing from the parts catalog.

