

MODIFICATION BULLETIN NO. BRO-001ISSUED ON Jan. 31, 1996

Model	<b>Fax170 / 180 ( China )</b>					Date of Modification	
Modified Article	FCU					<b>Execution Date</b>	
Reason for Modification	<input type="checkbox"/> Parts catalog correction <input type="checkbox"/> To meet standards (      ) <input type="checkbox"/> To facilitate assembly <input type="checkbox"/> Vender change <input type="checkbox"/> Part standardization <input checked="" type="checkbox"/> To improve reliability <input type="checkbox"/> Other					From October production in 1995.	

Old Part No.	New Part No.	Description	Q'ty Used Old → New	Interchange- ability	Remarks	Parts Catalog	
						Index No.	Page
H068 6001N	H068 6001P	PCB - FCU: CHINA	1 → 1	X / O		5	8
H068 7201D	H068 7201E	IC-Programmed ROM	( 1 → 1 )	( X / O )			

M. Iwasa  
 Manager  
 Quality Assurance Center

**MODIFICATION BULLETIN NO. BRO-002**ISSUED ON Feb. 29, 1996

Model	<b>BRO / BR1 for Asia</b>	Date of Modification
Modified Article	Operation Panel Ass'y	<b>Execution Date</b>
Reason for Modification	<div> <input type="checkbox"/> Parts catalog correction <input type="checkbox"/> Vender change <input checked="" type="checkbox"/> To meet standards ( ITU-T ) <input type="checkbox"/> Part standardization <input type="checkbox"/> To facilitate assembly <input type="checkbox"/> To improve reliability <input type="checkbox"/> Other </div> <p>Letters have been printed on the ten-key pads for Singapore.</p>	February production in 1996.

Old Part No.	New Part No.	Description	Q'ty Used Old → New	Interchange- ability	Remarks	Parts Catalog	
						Index No.	Page
H068 5412B	H068 5412C	Operation Panel Ass'y: BRO Asia	1 → 1	O / O ←	(Except Singapore)	40	1-3
H068 5415B	H068 5415C	Operation Panel Ass'y: BRO GES	1 → 1	O / O ←	(Except Singapore)	40	1-3
H069 5411B	H069 5411C	Operation Panel Ass'y: BR1 Asia	1 → 1	O / O ←	(Except Singapore)	40	1-3

M. Iwasa  
Manager  
Quality Assurance Center

MODIFICATION BULLETIN NO. BRO-003ISSUED ON Feb. 29, 1996

Model	<b>BRO/BR1</b>						Date of Modification		
Modified Article	ROM						<b>Execution Date</b>		
Reason for Modification	<input type="checkbox"/> Parts catalog correction <input type="checkbox"/> To meet standards (      ) <input type="checkbox"/> To facilitate assembly <input type="checkbox"/> Vender change <input type="checkbox"/> Part standardization <input checked="" type="checkbox"/> To improve reliability <input type="checkbox"/> Other						From April production in 1996.		
		See RTB BRO-005.							

Old Part No.	New Part No.	Description	Q'ty Used Old → New	Interchange- ability	Remarks	Parts Catalog	
						Index No.	Page
H068 6000R	H068 6000S	PCB-FCU - Asia	1 → 1	X / O	BRO	5	1-8
H068 7200F	H068 7200G	Programmed ROM	( 1 → 1 )	( X / O )			
H068 6001P	H068 6001Q	PCB-FCU - China	1 → 1	X / O	BRO	5	1-8
H068 7201E	H068 7201F	Programmed ROM	( 1 → 1 )	( X / O )			
H068 6080C	H068 6080D	PCB-FCU - US	1 → 1	X / O	BRO	5	1-8
H068 7200F	H068 7200G	Programmed ROM	( 1 → 1 )	( X / O )			
H069 6000N	H069 6000P	PCB-FCU - Asia	1 → 1	X / O	BR1	5	1-8
H069 7200D	H069 7200E	Programmed ROM	( 1 → 1 )	( X / O )			
H069 6001N	H069 6001P	PCB-FCU - China	1 → 1	X / O	BR1	5	1-8
H069 7211B	H069 7211C	Programmed ROM	( 1 → 1 )	( X / O )			

M. Iwasa  
 Manager  
 Quality Assurance Center

**MODIFICATION BULLETIN NO.BRO - 004**

RE-ISSUED ON 31.Jul.1996

Model	<b>BRO / BR1</b>		Modification Schedule
Modified Article	ADF		After the old part will no longer be in stock.
Reason for Modification	<div> <input type="checkbox"/> Parts catalog correction             <input type="checkbox"/> To meet standards ( )             <input type="checkbox"/> To facilitate assembly           </div> <div> <input type="checkbox"/> Vender change             <input type="checkbox"/> Part standardization             <input checked="" type="checkbox"/> To improve reliability           </div> <div> <input type="checkbox"/> Other         </div> <p>This change has been implemented for the Japanese market to improve the feeding of thin documents.</p> <p>(Sensor) (Spring)</p> <p>S1 H0681512 → H0681515 (O / O) * *: ① Strength of the spring has been changed</p> <p>S2 H0681512 → H0681512 (NO Change) ② H0681515 cannot be used for S2.</p> <p>S3 H0681512 → H0681515 (O / O) *</p>		

Old Part No.	New Part No.	Description	Q'ty Used Old → New	Interchange-ability	Remarks	Parts Catalog	
						Index No.	Page
H0681512		Spring - S2	3 → 1			2	3
	H0681515	Spring - S1 / S3	0 → 2				

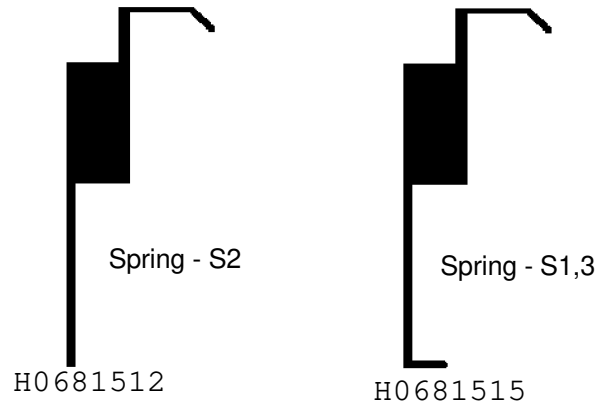

S.Fujii  
General Manager  
2nd Field Information Department  
QA Division

Prepared by Y.Okunishi

RC	RE	ASIA	
*	*	*	

MODIFICATION BULLETIN NO. BRO - 005ISSUED ON 31.Jul,1996

<b>Model</b>	<b>BRO / BR1 (Except China)</b>					<b>Modification Schedule</b>	
<b>Modified Article</b>	Exterior					After the old parts are out of stock.	
<b>Reason for Modification</b>	<input type="checkbox"/> Parts catalog correction <input type="checkbox"/> To meet standards (      ) <input type="checkbox"/> To facilitate assembly <input type="checkbox"/> Vender change <input type="checkbox"/> Part standardization <input checked="" type="checkbox"/> To improve reliability <input type="checkbox"/> Other						
To prevent deformation of the Exit Guide.							

Old Part No.	New Part No.	Description	Q'ty Used Old → New	Interchange- ability	Remarks	Parts Catalog	
						Index No.	Page
H0682137	H0682141	Exit Guide	1	O / O	In combination	45	4
	H0682142	Bracket - Exit Guide - LEFT	1			X	
	H0682143	Bracket - Exit Guide - RIGHT	1			Y	

S. Fujii  
 General Manager  
 2nd Field Information Department  
 QA Division

Prepared by Y.Okunishi

RC	RE	ASIA	
----	----	------	--

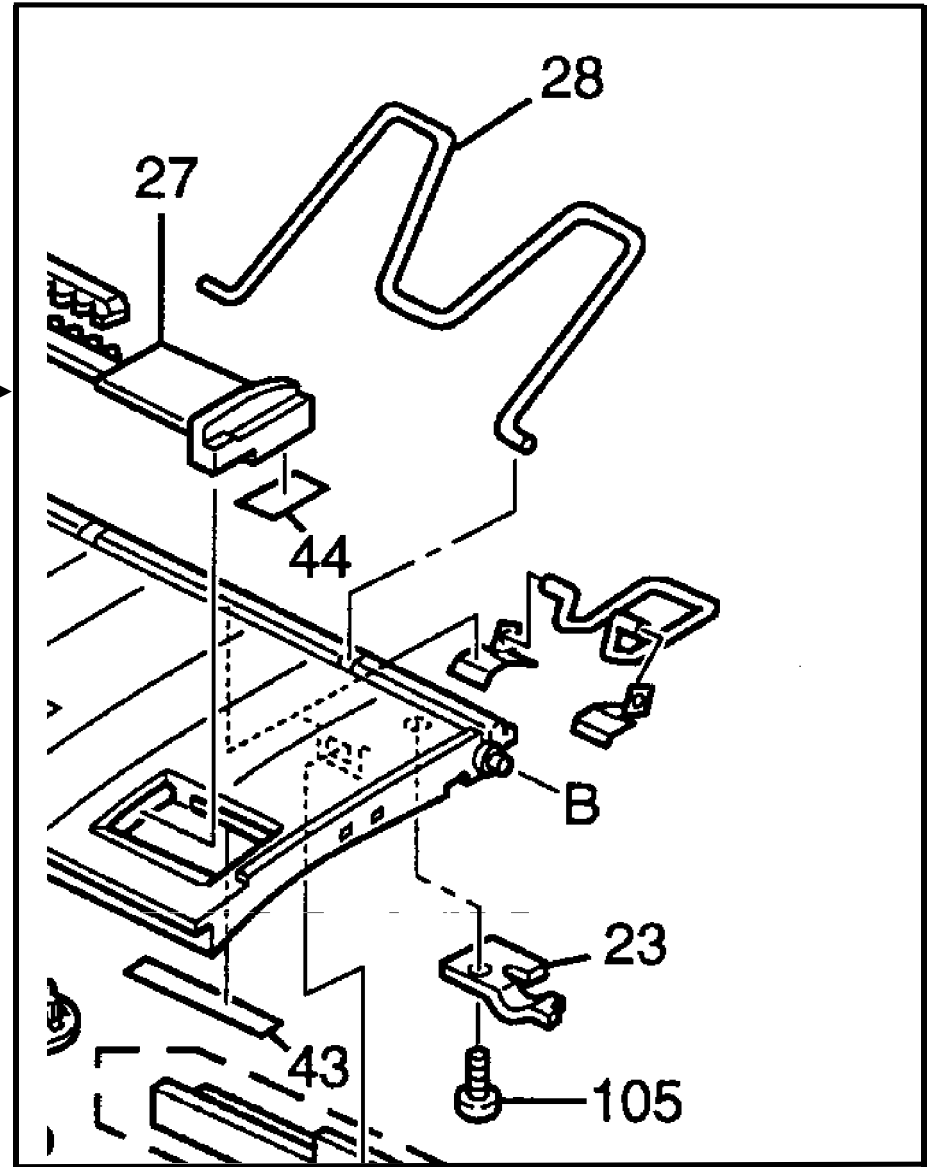
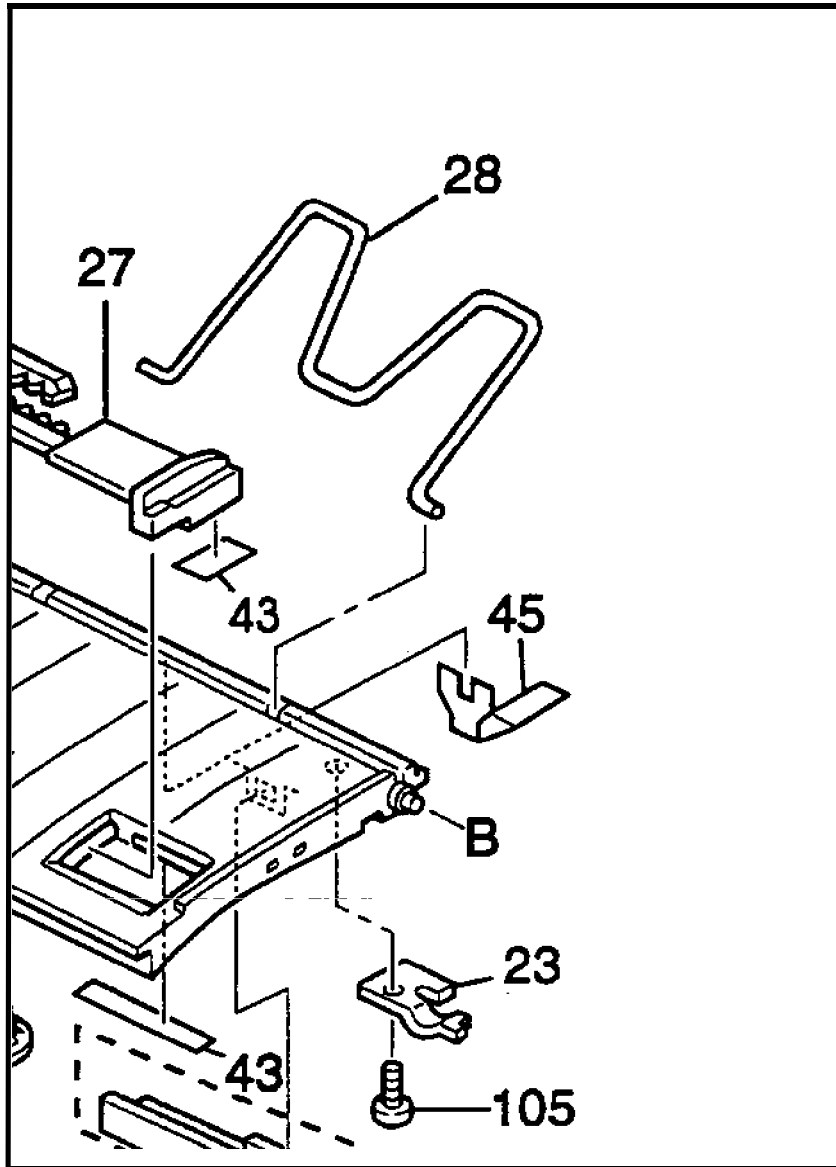

**MODIFICATION BULLETIN NO. BRO - 006**

ISSUED ON 30,Jun.1996

Model	<b>FAX188</b>					Modification Schedule	
Modified Article	PCB - FCU						
Reason for Modification	<div> <input type="checkbox"/> Parts catalog correction             <input type="checkbox"/> To meet standards ( )             <input type="checkbox"/> To facilitate assembly         </div> <div> <input type="checkbox"/> Vender change             <input type="checkbox"/> Part standardization             <input checked="" type="checkbox"/> To improve reliability         </div> <div> <input type="checkbox"/> Other         </div> <div> <p>Software Change See the RTB that will be issued soon.</p> </div>					June production in 1996.	
Old Part No.	New Part No.	Description	Q'ty Used Old → New	Interchange- ability	Remarks	Parts Catalog	
						Index No.	Page
H0686001Q	H0686001R	PCB - FCU	1 → 1	O / O		5	8
H0687201F	H0687201G	IC - ROM BRO	1 → 1	O / O			
<div>S.Fujii General Manager 2nd Field Infomation Deptment. QA Division.</div>							

MODIFICATION BULLETIN NO. BRO - 007ISSUED ON 31.Jul,1996

Model	<b>BRO / BR1</b>		Modification Schedule
Modified Article	FCU		From June 1996
Reason for Modification	<input type="checkbox"/> Parts catalog correction <input type="checkbox"/> To meet standards (      ) <input type="checkbox"/> To facilitate assembly <input type="checkbox"/> Vender change <input type="checkbox"/> Part standardization <input checked="" type="checkbox"/> To improve reliability <input type="checkbox"/> Other		
<p>See RTB BRO - 005A which will be issued later</p> <p><b>Note:</b> After the older ROM is changed to the new ROM in the field,  please reset the RAM (level 0 or 1) or change the NCU country code to another  code then change back to the proper country code to avoid a malfunction.</p>			

Old Part No.	New Part No.	Description	Q'ty Used Old → New	Interchange- ability	Remarks	Parts Catalog	
						Index No.	Page
H0686000S	H0686000T	PCB - FCU - BRO - Asia	1 - 1	O / O		5	7
H0687200G	H0687200H	Programmed ROM	(1 - 1)	(O / O)			
H0686080D	H0686080E	PCB - FCU - BRO - US	1 - 1	O / O		5	7
H0687200G	H0687200H	Programmed ROM	(1 - 1)	(O / O)			
H0696000P	H0696000Q	PCB - FCU - BR1 - Asia	1 - 1	O / O		5	7
H0697200E	H0697200F	Programmed ROM	(1 - 1)	(O / O)			

S.Fujii  
General Manager  
2nd Field Information Department  
QA Division

Prepared by Y.Okunishi

RC	RE	ASIA	
*	*	*	



**MODIFICATION BULLETIN NO. BRO - 008**

ISSUED ON 31.Jul,1996

Model	<b>BRO, BR1, (ASIA, China)</b>			Modification Schedule	
Modified Article	PSU			After the old part is out of stock.	
Reason for Modification	<input type="checkbox"/> Parts catalog correction <input type="checkbox"/> To meet standards (      ) <input type="checkbox"/> To facilitate assembly <input type="checkbox"/> Vender change <input checked="" type="checkbox"/> Part standardization <input type="checkbox"/> To improve reliability <input type="checkbox"/> Other				

Old Part No.	New Part No.	Description	Q'ty Used Old → New	Interchange- ability	Remarks	Parts Catalog	
						Index No.	Page
H0685001	H0685003	PCB - PSU - 220V	1 - 1	O / O		6	7

RC	RE	ASIA	
	*	*	

S.Fujii  
 General Manager  
 2nd Field Infomation Department  
 QA Division

MODIFICATION BULLETIN NO.BRO - 009ISSUED ON Aug. 15.1996

Model	BRO, BR1			Modification Schedule
Modified Article	Printer Cover			From April, 1996
Reason for Modification	<div><div><input checked="" type="checkbox"/> Parts catalog correction</div><div><input type="checkbox"/> Vender change</div><div><input type="checkbox"/> To meet standards (</div><div><input type="checkbox"/> Part standardization</div><div>)</div><div><input type="checkbox"/> To facilitate assembly</div><div><input checked="" type="checkbox"/> To improve reliability</div><div><input type="checkbox"/> Other</div></div> <p><b>Problem :</b> The printer cover catch (Stopper - Printer Cover) becomes detached from the printer cover. (The user pushes the Stopper in the opposite direction.)</p> <p><b>Countermeasuue :</b> ① A decal is attached, See RTB no. BRO - 004. ② The stopper is modified; see below.</p>			

Old Part No.	New Part No.	Description	Q'ty Used Old → New	Interchange-ability	Remarks	Parts Catalog	
						Index No.	Page
		(BRO for China)					
H068 3122	H068 3157	Stopper - Printer Cover	1 - 1	X / O		24	2
		(Other BROs and all BR1s)					
H068 3121	H068 3156	Stopper - Printer Cover	1 - 1	X / O	Add into the parts catalog	24	2

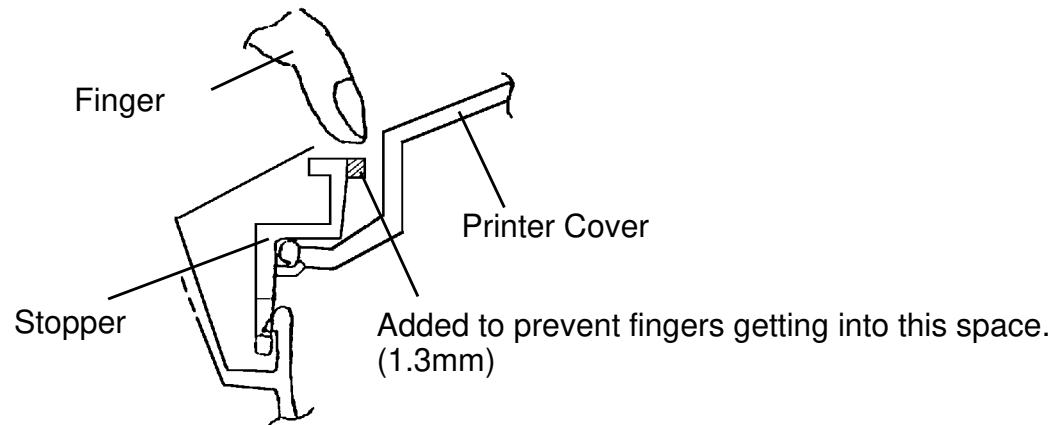

RC	RE	ASIA	
*	*	*	

S.Fujii  
General Manager  
2nd Field Information Department  
QA Division

Prepared by Y.Okunishi

**MODIFICATION BULLETIN NO. BRO - 010**

ISSUED ON Oct.15,1996

Model	BR1 (FAX170) (Asia. China)			Modification Schedule		
Modified Article	FCU			① Old part :		
Reason for Modification	<input type="checkbox"/> Parts catalog correction <input type="checkbox"/> To meet standards (      ) <input type="checkbox"/> To facilitate assembly <input type="checkbox"/> Vender change <input type="checkbox"/> Part standardization <input checked="" type="checkbox"/> To improve reliability <input type="checkbox"/> Other			Inspected parts will be used for October production.  ② New part : The new part will be used after the old part is out of stock.		
To expand the margin for error when transmitting an image.						

Old Part No.	New Part No.	Description	Q'ty Used Old → New	Interchange-ability	Remarks	Parts Catalog	
						Index No.	Page
		(Asia)					
H069 6000	H069 6010	PCB - FCU	1 - 1	X / O			
(H5217132)	(H521 7133)	IC - RF5A170	(1 - 1)	X / O	IC - 8	5	17
		(China)					
H069 6001P	H069 6011	PCB - FCU China	1 - 1	X / O		5	1-7
(H521 7132)	(H521 7133)	IC - RF5A170	(1 - 1)	(X / O)	IC - 8		
(H0697211)	(H069 7311)	IC - Programmed ROM	(1 - 1)	(O / O)	EPROM → Masked ROM		

S.Fujii  
 General Manager  
 2nd Field Information Department  
 QA Division

Prepared by Y.Okunishi

RC	RE	ASIA	
	*	*	

**MODIFICATION BULLETIN NO.BRO - 011**

ISSUED ON

Oct.15,1996

Model	<b>BRO (fax180 for China)</b>		Modification Schedule
Modified Article	FCU		After the old part is out of stock.
Reason for Modification	<div style="display: flex; justify-content: space-between;"> <div> <input type="checkbox"/> Parts catalog correction  <input type="checkbox"/> Vender change </div> <div> <input type="checkbox"/> To meet standards ( )  <input type="checkbox"/> Part standardization </div> <div> <input checked="" type="checkbox"/> To facilitate assembly  <input type="checkbox"/> To improve reliability  <input type="checkbox"/> Other </div> </div> <p style="text-align: center;">A masked ROM will be used instead of the EPROM</p>		

Old Part No.	New Part No.	Description	Q'ty Used Old → New	Interchange- ability	Remarks	Parts Catalog	
						Index No.	Page
H068 6001R	H068 6001S	PCB - FCU China	1 - 1	O / O		5	1-7
(H068 7201G)	(H068 7302)	IC - Programmed ROM	(1 - 1)	(O / O)	No change to the program		

S.Fujii  
General Manager  
2nd Field Information Department  
QA Division

Prepared by Y.Okunishi

RC	RE	ASIA	China
			[

Model: BRO / BR1		Date: 15-May-98	No: 012
Modified Article: Operation Panel Ass'y		Prepared by: Y.Okunishi	
From: QAC Field Information Dept.			
Reason for Modification:	<input checked="" type="checkbox"/> Parts catalog correction <input type="checkbox"/> Vendor change <input type="checkbox"/> To meet standards <input type="checkbox"/> To facilitate assembly <input type="checkbox"/> To improve reliability    (    ) <input type="checkbox"/> Part Standardization <input type="checkbox"/> Other		
Modification Schedule			

Old part number	New part number	Description	Qty	Int	Page	Index	Note
H068 5411	H068 5601	Operation Panel Ass'y - China	1 – 1	O/O	1 - 3	40	
H068 5412	H068 5602	Operation Panel Ass'y – Asia	1 – 1	O/O	1 - 3	40	
H068 5413	H068 5603	Operation Panel Ass'y – US	1 – 1	O/O	1 - 3	40	
H068 5415	H068 5605	Operation Panel Ass'y – Ges	1 – 1	O/O	1 - 3	40	
H069 5411	H069 5602	Operation Panel Ass'y – Asia	1 – 1	O/O	1 - 3	40	
H069 5412	H069 5601	Operation Panel Ass'y - China	1 – 1	O/O	1 - 3	40	

RC	RE	ASIA	
*	*	*	

Model: FX4,FX6,FX6MK2,LSO,IFO,FLX7,FR4,LFO BR1		Date: 15-Sep-98	No: Multi - 012
Modified Article: NCU		Prepared by: Y.Okunishi	
From: QAC Field Information Dept.			
Reason for Modification:	<input type="checkbox"/> Parts catalog correction <input checked="" type="checkbox"/> Vendor change <input type="checkbox"/> To meet standards <input type="checkbox"/> To facilitate assembly <input type="checkbox"/> To improve reliability    (    ) <input type="checkbox"/> Part Standardization <input type="checkbox"/> Other		
Modification Schedule	Once the stock of the old part runs out.		

Old part number	New part number	Description	Qty	Int	Page	Index	Note
54886040E	54886040F	PCB – NCU – HEI	1 – 1	O/O			*1
54886041E	54886041F	PCB – NCU – HE2	1 – 1	O/O			IF0
54886045B	54886045C	PCB – NCU – HE2Y	1 – 1	O/O			*2
54886050B	54886050C	PCB – NCU – HE - IT	1 – 1	O/O			FR4
54886052	54886052	PCB – NCU – HE – 1Y	1 – 1	O/O			*3
54886053B	54886053C	PCB – NCU – HE – 2Y	1 – 1	O/O			LFO
H0686003H	H0686003J	PCB – NCU – HE -ASA	1 – 1	O/O			*4
(H5047146)	(H5457108)	HIL – 220/240V	(1 – 1)	(O/O)			

Note: \*1= FX4, FX6, FX6MK2, LSO

\*2= FX7, LX7

\*3= FR4, G3 Option

\*4= BRO, BR1

Europe, Asia only

RC	RE	ASIA	
	*	*	

Model: BRO, BR1		Date: 15-Oct-98	No.: 013
Modified Article: Cutter Ass'y		Prepared by: Y.Okunishi	
From: GTSS Field Information Dept.			
Reason for Modification:	<input type="checkbox"/> Parts catalog correction <input type="checkbox"/> To facilitate assembly <input type="checkbox"/> Part standardization	<input type="checkbox"/> Vendor change <input checked="" type="checkbox"/> To improve reliability <input type="checkbox"/> Other (See below)	<input type="checkbox"/> To meet standards (      )
Modification Schedule	After the old part becomes out of stock.		

The width of the belt for the cutter carriage changes to 3mm from 2mm. This change makes the belt teeth stronger and prevents incomplete cutting.

Old part number	New part number	Description	Qty	Int	Page	Index	Note
H068 2020	H068 2021	Cutter Ass'y	1 - 1	O/O	1 - 5	11	

RC	REBV	ASIA	
*		*	