

Model: Model K3		Date: 1-Nov-02	No.: MH310001
Modified Article: Parts Catalog Corrections		Prepared by: M. Mano	
From: Technical Services sec. Service Planning Dept.			
Reason for Modification:	<input checked="" type="checkbox"/> Parts catalog correction <input type="checkbox"/> To facilitate assembly <input type="checkbox"/> Part standardization	<input type="checkbox"/> Vendor change <input type="checkbox"/> To improve reliability <input type="checkbox"/> Other	<input type="checkbox"/> To meet standards ()

The currency symbol for the Euro has been added to the Mask ROM, and the Controller Board modified to accommodate this new part.

NOTE: Both the new board and new ROM should be replaced together as a set.

Old part number	New part number	Description	Q'ty	Int	Page	Index	Note
B5165750	B5165753	Controller Board	1	X/O	3	17	
G0565901	G0565903	Mask ROM – PCL	1	X/O	-	-	

Cut-in Serial Numbers:

From October '02: J5221000004~

Model: Model K3		Date: 9-Jan-03	No.: MH310002
Modified Article: Parts Catalog Corrections		Prepared by: M. Mano	
From: Technical Services Sec. Service Planning Dept.			
Reason for Modification:	<input checked="" type="checkbox"/> Parts catalog correction <input type="checkbox"/> To facilitate assembly <input type="checkbox"/> Part standardization	<input type="checkbox"/> Vendor change <input type="checkbox"/> To improve reliability <input type="checkbox"/> Other	<input type="checkbox"/> To meet standards ()

The following part has been modified to improve paper size detection reliability.

Mainframe (H310/H311)

Old part number	New part number	Description	Q'ty	Int	Page	Index	Note
H5193033	H3103392	Paper Size Sensor - Rear	1	X/O	21	4	

Optional PFU (H206)

Old part number	New part number	Description	Q'ty	Int	Page	Index	Note
H5193033	H3103392	Paper Size Sensor - Rear	1	X/O	5	5	

Model: Model K3		Date: 23-Jan-03	No.: MH310003
Modified Article: Parts Catalog Corrections		Prepared by: M. Mano	
From: Technical Services Sec. Service Planning Dept.			
Reason for Modification:	<input checked="" type="checkbox"/> Parts catalog correction <input type="checkbox"/> To facilitate assembly <input type="checkbox"/> Part standardization	<input type="checkbox"/> Vendor change <input type="checkbox"/> To improve reliability <input type="checkbox"/> Other	<input type="checkbox"/> To meet standards ()

To facilitate assembly, the hole in the Exit Guide shown below has been closed (with no change in function).

Mainframe (H310/H311)

Old part number	New part number	Description	Q'ty	Int	Page	Index	Note
H3101196	H3101199	Exit Guide	1	X/O	15	22	

New Part: The shaded hole [A] is closed

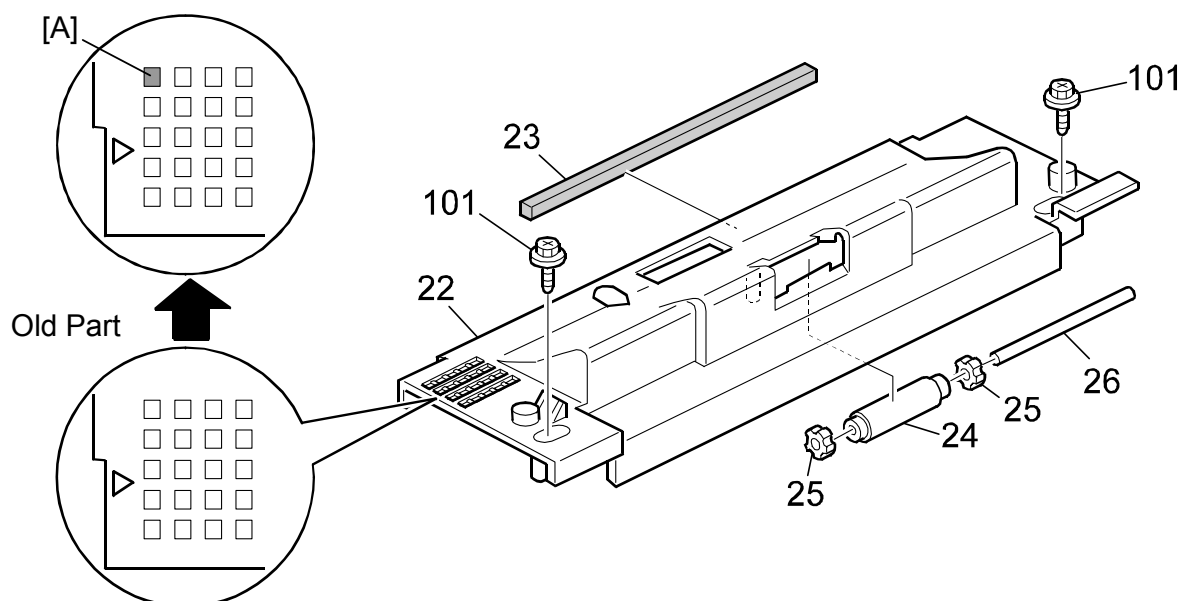

Model: Model K3		Date: 23-Jan-03	No.: MH310004
Modified Article: Parts Catalog Corrections		Prepared by: M. Mano	
From: Technical Services Sec. Service Planning Dept.			
Reason for Modification:	<input checked="" type="checkbox"/> Parts catalog correction <input type="checkbox"/> To facilitate assembly <input type="checkbox"/> Part standardization	<input type="checkbox"/> Vendor change <input type="checkbox"/> To improve reliability <input type="checkbox"/> Other	<input type="checkbox"/> To meet standards ()

The following parts have been modified to ensure the harness is not pinched when the PFU is installed.

Optional PFU (H206)

Old part number	New part number	Description	Q'ty	Int	Page	Index	Note
H3103538	H3103539	Connector Bracket	1	X/O	9	5	
H3105289	H3105270	Upper Relay Harness	1	X/O	9	13	
11050199	11050487	Harness Clamp	1	X/O	9	101	

Model: Model K3		Date: 5-Mar-03	No.: MH310005
Modified Article: Parts Catalog Corrections		Prepared by: M. Mano	
From: Technical Services Sec. Service Planning Dept.			
Reason for Modification:	<input checked="" type="checkbox"/> Parts catalog correction <input type="checkbox"/> To facilitate assembly <input type="checkbox"/> Part standardization	<input type="checkbox"/> Vendor change <input type="checkbox"/> To improve reliability <input type="checkbox"/> Other	<input type="checkbox"/> To meet standards ()

The Function Decal has been changed to the one used on the S-F2 due to a Marketing request for standardization.

NIC Fax Unit (H210)

Old part number	New part number	Description	Q'ty	Int	Page	Index	Note
H3114112	H3114113	Function Decal	1	X/O	3	23	

Model: Model K3		Date: 25-Jun-08	No.: MH310006
Modified Article: Parts Catalog Corrections		Prepared by: T.Shintani	
From: 1st Tech. Support Sec. Service Support Dept.			
Reason for Modification:	<input checked="" type="checkbox"/> Parts catalog correction <input type="checkbox"/> To facilitate assembly <input type="checkbox"/> Part standardization	<input type="checkbox"/> Vendor change <input type="checkbox"/> To improve reliability <input type="checkbox"/> Other	<input type="checkbox"/> To meet standards ()

Model K3

Old part number	New part number	Description	Int	Page	Index	Note
H3105003	AW020156	PHOTOINTERRUPTOR	O/O	15	6	Note 1
H3105411	H3105401	THERMOFUSE:K3	O/O	29	5	Note 2
H3105073	H3105173	SPEAKER:H310	O/O	37	1	Note 3
H3105074	H3105174	FAN:FUSING	O/O	35	2	Note 3
H3105072	H3105172	TONER END SENSOR:H310	O/O	23	18	Note 3
H3105070	H3105170	BRUSHLESS MOTOR:H310	O/O	31	9	Note 3
H5195216	H3105045	MAGNETIC CLUTCH	O/O	33	11	Note 3
H3065043	H3105143	REGISTRATION SENSOR	O/O	23	16	Note 3
H3105041	AX020083	STEPPER MOTOR DC24V 12.6W	O/O	33	2	Note 3
H3105043	H3105044	MAGNETIC CLUTCH:PAPER	O/O	33	3	Note 3
H5115005	H3105005	TRANSMITED RUBBER STAMP	O/O	15	7	Note 3

Change/Reason:

- 1) Vendor change
- 2) Parts standardization with the Japan model
- 3) RoHS compliance (material was changed)



Part Change Information List

Date: August 31, 2009

Model	Code	PCIL Nr.	PCIL Correction	Old part number	New part number	Description	Old Q'ty	New Q'ty	Int	3DPC	Page	Index	Set	Set Int	RTB	Note	Ref. Nr.	ECN Nr.
K3	H310	200908		14030598	14030620	PHOTO COUPLER - PS2501-2	1	0	O/O		45	108					V0901886	9070389



Part Change Information List

Date: January 29, 2010

Model	Code	PCIL Nr.	PCIL Correction	Old part number	New part number	Description	Old Q'ty	New Q'ty	Int	3DPC	Page	Index	Set	Set Int	RTB	Note	Ref. Nr.	ECN Nr.
K3	H310	201001			H3105061	STEPPER MOTOR:TX:H310	0	1	X/O		13	32			RH310015		V0903179	



Part Change Information List

Date: September 30, 2010

Model	Code	PCIL Nr.	PCIL Correction	Old part number	New part number	Description	Old Q'ty	New Q'ty	Int	3DPC	Page	Index	Set	Set Int	RTB	Note	Ref. Nr.	ECN Nr.
K3	H310	201009			H3104111	DECAL:EMBLEM-RIC:H310	0	1			57	15			RH310016		V1001438	10060589



Part Change Information List

Date: October 29, 2010

Model	Code	PCIL Nr.	PCIL Correction	Old part number	New part number	Description	Old Q'ty	New Q'ty	Int	3DPC	Page	Index	Set	Set Int	RTB	Note	Ref. Nr.	ECN Nr.
K3	H310	201010		H5211350	H3101360	PAD:PICKUP	1	1	O/O		11	6					V1001472	10061041
K3	H310	201010		14030598	14030620	Photocoupler	2	2	O/O		45	108					V0901886	9070389

RICOH

Part Change Information List

Date: January 5, 2015

Model	Code	PCIL Number	PCIL Correction	Old part number	New part number	Description	Old Q'ty	New Q'ty	Int	3DPC	Page	Index	Set	Set Int	RTB	Note	Ref Number	ECN Number
K3	H310	201512		H0062316	B0442316	CLUTCH SPACER	4	4	O/O	N	8	11					V1503486	