

RICOH

**Model OP-P2/MF2
Service Training
Update Training Course**



Slide 1

Version 1.1

Please refer to NPLI for the information of models and their regions

Differences from Previous Models

- ❑ **OP-P2/MF2 is a minor change model from OP-P1/MF1.**
- ❑ **New operation panel**
 - ◆ All MF models has a control panel with 4-LINE back light LCD display.
- ❑ **Common AIOs can be used between OP-P1/MF1 and OP-P2/MF2**
 - ◆ One AIO can be refilled maximum 3 times depends on the life of photo-conductor and the capacity of the old toner tank.
- ❑ **GDI driver or PCL driver, with support for Windows only.**



Slide 2

No additional notes

General Specifications		
	OP-P2/MF2	OP-P1/MF1
PPM (A4 / LT)	22 / 23	
Warm up time (sec.)	< 25 (Wi-Fi MF: < 27)	< 25
First print time (sec.)	< 10 (from print-data-in to paper-ejection) < 6 (from paper-feed-start to paper-ejection)	
Resolution	Printing/Copying: 600 x 600 dpi, 1200 x 600 dpi Scan from exposure glass: 600 x 600 dpi, 600 x 300 dpi Scan from ADF: 600 x 300 dpi	
ADF capacity	35	15
Input tray capacity	Bank tray: 150 Bypass tray: 1	
Output tray capacity	50 (face down)	
Duplex printing	Manual	
Paper size	Bank tray: A4, Letter, Half letter ,B5, A5, B6, Executive, 16K, Legal Bypass tray: Width 100mm~216mm (3.5"~8.5") Length 148mm~356mm (5.8"~14") ADF: Width 140mm~216mm (5.5"~8.5") Length 139mm~356mm (5.5"~14")	

Slide 3

No additional notes

Electrical Component Layout

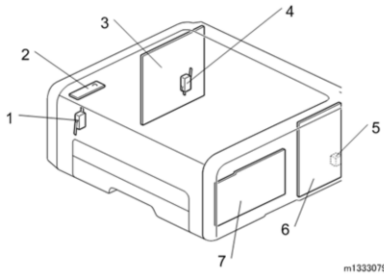

1. Front Door Switch
2. Operation Panel Unit
3. Main PCB
4. Interlock Switch (Fusing Unit Cover)
5. Main Switch
6. PSU
7. HVPP (High Voltage Power Pack)

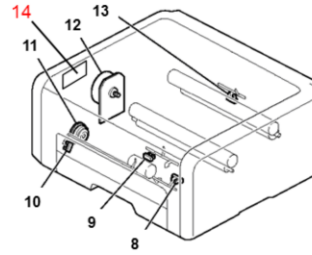

8. Paper End Sensor
9. Registration Sensor
10. By-pass Set Sensor
11. Paper Feed Clutch
12. Main Motor
13. Paper Exit Sensor
14. Wi-Fi PCB (new for OP-P2/MF2)

Slide 4

No additional notes

Using the Service Mode

❑ The method for entering the service mode depends on the function item and the model.

No.	Function	To Enter Service Mode	MF	SFP
1	Maintenance	From control panel key-pad: Stop/Reset > 1 > 0 > 7 > Start	Yes	No
		From SOM: User tools > Printer configuration > Access code: Admin074	Yes	Yes
2	Fax test	Hold the Fax key + Power ON	Yes	No

Slide 5

No additional notes

Updating Firmware

- ❑ A computer is necessary for updating the firmware.
- ❑ The independent FW update tool for OP-P2/MF2 can be executed without SOM. (OP-P1/MF1 need SOM)
- ❑ The machine will be reboot automatically after upgrade complete. (OP-P1/MF1 need be reboot manually)
- ❑ The updating procedure is different from OP-P1/MF1. Refer service manual for details.

Slide 6

No additional notes

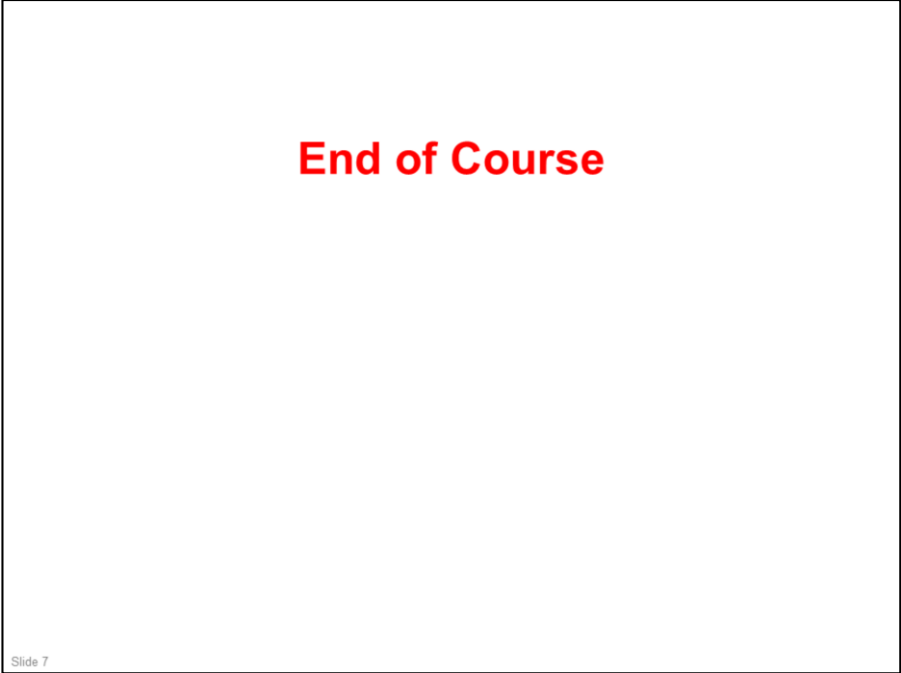

No additional notes