

Notes for Users

About opening and closing the input tray

After opening the input tray cover and pulling out the tray, raise up the paper support wire.

This prevents the paper from bending.

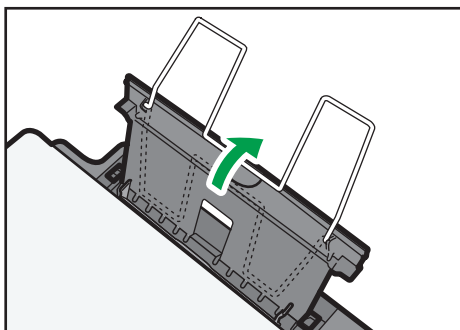

CHZ090

When closing the input tray, make sure to return the paper support wire to the correct location.

The arrow indicates the location where you return it to.

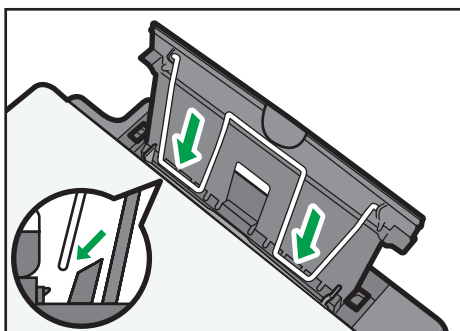

CHZ094



M1018686

Copyright © 2012
Printed in China
EN (US) EN (GB)
M101-8686