

Model	PDC - 10E	Volt/Hz	Date of Modification	Serial Number
Modified Article	Parts Catalog			
Reason for Modification	Parts Catalog Correction (-27 machines only)			

Incorrect P/N	Correct P/N	Description	Q'ty Used	Parts Catalog	
				Index No.	Page
A1055250	A1055252	Video Processing Board	1	8	25
A0495300	A1055300	Scanner Coaxial Harness	1	24	27
A1051856	A1051857	CCD Drive Board Set	1	4	27

Old P/N	New P/N	Description	Q'ty Used Old → New	Parts Catalog	
				Index No.	Page
A1055270	A1055274	Scanner Control Board	1 → 1	9	25
				*	105
16070339		IC-DS1000M - 50	4 → 0		
	16070345	Delay Line	0 → 2	161	105
16041353		Capacitor 47UF 10V	1 → 0		
	16402470	Capacitor 47UF ±20% 25V	0 → 1	153	105
	16020989	Capacitor and Coil 100pF100V	0 → 8	174	105
	16027002	Capacitor 50V 100MHOM	0 → 1	175	105
	16303470	Resistor 470 OHM ±5% 1/10W	0 → 43	176	105
	16330000	Resistor 0 OHM ±1% 1/10W	0 → 2	177	105

Please add the following table to page 104 of your parts catalog.

SYMBOL	INDEX NO.
IC746	161
IC750	161

SYMBOL	INDEX NO.
NF701	174
NF702	174
NF703	174
NF704	174
NF705	174
NF706	174
NF707	174
NF708	174
NF734	175

SYMBOL	INDEX NO.
R800	176
↓	
R839	
R840	177
R841	177
R842	176
R843	176
R844	176

M. Iwasa, Manager
Technical Support Department

MODEL NAME	V/Hz	DESTINATION	CODE	SERIAL NUMBER
Ricoh NC8115	115 / 60	USA, CANADA	A105-17	
Ricoh NC8115	230 / 60	EUROPE	A105-27	

ISSUED ON: July 15, '95

Model	PDC - 10E	Volt/Hz	Date of Modification	Serial Number
Modified Article	SUB Hopper Unit			
Reason for Modification	Material change			

Old P/N	New P/N	Description	Q'ty Used	Inter-change-ability	Parts Catalog	
					Index No.	Page
AD001031	AD001039	SUB Hopper Unit	4 → 4	O/O	*	51

M. Iwasa, Manager
Technical Support Department

MODEL NAME	V/Hz	DESTINATION	CODE	SERIAL NUMBER
Ricoh NC8115	115 / 60	USA, CANADA	A105-17	
Ricoh NC8115	230 / 60	EUROPE	A105-27	

ISSUED ON: July 15, '95

Model	PDC - 10E	Volt/Hz	Date of Modification	Serial Number
Modified Article	Transport Fan Motor			
Reason for Modification	Vender change			

Due to a vender change, the following part has been changed.

Old P/N	New P/N	Description	Q'ty Used	Inter-change-ability	Parts Catalog	
					Index No.	Page
AX050008	AX650018	Transport Fan Motor	2 → 2	O/O	12	91
			1 → 1		30	93

M. Iwasa, Manager
Technical Support Department

MODEL NAME	V/Hz	DESTINATION	CODE	SERIAL NUMBER
Ricoh NC8115	115 / 60	USA, CANADA	A105-17	
Ricoh NC8115	230 / 60	EUROPE	A105-27	

Model		PDC-10E (-27 machine only)						Volt/Hz	Date of Modification	Serial Number	
Modified Article		Parts Catalog									
Reason for Modification		Parts Catalog Correction									
Draw No.	Incorrect No.		Correct No.	Description	Rank	Q'ty Used Old→New	Inter-change-ability	Parts needed for replacement by new part		Parts Catalog	
								Part No.	Description	No.	Page
	A1055250		A1055252	Video Processing Board		1 → 1				8	25
	A1051691		A1051693	Left Inner Cover		1 → 1				10	25
	A0491709		A1051709	Left Scale Bracket		1 → 1				19	25
	A0491708		A1051708	Right Scale Bracket		1 → 1				24	25
	A0491695		A1051696	Right Inner Cover		1 → 1				32	25
	A0491699		A1051699	Middle Inner Cover		1 → 1				33	25
	A1051856		A1051857	CCD Drive Board Set		1 → 1				4	27
	A0491895		A1051896	Left Upper Cover - Scanner		1 → 1				12	27
	A0491898		A1051898	Right Upper Cover - Scanner		1 → 1				23	27
	A0495300		A1055300	Scanner Coaxial Harness		1 → 1				24	27

Rank: A : Replace with new parts immediately. B : Replace with new parts at time of repair. C : Replace with new parts at time of overhaul.

Interchangeability:

- (1) When old and new parts are not mutually interchangeable, use additional parts or an assembly part as indicated in "Parts needed for replacement by new part" to install the new part.
- (2) The mark to the left of the slash indicates whether the old part can be used in the new machine, and the mark to the right indicates whether the new part can be used in the old machine. x = Not interchangeable o = Interchangeable

Draw No.	Incorrect Parts No.		Correct Parts No.	Description	Rank	Q'ty Used Old → New	Inter-changeability	Part needed for replacement by new part		Parts Catalog	
								Part No.	Description	No.	Page
	A0491704			PCB Guide Bracket - Front		1 → 0				1	29
	A0491705			PCB Guide Bracket - Front Right		1 → 0				2	29
			A1051702	PCB Guide Bracket - Front		0 → 1				* 25	
	A0491701			PCB Guide Bracket - Rear Left		1 → 0				4	29
	A0491703			PCB Guide Bracket - Rear Right		1 → 0				5	29
	A0491702			PCB Guide Bracket - Rear		1 → 0				6	29
			A1051701	PCB Guide Bracket - Rear		0 → 1				* 26	
	10050907			Rail - 50 x 6040		2 → 0				110	29
	10050785			PCB Guide Rail		n → n-2				115	29
			10050958	PCB Guide Rail		0 → 8				* 116	
			03540060B	Screw - M4 x 6		n → n-1				101	
			03530060B	Screw - M3 x 6		n → n+16				*	29
			A1056630	Scanner Ground Bracket - Right		0 → 1				* 25	
			A1056629	Scanner Ground Bracket - Left		0 → 1				* 26	
			03540060B	Screw - M4 x 6		n → n+4				101	95

DETAILS OF MODIFICATION

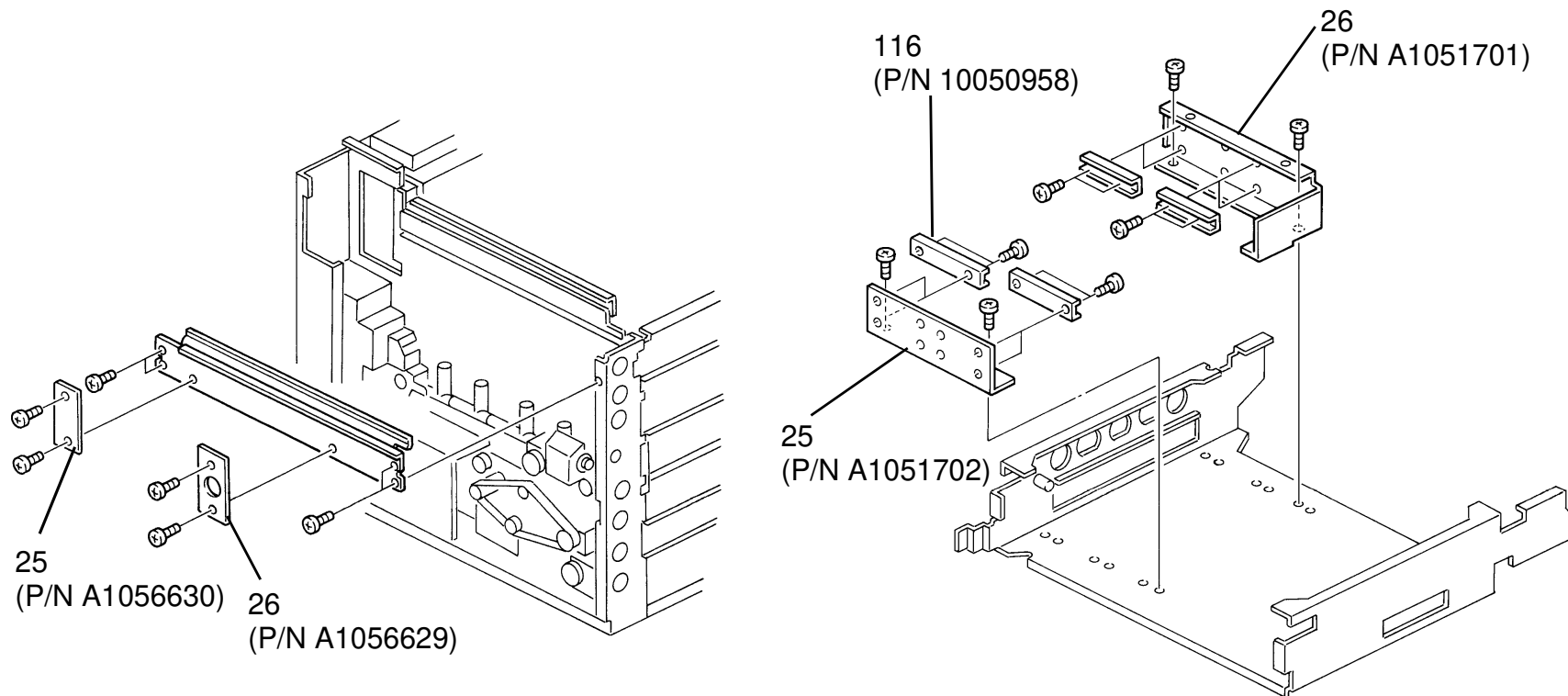

M. Iwasa, Manager
Technical Support Department

MODEL NAME	V/Hz	DESTINATION	CODE	SERIAL NUMBER
Ricoh NC8115	115 / 60	USA, CANADA	A105-17	
Ricoh NC8115	230 / 60	EUROPE	A105-27	

MODIFICATION BULLETIN NO. 5

PAGE 2 OF 6

ISSUED ON: November 30, '95

[illegible]

DETAILS OF MODIFICATION

To comply with the CE mark standards, the following modifications have been made.

1. To improve grounding, two screws have been added to secure the rear left cover. Also, the IPU cover seal and seal 9.5x9.5x125 have been added.

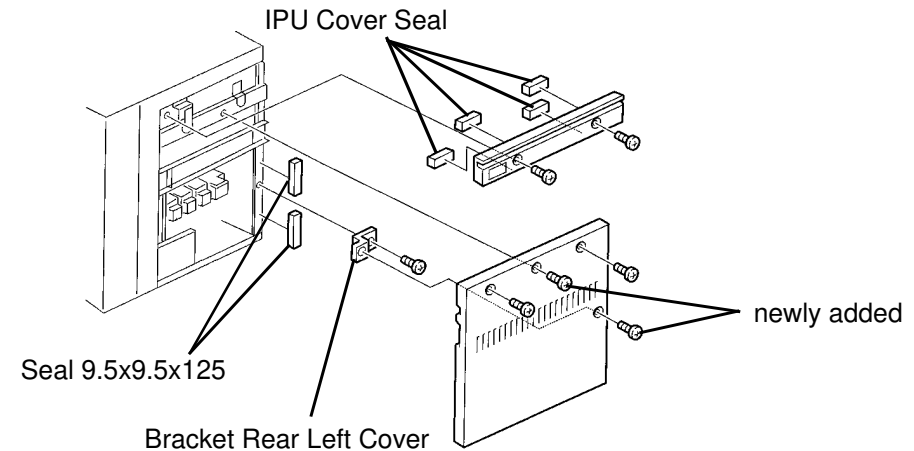

2. To improve grounding, six screws have been added to secure the operation panel lower cover to the main frame. To improve grounding, three screws have been added to attach the operation panel assembly to its brackets.

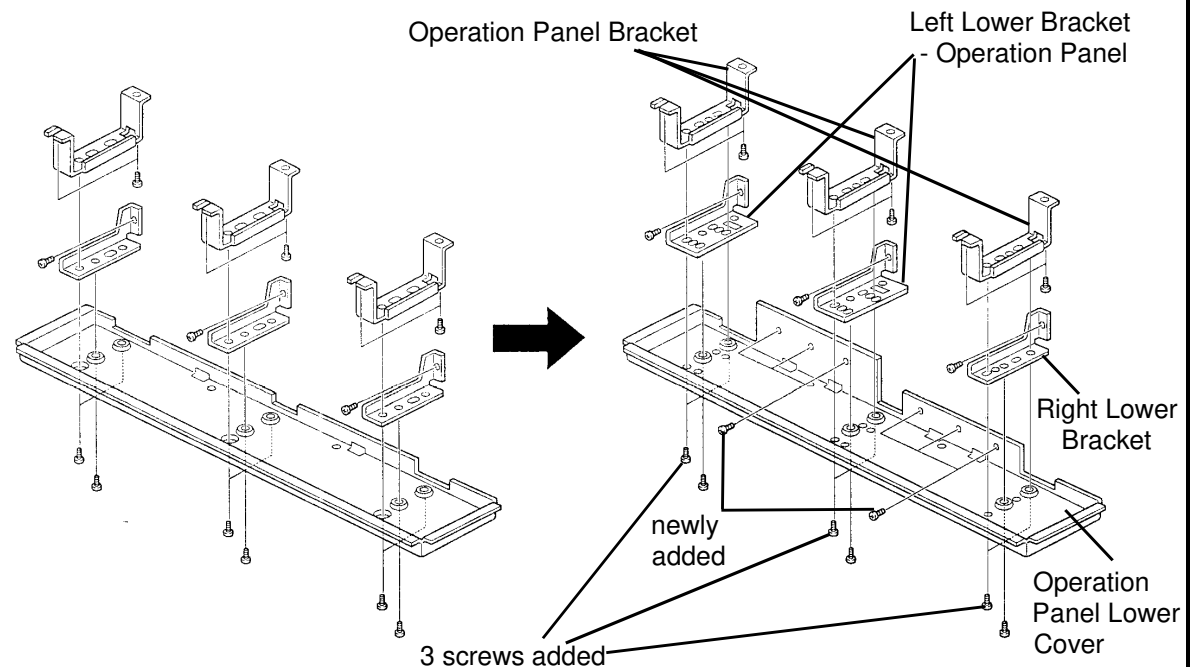
OLDNEW

DETAILS OF MODIFICATION

3. To reduce electrical noise, ferrite cores have been added to the IPU relay harness, the laser unit main harness, and the laser unit data harness. A ferrite core (P/N 16070881) has been added also to the LED harness inside the editor board.

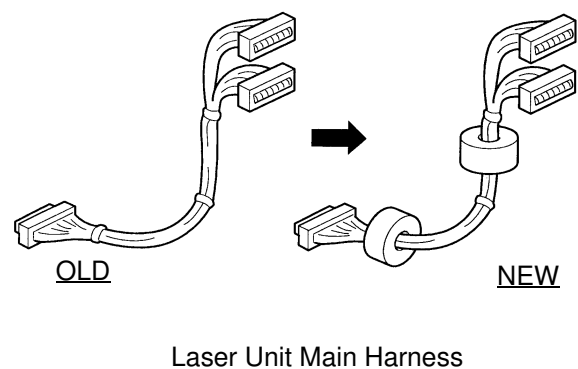
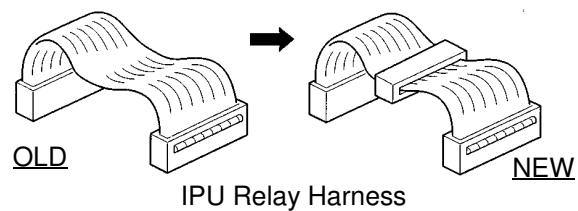
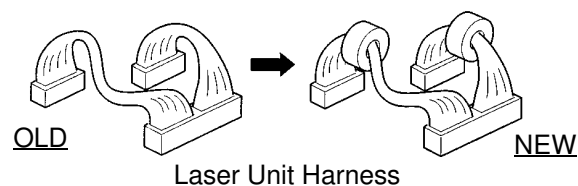

4. To reduce the electrical noise, spacers made of copper plate have been added around the exposure glass.
The front scale spacer and the right scale spacer are copper plates, and a similar copper plate is attached to the rear edge of the exposure glass.

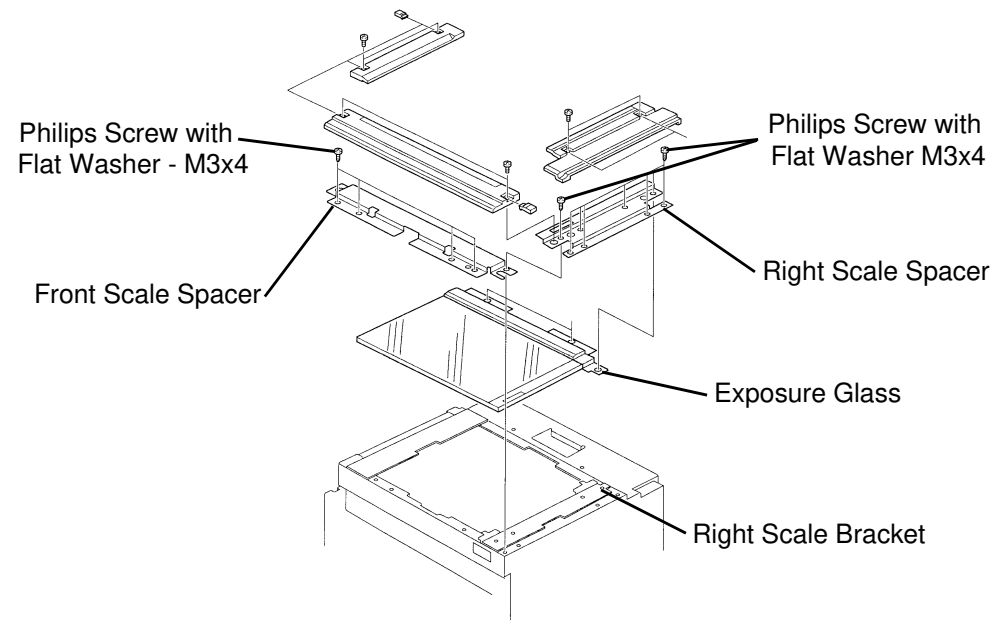

M. Iwasa, Manager
Technical Support Department

MODEL NAME	V/Hz	DESTINATION	CODE	SERIAL NUMBER
Ricoh NC8115	115 / 60	USA, CANADA	A105-17	A3585090001
Ricoh NC8115	230 / 50	EUROPE	A105-27	A3585090014

Model	PDC - 10E	Volt/Hz	Date of Modification	Serial Number
Modified Article	Transfer Belt			
Reason for Modification	To reduce contamination of the transfer belt			

To reduce contamination of the transfer belt, the surface finishing has been improved.

Old P/N	New P/N	Description	Q'ty Used	Inter-change-ability	Parts Catalog	
					Index No.	Page
A1053850	A1053852	Transfer Belt	1 → 1	X/O	19	57
					19	59

M. Iwasa, Manager
Technical Support Department

MODEL NAME	V/Hz	DESTINATION	CODE	SERIAL NUMBER
Ricoh NC8115	115 / 60	USA, CANADA	A105-17	A3585090001
Ricoh NC8115	230 / 60	EUROPE	A105-27	A3585090014

ISSUED ON: June 15, '96

Model	PDC - 10E	Volt/Hz	Date of Modification	Serial Number
Modified Article	Oscillator	No serial number cut-in information.		
Reason for Modification	Vendor change			

Due to a vendor change, the following part has been changed.

Old P/N	New P/N	Description	Q'ty Used	Inter-change-ability	Parts Catalog	
					Index No.	Page
15030182	15030716	Crystal Oscillator - 12MHZ	1 → 1	O/O	134	111



T. Inoue, General Manager
1st Field Information Dept. QAC