

Notes for Users

Due to product improvements, the shapes of the main unit's paper trays (Trays 2, 3, 4) have been changed. In accordance with this, changes to the manual have been made as shown below.

❖ Paper trays (Shapes of Trays 2, 3, 4 before and after the improvement)

The illustration below shows Tray 2.

Before improvement:

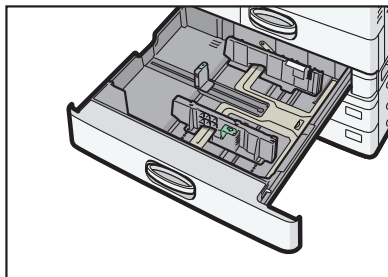

DDU016

After improvement:

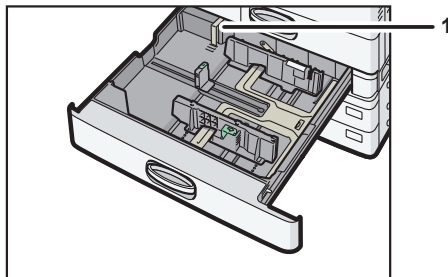

DDU010

1. Supporting side fence

↓ Note

- There are no changes to the method used to load paper into the tray.
- Adjust the supporting side fence before loading into the tray sheets of paper whose size is over A3 or 11" x 17".

❖ Adjusting the supporting side fence

1. Loosen the fixed screw with an object such as a coin.

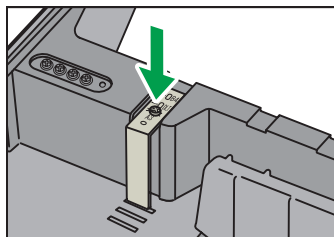

DDU011

2. Move the supporting side fence to match the size of the paper you want to load. Set the screw position to match the size of the set paper.

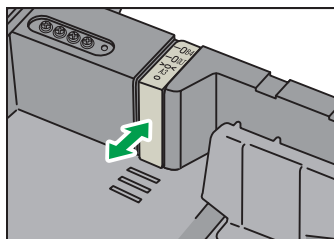

DDU012



*1 Not for common use

↓ Note

- The marks on the supporting side fence may differ depending on the region.

3. Tighten the fixed screw with an object such as a coin.

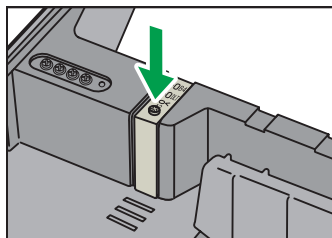

DDU013

❖ Recommended Paper Sizes (Trays 2, 3, 4)

The paper sizes that can be loaded in Trays 2, 3, 4 are changed as follows:

The paper sizes for postcards and envelopes are those specified in the manual.

Paper Specifications and Adding Paper > Recommended Paper > Recommended Paper Sizes and Types > Tray 2 > Thin Paper–Thick Paper 4

Paper size	
<ul style="list-style-type: none"> Paper sizes that can be detected automatically: 	
Region A	A3□, A4□, A5□, B4 JIS□, B5 JIS□, 8 ¹ / ₂ ×11□, SRA3□ *2
Region B	A4□, A5□, B5 JIS□, 11×17□, 8 ¹ / ₂ ×14□, 8 ¹ / ₂ ×11□, 7 ¹ / ₄ ×10 ¹ / ₂ □, 12×18□ *2
<ul style="list-style-type: none"> Select the paper size using the Tray Paper Settings menu: 	
Region A	A5□, A6□, B6 JIS□, 11×17□, 8 ¹ / ₂ ×14□, 8 ¹ / ₂ ×13□, 8 ¹ / ₂ ×11□, 8 ¹ / ₄ ×14□, 8 ¹ / ₄ ×13□, 8×13□, 8×10□, 7 ¹ / ₄ ×10 ¹ / ₂ □, 5 ¹ / ₂ ×8 ¹ / ₂ □, 8K□, 16K□, 12×18□ *2, 11×15□, 10×14□
Region B	A3□, A4□, A5□, A6□, B4 JIS□, B5 JIS□, B6 JIS□, 8 ¹ / ₂ ×13□, 8 ¹ / ₄ ×14□, 8 ¹ / ₄ ×13□, 8×13□, 8×10□, 7 ¹ / ₄ ×10 ¹ / ₂ □, 5 ¹ / ₂ ×8 ¹ / ₂ □, 8K□, 16K□, 11×15□, 10×14□, SRA3□ *2
<ul style="list-style-type: none"> Custom size *1*3: 	
Region A	Vertical: 90.0–320.0 mm, Horizontal: 148.0–457.2 mm
Region B	Vertical: 3.55–12.59 inches, Horizontal: 5.83–18.00 inches

Paper Specifications and Adding Paper > Recommended Paper > Recommended Paper Sizes and Types > Trays 3 and 4 > Thin Paper–Thick Paper 4

Paper size	
<ul style="list-style-type: none"> Paper sizes that can be detected automatically: 	
Region A	A3□, A4□, A5□, B4 JIS□, B5 JIS□, 8 ¹ / ₂ ×11□, SRA3□ *2
Region B	A4□, A5□, B5 JIS□, 11×17□, 8 ¹ / ₂ ×14□, 8 ¹ / ₂ ×11□, 7 ¹ / ₄ ×10 ¹ / ₂ □, 12×18□ *2
<ul style="list-style-type: none"> Select the paper size using the Tray Paper Settings menu: 	
Region A	11×17□, 8 ¹ / ₂ ×14□, 8 ¹ / ₂ ×13□, 8 ¹ / ₂ ×11□, 8 ¹ / ₄ ×14□, 8 ¹ / ₄ ×13□, 8×13□, 8×10□, 7 ¹ / ₄ ×10 ¹ / ₂ □, 8K□, 16K□, 12×18□ *2, 11×15□, 10×14□
Region B	A3□, A4□, B4 JIS□, B5 JIS□, 8 ¹ / ₂ ×13□, 8 ¹ / ₄ ×14□, 8 ¹ / ₄ ×13□, 8×13□, 8×10□, 7 ¹ / ₄ ×10 ¹ / ₂ □, 8K□, 16K□, 11×15□, 10×14□, SRA3□ *2
<ul style="list-style-type: none"> Custom size *1*3: 	
Region A	Vertical: 182.0–320.0 mm, Horizontal: 148.0–457.2 mm
Region B	Vertical: 7.17–12.59 inches, Horizontal: 5.83–18.00 inches

*1 When loading paper with a vertical length of more than 304.8 mm (12.0 inches) in Trays 2–4, use paper that has a horizontal width of 450 mm (17.8 inches) or less.

*2 Adjust the supporting side fence before loading SRA3□ or 12×18□ paper.

*3 Set the supporting side fence position to SRA3□ before loading paper with a vertical length of 297 mm or longer and a horizontal length of over 335 mm.

