



Notes for Administrators:
Using This Machine in a Network Environment
Compliant with IEEE Std 2600.2™-2009

TABLE OF CONTENTS

1. Notes for Administrators

Introduction.....	3
Before Applying the Security Functions.....	3
CC-Certified Operating Environment.....	4
MFPs Explained in This Manual.....	5
Checking Versions for CC Conformance.....	5
Manuals.....	9
Options.....	17
Preparation for Use.....	18
Specifying the MFP Settings.....	18
Procedure 1: Settings to Specify Using the Control Panel 1.....	18
Procedure 2: Settings to Specify Using the Control Panel 2.....	20
Procedure 3: Settings to Specify Using Web Image Monitor.....	28
Procedure 4: Settings to Specify Using the Control Panel 3.....	37
Checking the MFP Settings.....	38
Changing MFP Settings during Operation.....	40
Notes for Setting up and Operation.....	47
Trademarks.....	50



1. Notes for Administrators

Introduction

This product is a multifunction printer (MFP) certified in an operating environment complying with the requirements of the Common Criteria for Information Technology Security Evaluation (CC certification). Be sure to read the booklet carefully and understand its contents thoroughly.

The official name of IEEE Std 2600.2TM-2009 is U.S. Government Approved Protection Profile - U.S. Government Protection Profile for Hardcopy Devices Version 1.0 (IEEE Std 2600.2TM-2009)(Version: 1.0).

Before Applying the Security Functions

The person responsible for acquiring this machine must appoint competent personnel as the administrators (including the machine supervisor) and instruct them to read the administrator manuals listed below.

- Security Guide
- About This Machine
- Notes for Administrators: Using This Machine in a Network Environment Compliant with IEEE Std 2600.2TM-2009

To securely operate the machine, administrators must keep these manuals handy.

All other manuals are for general users.

Before applying any security functions, administrators must read and fully understand "Before Configuring the Security Function Settings" in Security Guide.

CC-Certified Operating Environment

CC evaluation was performed under the following environment.

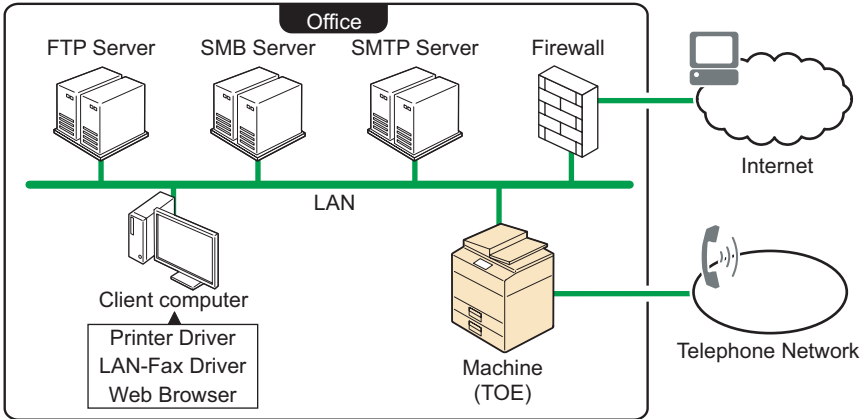

CJL104

IT Products	Names/Versions of Evaluated IT Products
Printer Driver	PCL6 Driver 1.0.0.0
LAN-Fax Driver	LAN-Fax Driver 8.0.0.0
Web Browser	Internet Explorer 9.0 and 11.0 for Windows

★ Important

- You can connect necessary IT products to the MFP over the network or telephone line in your operating environment.
- If this machine's LAN (local area network) is connected to an external network, be sure to use a firewall or some other means to block any unused ports. Check which ports are required and block any that are not.
- Use only CC-conformant or later (post-CC-conformant) versions of the PCL6 and LAN-Fax drivers. If you use a post-CC-conformant driver version, check the revision history to make sure there has been no security-related revision to the CC-conformant version. You can download the drivers from the manufacturer's website.
- To install the LAN-Fax driver, enter the machine's IP address or host name in the [Printer URL] box as follows (also described in "Using the IPP port" in "Specifying the Port When Installing the LAN-Fax Driver" in "Installing the LAN-Fax Driver", Driver Installation Guide):
 - [https://\(machine's IP address or host name\)/printer](https://(machine's IP address or host name)/printer)

- To install the printer driver, enter the machine's IP address or host name in the [URL:] box as follows (also described in "Using the IPP Port" in "Installing the Printer Driver for the Selected Port" in "Installing the Printer Driver for a Network Connection", Driver Installation Guide):
 - [https://\(machine's IP address or host name\)/printer](https://(machine's IP address or host name)/printer)

MFPs Explained in This Manual

Check the rating plate, so that the MFP you are using is included in the models listed below:

Ricoh MP 402SPF,

Savin MP 402SPF,

Lanier MP 402SPF,

nashuatec MP 402SPF,

Rex-Rotary MP 402SPF,

Gestetner MP 402SPF,

infotec MP 402SPF

Checking Versions for CC Conformance

The version of CC-certified target of evaluation (TOE) is E-1.00. The versions of the firmware and hardware corresponding to version E-1.00 TOE are shown below. When using an MFP, you can display the firmware and hardware versions.



Machine firmware and hardware

Primary Classification	Secondary Classification	Version
Firmware	System/Copy	1.03
	Network Support	16.34
	Web Support	1.02
	Fax	02.00.00
	RemoteFax	01.00.00
	Scanner	01.03
	Web Uapl	1.01
	NetworkDocBox	1.01
	animation	1.00

Primary Classification	Secondary Classification	Version
Firmware	Printer	1.01
	RPCS	3.20.13
	Font EXP	1.00
	PCL	1.03
	PCL Font	1.09
	PDF	1.00
	PS3	1.00
	PS3 Font	1.17
	Java VM v12 std	12.47.01
	Data Erase Onb	1.05
	GWFCU3.8-15(WW)	02.00.00
	PowerSaving Sys	F.L3.06
	M2a_System	1.21
	M2a_BLEPlugin	2.12.00
	M2a_BluetoothSe	1.01
	M2a_cspf	2.02.00
	M2a_ICCdDisptch	2.12.04
	M2a_iWnn	2.3.3
	M2a_iWnn_Hang	1.0.0
	M2a_iWnn_Hans	1.0.0
	M2a_iWnn_Hant	1.0.0
	M2a_LegacyUI	1.14
	M2a_MeidaPrtScn	1.16
	M2a_NFCPlugin	2.12.00
	M2a_PrinterInfo	1.10

Primary Classification	Secondary Classification	Version
Firmware	M2a_PrinterSJob	1.63
	M2a_ProgramInfo	1.18
	M2a_QRCode_SDC	2.1.2
	M2a_QuickCdAuth	2.12.04
	M2a_RemAssist	1.0.5
	M2a_RemSptSvc	1.0.1
	M2a_SimpleCopy	1.17
	M2a_SimpleFAX	1.12
	M2a_SimpleScan	1.13
	M2a_SmartCopy	1.21
	M2a_SmartFAX	1.18
	M2a_SmartScan	1.12
	M2a_USBCdPlugin	2.12.00
	M2a_WEcoInfo	1.06
	M2a_WFaxInfo	1.02
	M2a_WLanguage	1.06
	M2a_WStopKey	1.01
	M2a_WTonner	1.05
	M2a_zoo	1.04.01
	Engine	1.02:03
Hardware	Ic Ctlr	03
	Ic Key	01020d0c

You can check the firmware and hardware versions of this machine from the control panel as follows:

1. Press [Home]  at the bottom of the screen in the center.
2. Flick the screen to the left, and then press the [User Tools] icon .



- 3. Press [Machine Features].
- 4. Press [System Settings].
- 5. Press [Administrator Tools].
- 6. Press [Firmware Version].

MultiLink-Panel firmware

Primary Classification	Secondary Classification	Version
Firmware	Firmware	1.21
	Keymicon	6.11
	Application Site	1.04.01
	Bluetooth Authentication Plugin	2.12.00
	BluetoothService	1.01
	Change Langs. Widget	1.06
	Copy	1.21
	CSPF	2.02.00
	Eco-friendly Widget	1.06
	Fax	1.18
	Fax RX File Widget	1.02
	ICCardDispatcher	2.12.04
	iWnn IME	2.3.3
	iWnn IME Chinese(Simplified) Pack	1.0.0
	iWnn IME Chinese(Traditional) Pack	1.0.0
	iWnn IME Korean Pack	1.0.0
	LegacyUI type-1	1.14
	LegacyUIData	1.00
	Print/Scan(Memory Storage Device)	1.16
	Printer	1.10

Primary Classification	Secondary Classification	Version
Firmware	ProgramInfoService	1.18
	Proximity Card Reader Support Plugin	2.12.00
	Quick Card Authentication Config.	2.12.04
	Quick Copy	1.17
	Quick Fax	1.12
	Quick Print Release	1.63
	Quick Scanner	1.13
	RemoteConnect Support	1.0.5
	RemoteSupportService	1.0.1
	Scanner	1.12
	Smart Device Connector	2.1.2
	Standard IC Card Plugin	2.12.00
	Stop Widget	1.01
	Supply Info Widget	1.05

You can check the firmware version of the MultiLink-Panel from the control panel as follows:

1. Press [Home] () at the bottom of the screen in the center.
2. Flick the screen to the left, and then press the [User Tools] icon ()
3. Press [Screen Features].
4. Press [Screen Device Settings Information] in [SYSTEM].
5. Press [Software Version List].

Manuals

The reference numbers of the CC-certified manuals and the model numbers of the machines covered by the manuals are as follows:

Identifying the model

- Mainly Europe
"-27"

- Mainly North America
"-17"
- Mainly Asia
"-29"

In the following example, the machine's model number ends with "-27".

1. Check the label on the rear of the machine to identify the model.

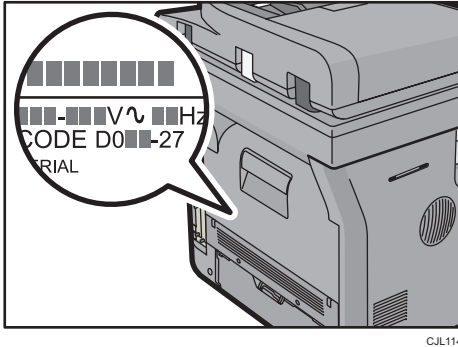

2. Check whether the model number on the label ends with "-27".

★ Important

- Do not use the supplied "User Guide" or the manuals on the supplied CD-ROM.

1. Manual reference numbers for "-27" models

Paper Manuals

Manual Name	Reference Number
Note to users EU Countries	D150-1469A
Notes for Using This Machine Safely	D219-7074
Notes for Users	D241-7083
NOTICE TO USERS	D241-7178
SOFTWARE LICENSE AGREEMENT	D241-7238
Note to users	D256-8996A
For Users of This Product	D3BR-4506
Fusing Roller Cleaning Function	M160-7566B

Online Manuals (Website 1)

Manual Name	Reference Number
About This Machine	M0A0-7536
Copy/ Document Server	M0A0-7537
Fax	M0A0-7538
Print	M0A0-7539
Scan	M0A0-7540
Troubleshooting	M0A0-7541
Connecting the Machine/System Settings	M0A0-7542
PostScript 3	M0A0-7543
Security Guide	M0A0-7544
Extended Feature Settings	M0A0-7545

To see the listed manuals, use the computer's browser to access the following website:

https://support-download.com/services/device/ccmanual/MP402/en/booklist/int/index_book.htm

Online Manuals (Website 2)

Manual Name	Reference Number
Read This First	M0A0-7546

To see the listed manuals, use the computer's browser to access the following website:

<https://support-download.com/services/device/ccmanual/MP402/en/pdf/ReadThisFirst.html>

Online Manuals (Website 3)

Manual Name	Reference Number
User Guide	M0A0-7531

To see the listed manuals, use the computer's browser to access the following website:

<https://support-download.com/services/device/ccmanual/MP402/en/pdf/User.html>

Online Manuals (Website 4)

Manual Name	Reference Number
Operating Instructions	M0A0-7532
Driver Installation Guide	

To see the listed manuals, use the computer's browser to access the following website:

<https://support-download.com/services/device/ccmanual/MP402/en/pdf/DriverInstall.html>

Online Manuals (Website 5)

Manual Name	Reference Number
About Open Source Software License	M0A0-7533

To see the listed manuals, use the computer's browser to access the following website:

<https://support-download.com/services/device/ccmanual/MP402/en/pdf/Oss.html>

Online Manuals (Website 6)

Manual Name	Reference Number
Start Guide	M0A0-7534

To see the listed manuals, use the computer's browser to access the following website:

<https://support-download.com/services/device/ccmanual/MP402/en/pdf/StartGuide.html>

Online Manuals (Website 7)

Manual Name	Reference Number
Notes on Security Functions	D146-7587
Notes for Administrators: Using This Machine in a Network Environment Compliant with IEEE Std 2600.2™-2009	M0A0-7548

2. Manual reference numbers for "-17" models**Paper Manuals**

Manual Name	Reference Number
Notes for Users	D241-7085
SOFTWARE LICENSE AGREEMENT	D241-7238
Fusing Roller Cleaning Function	M160-7566B

Manual Name	Reference Number
Notes for Using This Machine Safely	D219-7074
Note to users in Canada	D219-7461A
For Users of This Product	D219-7454
Notes to Users in the United States of America	D219-7458A
NOTICE TO USERS	D241-7178
Note to users	D256-8996A

Online Manuals (Website 1)

Manual Name	Reference Number
About This Machine	M0A0-7536
Copy/ Document Server	M0A0-7537
Fax	M0A0-7538
Print	M0A0-7539
Scan	M0A0-7540
Troubleshooting	M0A0-7541
Connecting the Machine/System Settings	M0A0-7542
PostScript 3	M0A0-7543
Security Guide	M0A0-7544
Extended Feature Settings	M0A0-7545

To see the listed manuals, use the computer's browser to access the following website:

https://support-download.com/services/device/ccmanual/MP402/en/booklist/int/index_book.htm

Online Manuals (Website 2)

Manual Name	Reference Number
Read This First	M0A0-7530

To see the listed manuals, use the computer's browser to access the following website:

<https://support-download.com/services/device/ccmanual/MP402/en/pdf/ReadThisFirst.html>

Online Manuals (Website 3)

Manual Name	Reference Number
User Guide	M0A0-7531

To see the listed manuals, use the computer's browser to access the following website:

<https://support-download.com/services/device/ccmanual/MP402/en/pdf/User.html>

Online Manuals (Website 4)

Manual Name	Reference Number
Operating Instructions Driver Installation Guide	M0A0-7532

To see the listed manuals, use the computer's browser to access the following website:

<https://support-download.com/services/device/ccmanual/MP402/en/pdf/DriverInstall.html>

Online Manuals (Website 5)

Manual Name	Reference Number
About Open Source Software License	M0A0-7533

To see the listed manuals, use the computer's browser to access the following website:

<https://support-download.com/services/device/ccmanual/MP402/en/pdf/Oss.html>

Online Manuals (Website 6)

Manual Name	Reference Number
Start Guide	M0A0-7534

To see the listed manuals, use the computer's browser to access the following website:

<https://support-download.com/services/device/ccmanual/MP402/en/pdf/StartGuide.html>

Online Manuals (Website 7)

Manual Name	Reference Number
Notes on Security Functions	D146-7587
Notes for Administrators: Using This Machine in a Network Environment Compliant with IEEE Std 2600.2 TM -2009	M0A0-7548

3. Manual reference numbers for "-29" models

Paper Manuals

Manual Name	Reference Number
Notes for Using This Machine Safely	D219-7074
For Users of This Product	D219-7454
Notes for Users	D241-7096
NOTICE TO USERS	D241-7178
SOFTWARE LICENSE AGREEMENT	D241-7238
Note to users	D256-8996A
Fusing Roller Cleaning Function	M160-7566B

Online Manuals (Website 1)

Manual Name	Reference Number
About This Machine	M0A0-7536
Copy/ Document Server	M0A0-7537
Fax	M0A0-7538
Print	M0A0-7539
Scan	M0A0-7540
Troubleshooting	M0A0-7541
Connecting the Machine/System Settings	M0A0-7542
PostScript 3	M0A0-7543
Security Guide	M0A0-7544
Extended Feature Settings	M0A0-7545

To see the listed manuals, use the computer's browser to access the following website:

https://support-download.com/services/device/ccmanual/MP402/en/booklist/int/index_book.htm

Online Manuals (Website 2)

Manual Name	Reference Number
Read This First	M0A0-7547

To see the listed manuals, use the computer's browser to access the following website:

<https://support-download.com/services/device/ccmanual/MP402/en/pdf/ReadThisFirst.html>

Online Manuals (Website 3)

Manual Name	Reference Number
User Guide	M0A0-7531

To see the listed manuals, use the computer's browser to access the following website:

<https://support-download.com/services/device/ccmanual/MP402/en/pdf/User.html>

Online Manuals (Website 4)

Manual Name	Reference Number
Operating Instructions Driver Installation Guide	M0A0-7532

To see the listed manuals, use the computer's browser to access the following website:

<https://support-download.com/services/device/ccmanual/MP402/en/pdf/DriverInstall.html>

Online Manuals (Website 5)

Manual Name	Reference Number
About Open Source Software License	M0A0-7533

To see the listed manuals, use the computer's browser to access the following website:

<https://support-download.com/services/device/ccmanual/MP402/en/pdf/Oss.html>

Online Manuals (Website 6)

Manual Name	Reference Number
Start Guide	M0A0-7534

To see the listed manuals, use the computer's browser to access the following website:

<https://support-download.com/services/device/ccmanual/MP402/en/pdf/StartGuide.html>

Online Manuals (Website 7)

Manual Name	Reference Number
Notes on Security Functions	D146-7587
Notes for Administrators: Using This Machine in a Network Environment Compliant with IEEE Std 2600.2™-2009	M0A0-7548

1

The manual displayed on the MultiLink-Panel may have been modified after obtaining CC-certification.

Options

The following options are not CC-certified, but can still be used with the machine.

- Handset HS1020
- Paper Feed Unit PB1060
- Paper Feed Unit PB1070
- Unicode Font Package for SAP® 1 License
- Unicode Font Package for SAP® 10 License
- Unicode Font Package for SAP® 100 License

Preparation for Use

To use the MFP in a CC-certified operating environment, the administrator must perform the procedures described on page 18 "Specifying the MFP Settings" and page 38 "Checking the MFP Settings" in advance.

The administrator should read the MFP manual thoroughly before performing the procedures described on page 18 "Specifying the MFP Settings" and page 38 "Checking the MFP Settings".

Specifying the MFP Settings

This section explains how to specify the MFP settings to establish a CC-certified operating environment.

The administrator must specify the MFP settings using the MultiLink-Panel, the control panel, or Web Image Monitor.

★ Important

- If a message prompting you to change the password at startup appears, specify passwords for the administrator and the supervisor. For details about specifying the passwords, see "Changing the Administrator's or Supervisor's Password", Notes for Using This Machine Safely.

Procedure 1: Settings to Specify Using the Control Panel 1

Using the MultiLink-Panel, specify settings in [Screen Features] so that the values are in the CC-certified ranges.

For details about configuring settings, see "Screen Features", Connecting the Machine/System Settings.

★ Important

- Delete all the icons on the Home screen except for "Address Book Management", "User Tools", "System Mes. Widget", "Fax RX File Widget", "Change Langs. Widget" and "Supply Info Widget". Do not re-register the deleted icons. Then, register the "Copier (Classic)", "Scanner (Classic)", "FAX (Classic)", "Printer (Classic)", and "Document Server" icons on the Home screen. For details about how to delete an icon, see "Deleting an Icon on the [Home] Screen", Convenient Functions. For details about adding icons, see "Adding Icons to the [Home] Screen" in "Convenient Functions".

1. Specifying [Screen Features]

The administrator must specify the settings in [Screen Features] within the ranges shown in the table on the following page.

For details about how to specify the settings, see "Screen Features", Connecting the Machine/System Settings.

Tab	Item	Settings
WIRELESS & NETWORKS	Interface Settings ▶ Interface Settings	[Wi-Fi Connection]
WIRELESS & NETWORKS	Proxy Settings ▶ Use Proxy	[OFF] (Clear)
WIRELESS & NETWORKS	Wi-Fi	[OFF] (Clear)
WIRELESS & NETWORKS	Wireless Direct Settings	[OFF] (Clear)
WIRELESS & NETWORKS	Bluetooth	[OFF] (Clear)
PERSONAL	Security ▶ Setting for Entering Authentication Password ▶ Characters to be Used for Entering Password	[Only 1 Byte Characters]
PERSONAL	Language & input ▶ iWnn IME	[OFF] (Clear)
SYSTEM	Screen Device Settings ▶ Screen SD Card Slot	[Inactive]
SYSTEM	Screen Device Settings ▶ Screen USB Memory Slot	[Inactive]
SYSTEM	Screen Device Settings ▶ Server Settings ▶ Server Function ▶ Server Function	[Inactive]
SYSTEM	Screen Device Settings ▶ IC Card/Bluetooth Software Settings ▶ Select IC Card Reader	[Do not Use]
SYSTEM	Screen Device Settings ▶ User's OwnCustomization	[Prohibit]

Procedure 2: Settings to Specify Using the Control Panel 2

In [Machine Features] in the [User Tools] menu, using the control panel, specify [System Settings], [Copier/Document Server Features], [Printer Features], [Scanner Features], [Fax Features], and [User Authentication Management] so that the specified values are in the CC-certified ranges.

For details about configuring settings in the User Tools menu, see "Accessing User Tools", Connecting the Machine/System Settings.

1. Specifying [System Settings] (1)

The administrator must specify the settings in [System Settings] within the ranges shown in the table on the following page.

For details about how to specify the settings, see "System Settings", Connecting the Machine/System Settings.

After specifying Administrator Authentication Management ► File Management, log in as the administrator to specify the MFP settings. For details about logging in as the administrator, see "Administrator Login Method" in "Getting Started", Security Guide.

★ Important

- To change the supervisor's "Login User Name" and "Login Password", log in as the supervisor.

Tab	Item	Settings
Timer Settings	Time Zone	Set the appropriate time zone. The specified setting is applied after the machine reboots.
Timer Settings	Daylight Saving Time	Set the appropriate daylight saving time. The specified setting is applied after the machine reboots. Reboot the machine after configuring this setting.
Timer Settings	Set Date	Set the appropriate date.
Timer Settings	Set Time	Set the appropriate time.
Timer Settings	Auto Logout Timer	Select [On], and then set the range for the timer between 10-999 seconds.

Tab	Item	Settings
Interface Settings	Network ▶ Machine IPv4 Address	<ul style="list-style-type: none"> Specifying a static IPv4 address Enter the IPv4 address and subnet mask. Obtaining the DHCP server address automatically Select [Auto-Obtain (DHCP)].
Interface Settings	Network ▶ IPv4 Gateway Address	Enter the IPv4 gateway address.
Interface Settings	Network ▶ DNS Configuration	<p>Specify this only if you are using a static DNS server.</p> <ul style="list-style-type: none"> Specifying a static DNS server Enter the IPv4 address in "DNS Server 1", "DNS Server 2", and "DNS Server 3". (Specify DNS Server 2 and 3 if required.) Obtaining the DHCP server address automatically Select [Auto-Obtain (DHCP)].
Interface Settings	Network ▶ Effective Protocol ▶ IPv4	[Active]
Interface Settings	Network ▶ Effective Protocol ▶ IPv6	[Inactive]
Interface Settings	Network ▶ IEEE 802.1X Authentication for Ethernet	[Inactive]
File Transfer	Fax Email Account	[Do not Receive]
Administrator Tools	Administrator Authentication Management ▶ User Management	Set [Admin. Authentication] to [On], and then select [Administrator Tools] in [Available Settings].

Tab	Item	Settings
Administrator Tools	Administrator Authentication Management ▶ Machine Management	Set [Admin. Authentication] to [On], and then select [General Features], [Tray Paper Settings], [Timer Settings], [Interface Settings], [File Transfer], and [Administrator Tools] in [Available Settings].
Administrator Tools	Administrator Authentication Management ▶ Network Management	Set [Admin. Authentication] to [On], and then select [Interface Settings], [File Transfer], and [Administrator Tools] in [Available Settings].
Administrator Tools	Administrator Authentication Management ▶ File Management	Set [Admin. Authentication] to [On], and then select [Administrator Tools] in [Available Settings].
Administrator Tools	Program / Change Administrator ▶ Administrator 1-4	Specify settings for one or more administrators. Specify the administrator's "Login User Name" and "Login Password". Assign all administrator roles (user administrator, machine administrator, network administrator, and file administrator) to a single administrator.
Administrator Tools	Program / Change Administrator ▶ Supervisor	Change the supervisor's "Login User Name" and "Login Password".
Administrator Tools	Media Slot Use ▶ Store to Memory Device	[Prohibit]
Administrator Tools	Media Slot Use ▶ Print from Memory Storage Device	[Prohibit]

2. Specifying [User Authentication Management]

The administrator must specify the settings in [User Authentication Management] in [System Settings] within the ranges shown in the following table.

For details about how to specify the settings, see "System Settings", Connecting the Machine/System Settings.

Tab	Item	Settings
Administrator Tools	User Authentication Management	[Basic Auth.]
Administrator Tools	User Authentication Management ▶ Basic Auth. ▶ Available Functions	Specify this in accordance with your operating environment. Do not set this to [Browser].
Administrator Tools	User Authentication Management ▶ Basic Auth. ▶ Printer Job Authentication	[Entire]

3. Specifying [System Settings] (2)

The administrator must specify the settings in [System Settings] within the ranges shown in the table on the following page.

For details about how to specify the settings, see "System Settings", Connecting the Machine/System Settings.

Tab	Item	Settings
Administrator Tools	Extended Security ▶ Restrict Display of User Information	[On]
Administrator Tools	Extended Security ▶ Restrict Adding of User Destinations (Fax)	[On]
Administrator Tools	Extended Security ▶ Restrict Adding of User Destinations (Scanner)	[On]

Tab	Item	Settings
Administrator Tools	Extended Security ▶ Restrict Use of Destinations (Fax)	[On]
Administrator Tools	Extended Security ▶ Restrict Use of Destinations (Scanner)	[On]
Administrator Tools	Extended Security ▶ Transfer to Fax Receiver	[Prohibit]
Administrator Tools	Extended Security ▶ Authenticate Current Job	[Access Privilege]
Administrator Tools	Extended Security ▶ Update Firmware	[Prohibit]
Administrator Tools	Extended Security ▶ Change Firmware Structure	[Prohibit]
Administrator Tools	Extended Security ▶ Password Policy	<p>Set "Complexity Setting" to [Level 1] or [Level 2], press [Change] on the right of "Minimum Character No.", and then set the number of characters to 8 or more.</p> <p>For example, to set the number of characters to 8, press the number key "8", and then "#".</p> <p>Even if you change the password policy, passwords that have already been registered can still be used. The changed password policy will be applied only to passwords specified or changed subsequently.</p>
Administrator Tools	Extended Security ▶ Security Setting for Access Violation	[Off]
Administrator Tools	Auto Delete File in Document Server	Select [Specify Days], [Specify Hours], or [Off].

Tab	Item	Settings
Administrator Tools	LDAP Search	[Off]
Administrator Tools	Service Mode Lock	[On]
Administrator Tools	Auto Erase Memory Setting	Select [On], and then select [NSA], [DoD], or [Random Numbers]. If you set this to [Random Numbers], set [Number of Erase] to three or more.
Administrator Tools	Transfer Log Setting	[Off]
Administrator Tools	Machine Data Encryption Settings	Ensure that the current data has been encrypted. If the data has been encrypted, the following message will appear: "The current data in the machine has been encrypted."
Administrator Tools	Central Management ▶ Address Book	[Do not Manage Centrally]
Administrator Tools	Shift to Main Power-Off When Network Disconnected (mainly Europe)	[Off]
Administrator Tools	Application Authentication Management	Set [Copier], [Printer], [Document Server], [Fax] and [Scanner] to [On].
Administrator Tools	Document Server Function	Select [On].

4. Specifying [Copier / Document Server Features]

The administrator must specify the settings in [Copier / Document Server Features] within the ranges shown in the following table.

For details about how to specify the settings, see "Copier / Document Server Features", Copy/Document Server.

Tab	Item	Settings
Administrator Tools	Menu Protect	[Level 2]

5. Specifying [Printer Features]

The administrator must specify the settings in [Printer Features] within the ranges shown in the following table.

For details about how to specify the settings, see "Printer Features", Print.

Tab	Item	Settings
Data Management	Menu Protect	[Level 2]
Data Management	Auto Delete Temporary Print Jobs	Select [On] or [Off].
Data Management	Auto Delete Stored Print Jobs	Select [On] or [Off].
System	Jobs Not Printed As Machn. Was Off	[Do not Print]
System	Auto Store Jobs without User Authent. Info	Make sure that [Off] is selected.

6. Specifying [Scanner Features]

The administrator must specify the settings in [Scanner Features] within the ranges shown in the following table.

For details about how to specify the settings, see "Scanner Features", Scan.

Tab	Item	Settings
Initial Settings	Menu Protect	[Level 2]
General Settings	Print & Delete Scanner Journal	[Do not Print: Delete Oldest] or [Do not Print: Disable Send]
General Settings	Download File Directly From URL Link	[Off]

7. Specifying [Fax Features]

The administrator must specify the settings in [Fax Features] within the ranges shown in the following table.

For details about how to specify the settings, see "Fax Features", Fax.

Tab	Item	Settings
General Settings	Box Setting	Set all items to [* Not Programmed].
Send Settings	Backup File TX Setting	[Off]
Reception Settings	Reception File Settings ▶ Store	[On]
Reception Settings	Reception File Settings ▶ Forwarding	[Off]
Reception Settings	Reception File Settings ▶ Print	[Off]
Reception Settings	Reception File Settings ▶ Memory Lock Reception	[Off]
Initial Settings	Menu Protect	[Level 2]
Initial Settings	Parameter Setting ▶ switch 40, bit 0	[1] If the memory for stored received faxes become full, the MFP stops receiving new faxes and keeps the stored ones without printing or deleting them.
Initial Settings	Parameter Setting ▶ switch 10, bit 0	[1] Only users who are authorized by the administrator can access, from the control panel, received faxes that are stored.
Initial Settings	Parameter Setting ▶ switch 04, bit 7	[0] If this is enabled, previews will not be included in the reports.
Initial Settings	Internet Fax Setting	[Off]
Initial Settings	Email Setting	[On]
Initial Settings	Folder Setting	[On]

Procedure 3: Settings to Specify Using Web Image Monitor

It is necessary to specify the values in [Device Settings], [Printer], [Fax], [Interface], [Network], [Security], [Webpage] and [Extended Feature Settings] in [Configuration] in [Device Management] of Web Image Monitor within the CC-certified range.

Before specifying system settings, the administrator should refer to the Web Image Monitor help. The CC-certified Web Image Monitor help can be downloaded from the following URL:

<https://support-download.com/services/device/webhlp/nb/gen/v212cc1/en/>

The help that appears when the "?" icon (Help button) in Web Image Monitor's header area is clicked may have changed after receiving CC evaluation.

Before specifying the settings, install the Web browser specified in "CC-Certified Operating Environment" in this manual on the client computer, and then connect the client computer and MFP to the network that can be accessed only by the administrator.

For details about how to launch Web Image Monitor, see "Using Web Image Monitor" in "Monitoring and Configuring the Machine", Connecting the Machine/System Settings.

1. Specifying [Device Settings]

The administrator must specify the settings in [Device Settings] within the ranges shown in the following table.

Category	Item	Settings
Device Settings	Logs ▶ Collect Job Logs	[Active]
Device Settings	Logs ▶ Job Log Collect Level	[Level 1]
Device Settings	Logs ▶ Collect Access Logs	[Active]
Device Settings	Logs ▶ Access Log Collect Level	[Level 2]
Device Settings	Logs ▶ Collect Eco-friendly Logs	[Active]
Device Settings	Logs ▶ Eco-friendly Log Collect Level	[Level 2]

Category	Item	Settings
Device Settings	Email ▶ Administrator Email Address	Enter the administrator's email address.
Device Settings	Email ▶ SMTP Server Name	Enter the SMTP server name or IP address.

2. Specifying [Printer]

The administrator must specify the settings in [Printer] within the ranges shown in the following table.

Category	Item	Settings
Printer	Basic Settings ▶ Virtual Printer	[Inactive]
Printer	Permissions for Printer Language to Operate File System ▶ PDF, PostScript	[Do not Permit]

3. Specifying [Fax]

The administrator must specify the settings in [Fax] within the ranges shown in the following table.

Category	Item	Settings
Fax	Initial Settings ▶ Cloud Fax Settings ▶ Enable/Disable Cloud Fax	[Disable]
Fax	IP-Fax Settings ▶ Enable H.323	[Off]
Fax	IP-Fax Settings ▶ Enable SIP	[Off]

Category	Item	Settings
Fax	Parameter Settings ▶ LAN-Fax Result Report	[Off]

4. Specifying [Network]

The administrator must specify the settings in [Network] within the ranges shown in the following table.

Category	Item	Settings
Network	IPv4 ▶ LLMNR	[Inactive]

5. Specifying [Security]

The administrator must specify the settings in [Security] within the ranges shown in the following table.

★ Important

- If "Network Security" ▶ "Security Level" is set to [FIPS 140], some functions become unavailable. For details about the functions that become unavailable, see "Status of Functions under Each Network Security Level" and "Enabling and Disabling Protocols" in the Security Guide.
- If the FTP or SNMP function is set to [Inactive], some functions become unavailable. For details about the functions that become unavailable, see "Enabling and Disabling Protocols" in the Security Guide.
- For details about how to specify Device Certificate, see "Protecting Communication Paths via a Device Certificate", Security Guide.
- For details about specifying IPsec, see "Configuring IPsec Settings", Security Guide.

Category	Item	Settings
Security	Device Certificate ▶Certificate 1 ▶Create	<p>Configure this to create and install the device certificate (self-signed certificate).</p> <p>If you are using a certificate issued by the certificate authority, you do not need to configure this setting.</p> <p>Of the settings for the device certificate (self-signed certificate), set "Algorithm Signature" to one of the following:</p> <ul style="list-style-type: none">• sha512WithRSA-4096• sha512WithRSA-2048• sha256WithRSA-4096• sha256WithRSA-2048• sha1WithRSA-2048

Category	Item	Settings
Security	Device Certificate ▶ Certificate 1 ▶ Request	<p>Configure this to create the request form for the certificate authority to issue the device certificate.</p> <p>If you are using a self-signed device certificate, you do not need to configure this setting.</p> <p>Of the settings for the device certificate (certificate issued by the certificate authority), set "Algorithm Signature" to one of the following:</p> <ul style="list-style-type: none"> • sha512WithRSA-4096 • sha512WithRSA-2048 • sha256WithRSA-4096 • sha256WithRSA-2048 • sha1WithRSA-2048 <p>Submit the application form to request that the certificate authority issue the device certificate.</p> <p>The request method depends on the certificate authority. For details, contact the certificate authority.</p> <p>You can install the certificate issued by the certificate authority via Web Image Monitor.</p>
Security	Device Certificate ▶ Install	<p>To use the device certificate (issued by the certificate authority), install the certificate by configuring this setting.</p> <p>If using the intermediate certificate as well, install that too.</p>
Security	Device Certificate ▶ Install Intermediate Certificate	<p>When using an intermediate certificate, configure this setting to install the certificate.</p>

Category	Item	Settings
Security	Device Certificate ▶ Certification ▶ S/MIME	Select the installed device certificate.
Security	Device Certificate ▶ Certification ▶ IPsec	Select the installed device certificate.
Security	Network Security ▶ Security Level	[FIPS 140] After setting this to [FIPS 140], be sure to click [OK].
Security	Network Security ▶ TCP/IP ▶ IPv6	[Inactive]
Security	Network Security ▶ HTTP - Port 80 ▶ IPv4	[Close] Doing this will also set "IPv4" to [Close] in "Port 80" in "IPP".
Security	Network Security ▶ SSL/TLS Version	Set "TLS1.2", "TLS1.1", and "TLS1.0" to [Active], and "SSL3.0" to [Inactive].
Security	Network Security ▶ Encryption Strength Setting	Check "AES", and uncheck "RC4" and "3DES".
Security	Network Security ▶ FTP ▶ IPv4	[Inactive]
Security	Network Security ▶ WSD (Device) ▶ IPv4	[Inactive]
Security	Network Security ▶ WSD (Printer)	[Inactive]

Category	Item	Settings
Security	Network Security ▶ WSD (Scanner)	[Inactive]
Security	Network Security ▶ SNMP	[Inactive]
Security	S/MIME ▶ Encryption Algorithm	Select [AES-256 bit] or [AES-128 bit]. When using S/MIME, it is necessary to register the user certificate.
Security	S/MIME ▶ Digest Algorithm	Select [SHA-512 bit], [SHA-384 bit], [SHA-256 bit] or [SHA1].
Security	S/MIME ▶ When Sending Email by Scanner	[Use Signatures]
Security	S/MIME ▶ When Transferring by Fax	[Use Signatures]
Security	S/MIME ▶ When Sending Email by Fax	[Use Signatures]
Security	S/MIME ▶ When Emailing TX Results by Fax	[Use Signatures]
Security	S/MIME ▶ When Transferring Files Stored in Document Server (Utility)	[Use Signatures]
Security	IPsec ▶ IPsec	Select [Active] or [Inactive]. If you set this to [Inactive], do not use Scan to Folder, and delete Scan to Folder destinations registered in the address book.

Category	Item	Settings
Security	IPsec ▶ Encryption Key Auto Exchange Settings ▶ Address Type	[IPv4]
Security	IPsec ▶ Encryption Key Auto Exchange Settings ▶ Local Address	The machine's IP address
Security	IPsec ▶ Encryption Key Auto Exchange Settings ▶ Remote Address	Connected server's IP address
Security	IPsec ▶ Encryption Key Auto Exchange Settings ▶ Security Level	[Authentication and High Level Encryption]
Security	IPsec ▶ Encryption Key Auto Exchange Settings ▶ Authentication Method	Select [PSK] or [Certificate].
Security	IPsec ▶ Encryption Key Auto Exchange Settings ▶ PSK Text	If Authentication Method has been set to [PSK], enter a character string. (Make a note of the entered character string, because it will be required when specifying the delivery server setting.)
Security	IPsec ▶ Encryption Key Auto Exchange Settings ▶ Hash Algorithm	Select [SHA1], [SHA256], [SHA384], or [SHA512].

Category	Item	Settings
Security	IPsec ▶ Encryption Key Auto Exchange Settings ▶ Encryption Algorithm	Select [3DES], [AES-128-CBC], [AES-192-CBC], or [AES-256-CBC].
Security	IPsec ▶ Encryption Key Auto Exchange Settings ▶ Diffie-Hellman Group	[14]
Security	IPsec ▶ Encryption Key Auto Exchange Settings ▶ Authentication Algorithm	Check [HMAC-SHA1-96], [HMAC-SHA256-128], [HMAC-SHA384-192] and [HMAC-SHA512-256], and uncheck [HMAC-MD5-96].
Security	IPsec ▶ Encryption Key Auto Exchange Settings ▶ Encryption Algorithm Permissions	Check [3DES], [AES-128], [AES-192] and [AES-256], and uncheck [Cleartext] and [DES].
Security	IPsec ▶ Encryption Key Auto Exchange Settings ▶ PFS	[14]
Security	User Lockout Policy ▶ Lockout	[Active]
Security	User Lockout Policy ▶ Number of Attempts before Lockout	1-5
Security	User Lockout Policy ▶ Lockout Release Timer	[Active]
Security	User Lockout Policy ▶ Lock Out User for	1-9999

6. Specifying [Webpage]

The administrator must specify the settings in [Webpage] within the ranges shown in the following table.

Category	Item	Settings
Webpage	Webpage ▶ Web Image Monitor Auto Logout Settings	3-60

1

7. Specifying [Extended Feature Settings]

The administrator must specify the settings in [Extended Feature Settings] within the ranges shown in the following table.

Category	Item	Settings
Extended Feature Settings	Administrator Tools ▶ Java™ Platform	[Inactive]

Procedure 4: Settings to Specify Using the Control Panel 3

Using the control panel, specify [System Settings] and [Fax Features] in the [Machine Features] menu so that they are in the CC-certified ranges.

1. Specifying [System Settings] (1)

The administrator must specify the settings in [System Settings] within the ranges shown in the table on the following page.

For details about how to specify the settings, see "System Settings", Connecting the Machine/System Settings.

Tab	Item	Settings
Interface Settings	Network ▶ Effective Protocol ▶ Firmware Update (IPv4)	[Inactive]

Tab	Item	Settings
Interface Settings	Network ▶ Effective Protocol ▶ Firmware Update (IPv6)	[Inactive]
Interface Settings	Network ▶ Effective Protocol ▶ @Remote Service	[Inactive]

2. Specifying [Fax Features]

The administrator must specify the settings in [Fax Features] within the ranges shown in the following table.

For details about how to specify the settings, see "Fax Features", Fax.

★ Important

- Prior to this, the administrator must register in the address book the users or groups whose access to received faxes stored in the machine's memory is authorized. For details about registering data in the address book, see "Registering Addresses and Users", Connecting the Machine/System Settings.

Tab	Item	Settings
Reception Settings	Stored Reception File User Setting	[On] After setting this to [On], specify the users or groups that can access stored reception files.

Checking the MFP Settings

After completing the procedure described on page 18 "Specifying the MFP Settings", check the log data and ROM version according to the following procedure.

You can check that the fax unit in use is a genuine product by checking that the entries in the log files and the ROM version match the following:

1. Check that the machine is off.
2. Turn the machine on.

3. Check the details of the log files that were stored in this machine.

Check that the details for "Log Type", "Result", and "Module Name" in the recorded access log are as follows:

Log Type: Firmware: Structure

Result: Succeeded

Module Name: G3

For details about logs, see "Managing Log Files", Security Guide.

4. Log on as the administrator ("admin").**5. Use the following procedure to check the fax parameter settings from the machine's control panel.**

1. Press [Fax Features].
2. Press [Initial Settings].
3. Press [Parameter Setting: Print List].
4. Press [Start].
5. Check that the following ROM version matches the one shown in the printed list:

[ROM Version]

G3: 02.00.00 (Validation Data: E59F)

6. Log off.

Changing MFP Settings during Operation

1

Of the settings specified before operation according to the procedure described on page 18 "Specifying the MFP Settings", the following setting can be changed even during operation.

1. Changing [System Settings] Using the Control Panel

Tab	Item	Settings
Timer Settings	Time Zone	Set the appropriate time zone. The specified setting is applied after the machine reboots.
Timer Settings	Daylight Saving Time	Set the appropriate daylight saving time. The specified setting is applied after the machine reboots. Reboot the machine after configuring this setting.
Timer Settings	Set Date	Set the appropriate date.
Timer Settings	Set Time	Set the appropriate time.
Timer Settings	Auto Logout Timer	Select [On], and then set the range for the timer between 10-999 seconds.
Interface Settings	Network ▶ Machine IPv4 Address	<ul style="list-style-type: none"> Specifying a static IPv4 address Enter the IPv4 address and subnet mask. Obtaining the DHCP server address automatically Select [Auto-Obtain (DHCP)].
Interface Settings	Network ▶ IPv4 Gateway Address	Enter the IPv4 gateway address.

Tab	Item	Settings
Interface Settings	Network ▶ DNS Configuration	Specify this only if you are using a static DNS server. <ul style="list-style-type: none"> Specifying a static DNS server Enter the IPv4 address in "DNS Server 1", "DNS Server 2", and "DNS Server 3". (Specify DNS Server 2 and 3 if required.) Obtaining the DHCP server address automatically Select [Auto-Obtain (DHCP)].
Administrator Tools	Program / Change Administrator ▶ Administrator 1-4	Specify settings for one or more administrators. Specify the administrator's "Login User Name" and "Login Password". Assign all administrator roles (user administrator, machine administrator, network administrator, and file administrator) to a single administrator.
Administrator Tools	Program / Change Administrator ▶ Supervisor	Change the supervisor's "Login User Name" and "Login Password".

2. Changing [User Authentication Management] Using the Control Panel

Tab	Item	Settings
Administrator Tools	User Authentication Management ▶ Basic Auth. ▶ Available Functions	Specify this in accordance with your operating environment. Do not set this to [Browser].

3. Changing [System Settings] Using the Control Panel

Tab	Item	Settings
Administrator Tools	Extended Security ▶ Password Policy	<p>Set "Complexity Setting" to [Level 1] or [Level 2], press [Change] on the right of "Minimum Character No.", and then set the number of characters to 8 or more.</p> <p>For example, to set the number of characters to 8, press the number key "8", and then "#".</p> <p>Even if you change the password policy, passwords that have already been registered can still be used. The changed password policy will be applied only to passwords specified or changed subsequently.</p>
Administrator Tools	Auto Erase Memory Setting	<p>Select [On], and then select [NSA], [DoD], or [Random Numbers].</p> <p>If you set this to [Random Numbers], set [Number of Erase] to three or more.</p>

4. Changing [Scanner Features] Using the Control Panel

Tab	Item	Settings
General Settings	Print & Delete Scanner Journal	[Do not Print: Delete Oldest] or [Do not Print: Disable Send]

5. Changing [Device Settings] via Web Image Monitor

Category	Item	Settings
Device Settings	Email ▶ Administrator Email Address	Enter the administrator's email address.
Device Settings	Email ▶ SMTP Server Name	Enter the SMTP server name or IP address.

6. Changing [Security] via Web Image Monitor

Category	Item	Settings
Security	Device Certificate ▶ Certificate 1 ▶ Create	<p>Configure this to create and install the device certificate (self-signed certificate).</p> <p>If you are using a certificate issued by the certificate authority, you do not need to configure this setting.</p> <p>Of the settings for the device certificate (self-signed certificate), set "Algorithm Signature" to one of the following:</p> <ul style="list-style-type: none">• sha512WithRSA-4096• sha512WithRSA-2048• sha256WithRSA-4096• sha256WithRSA-2048• sha1WithRSA-2048

Category	Item	Settings
Security	Device Certificate ▶ Certificate 1 ▶ Request	<p>Configure this to create the request form for the certificate authority to issue the device certificate.</p> <p>If you are using a self-signed device certificate, you do not need to configure this setting.</p> <p>Of the settings for the device certificate (certificate issued by the certificate authority), set "Algorithm Signature" to one of the following:</p> <ul style="list-style-type: none"> • sha512WithRSA-4096 • sha512WithRSA-2048 • sha256WithRSA-4096 • sha256WithRSA-2048 • sha1WithRSA-2048 <p>Submit the application form to request that the certificate authority issue the device certificate.</p> <p>The request method depends on the certificate authority. For details, contact the certificate authority.</p> <p>You can install the certificate issued by the certificate authority via Web Image Monitor.</p>
Security	Device Certificate ▶ Install	<p>To use the device certificate (issued by the certificate authority), install the certificate by configuring this setting.</p> <p>If using the intermediate certificate as well, install that too.</p>
Security	Device Certificate ▶ Install Intermediate Certificate	<p>When using an intermediate certificate, configure this setting to install the certificate.</p>

Category	Item	Settings
Security	Device Certificate ▶ Certification ▶ S/MIME	Select the installed device certificate.
Security	Device Certificate ▶ Certification ▶ IPsec	Select the installed device certificate.
Security	S/MIME ▶ Encryption Algorithm	Select [AES-256 bit] or [AES-128 bit]. When using S/MIME, it is necessary to register the user certificate.
Security	S/MIME ▶ Digest Algorithm	Select [SHA-512 bit], [SHA-384 bit], [SHA-256 bit] or [SHA1].
Security	IPsec ▶ IPsec	Select [Active] or [Inactive]. If you set this to [Inactive], do not use Scan to Folder, and delete Scan to Folder destinations registered in the address book.
Security	IPsec ▶ Encryption Key Auto Exchange Settings ▶ Local Address	The machine's IP address
Security	IPsec ▶ Encryption Key Auto Exchange Settings ▶ Remote Address	Connected server's IP address
Security	IPsec ▶ Encryption Key Auto Exchange Settings ▶ Authentication Method	Select [PSK] or [Certificate].

Category	Item	Settings
Security	IPsec <ul style="list-style-type: none"> ▶ Encryption Key Auto Exchange Settings ▶ PSK Text 	If "Authentication Method" has been set to [PSK], enter a character string. (Make a note of the entered character string, because it will be required when specifying the delivery server setting.)
Security	IPsec <ul style="list-style-type: none"> ▶ Encryption Key Auto Exchange Settings ▶ Hash Algorithm 	Select [SHA1], [SHA256], [SHA384], or [SHA512].
Security	IPsec <ul style="list-style-type: none"> ▶ Encryption Key Auto Exchange Settings ▶ Encryption Algorithm 	Select [3DES], [AES-128-CBC], [AES-192-CBC], or [AES-256-CBC].
Security	User Lockout Policy <ul style="list-style-type: none"> ▶ Number of Attempts before Lockout 	1-5
Security	User Lockout Policy <ul style="list-style-type: none"> ▶ Lock Out User for 	1-9999

7. Changing [Webpage] via Web Image Monitor

Category	Item	Settings
Webpage	Webpage <ul style="list-style-type: none"> ▶ Web Image Monitor Auto Logout Settings 	3-60

Notes for Setting up and Operation

1

- Note that regarding display and manual languages, CC certification has been obtained for English only in a network environment compliant with IEEE Std 2600.2TM-2009.
- The CC conformance standard stipulates that you request an authorized service representative to set up a CC-conformant environment.
- Before using the MFP, the encryption key to encrypt the data in the machine must be provided by the service representative or be newly created.
- Back up the encryption key only when the machine is not operating.
- For faxing, use the public switched telephone network. IP-Fax and Internet Fax are not CC conformant.
- For print jobs and fax transmissions from the client computer, use IPP-SSL authentication.
- The following message might also be displayed: "SD Card authentication has failed.". If it is, contact your service representative.
- In the event of a hard disk error, the machine displays a message asking whether or not to initialize the disk and initializes it upon receiving approval. Note however that following the hard disk initialization, user authentication might fail even though the correct password has been entered. If this happens, contact your service representative.
- "Encryption", "User Certificate", and "E-mail Address" must be specified by the administrator using Web Image Monitor. For details about installing the user certificate, see "E-mail Encryption", Security Guide.
- To send files by e-mail using the scanner or fax function, install the user certificate when registering a user in the address book and set the encryption setting to [Encrypt All]. When you display addresses to send an e-mail, a  icon appears next to destinations for which [Encrypt All] has been set.
- When using Scan to Folder, make sure IPsec is enabled.

The Scan to Folder destination (FTP or SMB server) must be registered in the address book by the administrator.

When you register the Scan to Folder destination in the address book, click [Change] in "Access Privileges" in "Protect Destination" in "Protection", and then select [Read-only] for users who are allowed to access the Scan to Folder destination.

Configure IPsec for the server selected as the Scan to Folder destination.

- Before receiving faxes, specify "Stored Reception File User Setting" in the Fax setting.
- When you configure "Program Special Sender" in the fax mode, do not specify "Forwarding per Sender" or "Memory Lock RX per Sender" before registering or changing special senders.
- The file creator (owner) has the authority to grant [Full Control] privileges to other users for stored documents in the Document Server. However, administrators should tell users that [Full Control] privileges are meant only for the file creator (owner).

- A third party may steal or read paper documents printed by this machine. Instruct users to collect printed copies immediately.
- Do not access other Web sites when using Web Image Monitor. Also, be sure to logout after you have finished using Web Image Monitor. Instruct users not to access other Web sites when they are using Web Image Monitor, and to be sure to logout when they have finished.
- Obtain log files by downloading them via Web Image Monitor. The administrator is required to properly manage the log information downloaded on the computer, so that unauthorized users may not view, delete, or modify the downloaded log information.
- To prevent incorrect timestamps from being recorded in the audit log, ensure that the File Server that connects to the MFP is synchronized with the MFP.
- If the power plug is pulled out before the main power is turned off so that the machine is shut down abnormally, the date and time when the main power is turned off (the value for "Main Power Off", which is an attribute of the eco log) is not registered correctly to the "eco" log.
- Do not use exported or imported device setting information since it is not CC-conformant.
- Do not restore the address book from an SD card, back up to the computer, or restore from the computer since these actions are not CC-conformant.
- Modification of stored file has not been rated for CC conformance.
- When you specify "HDD Erase Method" in "Erase All Memory", do not select "Format".
- Do not use applications other than "User Tools" in the application list.
- Do not assign "Reception File Settings" to a Quick Operation key in Fax mode.
- When performing "CCC: Apply Standard Values" in "Administrator Tools" in "System Settings" in Connecting the Machine/System Settings, check all settings again from "Procedure 1: Settings to Specify Using the Control Panel 1" to "Procedure 4: Settings to Specify Using the Control Panel 3" in this manual.
- When you delete all logs, make sure that the following functions are not being used:
 - Scan file storage
 - Scan file transmission
- When switching from [On] to [Off] in [Document Server Function] in [Administrator Tools] in [System Settings], delete all the received fax documents and specify the following settings again:
 - System Settings

Tab	Item	Settings
Administrator Tools	Document Server Function	Select [On].

- Fax Features

Tab	Item	Settings
Reception Settings	Reception File Settings ▶ Store	[On]
Reception Settings	Reception File Settings ▶ Print	[Off]

Trademarks

Microsoft, Windows, Windows Vista, and Internet Explorer are either registered trademarks or trademarks of Microsoft Corporation in the United States and/or other countries.

The proper names of the Windows operating systems are as follows:

- The product names of Windows Vista are as follows:

Microsoft® Windows Vista® Ultimate

Microsoft® Windows Vista® Business

Microsoft® Windows Vista® Home Premium

Microsoft® Windows Vista® Home Basic

Microsoft® Windows Vista® Enterprise

- The product names of Windows 7 are as follows:

Microsoft® Windows® 7 Home Premium

Microsoft® Windows® 7 Professional

Microsoft® Windows® 7 Ultimate

Microsoft® Windows® 7 Enterprise

- The proper names of Internet Explorer 9 and 11 are as follows:

Windows® Internet Explorer® 9

Internet Explorer® 11

Other product names used herein are for identification purposes only and might be trademarks of their respective companies. We disclaim any and all rights to those marks.

MEMO

MEMO

