

**Repair Center Manual for
Model B-C3
(Machine Code: B234/235/236)**

17 January 2006
Subject to Change

SAFETY AND ECOLOGICAL NOTES FOR DISPOSAL

1. Do not incinerate toner bottles or used toner. Toner dust may ignite suddenly when exposed to an open flame.
2. Dispose of used toner, developer, and organic photoconductors in accordance with local regulations. (These are non-toxic supplies.)
3. Dispose of replaced parts in accordance with local regulations.

Conventions in this Manual

This manual uses several symbols.





Symbol	What it means
	Refer to section number
	Screw
	Connector
	E-ring
	Clip ring
NA	North America
EUR/A	Europe/Asia

TABLE OF CONTENTS

1. REPAIR CENTER MANUAL	1-1
1.1 PRE-CHARGE UNIT	1-1
1.1.1 DISASSEMBLY	1-1
1.1.2 RE-ASSEMBLY	1-3
Corona Wire.....	1-3
Grid	1-4
1.2 CHARGE CORONA UNIT	1-5
1.2.1 DISASSEMBLY	1-5
1.2.2 RE-ASSEMBLY	1-7
1.3 DEVELOPMENT UNIT	1-10
1.3.1 DISASSEMBLY	1-10
Removing the Developer	1-10
Cleaning the Doctor Blade	1-13
Pouring in New Developer	1-15
1.3.2 REASSEMBLY	1-15
1.4 DRUM CLEANING UNIT	1-16
1.4.1 REMOVING THE 2ND CLEANING BLADE	1-16
1.4.2 REMOVING THE CLEANING BLADE	1-17
1.4.3 REPLACING THE CLEANING BRUSH	1-18
1.4.4 REPLACING THE CLEANING BLADE	1-19
1.4.5 REPLACING THE CLEANING FILTERS.....	1-20
1.4.6 RE-INSTALLING THE 2ND CLEANING BLADE	1-21
1.5 PCU.....	1-22
1.5.1 DISASSEMBLY	1-22
Removing the Drum	1-22
Replacing the Pick-off pawls	1-23
Reassembly	1-24
1.6 FUSING UNIT.....	1-25
1.6.1 DISASSEMBLY	1-25
Hot Roller Unit, Pressure Roller	1-25
Pressure Roller Cleaning Unit.....	1-28
Removing the Fusing Lamps	1-29
Disassembling the Hot Roller.....	1-31
Disassembling the Hot Roller Strippers	1-32
1.6.2 RE-ASSEMBLY	1-33
Pressure Roller	1-33
Hot Roller.....	1-34
Fusing Lamps	1-36
Replacing the Hot Roller Strippers.....	1-39
1.7 FUSING CLEANING UNIT	1-41
1.7.1 DISASSEMBLY	1-41
1.7.2 REASSEMBLY	1-43

1. REPAIR CENTER MANUAL

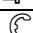
1.1 PRE-CHARGE UNIT

Required Tools:	Phillips Screwdriver, Tweezers
Parts	<ul style="list-style-type: none">• Pre-Charge Corona Grid• Pre-Charge Corona Wire

1.1.1 DISASSEMBLY

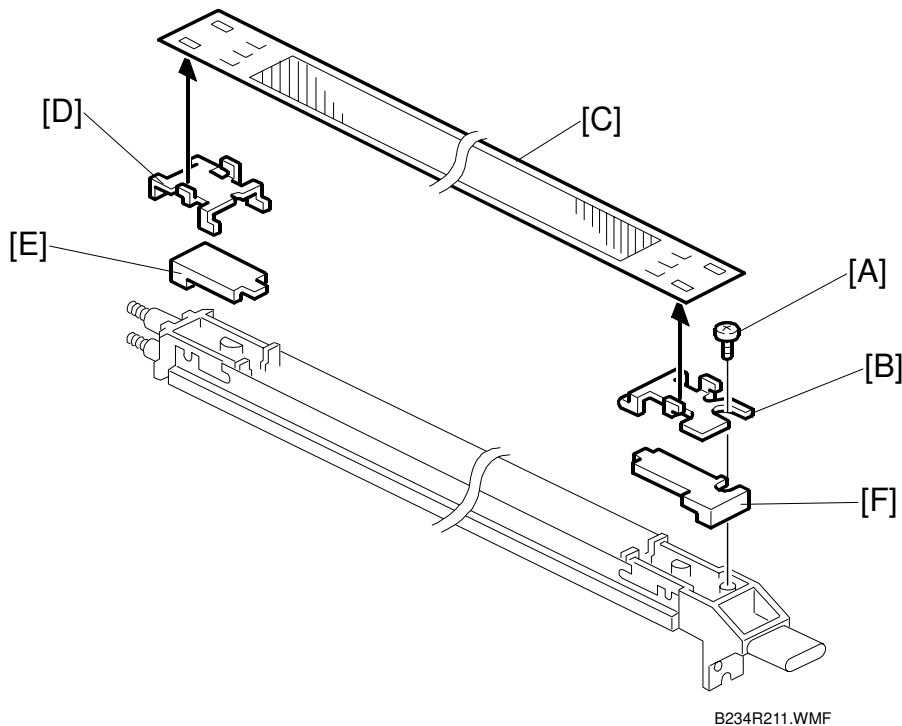

1. Remove screw [A] (⌀ x 1 M4 x 6).
2. Remove front lock plate [B] and grid [C] (Pawls x2).
3. Disconnect the grid from the hooks of the rear lock plate [D].

Important

- Hold the grid carefully at both ends.
 - Do not touch the wire mesh and avoid bending it.
4. Slide the rear lock plate off the pawls (x4) and remove it.
 5. Remove rear cover [E] and front cover [F].

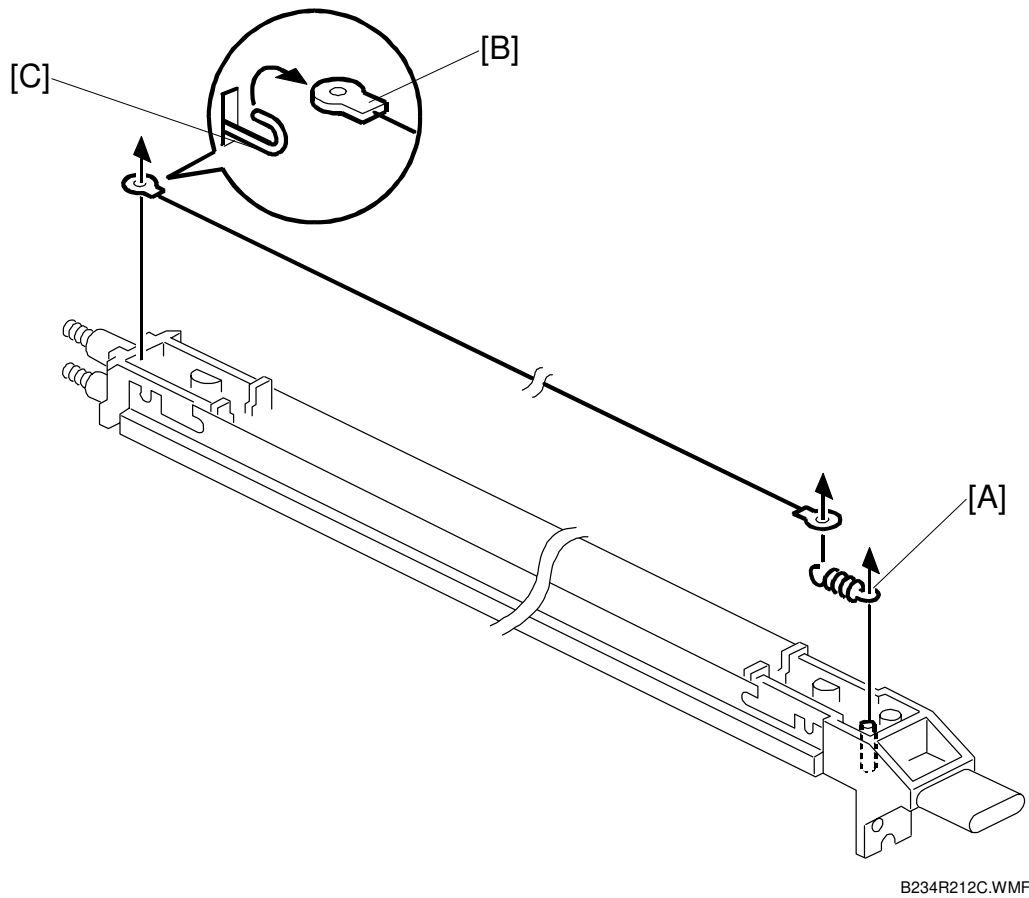

6. With the wire still attached, remove the spring [A] from the peg
7. Disconnect the eyelet of the corona wire [B] from the hook of the rear spring [C].
Important: Save the springs! You will need them to install the new corona wire.

1.1.2 RE-ASSEMBLY

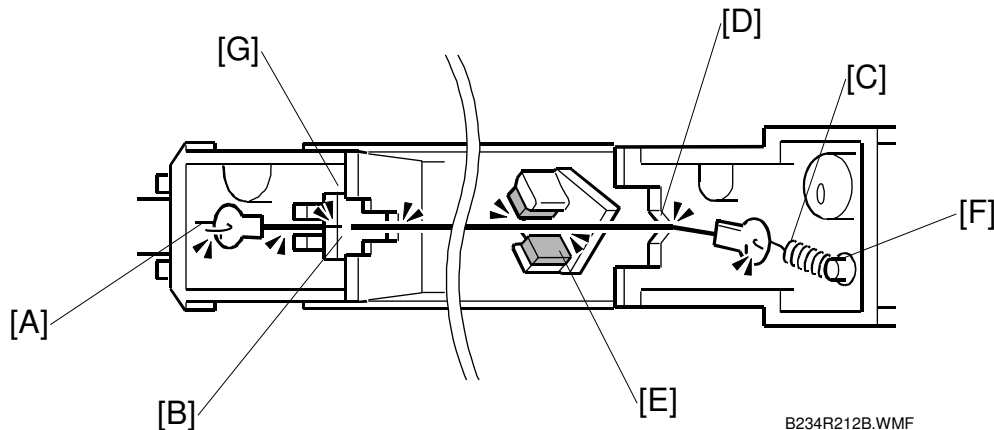

Corona Wire

1. Prepare a new corona wire as a replacement.

Important:

- Always hold the wire by the eyelets on both ends.
- Never touch any other part of the wire.
- Handle wire carefully to avoid bending it.

2. At the rear, attach the terminal of the corona wire to the spring hook [A], then set the wire in the groove [B].
3. At the opposite end of the wire, set the hook of the front spring [C].
4. Set the wire in the V-groove [D].
NOTE: Set the cleaning pad so its projection is facing the square hole in the side of the case, then gently pull the wire.
5. Set the corona wire so it is attached to the sponge of the cleaning pad at [E].
6. Attach the spring hook [F] to the base of the slender peg.
7. Push the wire completely into the slit of the cushion [G].

Checklist

- ☐ Corona wire seated in the V-groove at two locations, front and rear?
- ☐ Corona wire connected to the cleaning pad at both locations?
- ☐ Corona wire inserted completely into the cushion?
- ☐ Is the cushion slit facing straight up?
- ☐ Is the hook of the front spring attached securely to the slender base of the peg?

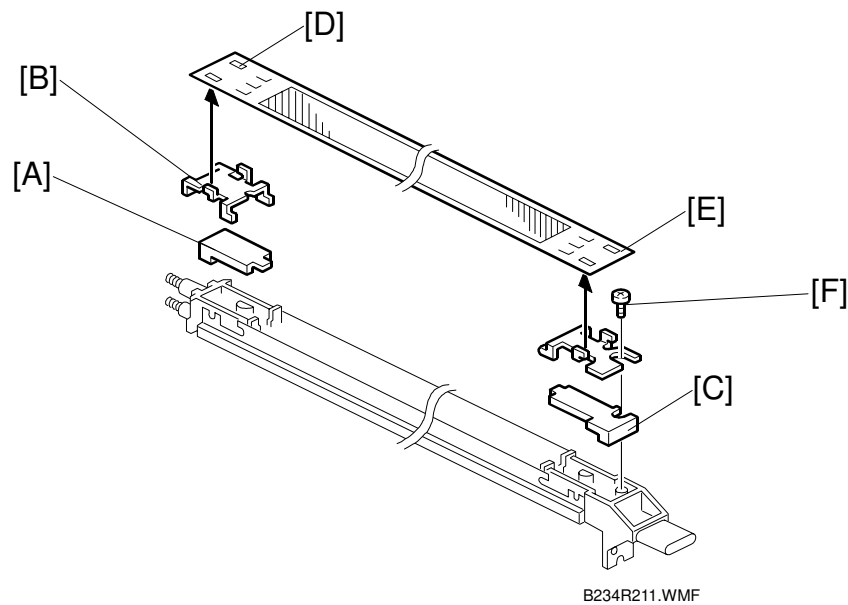
Grid

1. Attach the rear cover [A].
2. Attach the rear lock plate [B] (Pawls x4).
3. Attach the front cover [C].
4. Prepare a new grid as a replacement.

Important:

- Always handle the grid carefully by its edges.
 - Never touch any part of the wire mesh. Handle it carefully to avoid bending it.
5. At the rear, set the two holes of the grid [D] onto the two pawls of the rear lock plate.
 6. At the front, set the two holes of grid [E] onto the pawls of the front lock plate.
 7. While holding the grid on top of the front lock plate, lock them onto the frame (Pawls x2).
 8. While gently pressing down on the top of the grid and front lock plate, fasten the screw [F] (⌀ x 1 M4 x 6).
 9. Push cleaning pad to the front of the unit.
 10. Use a blower brush around the wire to remove any dust.

Checklist

- ☐ Is the wire mesh of the grid warped or covered with dust?
- ☐ Is the cleaning pad at the front of the unit?

1.2 CHARGE CORONA UNIT

Required Tools:	Phillips Screwdriver, Tweezers
Parts	<ul style="list-style-type: none"> • Charge Corona Grid • Charge Corona Wire • Cushions • Cleaner Pad

1.2.1 DISASSEMBLY

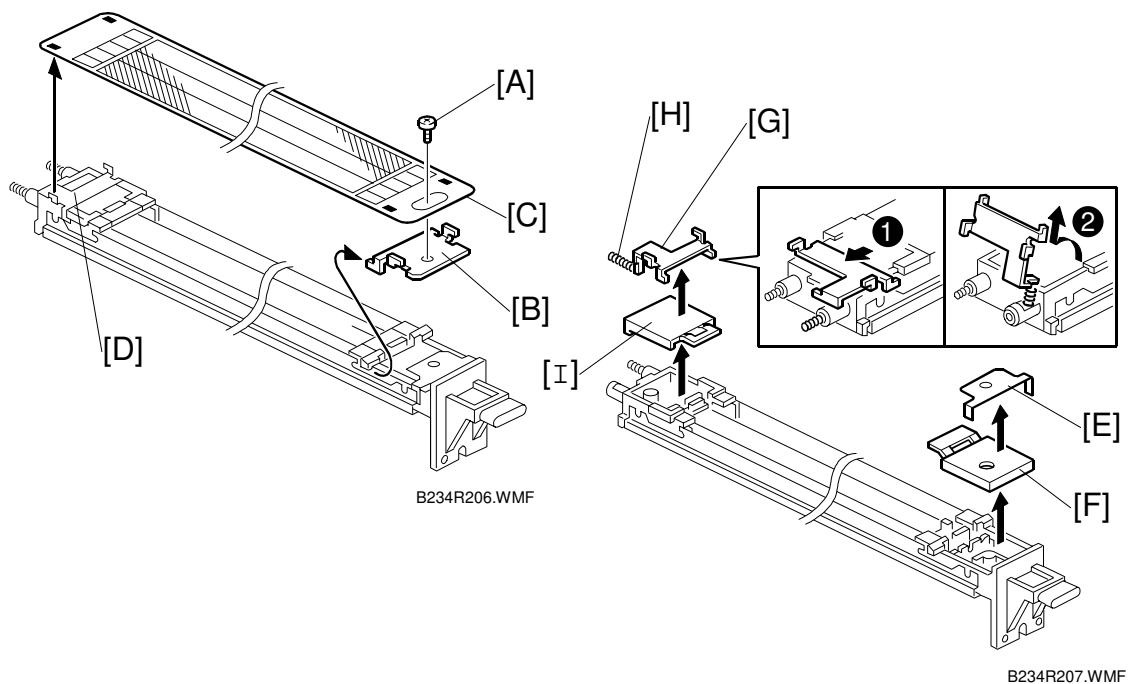

1. Remove the screw [A] (⌀ x 1 M4 x 8).
 2. Disconnect the front stay [B] and grid [C] (Pawls x2).
 3. Disconnect the grid from the pawls [D].
- Important:**
- Always handle the grid carefully by its edges.
 - Never touch any part of the wire mesh. Handle it carefully to avoid bending it.
4. Remove the terminal plate [E].
 5. Remove the front cover [F].
 6. Slide off the rear lock plate ❶ → ❷ (Pawls x4) and remove it with the spring [G].
 7. Remove the rear cover [I].

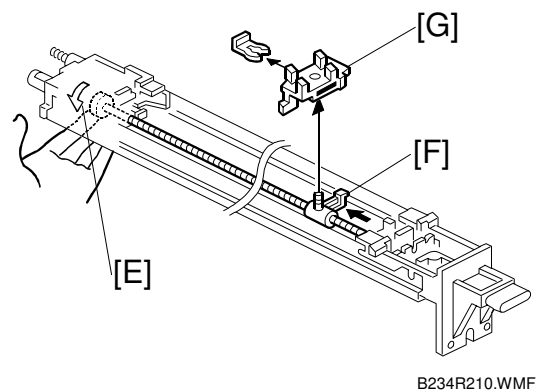
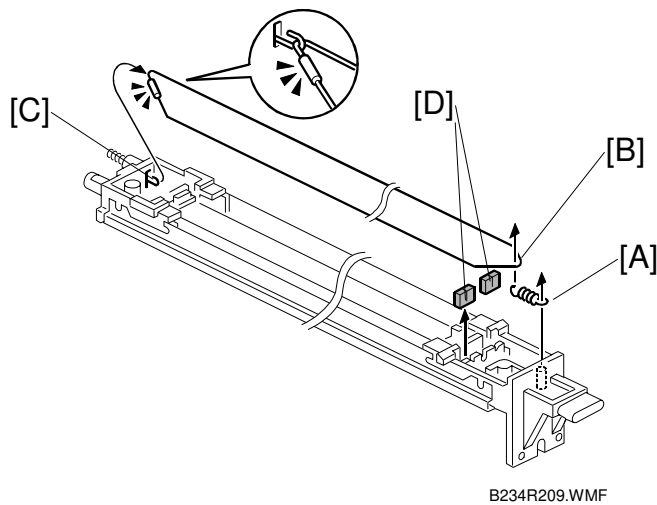

8. Disconnect the front spring [A] and corona wire [B]
9. Disconnect the corona wire from the rear hook [C] and remove the wire.

Important

- Always hold the wire by its metal fitting and its opposite end.
 - Never touch any other part of the wire.
 - Handle the corona wire carefully to avoid bending it.
10. Remove the two cushions [D].
 11. Turn the gear [E] to move the cleaner assembly [F] to a location where the cleaner is easy to access.
 12. Remove the cleaner pad [G] (☞ x1).

1.2.2 RE-ASSEMBLY

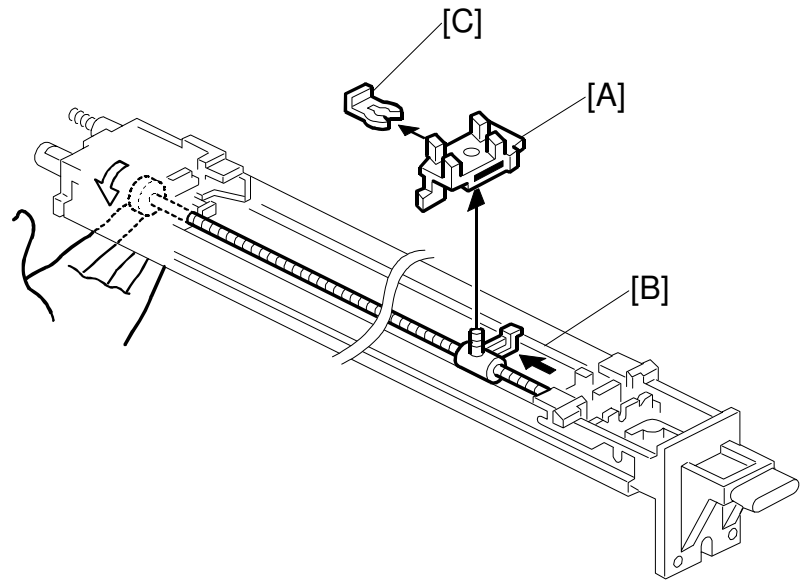

B234R210.WMF

1. Prepare a new cleaner pad as a replacement.
Important: Never touch the sponge surfaces of the four pads.
2. Set the cleaner [A] on slide rails [B] as shown.
3. With its flange facing up, insert the C-ring [C], then push in to insert it.
Important: Make sure that the flange is facing up.

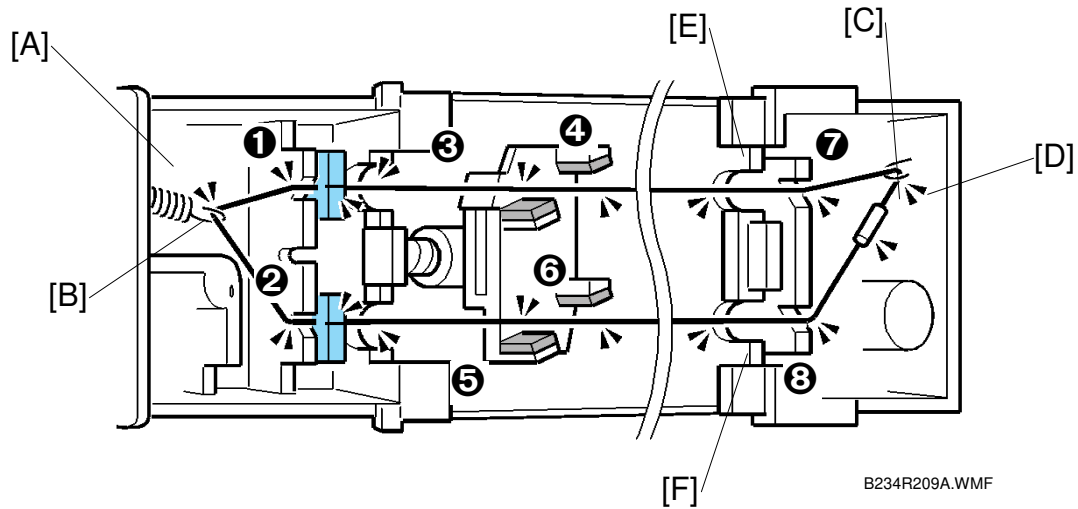

4. Prepare a new corona wire as a replacement.
Important: Handle the corona wire carefully with tweezers to avoid touching any other part of the wire.
5. Attach the end of the wire with the metal fitting to the hook of the rear spring [A].
Important: Make sure that the metal fitting [B] on the corona wire is near the side of the spring hook as shown.
6. Insert the corona wire into the V-grooves at two points ❶ and ❷.
7. Attach the corona wire to the cleaning pads at four points ❸, ❹, ❺, ❻.
8. At the front, insert the corona wire into the V-groove at two points ❼, ❽.
9. Attach the corona wire to the hook of the tension spring [C].
10. Attach the tension spring to the base of the slender peg on the front end block [D].
11. Prepare new cushions as replacements.
12. Gently split open the slit of each cushion and,, then from above the corona wire push the cushion onto the wire.
13. Use a pair of tweezers to rotate each cushion [E] and [F] 180 degrees so cushion slit is facing straight up.

Checklist

- ☐ When viewing from the where the grid is installed, is the C-ring installed so its flange up?
 - ☐ Is the C-ring inserted completely?
 - ☐ Is the metal fitting on the corona wire positioned near the rear spring?
 - ☐ Is the corona wire seated in the V-grooves at the front and rear at all four points?
 - ☐ Is the corona wire connected to the cleaning pad all four points?
 - ☐ Are the cushion slits facing straight up?
 - ☐ Is the corona wire inserted completely into the cushions?
 - ☐ Is the hook of the front spring attached securely to the slender base of the peg?
14. Attach the rear cover.
15. Pass the spring attached to the rear lock plate through the holes of the rear end block, then attach the rear lock plate (Pawls x3).
16. Attach the front cover.
17. Insert the pawls (x2) of the electrical terminal into the side of the metal plate, align with the hole, then press down to lock it in place.
18. Prepare a new grid as a replacement.
- Important:** Hold the grid by its edges, and do not touch any part of the wire mesh. Handle it carefully to avoid bending it.
19. Attach the grid to the lock plate (Pawls x2).
20. Attach the opposite end of the grid to the front stay (Pawls x2), then attach the front stay to the front end block (Pawls x2).
21. While gently pressing down on the top of the grid and front stay, fasten them with the screws (🔩 x1 M4 x 8).
22. Use a blower brush to remove any dust or dirt.

Checklist

- ☐ Can you visually detect if the wire mesh of the grid is bent or dirty?
- ☐ Is the U-groove of the slide mounted on the rail?
- ☐ Are the ribs of the cleaner in the grooves of the rail?
- ☐ Is the cleaning pad at the front of the unit?
- ☐ Is the electric terminal inserted into the metal plate?
- ☐ Is the spring of the rear lock plate inserted and not floating free?
- ☐ Is the leaf spring screw of the ground or terminal spring bent?

1.3 DEVELOPMENT UNIT

Required Tools:	Screwdriver, Paper Dust Cleaner, Clean Rags, Vacuum Cleaner, Blower Brush
Parts	<ul style="list-style-type: none"> • Developer • Paper Dust Cleaner A2949560

1.3.1 DISASSEMBLY

Removing the Developer

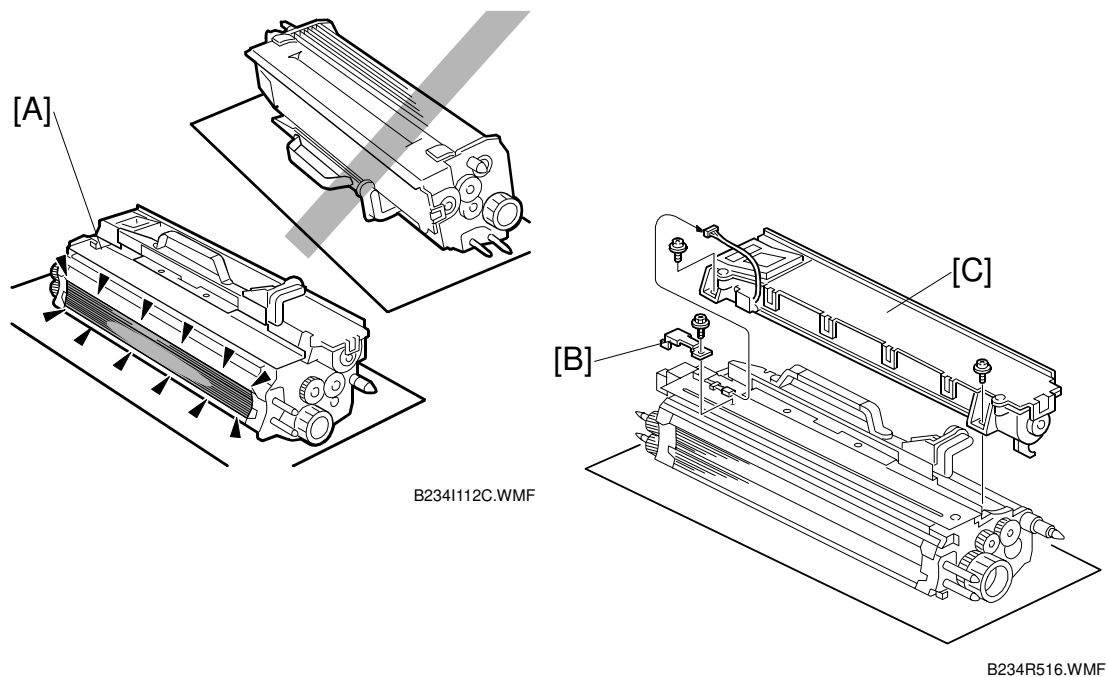

1. Lay the development unit [A] on some clean paper.
2. Remove bracket [B] (⚙️ x1).
3. Remove the toner hopper [C] (🔧 x1, ⚙️ x2).

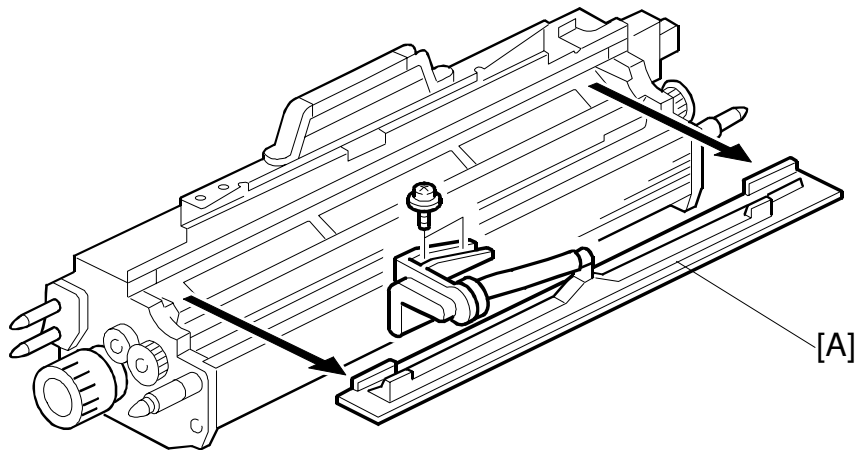

B234R522.WMF

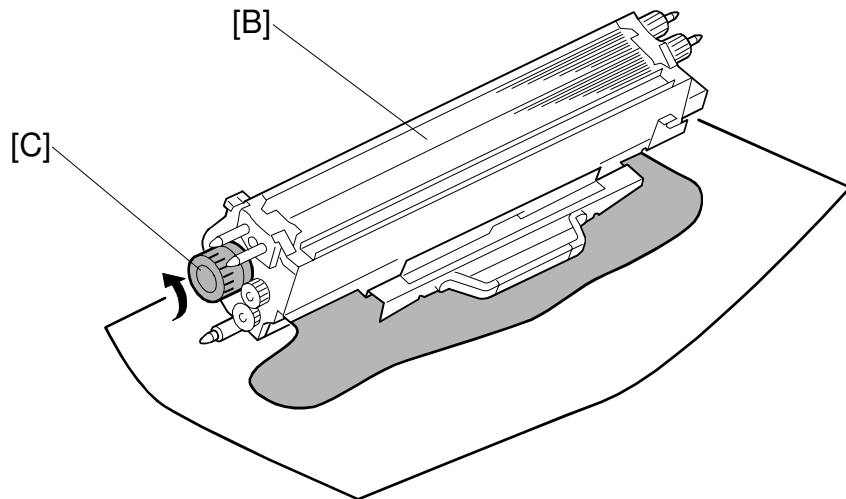

B234R523.WMF

4. Remove the development unit top cover [A] (⚙ x2)
5. Turn the development unit [B] upside down, then rotate the knob [C] counter-clockwise to push out the developer.

Important: When you dispose of the developer, obey the local laws and regulations regarding the disposal of such items.

6. Visually check to see any developer remains inside the development unit or on the rollers.

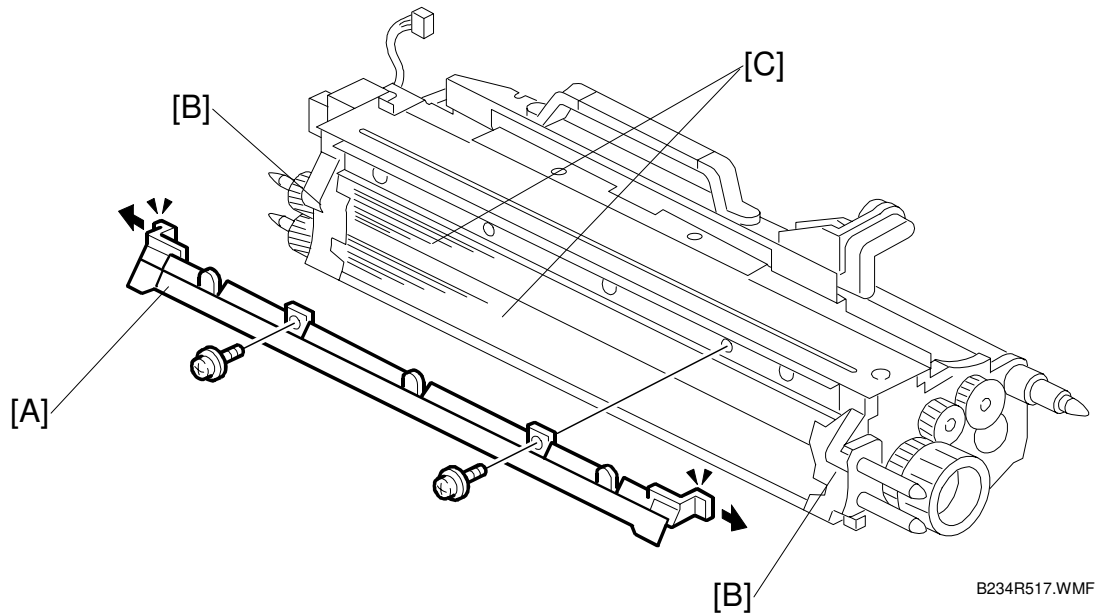

7. Remove the entrance seal [A] (x2) and clean it. Use a blower brush and clean dry cloth to clean.

Important: Handle the removed seal carefully and keep the mirror side facing up.

8. Use a clean, dry cloth to wipe clean the side seals [B].

Important: Handle the side seal carefully to avoid twisting or bending it.

9. Use a clean dry cloth and vacuum cleaner to clean the both development sleeves [C].

NOTE: Work carefully to avoid damaging the side seals.

Cleaning the Doctor Blade

Always clean the doctor blade before refilling the development unit with new developer.

Part Number	Description
A2949560	Paper Dust Cleaner - 5pcs/set

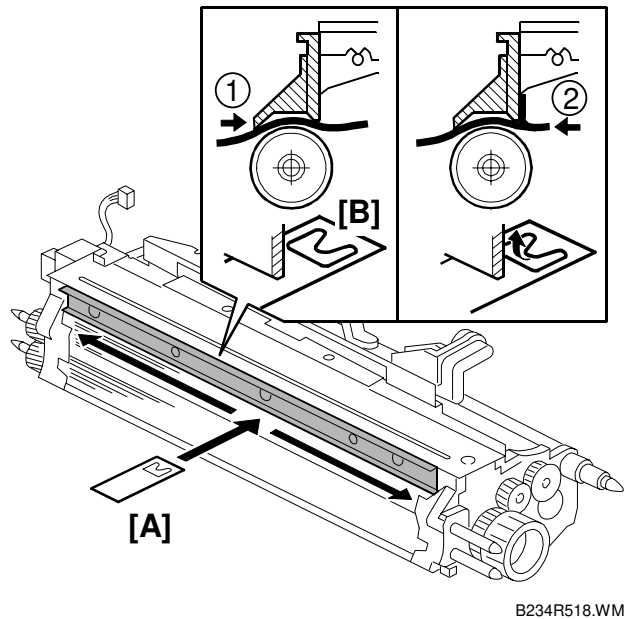

B234R518.WMF

Important:

- Always clean the doctor blade before refilling the development unit with new developer.
 - The paper dust cleaner is made of soft, thin plastic.
 - Always make sure that the tool is completely horizontal before you use it.
1. Flatten the paper dust cleaner before you use it.
 2. Hold the paper dust cleaner [A] perfectly level.
 3. Insert the cleaner into the gap ① until the flap [B] is not visible.
 4. Gently pull the cleaner toward you slowly ② until you feel slight resistance so the flap catches and flips up on the rear side of the doctor blade.
Important: If you pull with too much force, the flap will lose contact with the rear side of the blade or could break.
 5. While continuing to gently pull on the cleaner so it remains in contact with the back side of the blade, slide the cleaning tool 5 times completely to the left and right. This removes paper dust from the back of the blade.

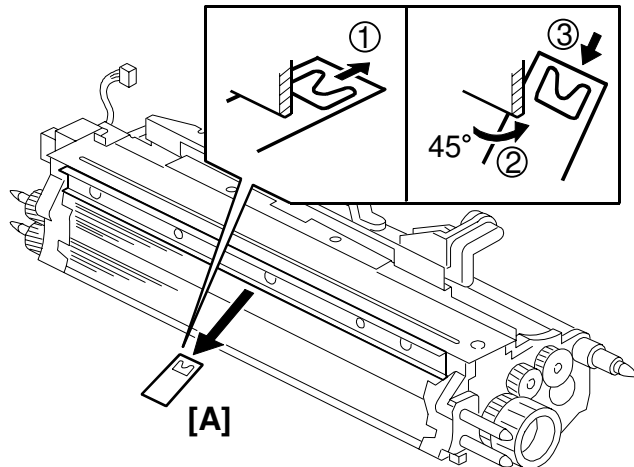

B234R519.WMF

6. When you are ready to remove the cleaning tool:
 - Push cleaner [A] in slightly about 10 mm (1/2") ①. This releases the flap from the back of the blade and allows it to lie flat.
 - Tilt the cleaning tool up to about a 45 degree angle, then slowly pull it out of the slit.
 - Turn the cleaner slightly to the left or right if you feel any resistance.
7. After removing the cleaner, rotate the development roller toward you about 10 mm (1/2").
8. Use a vacuum cleaner to remove any of the toner dust or developer.
9. Repeat Steps 1 to 6 about five times.
10. Hold the development unit upside down, and shake it gently to remove any remaining paper dust or developer.
11. Clean the work area thoroughly with the vacuum cleaner.

Checklist

- ☐ Has the special tool been removed?
- ☐ Are the pawls of the entrance seal attached securely to the frame? Have you double-checked the following points?
- ☐ Is there any dirt, dust, developer on the gears?
- ☐ Have the side seals been damaged?
- ☐ Is the harness of the TD sensor inside the groove of the guide?

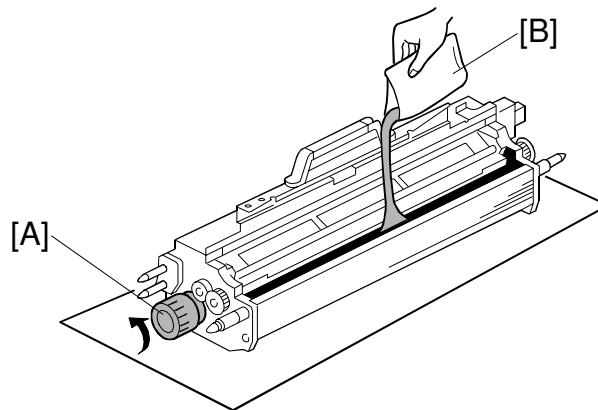
Pouring in New Developer

B234R521.WMF

1. Before refilling the development unit with new developer, use a blower brush to remove dirt, dust, or developer from the gears.
2. Cover the sleeve roller with a piece of clean paper to prevent any of the new developer from spilling onto the roller.
3. Turn knob [A] counter-clockwise as you pour new developer [B] into the development unit while moving the package from side to side to distribute the developer evenly.
4. If any of the new developer spills onto the sponge seal where the developer is poured into the unit, use a vacuum cleaner to clean the sponge seal.

1.3.2 REASSEMBLY

1. Re-attach:
 - Entrance seal (⌘ x2)
 - Development unit top cover (⌘ x2)
 - Bracket (⌘ x1) and toner hopper (⌘ x2, ⌘ x1)

Checklist

- ☐ Is the TD sensor connector free and not pinched?
- ☐ Are the pawls of the entrance seal attached securely to the frame?

1.4 DRUM CLEANING UNIT

Required Tools:	Phillips Screwdriver, Vacuum cleaner
Parts	<ul style="list-style-type: none">• Cleaning Blade• Cleaning Brush• Cleaning Filters

1.4.1 REMOVING THE 2ND CLEANING BLADE

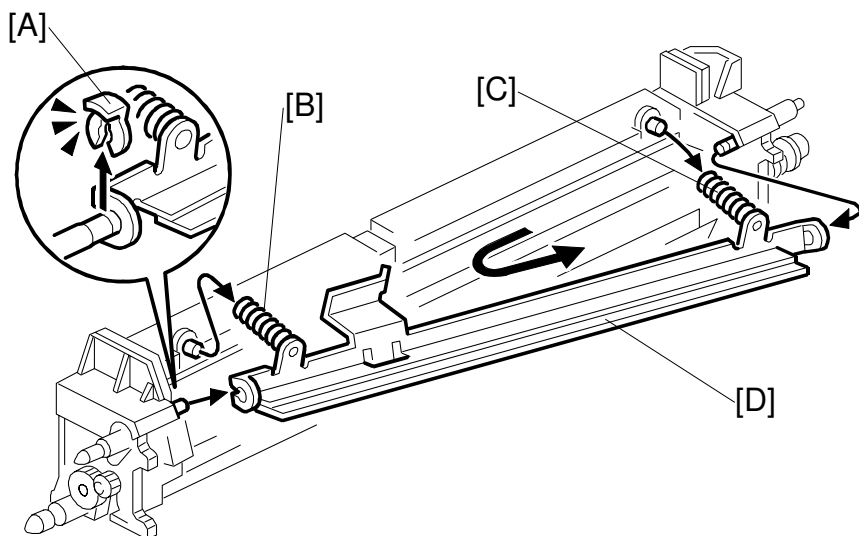

B234R214.WMF

1. Remove C-ring [A] (⌘ x1).
2. Remove pressure springs [B] and [C](x2).
3. Slide the 2nd cleaning blade [D] off of the shaft from the right.

1.4.2 REMOVING THE CLEANING BLADE

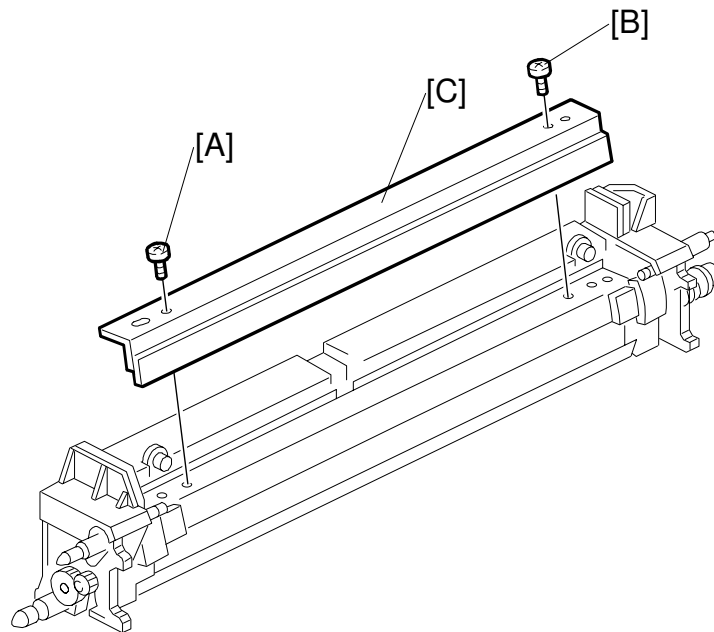

B234R215.WMF

1. Remove the screws [A] and [B] (⌀ M4 x 4).
2. Remove the cleaning blade [C].

1.4.3 REPLACING THE CLEANING BRUSH

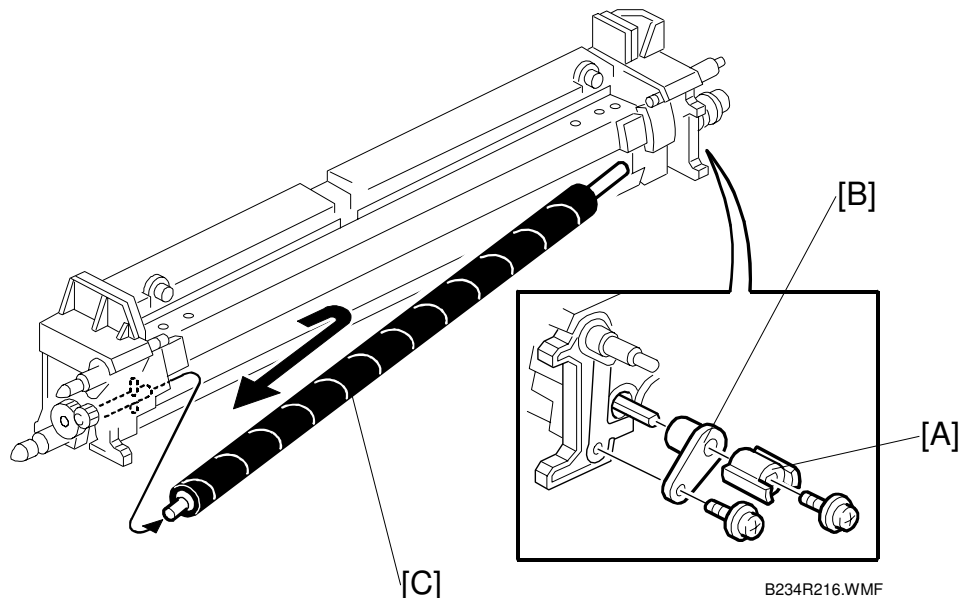

1. Remove the coupling [A] (⌘ x1).
2. Remove the bushing [B] (⌘ x1).
3. Push the cleaning brush [C] to the rear, then pull forward to remove it.
4. Use the vacuum cleaner to remove the toner inside the cleaning unit.
5. Install a new cleaning brush.
6. Re-install the bushing [B] and coupling [A].

NOTE: When tightening the screws hold the coupling with a wrench to keep it from turning with the screw).

Important

- Never touch the soft surface of the cleaning brush.
- When installing the cleaning brush, avoid bending or damaging the entrance seal with the cleaning brush.
- Before installation confirm that the cleaning brush has not been flattened by falling over.

1.4.4 REPLACING THE CLEANING BLADE

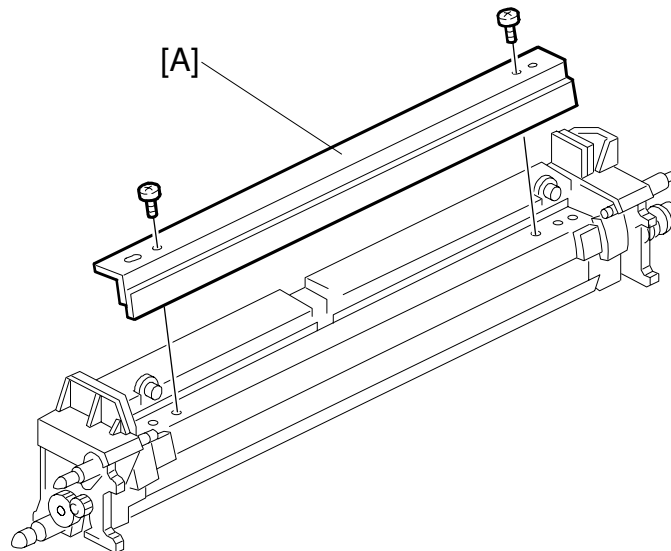

B234R215.WMF

Important

- The edge of a new cleaning blade is covered with setting powder, so never touch the edge of the blade.
 - If you touch the edge or if the powder is removed by mistake, apply some clean toner to the edge of the blade.
 - Avoid pinching the side seal when you install the cleaning blade.
1. Check the sponge at both ends of the new cleaning blade [A].
 2. Attach the new cleaning blade to the cleaning unit (⚙ x2 M4x4).

1.4.5 REPLACING THE CLEANING FILTERS

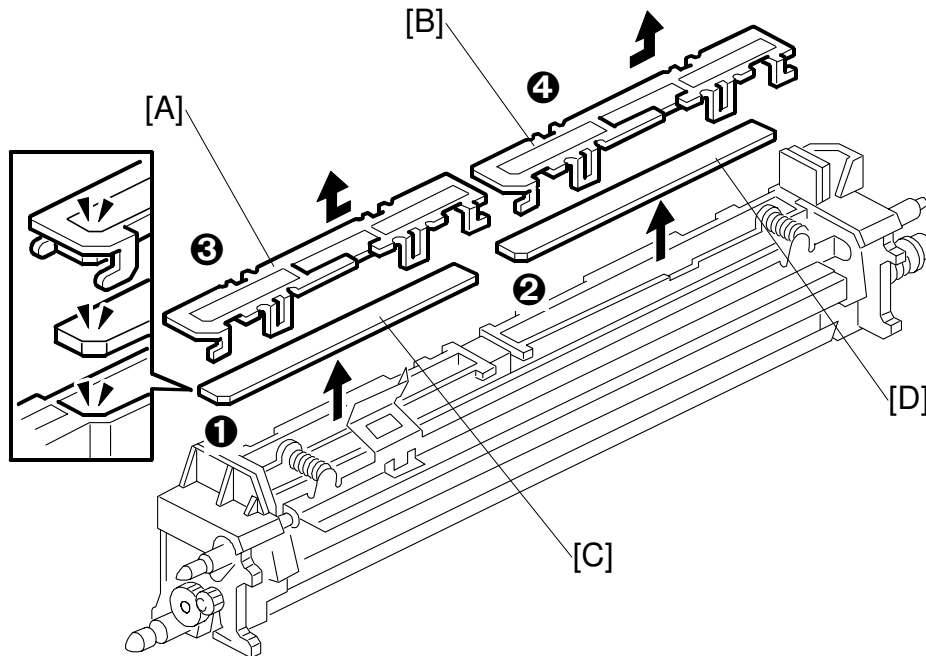

B234R213.WMF

1. Detach the pawls (x2) of the front filter cover [A] and remove it in the direction of the arrow.
2. Detach the pawls (x2) of the rear filter cover [B] and remove it in the direction shown by the arrow.
3. Remove the front cleaning filter [C].
4. Remove the rear cleaning filter [D].
5. Install the new cleaning filters (front and rear).

Important: When you install the new filters, confirm that the notched corners ① and ② of the filters fit tightly to the beveled corners of the plastic below.

6. Re-attach the filter covers [A] and [B].
 - Make sure that the notches ③ and ④ are facing left.
 - Install the front and rear covers follow the opposite direction of the arrows shown above.
 - Gently press down to confirm that the pawls are engaged.

1.4.6 RE-INSTALLING THE 2ND CLEANING BLADE

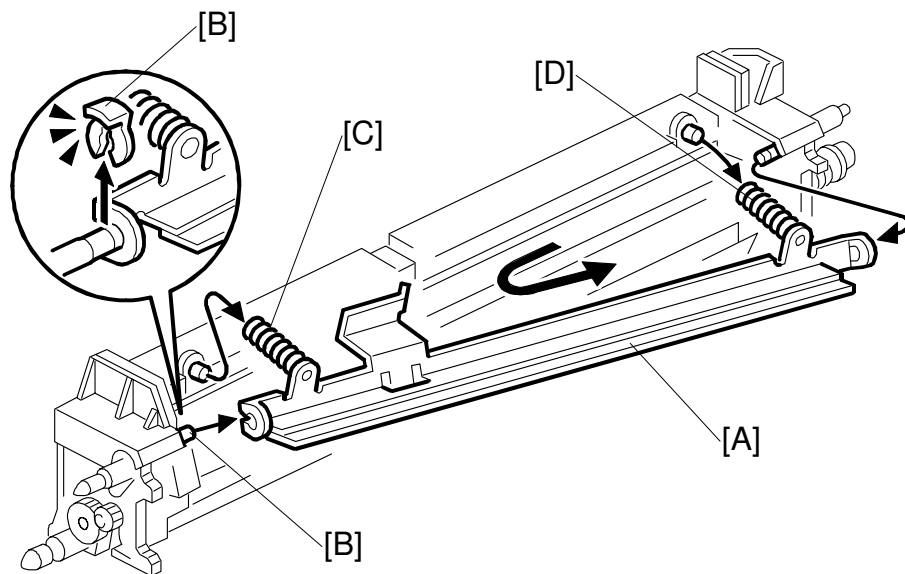

B234R214.WMF

1. Insert the 2nd cleaning blade [A] onto its support shaft [B].
2. Set the C-Ring (☺) [B] in the groove of the 2nd cleaning blade shaft.
NOTE: Make sure the rim (angled side) of the C-ring is facing out (flat side in).
3. Attach the springs [C] and [D].
4. Confirm that the blade moves smoothly.

1.5 PCU

Required Tools:	Required Tools: Screwdriver, Vacuum cleaner
Parts	<ul style="list-style-type: none">• Drum Setting Powder 54429101• Drum• Pick-off Pawls

1.5.1 DISASSEMBLY

Removing the Drum

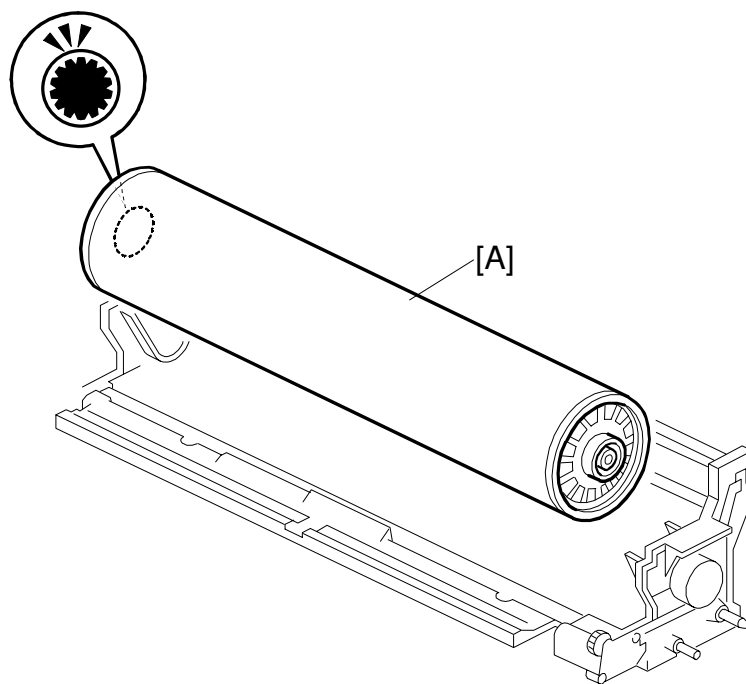

B234R201.WMF

1. Remove the drum [A] from the PCU.
2. Use the vacuum cleaner to clean the PCU.

Replacing the Pick-off pawls

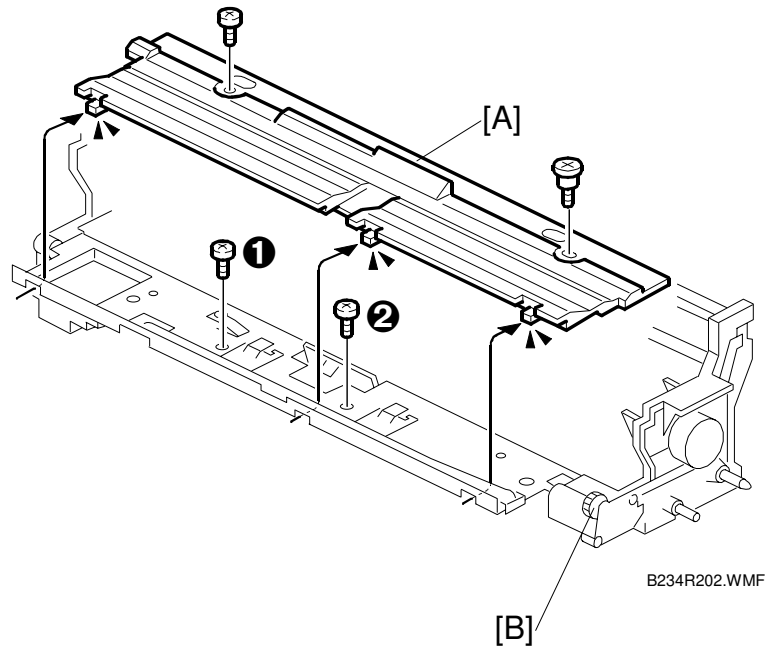

1. Remove the pick-off pawl cover [A] (⌘ x2)
2. Remove the pick-off pawl unit screws ❶, ❷ (⌘ x2)
3. Remove the pick-off pawl assembly.

NOTE: To remove, turn gear [B] as you pull the pawl assembly [C] to the front as shown.

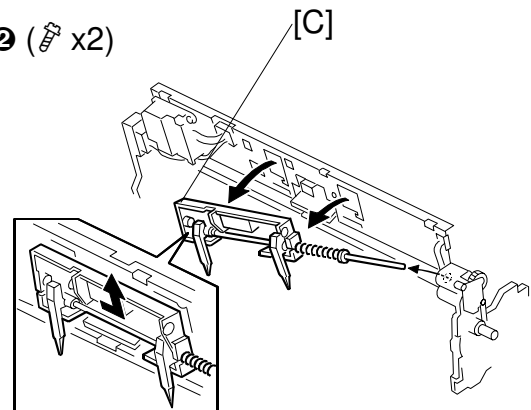

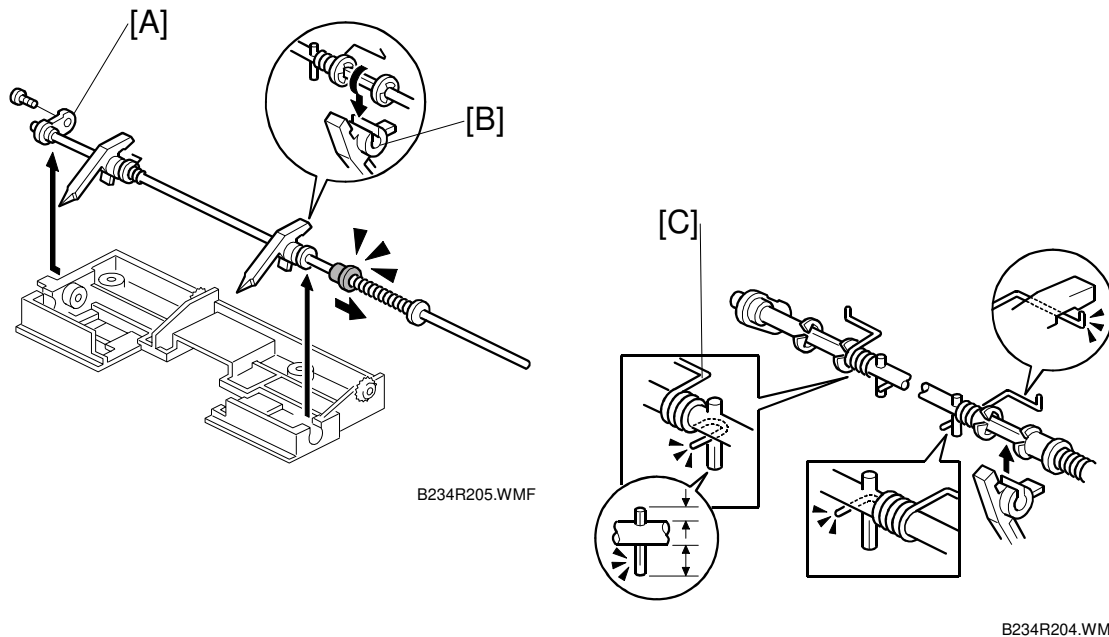

4. Detach the front end of the shaft [A] (⌘ x1) then lift the shaft. out of the grooves.
5. Rotate the pick-off pawl [B] 45 degrees, then remove it.
6. Install a new pick-off pawl by rotating it onto the shaft.
7. Do not forget to hook the tension springs [C].
8. Follow the same procedure to replace the other pick-off pawl.

Important

- Make sure the pawl springs are attached inside the pick-off pawl.
- After replacing the pick-off pawls, press down on each one to confirm that it moves freely.

Reassembly

1. Attach screw at [A] (⌘ x1, Ⓢ x1).
2. Reattach the pick-off pawl assembly to the PCU frame (⌘ x2).
3. Refasten pick-off pawl unit from the top ⌘ x1.
4. When you re-attach the cover, confirm:
 - Small screw on the left
 - Step screw on the right

1.6 FUSING UNIT

Required Tools:	Screwdriver, Tweezers, Paper to cover the fusing unit, Clean cloth for cleaning, Grease (Barrierta S552R)
Parts	<ul style="list-style-type: none"> • Hot Roller • Hot Roller Strippers • Pressure Roller

1.6.1 DISASSEMBLY

Hot Roller Unit, Pressure Roller

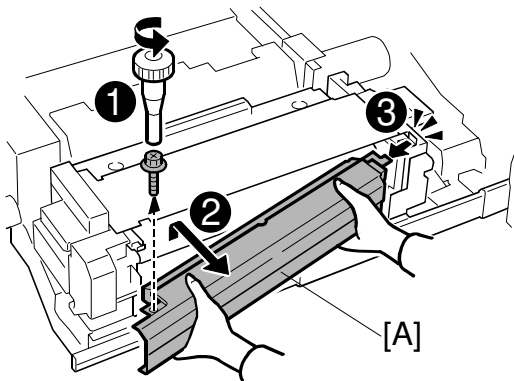

B234I105.WMF

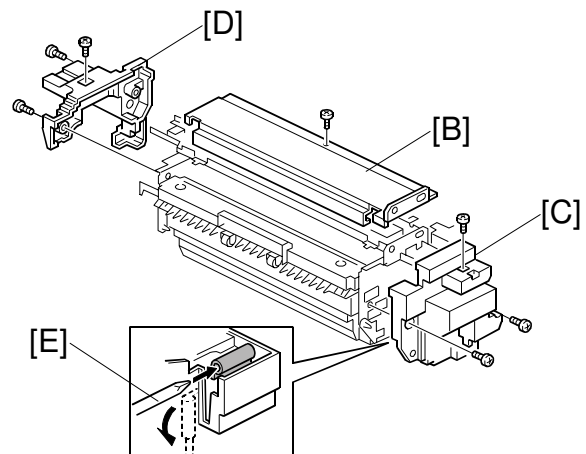

B234R501A.WMF

1. Remove the fusing cleaning unit. [A] (⚙ x1)
2. Remove the top cover [B]. (⚙ x1)
Important: The top cover of the B234/B235 is Black, the cover of the B236 is Yellow.
3. Remove the front cover [C]. (⚙ x3)
4. Remove the rear cover [D]. (⚙ x3)
5. Insert a screwdriver [E] and turn 90 down degrees in the direction of the arrow to release the nip between the hot roller and the pressure roller.

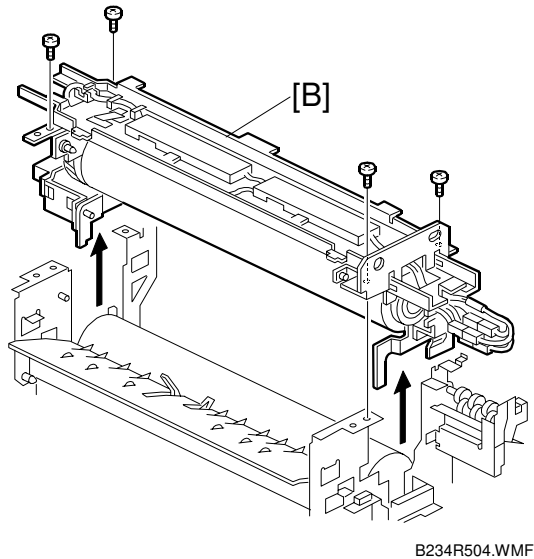
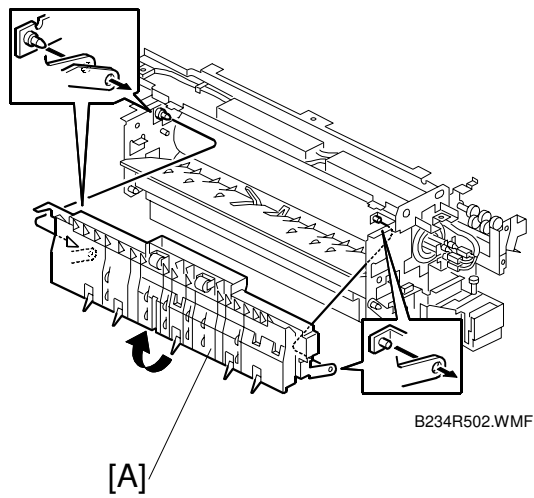

6. Turn the hot roller stripper unit [A] 90 degrees in the direction of the arrow, then slide it to the front and remove it.

Checklist

- ☐ Nip released?

7. Remove the hot roller unit [B]. (⚙ x4)

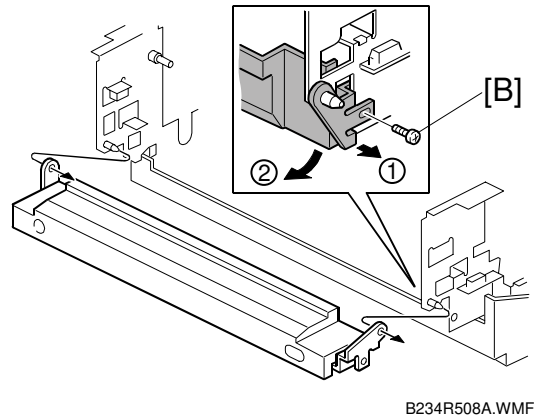
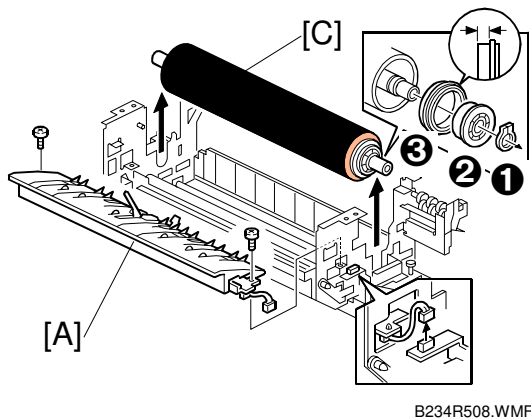

8. Disconnect and remove the pressure roller stripper unit [A] (⌘ x1, ⌘ x2)
9. Check the body of the pressure roller stripper unit and the points of the stripper pawls, and clean them with a clean cloth if they are dirty.
10. Remove screw [B] (⌘ x1).
11. Push the pressure roller cleaning unit toward ①, rotate it toward ②, then remove it.
12. Remove the pressure roller [C].
13. On both ends of the pressure roller remove:
 - ❶ C-rings (1 front/back)
 - ❷ Ball bearing races (1 front/back)
 - ❸ Bushings (1 front/back)

Checklist

- ☐ Do the ball bearing races rotate smoothly without catching?
- ☐ No chips or cracks on the ribs of the pressure roller stripper unit?

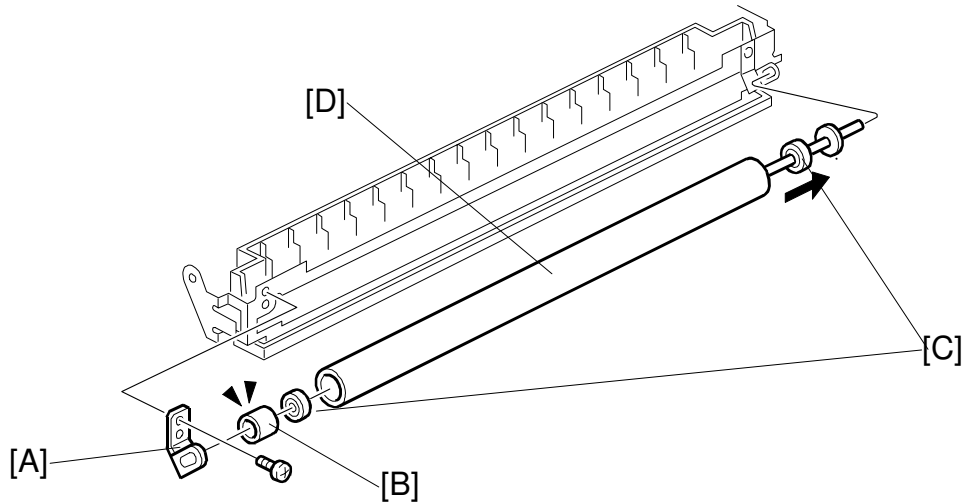
Pressure Roller Cleaning Unit

1. Remove:
 - [A] Plate (⚙ x1)
 - [B] Bushing x1
 - [C] Bearings x2
 - [D] Metal scavenger roller
2. Clean the metal roller with a clean cloth.
3. Reassemble the disassembled cleaning roller unit and re-install it. (⚙ x1)

Checklist

- ☐ Do both bearing races rotate smoothly without catching?

Removing the Fusing Lamps

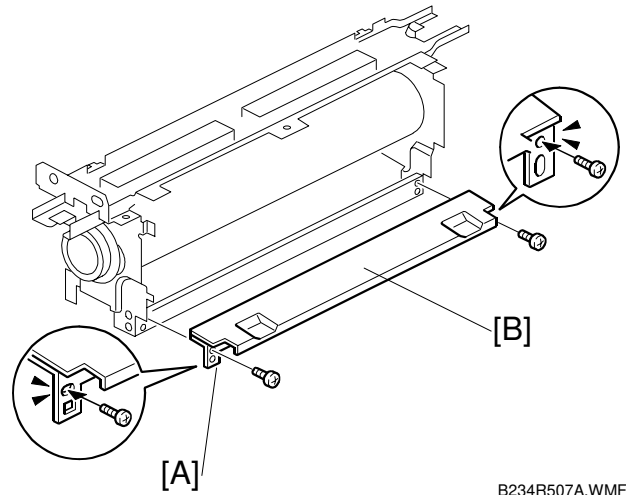

B234R507A.WMF

1. Remove the entrance guide plate [A] (⚙ x2).
2. Use a dry cloth to clean the front surface [B] of the entrance guide plate.

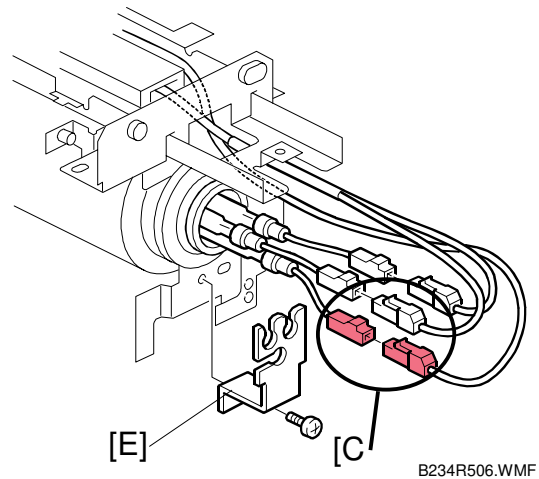
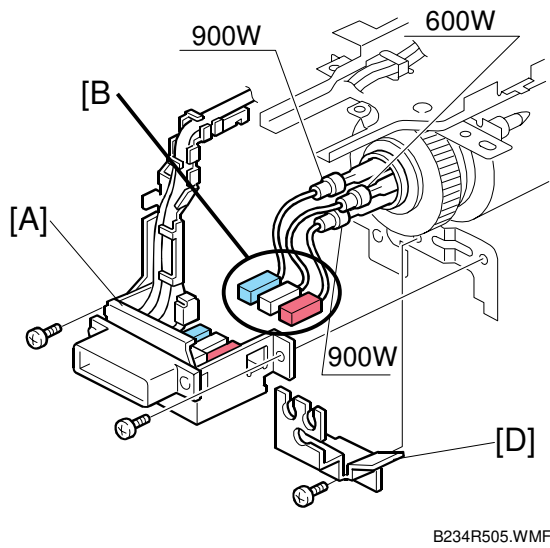

3. Remove the harness terminal bracket [A]. (⚙ x2)
4. Disconnect the rear fusing lamp cables [B]. (x3)
5. Disconnect the front fusing lamp cables [C]. (x3)
6. Remove the rear lamp holder [D]. (⚙ x1)
7. Remove the front lamp holder [E]. (⚙ x1)
8. Remove each fusing lamp [F], one at a time.

Important!:

- Do not touch the glass surfaces of the fusing lamps.
- Handle the lamps carefully to avoid breaking them.

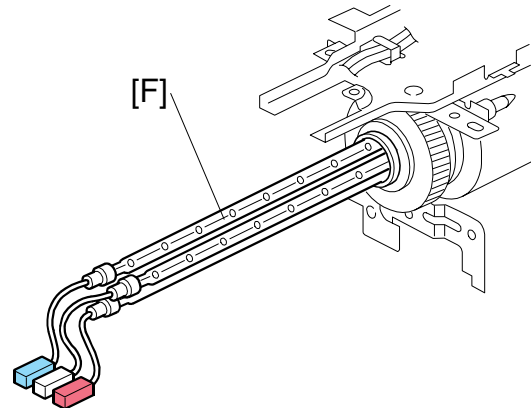

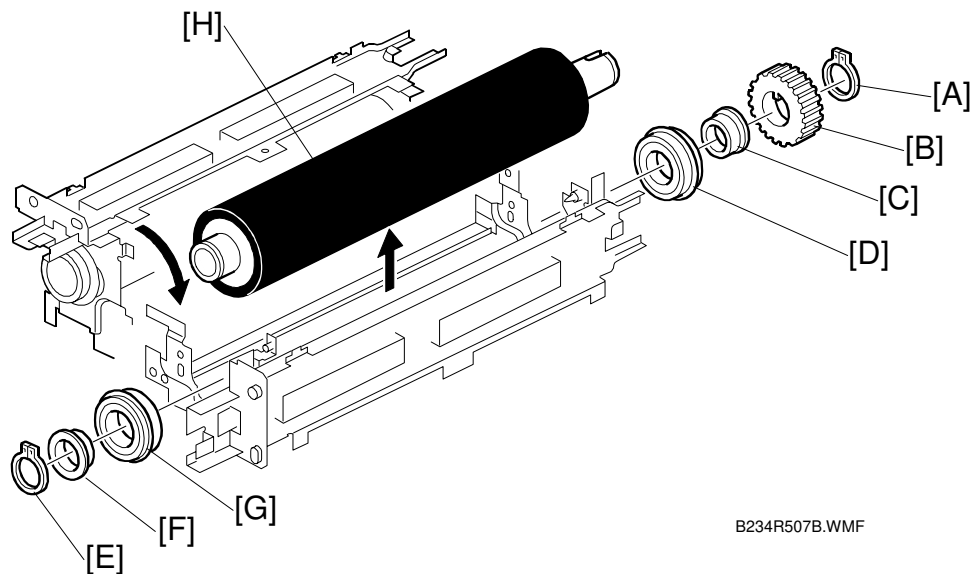
Disassembling the Hot Roller

1. Position the hot roller unit as shown.
2. Remove:
 - [A] C-ring
 - [B] Gear
 - [C] Bushing
 - [D] Ball bearing race.
3. Remove:
 - [E] C-ring
 - [F] Bushing
 - [G] Ball bearing race
4. Remove the hot roller [H].

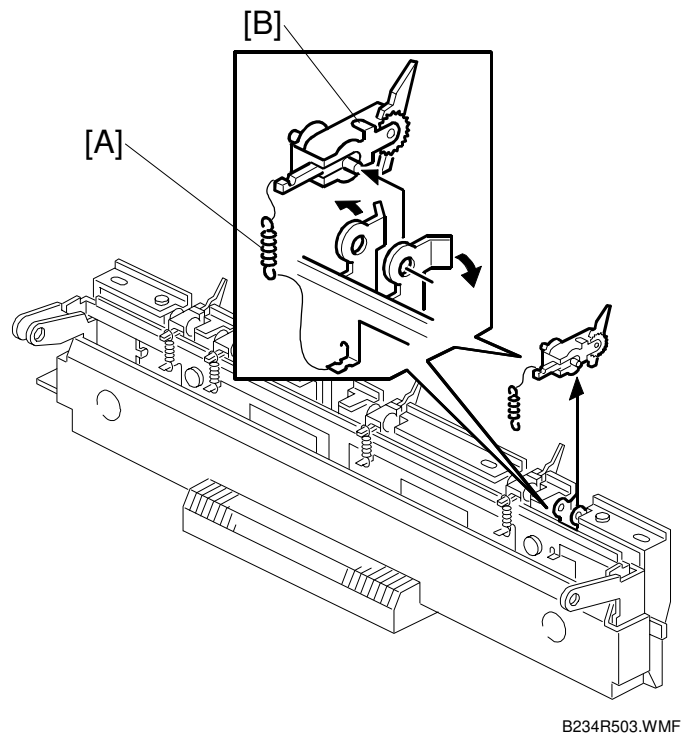
Disassembling the Hot Roller Strippers

1. Remove spring [A].
2. Spread the left and right sides of the holder as shown, then remove the hot roller stripper [B].
NOTE: Work carefully to avoid bending or deforming the spring and flexible leaf holders.
3. Follow the same procedure to remove the stripper pawls at four other locations.

Checklist

- ☐ Any chips or cracks on the ribs of the hot roller stripper unit?

1.6.2 RE-ASSEMBLY

Pressure Roller

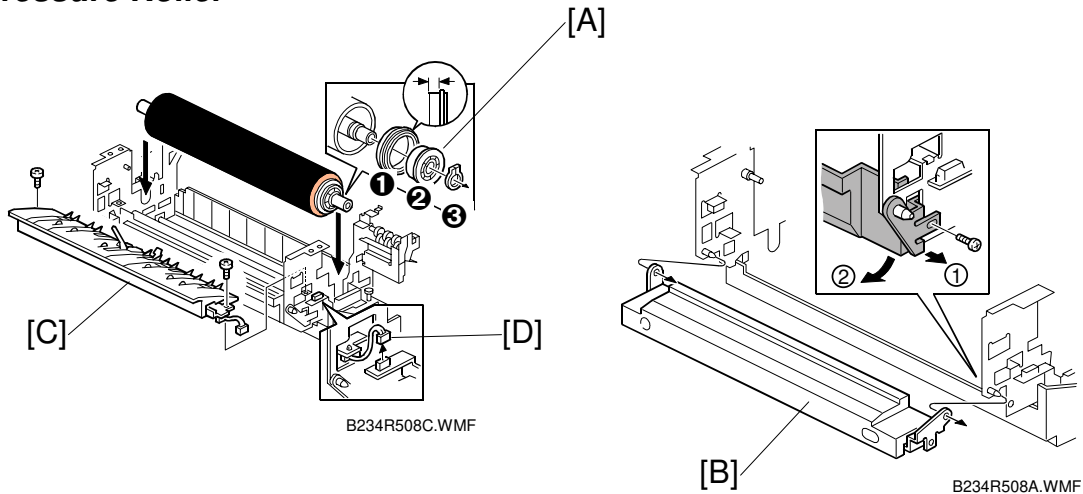

1. Bushings [A].
 - Use a clean, dry cloth to clean the surfaces of the holes and outer edges of the bushings and bearings.
 - Apply about one and a half drops of grease to the inside rim of the new pressure roller.

2. New pressure roller.

Important: Work carefully to avoid touching or hitting the surface of the pressure roller.

- Insert the shaft
- Attach ① bearings, ② bushings, ③ C-rings (each end).
- Set the front end of pressure roller shaft into the frame.

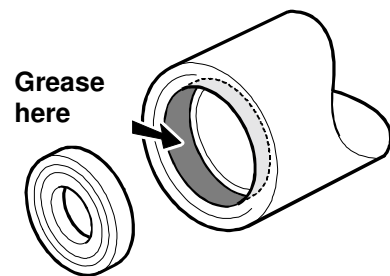

3. Insert the pin into the hinge of the pressure roller cleaning unit [B], rotate the pin counter-clockwise 90 degrees, press in on and fasten the screw.. (⚙ x1)

Checklist

- ☐ Grease applied to inner and outer surfaces of the bushings?
- ☐ Are the C-rings tight (not stretched, floating free)?

4. Attach the pressure roller stripper unit [C]. (⚙ x2)

Important: Avoid hitting or scratching the surface of the pressure roller when you attach the pressure roller stripper unit.

5. Pass the connector [D] through the small hexagonal hole at the front and connect it.

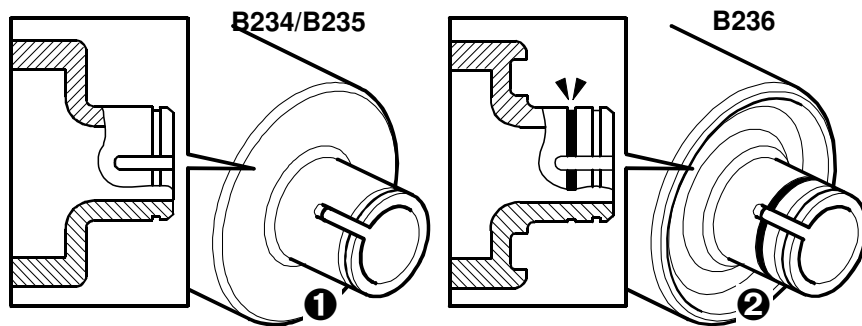
Hot Roller**Before You Begin...**

B234R507E.WMF

Important

- If the hot roller is to be replaced, confirm that the replacement roller is the correct type for the fusing unit.
- To confirm the hot roller type, check the rear shaft.
- The shape of the end ❶ of the hot roller for the B234/B235 is different from the B236 ❷.
- A hot roller for a B234/B235 fusing unit does not have this groove.

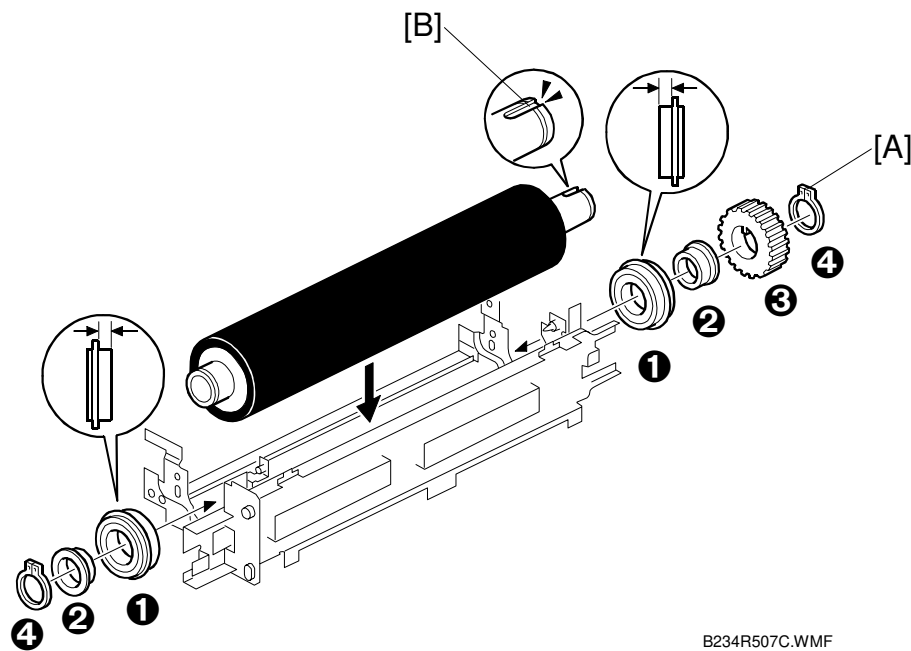

B234R507C.WMF

1. Prepare a new hot roller.

Important!: To prevent damage to the surface of the roller, do not let it hit the frame.

- Set the long end of the shaft temporarily in hole at the back side of the frame.
- Attach the ball bearings ❶ as shown.

2. Bushings ❷

- Clean the inner and outer surfaces of the bushings with a clean, dry cloth.
 - Apply a about 2 ϕ 3 of grease (Barrierta S552R) to the surfaces of the holes and outer surfaces of the bushings.
 - Attach the bushings. Attach the bushings with the thick rims facing out.
- Important!:** After installing the bushings, use a clean dry cloth to wipe away any excess grease.

3. Attach the gear ❸ at the rear.

4. Attach the C-rings ❹.

Important!: Make sure that the C-ring gap [A] does not overlap the key groove [B] of the hot roller at the rear.

5. Apply about 5 ϕ 3 of grease (Barrierta S552R) to the gear.

Checklist

- ☐ Grease applied to inner and outer surfaces of the bushings?
- ☐ Are the C-rings tight (not stretched, floating free)?
- ☐ Gap of the C-ring is not overlapping the roller gap at the rear?
- ☐ Has grease been applied to the hot roller gear?

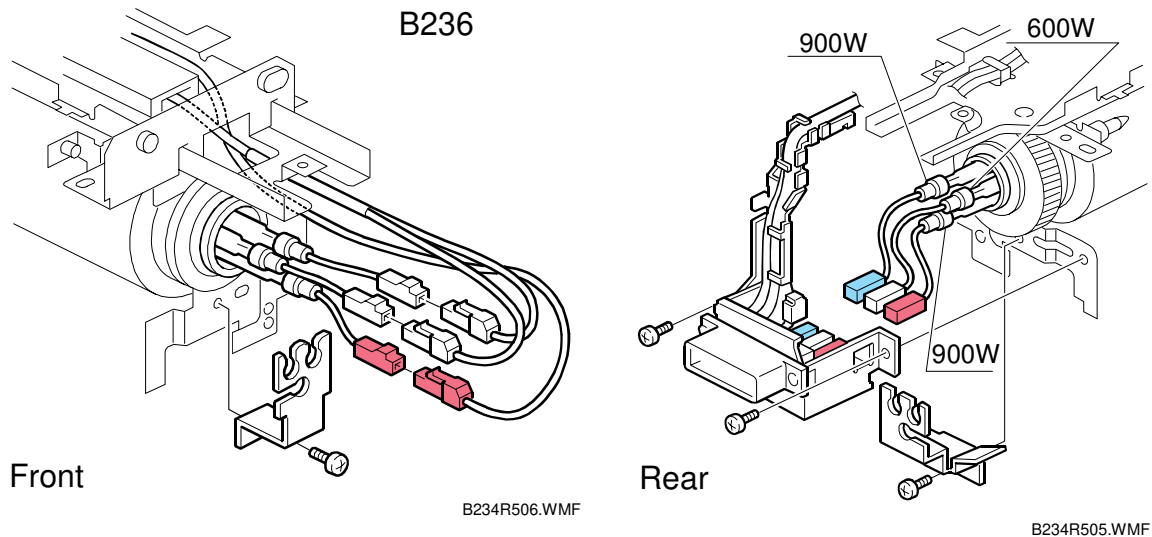
Fusing Lamps

1. Insert each fusing lamp from the rear hole of the fusing roller.
Important: Never not touch the glass surface of a fusing lamp with bare fingers. Handle the lamps carefully to avoid breaking them.
2. Lay the tip of each fusing lamp into any round hole in the front holder and fasten the holder.
3. Insert the tip of each fusing lamp into a round hole in the rear holder and fasten the holder.
NOTE: Make sure the lamps are perfectly parallel inside the hot roller.
4. Attach connectors. Refer to the table below.

Connection Table

B234/B235		B236	
Front	Rear	Front	Rear
Red	Red	Red	Red
White	White	Yellow	Yellow
White	Blue	White	Blue

5. Make sure the edges of holes in each holder fit snugly into the grooves in the rubber tips of the fusing lamps.

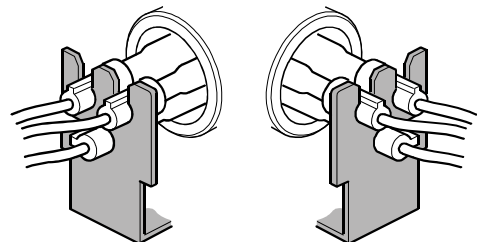

6. Connect hooks [A] of the harness terminal brackets to the slots in the frame at two points then fasten (⚙ x2).

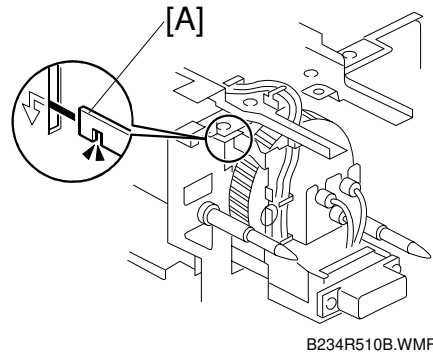

Checklist

- ☐ End of each fusing lamp securely inserted into holders at each end?
 - ☐ Connectors connected properly (refer to previous table)?
 - ☐ Are all the connectors tightly fastened?
 - ☐ Are the cables all secured properly by the 4 terminal bracket clamps as shown?
7. Attach the fusing entrance guide (⚙ x2).

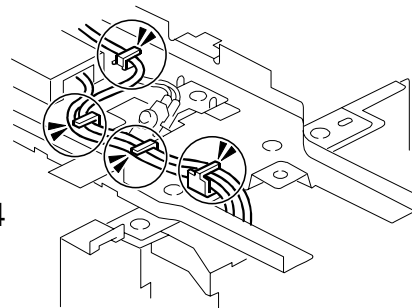

8. Use a blower brush to clean the entire fusing unit and remove any dust. Rotate the hot roller gear while vacuuming.

Checklist

- ☐ Is the surface of the hot roller clean and free of dirt, scratches, dust?
 - ☐ Are the holes on the top of the fusing entrance guide plate free?
9. Check for stamp at the ends of the entrance guide:
- "N": denotes "North America".
 - No mark: DOM/EU

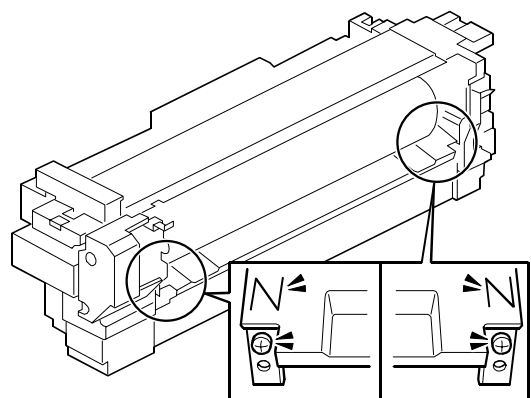

Precautions for Re-Installation [RWS1]

- Handle the fusing unit carefully to avoid hitting the hot roller.
- Make sure that the hot roller gear is facing the rear when you install the fusing unit.
- Make sure that the fusing unit is seated securely on the positioning pins (x2).

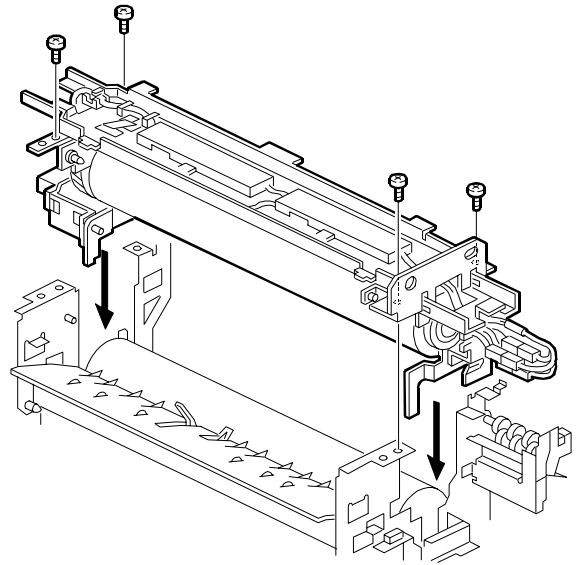

B234R504A.WMF

Replacing the Hot Roller Strippers

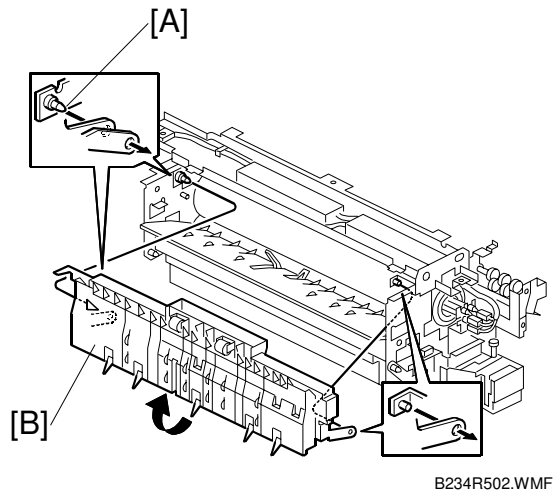
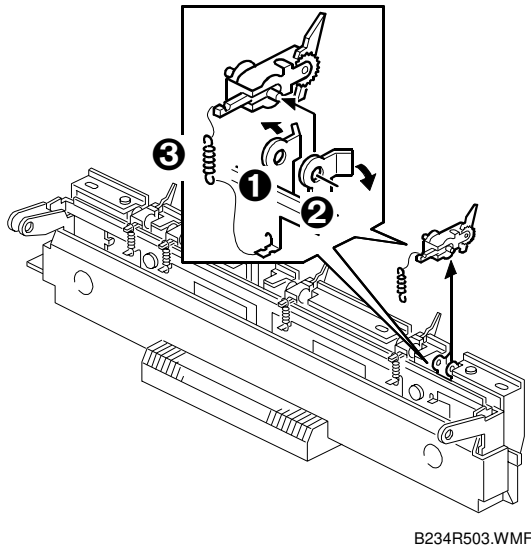

1. Prepare new hot roller strippers
2. Slightly spread the left and right sides of the plates ❶, ❷ then insert the new stripper between them.

Important: Work carefully to avoid bending the flexible leaf plates and spring.

3. Re-attach the spring ❸.

Checklist

- ☐ Are the stripper pawls pointed in the proper direction?
 - ☐ Are the springs attached properly?
4. Insert the pin [A] into the hinge of the hot roller stripper unit [B], rotate it 90 degrees, and re-attach it.

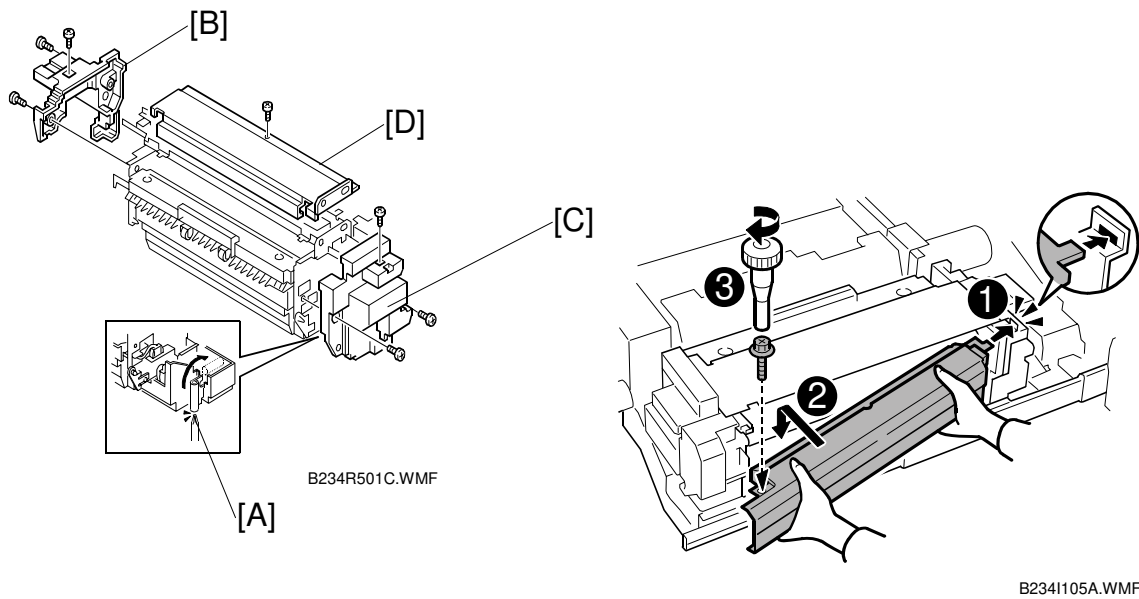

5. Insert the screwdriver [A] and rotate it up 90 degrees.
NOTE: Rotate 90 degrees before attaching front cover.
6. Re-attach:
 - [B] Rear cover (⚙ x3)
 - [C] Front cover (⚙ x3)
 - [D] Top cover (⚙ x1)
7. Re-attach the fusing cleaning unit:
 - Insert tab ❶ of the rear end into the fusing unit
 - Attach the front end ❷
 - Fasten screw ❸

1.7 FUSING CLEANING UNIT

Required Tools:	Phillips Screwdriver, Grease (Barrierta S552R), Small Brush (for grease)
Parts	<ul style="list-style-type: none">• Fusing Cleaning Fabric• Fusing Fabric Pressure Roller• Stopper

1.7.1 DISASSEMBLY

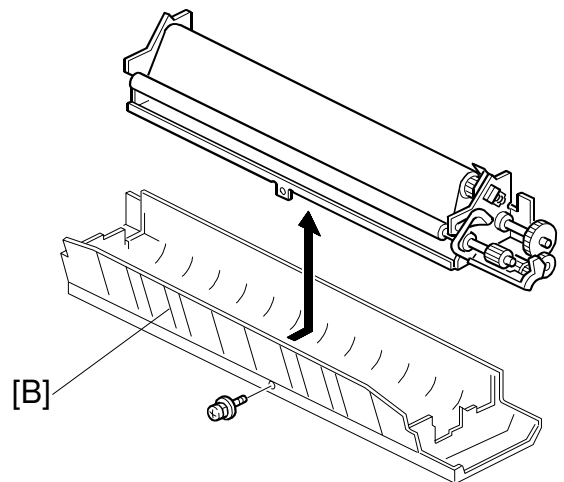
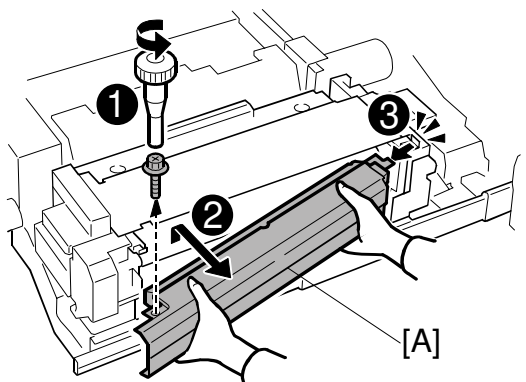

1. Remove the fusing cleaning unit unit [A]. (⌘ x1)
2. Remove cover [B].
 - Remove the screw (⌘ x1) .
 - Press the cover toward the rear.
 - Lift out the fusing cleaning unit.

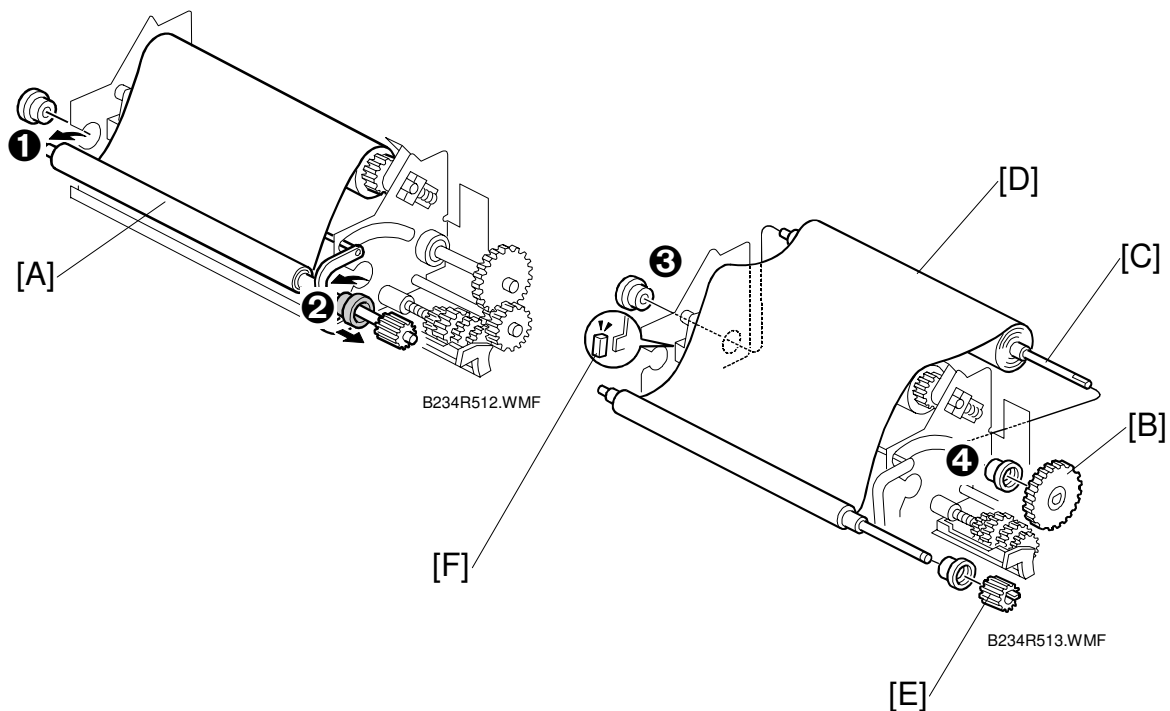

3. Remove the bushings ❶, ❷.
4. Slide out the shaft of the fusing cleaning fabric supply roller [A].
5. Remove the bushings ❸, ❹.
6. Slide off Gear Z50 [B].
7. Pull off the cleaning fabric take-up roller [C].
8. Remove the entire fabric [D] from the take-up roller.
9. Slide the key of Gear Z23 [E] off the shaft to remove the gear.
10. Remove the stopper [F].
11. Remove the fabric pressure roller [G]
(Springs x2, Bushings x2).

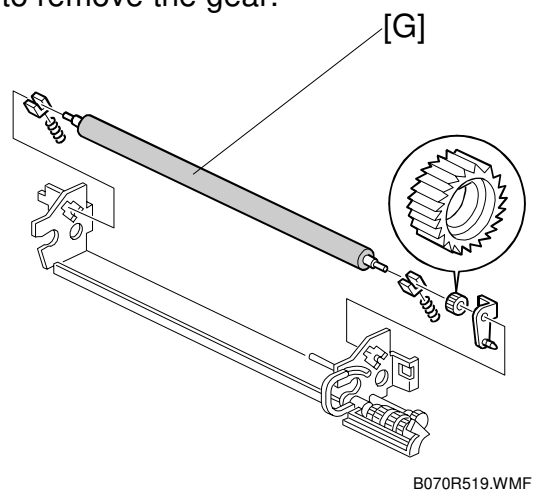

1.7.2 REASSEMBLY

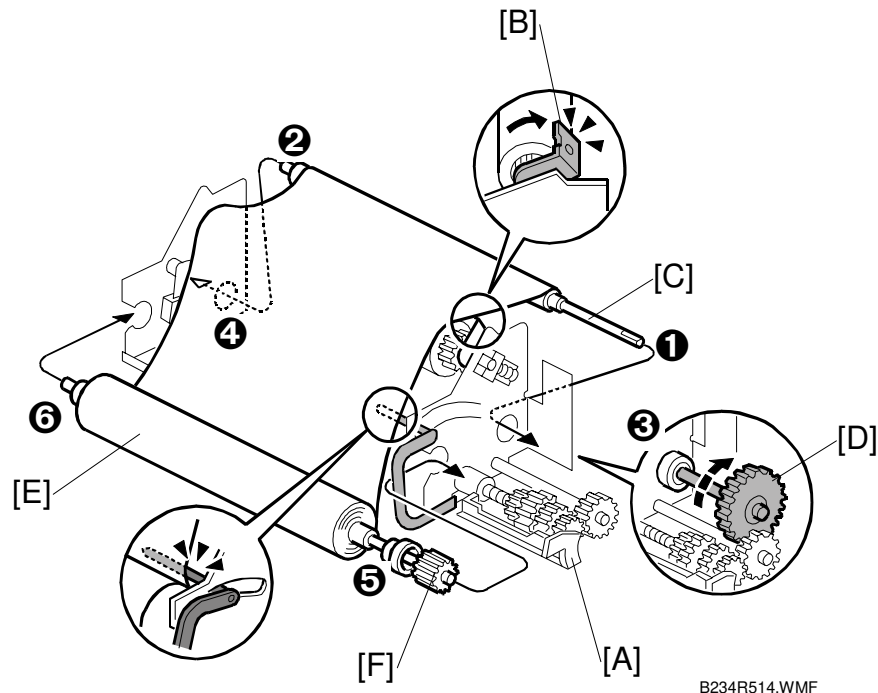

Important: Handle the rollers carefully to keep them clean.

Checklist Before You Begin

- Is the plastic [A] straight and not bent?

1. Prepare
 - New stopper.
 - New cleaning fabric roll.
 - New fabric pressure roller
2. Attach the new fabric pressure roller (Springs x2, Bushings x2).

Important

- Make sure that gear [B] rotates only clockwise.
 - Make sure that the fabric is below the bracket at [B].
3. Insert the take up roller [C]. Insert the front end ❶ then rear end ❷.
 4. Set the bushings ❸, ❹ on the shaft of the take-up roller.
 5. Attach Gear Z50 [D] so its teeth mesh with the teeth of the small gear below.
 6. Mount the take-up roller shaft (bushings attached).
 7. Mount the cleaning felt supply roller [E] (apply some pressure to position it correctly).
 8. Set the bearings ❺, ❻ on the shaft of the supply roller
 9. Gear Z23 [F]
 - Engage the key of the gear with its groove.
 - Attach it to the notch of the outer plate on the cleaning felt supply side.
 - Turn the gear to take up the slack of the cleaning fabric.
 10. Rotate Gear Z50 [D] clockwise 3 times.

11. Apply 3 ϕ 3 of grease (Barrierta S552R) to Gear Z50.

Checklist

- ☐ Cleaning felt is not riding up on the metal plate?
- ☐ Is the pressure lever down on the back of the felt?
- ☐ Gear Z50 clicks normally when it is turned?
- ☐ No slack in the cleaning fabric between the supply and take-up rollers?

12. Place the frame unit above the cover, push it forward then attach it ( x1).

Important: Attach the guide plate inside without allowing any of the 4 bearings or bushings to slip off.

13. Make sure that the cover is installed without riding up on the pawls (x2) on the bottom of the plate.