

SUBJECT:
SOFTWARE / FIRMWARE UPDATE

DATE: Aug. 31 '94
Reissued on:
Sept. 15, '94
PAGE: 1 of 3

PREPARED BY: M. Watanabe
CHECKED BY: S. Hamano

FROM: 2nd Technical Support Section

CLASSIFICATION:

- ☐ Action Required
☐ Troubleshooting
☐ Retrofit Information

- ☒ Revision of service manual
☒ Information only
☐ Other

MODEL: C4MF

We have updated the software firmware of the C4MF from July, 1994 production as follows:

Item	Version		Part No. / Suffix	
	Old	New	Old	New
1. Main Board ROMs	-----	-----	Suffix G	Suffix J
2. Printer Controller ROMs	V1.06	V1.27	Suffix G	Suffix H
3. Printer Driver / Font Download Utility for Windows	V2.1.0	V2.1.1	-----	-----
4. Printer Driver for Macintosh	V8.0.1.0	V8.1.1.0	-----	-----
5. Scanner Utility for Windows	V1.8	V2.3	-----	-----
6. Scanner Utility for Macintosh	V1.7	V2.1	-----	-----

The master ROMs and floppy discs were shipped to you already.

The details of update are as follows:

1. Cut-in Serial Number : A3234070001

2. Main Board ROMs

2. 1. Parts information

Old Part No.	New Part No.	Description / ROM Location	Check Sum	Type of ROM
A0995101K	A0995101M	Main Control Board	-----	-----
A0995175G	A0995175J	IC 109 (ROM)	9F45	AM27C020 - 150DC
A0995176G	A0995176J	IC 112 (ROM)	DAF3	

Note: 1. These ROMs must be replaced as a set.

2. The new ROMs are functional independently of the printer controller new ROMs.

SUBJECT:
SOFTWARE / FIRMWARE UPDATE

DATE: Aug. 31 '94
Reissued on:
Sept. 15, '94
PAGE: 2 of 3

2. 2. Details of update

The update for the main board ROMs contains the following change:

2. 2. 1. The guidance display of " SC624 " has been changed to " Undefined Error Turn off/on main SW." to minimize the number of service calls.
2. 2. 2. The machine operation when the " Reset Printer " is performed, has been changed to prevent possible misfeed condition. This may improve user friendliness.
2. 2. 3. The SP mode 5-950 " Sorter Bin Select " for 11" x 17" paper has been newly added. If 11" x 17" paper which has less stiffness is used, the paper might not be stacked properly on the printer bin of the sorter, and the trailing edge of the paper might be caught in the exit area. This will cause a misfeed condition. SP mode 5-950 has been added so that the service technician can select the print bin for 11" x 17" paper to avoid this problem.

Please add the following information to the service manual.

SP Mode No.			Function	Data
Class 1	Class 2			
5	950	Sorter Bin Select	Select the sorter bin to exit A3/11"/17" paper in printer mode.	0: Printer Bin 1: Interrupt Bin 2. Top Bin

2. 2. 4. The " Printer Disabled " guidance display has been newly added.
The guidance will be displayed under the following conditions:

- When the function switch inside the front door is switched to the " System Disabled " position.
- When the main board receives no signal from the printer control board after the main switch is turned on.

Note: The copier functions still work under the above conditions.

SUBJECT:
SOFTWARE / FIRMWARE UPDATE

DATE: Aug. 31 '94
Reissued on:
Sept. 15, '94
PAGE: 3 of 3

3. Printer Controller ROMs.

3. 1. Parts information

Old Part No.	New Part No.	Description / ROM Location	Check Sum	Type of ROM
A0995611M	A0995611N	Printer Control Board	-----	-----
A0995632G	A0995632H	A1 (ROM)	272B	AM27C020-150 DC
A0995633G	A0995633H	A2 (ROM)	2D0C	
A0995634G	A0995634H	A3 (ROM)	5459	
A0995635G	A0995635H	A4 (ROM)	2C2A	
A0995636G	A0995636H	B1 (ROM)	2006	
A0995637G	A0995637H	B2 (ROM)	5EC8	
A0995638G	A0995638H	B3 (ROM)	D6FD	
A0995639G	A0995639H	B4 (ROM)	023C	
A0995640G	A0995640H	C1 (ROM)	3C6C	
A0995641G	A0995641H	C2 (ROM)	8545	
A0995642G	A0995642H	C3 (ROM)	1D93	
A0995643G	A0995643H	C4 (ROM)	38C1	
A0995644G	A0995644H	D1 (ROM)	7B3B	
A0995645G	A0995645H	D2 (ROM)	9A12	
A0995646G	A0995646H	D3 (ROM)	B415	
A0995647G	A0995647H	D4 (ROM)	15A6	

Note: 1. These ROMs must be replaced as a set.
2. The new ROMs are functional independently of the main board new ROMs.

3. 2. Details of update

Please refer to the " C4MF SOFTWARE / FIRMWARE RELEASE NOTE (C4MF-RC-001) " dated August 4, 1994 issued by System Product Marketing Division.

4. Printer Drivers and Scanner Utilities

4. 1. Details of update

Please refer to the " C4MF SOFTWARE / FIRMWARE RELEASE NOTE " (C4MF-RC-001) " dated August 4, 1994 issued by System Product Marketing Division.

SUBJECT: AC HARNESS MODIFICATION

DATE: Sep. 15, '94
PAGE: 1 of 2

PREPARED BY: M. WATANABE
CHECKED BY: S. Hamano

FROM: 2nd Technical Support Section

CLASSIFICATION:

- ☐ Action Required
☐ Troubleshooting
☐ Retrofit Information

- ☒ Revision of service manual
☐ Information only
☐ Other

MODEL: C4MF

Note: The technical bulletins for NRG start from this issue.

The printer function will be disabled under the following conditions:

- When the function switch inside the front door is switched to the " System Disabled " position.
- When the main board receives no signal from the printer control board after the main switch is turned on.

Note: The copier functions still work under the above conditions.

When the anti-condensation switch is turned on and the printer function is disabled, service technician or operator must turn the anti-condensation and the main switches off and on to reset the printer control board.

To eliminate the necessity of turning off and on the anti-condensation switch the ac harness (Part Number : A0995501) has been modified from July 1994 production.

The cut-in serial numbers are as follows:

MODEL NAME	V/Hz	DETINATION	CODE	SERIAL NUMBER
Ricoh DS5330	115/60	U. S. A.	A099-17	A3234070001
Nashuatec D431 Gestetner 3131	220 ~ 240/50	Europe	A099-25	5474070001 (First Production)

The diagrams on page 2 of 2 show the point to point wiring of the old and new circuits. Please update the point to point diagram in the service manual.

SUBJECT: SOFTWARE / FIRMWARE UPDATE

DATE: Sep. 15, '94

PAGE: 2 of 2

< Old circuit >

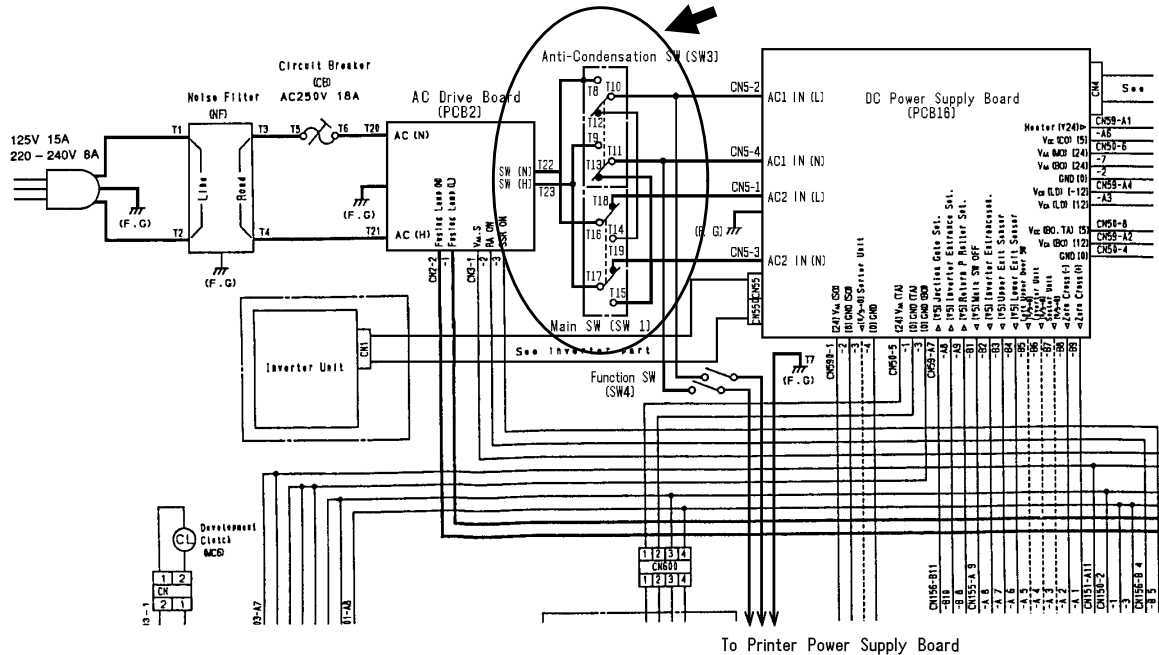

< New circuit >

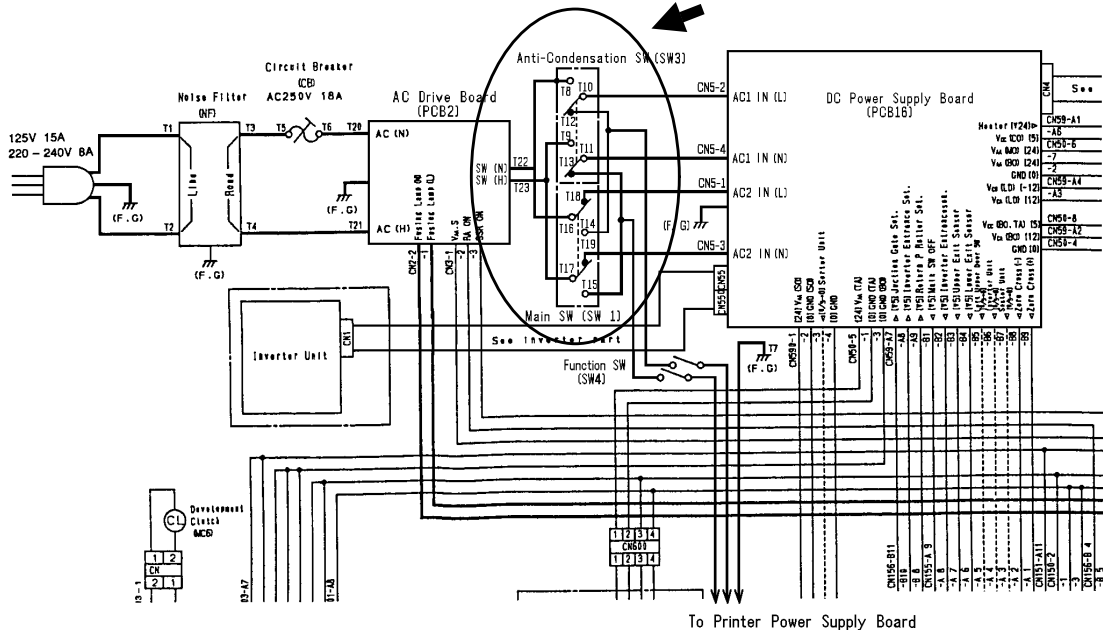

SUBJECT: Inverter Misfeed

DATE: Sept. 30 '94

PAGE: 1 of 1

PREPARED BY: M. Watanabe

FROM: 2nd Technical Support Section

CHECKED BY: S. Hamano

CLASSIFICATION:

☐ Action Required

☒ Troubleshooting

☐ Retrofit Information

☐ Revision of service manual

☐ Information only

☐ Other

MODEL: C4MF

- Phenomenon -

A paper misfeed occurs in the inverter unit and the Misfeed Location indicator D and E light.

- Possible Cause -

The paper entrance guide [A] on the LCT / duplex unit or the LCT unit is out of position and interferes with paper movement.

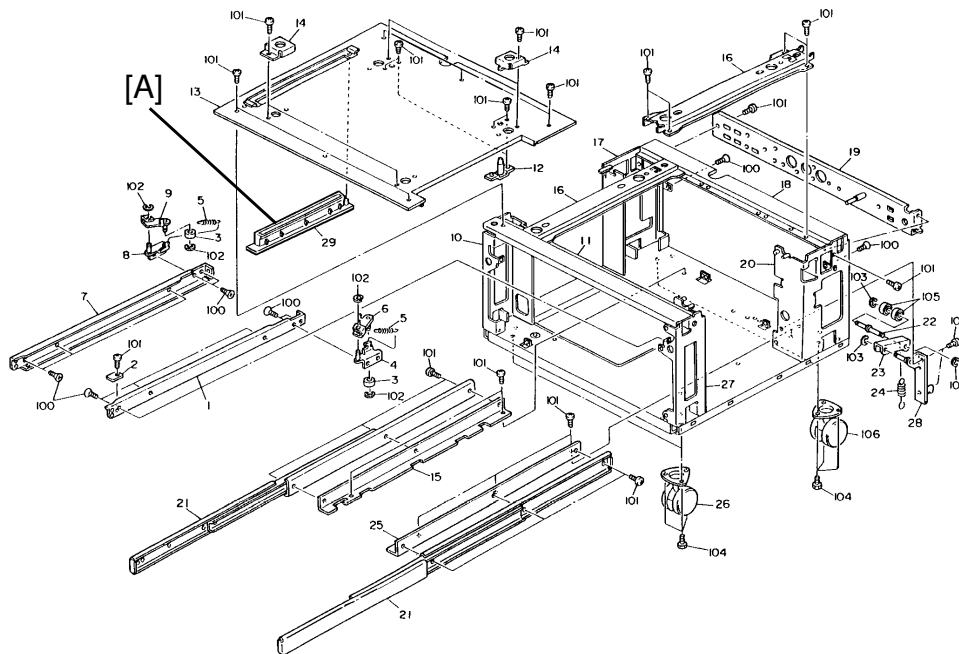

- Action -

1. Open the left cover on the LCT / duplex unit or the LCT.
2. Push and snap up both the front and rear of the paper entrance guide and make sure that it is positioned properly.

SUBJECT: FIRMWARE UPDATE

DATE: Feb. 15, '95
PAGE: 1 of 2PREPARED BY: M. Watanabe
CHECKED BY: S. Hamano

FROM: 2nd Technical Support Section

CLASSIFICATION:

☐ Action Required☐ Troubleshooting☐ Retrofit Information☐ Revision of service manual☒ Information only☐ Other

MODEL:

C4MF

We have updated the firmware of the main board and the printer control board as follows:

1. Main Board ROM**1.1. Parts information**

Old Part No.	New Part No.	Description / ROM Location	New Check Sum	Type of ROM
A0995101M	A0995101P	Main Control Board	-----	-----
A0995175J	A0995175M	IC 109 (ROM)	E23F	AM27C020 - 150DC
A0995176J	A0995176M	IC 112 (ROM)	636D	

Note: 1. These ROMs must be replaced as a set.
2. The main board ROMs with suffix "K" and "L" have not been installed into the production units.

1.2. Details of the update

The update of the main board ROM will solve the following problems:

1.2.1. The last page from the DF remains on the exposure glass.

If SP mode 6-2 (DF free size) is set to 1 (:Yes), the last page of the original fed from the DF remains on the exposure glass. The operator must press the clear modes key to eject the last page. (The ROM with suffix L will solve this problem.)

1.2.2. The printer function is disabled if the anti-condensation switch is turned on; the printer function does not initialize and the guidance display on the operation panel shows "Printer disabled" after the main switch is turned on.**1.3. Cut-in serial number**

All C4MF machines manufactured after serial number 5474100002 will have the modified ROM.

SUBJECT: FIRMWARE UPDATE

DATE: Feb. 15, '95
PAGE: 2 of 2

2. Printer Control Board ROM (Version 1.30)

2.1. Parts information

Old Part No.	New Part No.	Description / ROM Location	Check Sum	Type of ROM
A0995711A	A0995711B	Printer Control Board	-----	-----
A0995732A	A0995732B	A1 (ROM)	EB5C	AM27C020-150DC
A0995733A	A0995733B	A2 (ROM)	024D	
A0995734A	A0995734B	A3 (ROM)	E60B	
A0995735A	A0995735B	A4 (ROM)	8349	
A0995736A	A0995736B	B1 (ROM)	FCFF	
A0995737A	A0995737B	B2 (ROM)	F06B	
A0995738A	A0995738B	B3 (ROM)	C480	
A0995739A	A0995739B	B4 (ROM)	87BB	
A0995740A	A0995740B	C1 (ROM)	7014	
A0995741A	A0995741B	C2 (ROM)	0C6B	
A0995742A	A0995742B	C3 (ROM)	68DD	
A0995743A	A0995743B	C4 (ROM)	9C0F	
A0995744A	A0995744B	D1 (ROM)	37B6	
A0995745A	A0995745B	D2 (ROM)	590B	
A0995746A	A0995746B	D3 (ROM)	2706	
A0995747A	A0995747B	D4 (ROM)	A914	

Note: These ROMs must be replaced as a set.

2.2. Details of update

Refer to the "C4MF SOFTWARE/FIRMWARE RELEASE NOTE (C4MF-RE-002)" dated December 8, 1994.

2.3. Cut-in serial number

All C4MF machines manufactured after serial number 5474120001 will have the modified ROM.