

<b>Model</b>	C4MF	<b>Volt/Hz</b>	<b>Date of Modification</b>	<b>Serial Number</b>
<b>Modified Article</b>	Parts Catalog			
<b>Reason for Modification</b>	Parts catalog correction			

Please correct your parts as follows:

1. Part number corrections

Incorrect P/N	Correct P/N	Description	Parts Catalog	
			Index No.	Page
AA143306	A4983118	Stepped Screw - M6	7	33
A0995546	A0995547	Toner End Sensor Relay Harness	26	59
52054527	AA063496	Spring - Exit	8	77
A3164506	A3934623	Exit Driven Roller	12	77

2. Part number and description corrections:

Incorrect P/N	Incorrect Description	Correct P/N	Correct Description	Parts Catalog	
				Index No.	Page
12042234	Microswitch - AH735254N	12042355	Microswitch - AM51632A531	10	15
12042233	Microswitch - AH715254N	12042356	Microswitch - AM51612A531	110	45
AD020017	T/S Corona Wire	54429003	Main Corona Wire - 10pcs / set	4	55

**3. Description Corrections**

P/N	Incorrect Description	Correct Description	Parts Catalog	
			Index No.	Page
A0991474	Sheet - Proguramm	Sheet - Program	4	17
A0605201	Image Proccessing Board	SBU Board	34	25
AX060048	Scanner Motor Bracket	Scanner Motor	5	27
A0625600	Printer Board	DC Power Supply - 100V / 120V 130W	1	91
AZ000013	Power Supply Code Stopper	Power Supply Code	9	95
G0032503	Noise Feeler - 100V	Noise Filter - 100V	10	95
14040233	Registor - 100m $\Omega$ 3000V $\pm$ 600V	Arrestor - 100m $\Omega$ 3000V $\pm$ 600V	111	107

**4. Please delete the following parts from your parts catalog:**

P/N	Description	Parts Catalog	
		Index No.	Page
A0992040	Polygon Motor Unit	0	81
14072386	IC - SN74LS163NS	147	105

5. Please add the following parts to your parts catalog:

P/N	Description	Parts Catalog	
		Index No.	Page
11040511	IC Socket - 8P-D1CF-8CS-E	175	111
14074263	DRAM Module - 4MB	176	111
16303203	Resistor - 20K $\Omega$ $\pm$ 5% 1/10W	160	119
11050047	TY - Wrap	123	129

Page 108

Incorrect

Correct

IC

SYMBOL NO.	INDEX NO.	SYMBOL NO.	INDEX NO.	SYMBOL NO.	INDEX NO.
IC11	145	IC21	146	IC30	135
IC12	13	IC22	9	IC31	135
IC13	140	IC23	8	IC32	135
IC14	3	IC24	6	IC33	135
IC15	4	IC25	5	IC34	135
IC16	11	IC26	144	IC35	112
IC17	10		113	IC36	112
IC18	12	IC27	135	IC37	137
IC19	1	IC28	135	IC38	20
IC20	15	IC29	135	(Socket)	110



IC

SYMBOL NO.	INDEX NO.	SYMBOL NO.	INDEX NO.	SYMBOL NO.	INDEX NO.
IC11	145	IC21	146	IC31	135
IC12	13	IC22	9	IC32	135
IC13	140	IC23	8	IC33	135
(Socket)	175	IC24	6	IC34	135
IC14	3	IC25	5	IC35	176
IC15	4	IC26	144	(Socket)	112
IC16	11	(Socket)	113	IC36	176
IC17	10	IC27	135	(Socket)	112
IC18	12	IC28	135	IC37	137
IC19	1	IC29	135	IC38	20
IC20	15	IC30	135	(Socket)	110

Page 128

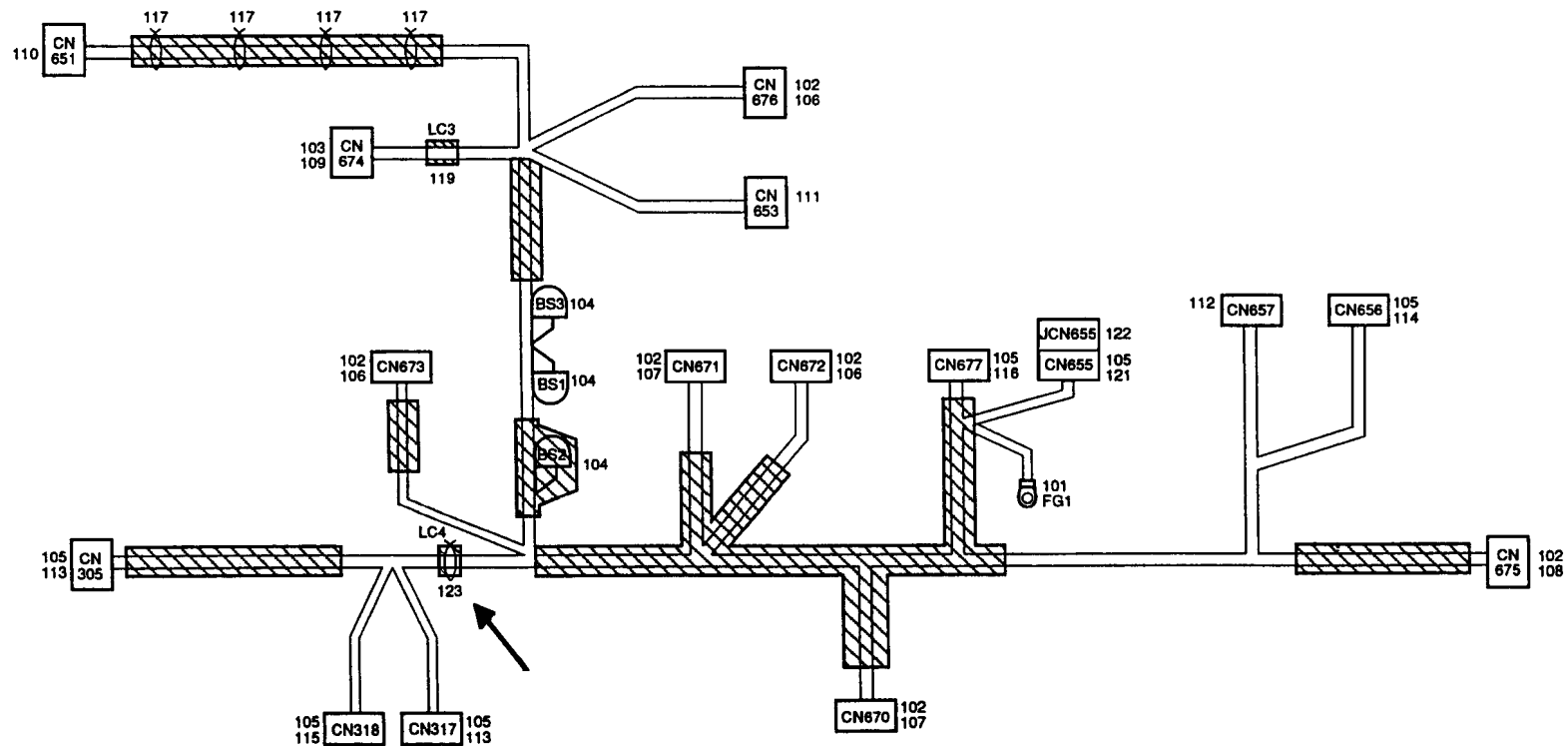

## 6. Index number corrections:

Page 116

Incorrect

## RESISTOR

SYMBOL NO.	INDEX NO.
R201	151
R202	144
R203	140
R204	140
R205	152
R206	138
R207	139
R208	148
R209	151
R210	144

SYMBOL NO.	INDEX NO.
R211	140
R212	152
R213	140
R214	138
R215	139
R216	148
R217	139
R218	148
R219	146
R220	139



Correct

## RESISTOR

SYMBOL NO.	INDEX NO.
R201	151
R202	160
R203	140
R204	143
R205	152
R206	138
R207	139
R208	148
R209	151
R210	160

SYMBOL NO.	INDEX NO.
R211	140
R212	152
R213	143
R214	138
R215	139
R216	148
R217	139
R218	148
R219	146
R220	139

## 7. Please correct the title of page 120 and 121, and INDEX to PARTS CATALOG as follows:

Incorrect	Correct
51. PRINTER BOARD (A099)	51. SCANNER MOTOR CONTROL BOARD (A099)

S. Hamano, Assistant General Manager  
Technical Support Department

MODEL NAME	V/Hz	DESTINATION	CODE	SERIAL NUMBER
Ricoh DS5330	115/60	U. S. A.	A099-17	

Model			C4MF						Volt/Hz		Date of Modification		Serial Number	
Modified Article			Reverse Roller Drive Shafts											
Reason for Modification			To reduce rumbling noise											
Draw No.	Old Parts No.		New Parts No.	Description	Rank	Q'ty Used Old→New	Inter-change-ability	Parts needed for replacement by new part		Parts Catalog				
								Part No.	Description	No.	Page			
	AA140350	└─┐	A0602828	Drive Shaft		1 → 1	X/O			2	33			
	06320100G	└─┐		Pin - M2 x 10		1 → 0				107	33			
	A0602616	└─┐	A0602827	Reverse Driven Shaft		1 → 0	X/O			4	33			
	06320100G	└─┐		Pin - M2 x 10		1 → 0				107	33			
	08053145	└─┐		Ball Bearing - 6 x 12 x 4mm		1 → 0				108	33			
	A0602804	└─┐	A0602825	Reverse Roller Driven Shaft		2 → 2	X/O			20	43			
	06320100G	└─┐		Pin - M2 x 10		2 → 0				108	43			
	08053145	└─┐		Ball Bearing - 6 x 12 x 4mm		2 → 0				105	43			
	A0602807	└─┐	A0602826	Reverse Roller Shaft		2 → 2	X/O			24	43			
	06320100G	└─┐		Pin - M2 x 10		2 → 0				108	43			
	50530447	└─┐		Bushing - 6mm		2 → 0				23	43			

Rank: A : Replace with new parts immediately. B : Replace with new parts at time of repair. C : Replace with new parts at time of overhaul.

Interchangeability:

(1) When old and new parts are not mutually interchangeable, use additional parts or an assembly part as indicated in "Parts needed for replacement by new part" to install the new part.

(2) The mark to the left of the slash indicates whether the old part can be used in the new machine, and the mark to the right indicates whether the new part can be used in the old machine. x = Not interchangeable o = Interchangeable

**DETAILS OF MODIFICATION**

The cylindrical pins on the reverse roller drive shafts of the side, the first and the second feed station have been changed to the spring pins. To facilitate servicing, the assembled parts will be supplied as service parts in stead of the individual parts as shown below.

Parts Catalog page 32

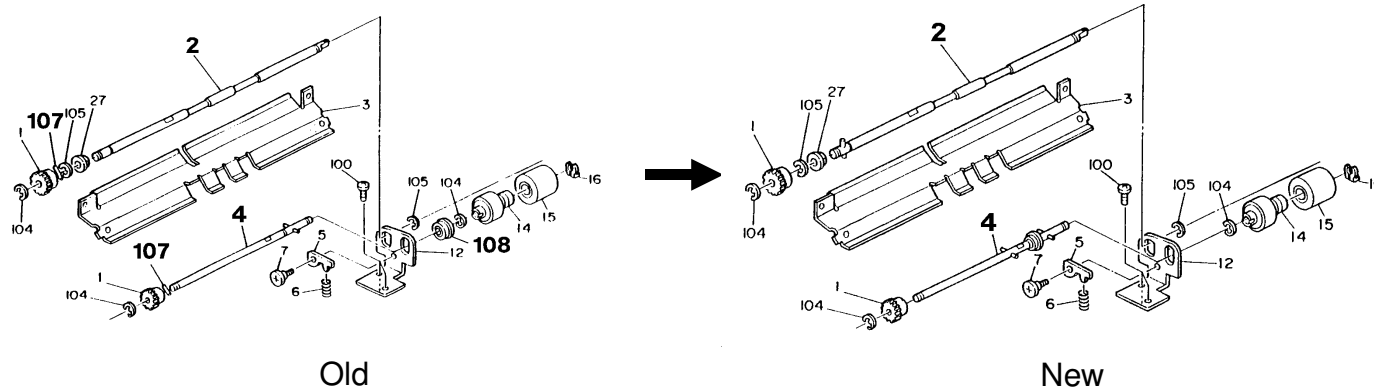

Parts Catalog page 42

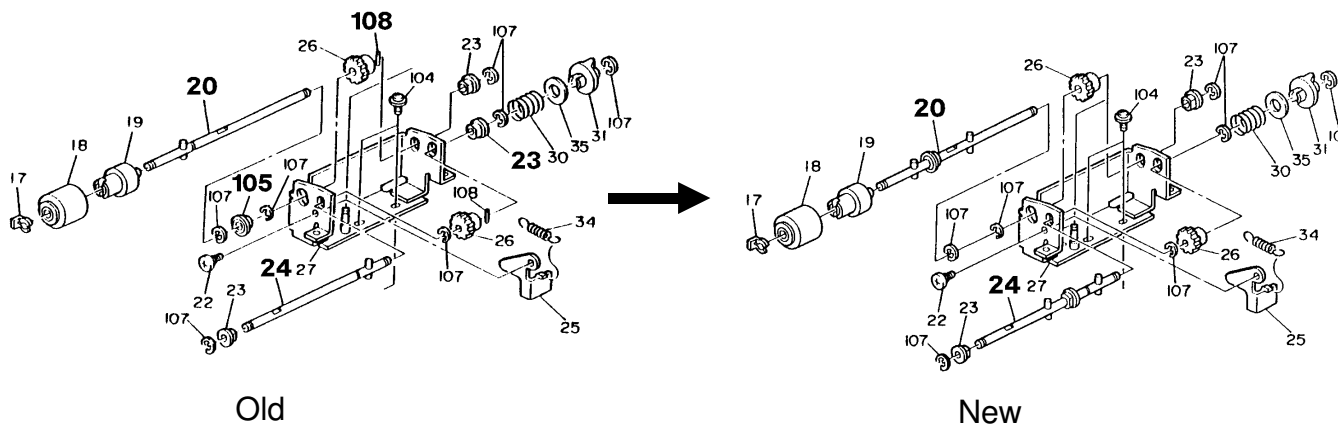

S. Hamano, Assistant General Manager  
Technical Support Department



MODEL NAME	V/Hz	DESTINATION	CODE	SERIAL NUMBER
Ricoh DS5330	115/60	U. S. A.	A099-17	A3234050001

**ISSUED ON: August 31, '94**

<b>Model</b>	C4MF	<b>Volt/Hz</b>	<b>Date of Modification</b>	<b>Serial Number</b>
<b>Modified Article</b>	Parts Catalog			
<b>Reason for Modification</b>	Parts Catalog Correction			

Please correct your parts catalog as follows.

Incorrect P/N	Incorrect Description	Correct P/N	Correct Description	Parts Catalog	
				Index No.	Page
A0602060	1st Mirror Ass'y	AC030027	1st Mirror	15	89

S. Hamano, Assistant General Manager  
Technical Support Department

MODEL NAME	V/Hz	DESTINATION	CODE	SERIAL NUMBER
Ricoh DS5330	115/60	U. S. A.	A099-17	

<b>Model</b>	C4MF	<b>Volt/Hz</b>	<b>Date of Modification</b>	<b>Serial Number</b>
<b>Modified Article</b>	Operating Instructions			
<b>Reason for Modification</b>	Due to software change and error correction			

Due to software change of printer function and correction of some errors, the operating instructions have been changed as follows:

Old P/N	New P/N	Description	Q'ty Used	Inter-change-ability	Parts Catalog	
					Index No.	Page
A0998607	A0998617	Operating Instructions - English	1 → 1	X/O	29	133
A0998637	A0998638	User Guide - Printer Drive - IBM	1 → 1	X/O	30	133
A0998647	A0998648	User Guide - Printer Drive - MAC	1 → 1	X/O	30	133

S. Hamano, Assistant General Manager  
Technical Support Department

MODEL NAME	V/Hz	DESTINATION	CODE	SERIAL NUMBER
Ricoh DS5330	115/60	U. S. A.	A099-17	A3234070001

<b>Model</b>	C4MF	<b>Volt/Hz</b>	<b>Date of Modification</b>	<b>Serial Number</b>
<b>Modified Article</b>	Parts Catalog			
<b>Reason for Modification</b>	Parts catalog correction			

Note: The modification bulletins for NRG start from this issue.

Please correct your parts catalog as follows:

**1. Parts number correction**

Incorrect P/N	Correct P/N	Description	Parts Catalog	
			Index No.	Page
A0995611	A0995711	Printer Control Board	*	111
A0995632	A0995742	IC - 27C020 - 150 (NRG)	20	111

**2. Part number and description corrections**

Incorrect P/N	Incorrect Description	Correct P/N	Correct Description	Parts Catalog	
				Index No.	Page
A0602060	1st Mirror Ass'y	AC030027	1st Mirror	15	89

**3. Description Correction**

P/N	Incorrect Description	Correct Description	Parts Catalog	
			Index No.	Page
11066066	Hexagonal Bolt - M2.6 x 5.5	Hexagonal Bolt - M2.6 x 5.5 - Inch	106	27

**DETAILS OF MODIFICATION**

4. Please add the following parts to your parts catalog.

P/N	Incorrect Description	Parts Catalog	
		Index No.	Page
R2136938	Hexagonal Bolt - M2.6 x 5.5 - Metric	106	27
A0995741	IC - 27C020 - 150 (NRG)	29	111
A0991523	Decal - Background Numbering (French)	31	133

S. Hamano, Assistant General Manager  
Technical Support Department

MODEL NAME	V/Hz	DESTINATION	CODE	SERIAL NUMBER
<del>Ricoh DS5330</del>	<del>115/60</del>	<del>U. S. A.</del>	<del>A099-17</del>	<del></del>
Nasuatec D431 Gestetner 3131	220 ~ 240/50	Europe	A099-25	



<b>Model</b>	C4MF	<b>Volt/Hz</b>	<b>Date of Modification</b>	<b>Serial Number</b>
<b>Modified Article</b>	Stabilizer			
<b>Reason for Modification</b>	Vendor change			

Due to a vendor change, the part number of the following part has been changed.

Old P/N	New P/N	Description	Q'ty Used	Inter-change-ability	Parts Catalog	
					Index No.	Page
AZ500017	AZ500023	Stabilizer	1	O/O	14	27

S. Hamano, Assistant General Manager  
Technical Support Department

MODEL NAME	V/Hz	DESTINATION	CODE	SERIAL NUMBER
Ricoh DS5330	115/60	U. S. A.	A099-17	A3234090001
Nashua D431 Gestetner 3131	220 ~ 240/50	EUrope	A099-25	5474090001

Model	C4MF	Volt/Hz	Date of Modification	Serial Number
Modified Article	Decal - Postscript			
Reason for Modification	Due to a change of Adobe's logo			

Due to a change of Adobe's logo, the following part has been modified.

Old P/N	New P/N	Description	Q'ty Used	Inter-change-ability	Parts Catalog	
					Index No.	Page
AA001329	AA001345	Decal - Postscript	1	X/O	45	13

Old Part



New Part



S. Hamano, Assistant General Manager  
Technical Support Department

MODEL NAME	V/Hz	DESTINATION	CODE	SERIAL NUMBER
Ricoh DS5330	115/60	U. S. A.	A099-17	A3234090001
Nashua D431 Gestetner 3131	220 ~ 240/50	EUrope	A099-25	5474090001

Model	C4MF	Volt/Hz	Date of Modification	Serial Number
Modified Article	Lower Exit Guide Plate			
Reason for Modification	To prevent deformation			

If the operator drops the lower exit guide [A] when clearing a misfeed, the front and rear stopper tabs [B] might be deformed. This might result in frequent misfeeds at the exit area. To prevent this, the lower exit guide plate has been modified as shown below, however, the part number has not been changed. Only the new part is in stock.

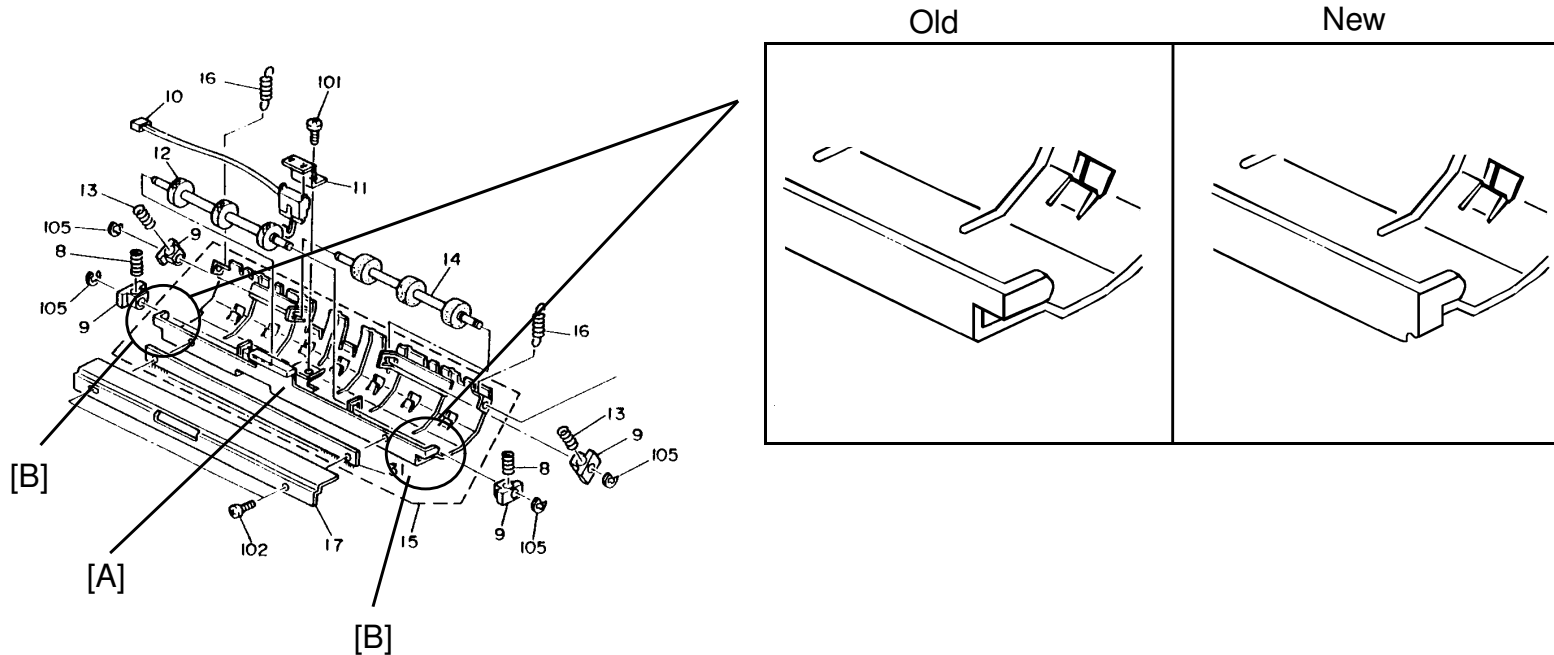

S. Hamano, Assistant General Manager  
Technical Support Department

MODEL NAME	V/Hz	DESTINATION	CODE	SERIAL NUMBER
Ricoh DS5330	115/60	U. S. A.	A099-17	A3234090001
Nashua D431 Gestetner 3131	220 ~ 240/50	Europe	A099-25	5474090001

Model	C4MF	Volt/Hz	Date of Modification	Serial Number
Modified Article	Parts Catalog			
Reason for Modification	Parts Catalog Correction			
				—

**Please correct your parts catalog as follows:**

**1. Parts number and description corrections:**

Incorrect P/N	Incorrect Description	Correct P/N	Correct Description	Parts Catalog	
				Index No.	Page
<b>A0061315</b>	<b>Decal - Main SW- 115F</b>	<b>AA001375</b>	Decal - Main SW- Standby	4	13
A0061315	Decal - Main SW- 115F	AA001374	Decal - Switch - On /Off	46*	13
A0061316	Decal - Main SW- 220/240F	AA001375	Decal - Main SW- Standby	4	13

\*: New index number (Refer to the following illustration corrections.)

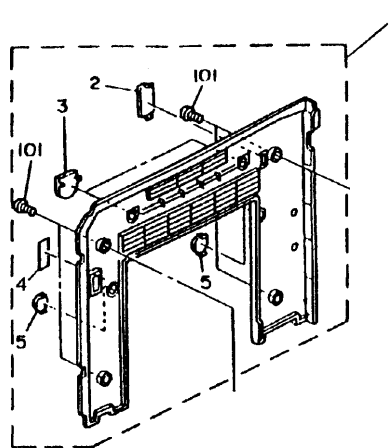
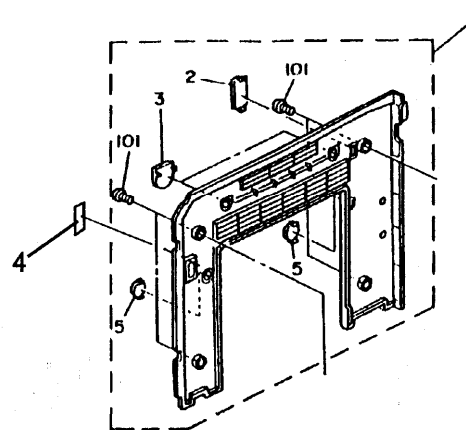
**DETAILS OF MODIFICATION****2. Illustration corrections**IncorrectCorrect

Note: The decal (#4) is not included in the left cover assembly (#1).

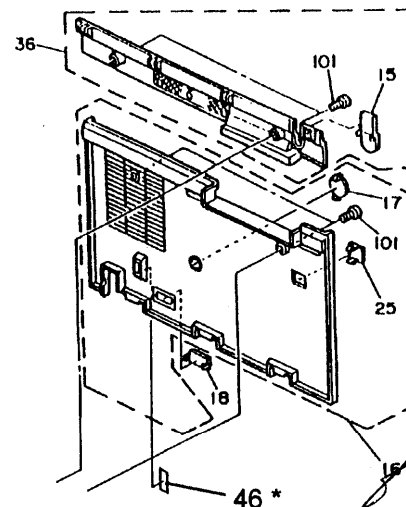
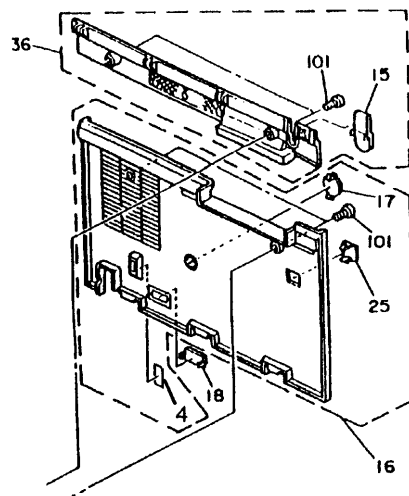

Note: The decal (#46) is not included in the rear cover assembly (#16).

  
S. Hamano, Assistant General Manager  
Technical Support Department



MODEL NAME	V/Hz	DESTINATION	CODE	SERIAL NUMBER
Ricoh DS5330	11 5/60	U. S. A.	A099-17	
<del>Nashua D431</del>	<del>220 ~ 240/50</del>	<del>Europe</del>	<del>A099-25</del>	
<del>Gestetner 3131</del>				

<b>Model</b>	C4MF	<b>Volt/Hz</b>	<b>Date of Modification</b>	<b>Serial Number</b>
<b>Modified Article</b>	Parts Catalog			
<b>Reason for Modification</b>	Parts Catalog Correction			

Please correct your parts catalog as follows:

1. Parts number and description corrections:

Incorrect P/N	Incorrect Description	Correct P/N	Correct Description	Parts Catalog	
				Index No.	Page
A0061315	Decal - Main SW - 115F	AA001375	Decal - Main SW - Standby	4	13
A0061316	Decal - Main SW - 220/240F	AA001375	Decal - Main SW - Standby	4	13
A0991290	Rear Cover	A0991291	Rear Cover - 220/240V	16	13
A0061316	Decal - Main SW - 220/240F	A0061315	Decal - Switch - On/ Off	46 *	13

\* : New index number (Refer to the following illustration corrections.)

**DETAILS OF MODIFICATION**

2. Illustration corrections

Incorrect

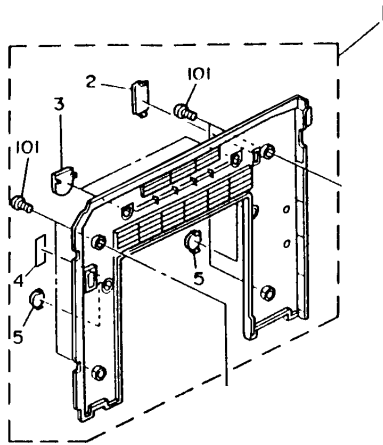

Correct

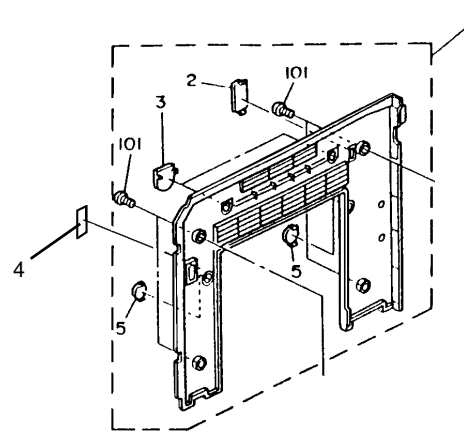

Note: The decal (#4) is not included in the left cover assembly (#1).

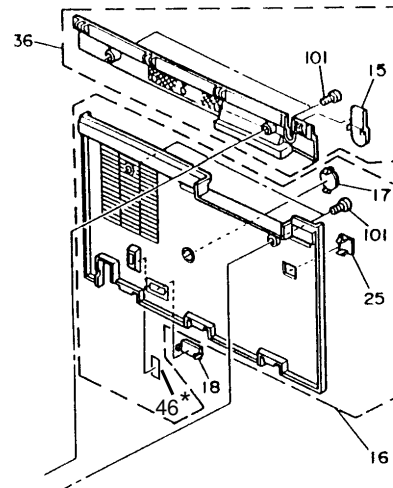
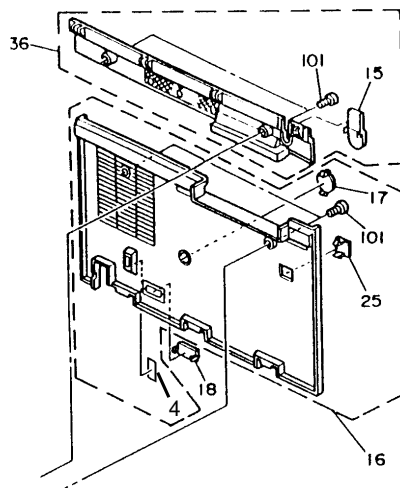
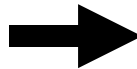

S. Hamano, Assistant General Manager  
Technical Support Department

MODEL NAME	V/Hz	DESTINATION	CODE	SERIAL NUMBER
<del>Ricoh DS5330</del>	<del>115/60</del>	<del>U. S. A.</del>	<del>A099-17</del>	
Nashua D431 Gestetner 3131	220 ~ 240/50	Europe	A099-25	

<b>Model</b>	C4MF	<b>Volt/Hz</b>	<b>Date of Modification</b>	<b>Serial Number</b>
<b>Modified Article</b>	Parts Catalog			
<b>Reason for Modification</b>	Parts catalog correction			

Please correct your parts catalog as follows:

Incorrect P/N	Correct P/N	Description	Parts Catalog	
			Index No.	Page
A0601115	A0601116	Right Support Plate	10	83

M. Iwasa, Manager  
Technical Support Department

MODEL NAME	V/Hz	DESTINATION	CODE	SERIAL NUMBER
Ricoh DS5330	115/60	U. S. A.	A099-17	
Nashua D431 Gestetner 3131	220 Å 240/50	EUrope	A099-25	

<b>Model</b>	C4MF	<b>Volt/Hz</b>	<b>Date of Modification</b>	<b>Serial Number</b>
<b>Modified Article</b>	Shoulder Screw			
<b>Reason for Modification</b>	Parts standardization			

Old P/N	New P/N	Description	Q'ty Used Old → New	Inter- change- ability	Parts Catalog	
					Index No.	Page
A0121256	A4221381	Shoulder Screw - M10	1 → 1	O/O	10	13

M. Iwasa, Manager  
Technical Support Department

MODEL NAME	V/Hz	DESTINATION	CODE	SERIAL NUMBER
Ricoh DS5330	115/60	U. S. A.	A099-17	
Nashua D431 Gestetner 3131	220 Å 240/50	Europe	A099-25	



<b>Model</b>	C4MF	<b>Volt/Hz</b>	<b>Date of Modification</b>	<b>Serial Number</b>
<b>Modified Article</b>	Parts Catalog			
<b>Reason for Modification</b>	Parts Catalog Correction			

Please correct your parts catalog as follows:

Incorrect P/N	Incorrect Description	Correct P/N	Correct Description	Parts Catalog	
				Index No.	Page
AB000015	Sprocket - 23Z	AX210039	Magnetic Clutch	11	97

M. Iwasa, Manager  
Technical Support Department

MODEL NAME	V/Hz	DESTINATION	CODE	SERIAL NUMBER
Ricoh DS5330	115/60	U. S. A.	A099-17	
Nashua D431 Gestetner 3131	220 ~ 240/50	Europe	A099-25	

Model	C4 MF	Volt/Hz	Date of Modification	Serial Number
Modified Article	Development Seals			
Reason for Modification	Part Standardization			

The following parts have been changed for part standardization with other models.

Old P/N	New P/N	Description	Q'ty Used	Inter-change-ability	Parts Catalog	
					Index No.	Page
AA15 1501	AA15 2273	Right Development Seal	1 → 1	O/O	6	73
AA15 1502	AA15 2274	Left Development Seal	1 → 1	O/O	7	73



T. Inoue, General Manager  
1st Field Information Dept. QAC

MODEL NAME	V/Hz	DESTINATION	CODE	SERIAL NUMBER
Ricoh DS5330	115/60	U. S. A.	A099-17	
Nashua D431 Gestetner 3131	220 Ä 240/50	Europe	A099-25	