

Model: Stinger-C1L		Date: 30-Nov-99	No.: RB001001
Subject: Differences from Stinger-C1		Prepared by: K. Miura	
From: Technical Services Dept., GTS Division			
Classification:	<input type="checkbox"/> Troubleshooting	<input type="checkbox"/> Part information	<input type="checkbox"/> Action required
	<input type="checkbox"/> Mechanical	<input type="checkbox"/> Electrical	<input checked="" type="checkbox"/> Service manual revision
	<input type="checkbox"/> Paper path	<input type="checkbox"/> Transmit/receive	<input type="checkbox"/> Retrofit information
	<input type="checkbox"/> Other ()		

The new model, "Stinger-C1L (B001)" will be launched in January 2000. It is a slightly modified version of the already existing model "Stinger-C1 (Ricoh Aficio 180, Gestetner 3218, Nashuatec D418, Rex-Rotary 2818, Savin 9918DP, Infotec 4180 MF)".

This will be six destination codes depending on the area: -10 is Latin America (Ricoh and Gestetner), -15 is North America (Savin), -17 is North America and Canada (Ricoh), -22 is Europe (Gestetner, Nashuatec, and Rex-Rotary), -26 is Europe and Oceania (Infotec), -27 is Europe, Latin America, and Hong Kong (Ricoh).

This RTB clarifies the differences between the base copier and Stinger-C1L (based on the style of the service manual).

Model: Stinger-C1L

Date: 30-Nov-99

No.: RB001001

1. OVERALL MACHINE INFORMATION

1-1. SPECIFICATIONS

NOTE: Only items marked * are different from the base copiers.

*Power Source: 120 V, 60Hz
More than 10 A (for North America/Latin America/Canada)
220 ~ 240 V, 50/60 Hz
More than 6 A (for Europe/Hong Kong/ Latin America)

*Noise Emission (Sound Power Level):

Stand-by (Mainframe only): 29 dB(A)
Operating (Mainframe only): 59 dB(A)
Operating (Full System): 63 dB(A)
Off Mode: 29 dB(A)

NOTE: 1) The above measurements were made in accordance with ISO 7779.

2) Full System: Mainframe + ADF

*Coping Speed in Multicopy mode (copies/minute)

	A4 sideways/ 11" x 8 1/2"	A3	11" x 17"	B4/8 1/2" x 14"
Non-memory copy mode	15	10	10	11
Memory copy mode	15	11	10	12

NOTE: 1) Measurement Conditions

Not APS mode

Full size

*Copy Paper Capacity:

Paper Tray:
250 sheets

By-pass Tray:

100 sheets (A4, B5, A5, B6, 8 1/2" x 11",
5 1/2" x 8 1/2")

10 sheets (A3, B4, 11" x 17", 8 1/2" x 13")

1 sheets (non-standard sizes)

NOTE: Copy weight: 80g/m² (20 lb).

Model: Stinger-C1L

Date: 30-Nov-99

No.: RB001001

Optional Equipment:

- Platen cover
- Auto document feeder
- Tray heater
- Optics anti-condensation heater
- Drum heater
- Copier feature expander (48 MB memory)

Copy Capacity:

Copy Tray: 250 sheets

*1-2. MACHINE CONFIGURATION

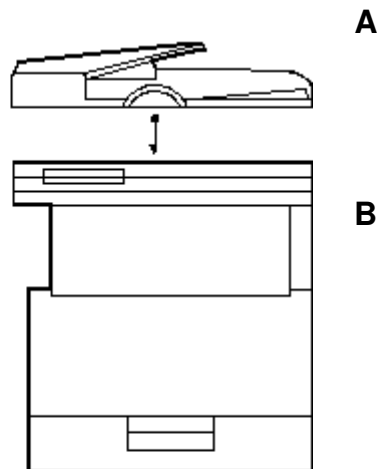

Version	Item	Machine Code	No.
Copier	Copier	B001	B
	ADF (Optional)	A859	A
	Platen Cover (Optional)	A893	
	Memory 48 MB (Optional)	A887	
Printer	Printer Controller (Optional)	B305	
	PS Option (Optional)	B308	
	HDD (Optional)	G690	
	NIB (Optional)	B307	
	Memory 32 or 64 MB (Optional)	G688	

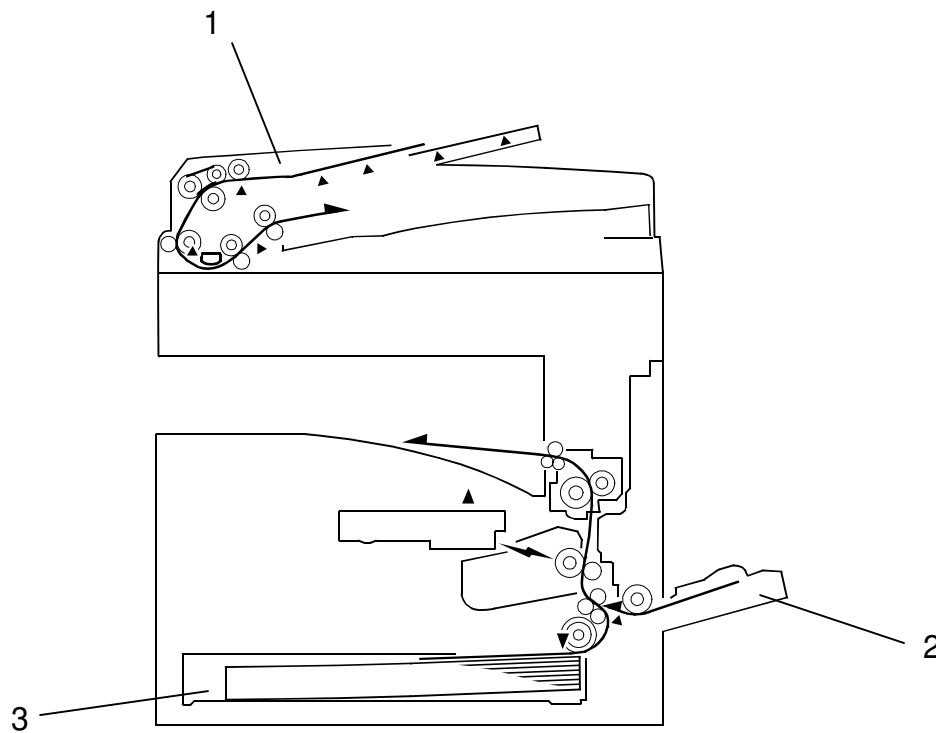
***1-3. PAPER PATH**

- 1. Optional ADF
- 2. By-pass feed tray
- 3. Paper tray

Model: Stinger-C1L

Date: 30-Nov-99

No.: RB001001

1-4. ELECTRICAL COMPONENT DESCRIPTIONS

The following items are not included in this machine.

Symbol	Name	Function	Index No.
MC4	Registration	Drives the registration rollers	13
SW4	Vertical Transport Cover Switch	Detects if the front door is open or not, and cuts the +24 V DC power line for the vertical transport clutch.	25
S10	Vertical Transport	Detects misfeeds.	22
PCB10	FCU (Option)	Controls all fax communications and fax features, in cooperation with the BICU.	43
PCB11	NCU (Option)	Switches the analog line between the fax unit and the external telephone.	47
LED1	Exit Tray	Indicates if there is paper on the exit tray.	32
LED2	1-bin Sorter	Indicates if there is paper on the 1-bin sorter. 1-bin sorter is option.	34
SP1	Speaker	Turns on during fax communication.	41

1-5. DRIVE LAYOUT

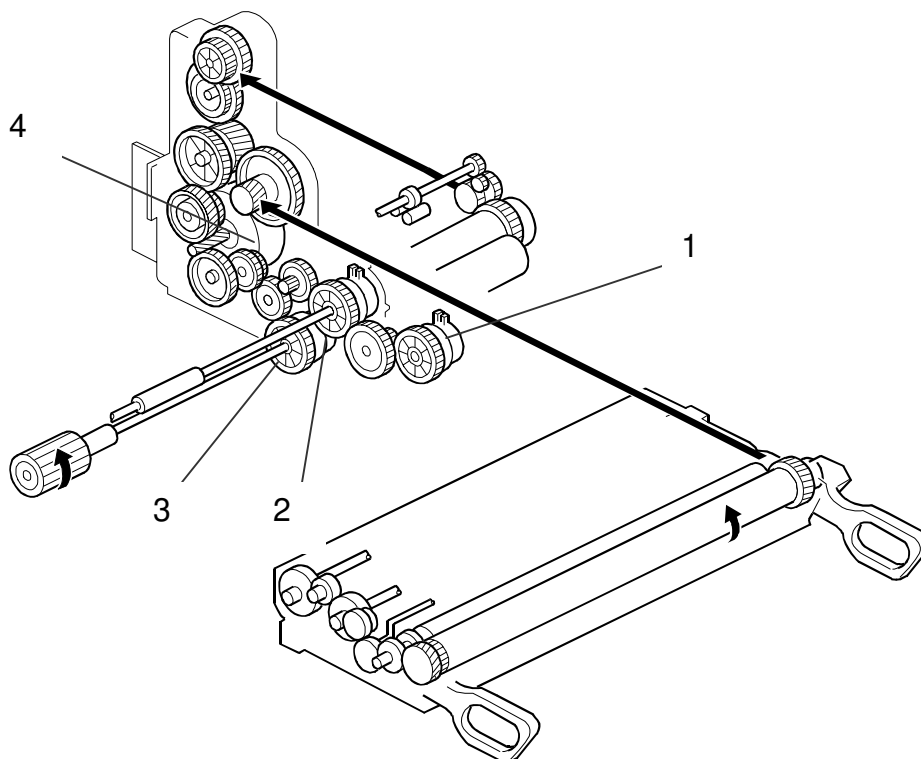

- 1. By-pass feed clutch
- 2. Registration clutch
- 3. Paper feed clutch
- 4. Main motor

1-6. BOARD STRUCTURE

1-6-1. OVERVIEW

This machine does not have an optional fax controller.

Model: Stinger-C1L

Date: 30-Nov-99

No.: RB001001

2. DETAILED DESCRIPTIONS

2-1. MISFEED DETECTION

The following checks are not included in this machine.

- **Vertical transport sensor ON check**
- **Vertical transport sensor OFF check**
- **Vertical transport sensor (Optional PFU) ON check**
- **Vertical transport sensor (Optional PFU) OFF check**
- **1 bin tray exit sensor ON check**
- **1 bin tray exit sensor OFF check**

Model: Stinger-C1L

Date: 30-Nov-99

No.: RB001001

3. SERVICE TABLES

3-1. SERVICE PROGRAM MODE TABLES

The following modes are not included in this machine.

Mode No.			Mode No.		
Class 1 and 2	Class 3		Class 1 and 2	Class 3	
1-002	2	Side-to-Side Regist. (2nd Paper Feed)	5-930		Fax Forwarding Mode
	3	Side-to-Side Regist. (3rd Paper Feed)	7-003	3	Total Print Counter (Fax)
1-003	2	Paper Feed Timing (2nd Paper Feed)	7-204	2	Copy Counter – Paper Tray (2nd)
	3	Paper Feed Timing (3rd Paper Feed)		3	Copy Counter – Paper Tray (3rd)
1-908	1 ~ 18	Paper Tray Adj.	7-504	4	Total Jams by Location (R Jam)
1-909		Tray Motor Reverse Time		5	Total Jams by Location (Y Jam)
5-103		Auto Paper Tray Shift		7	Total Jams by Location (2nd)
5-401	2	User Code Mode (Fax)		8	Total Jams by Location (3rd)

3-2. INPUT CHECK TABLE

The following checks are not included in this machine.

Number	Description	Number	Description
4	Vertical transport cover switch	44	Lower paper size switch (Optional paper tray unit)
5	Tray cover switch (Optional paper tray unit)	45	Upper paper height sensor (Optional paper tray unit)
7	Bin tray open switch (Optional 1-bin sorter)	46	Lower paper height sensor (Optional paper tray unit)
17	Vertical transport sensor	47	Upper lift sensor (Optional paper tray unit)
18	Vertical transport sensor (Optional paper tray unit)	48	Lower lift sensor (Optional paper tray unit)
21	Exit sensor (Optional 1-bin sorter)	49	Paper sensor (Optional 1-bin sorter)
41	Upper paper end sensor (Optional paper tray unit)	55	Paper tray unit set sensor (Optional paper tray unit)
42	Lower paper end sensor (Optional paper tray unit)	57	1-bin sorter installed
43	Upper paper size switch (Optional paper tray unit)	73	Tray motor lock (Optional paper tray unit)

Model: Stinger-C1L

Date: 30-Nov-99

No.: RB001001

3-3. OUTPUT CHECK TABLE

The following checks are not included in this machine.

Number	Description	Number	Description
21	Vertical transport clutch	30	Lower lift motor (Up) (Optional paper tray unit)
22	Relay clutch (Optional paper tray unit)	31	Upper lift motor (Down) (Optional paper tray unit)
26	Upper paper feed clutch (Optional paper tray unit)	32	Lower lift motor (Down) (Optional paper tray unit)
27	Lower paper feed clutch (Optional paper tray unit)	49	Exit tray LED
28	Tray motor (Optional paper tray unit)	50	1-bin tray LED
29	Upper lift motor (Up) (Optional paper tray unit)	54	Junction gate solenoid (Optional 1-bin sorter)

3-4. USER TOOLS

The following settings are not included in this machine.

System Setting

- 12. Pap. Tray Priority
- 13. Auto Tray Switch
- 14. Output Tray Prio.

Copy Setting

- 4. R.Srt.Aut Pap.
- 5. Sort

4. TROUBLESHOOTING

4-1. SC CODE DESCRIPTIONS

The following SC codes are not included in this machine.

SC502: 2nd Tray Lift Malfunction

SC503: 3rd Tray Lift Malfunction

SC506: Paper Tray Motor Lock

SC691: Communication Error between BICU and Fax Controller Unit