

Reissued: 8-Apr-05

Model: Martini-P1	Date: 2-Mar-05	No.: RG126001a
-------------------	----------------	----------------

RTB Correction

The items in bold italics have been corrected or added.

Subject: MT-P1 Service Manual		Prepared by: S. Watanabe	
From: 2nd Tech Support Sec. Service Support Dept.			
Classification:	<input type="checkbox"/> Troubleshooting <input type="checkbox"/> Mechanical <input type="checkbox"/> Paper path <input type="checkbox"/> Product Safety	<input type="checkbox"/> Part information <input type="checkbox"/> Electrical <input type="checkbox"/> Transmit/receive <input checked="" type="checkbox"/> Other ()	<input type="checkbox"/> Action required <input type="checkbox"/> Service manual revision <input type="checkbox"/> Retrofit information

AN OVERVIEW OF THE SERVICE MANUAL DIFFERENCES BETWEEN THE MT-P1 AND MT-C1/C2

- A Service Manual will not be released for the MT-P1 (G126), so refer to this RTB and the MT-C1/C2 Service Manual for the differences.
- The areas that are **highlighted in blue** are **unique to the MT-P1**.
- Some details are shown in other RTB/MBs.
 - e.g. The Installation Procedure differences are shown in RTB **RG126002**.

Note: MT-P1 mass production begins from March 2005.

Reissued: 8-Apr-05

Model: Martini-P1	Date: 2-Mar-05	No.: RG126001a
-------------------	----------------	----------------

1. INSTALLTION PROCEDURE

- See [RTB RG126002](#).

2. PREVENTATIVE MAINTENANCE

- PM procedures: **Same** with all three models.
- PM parts: **No unique parts** for the P1 (see table below).

Unique/Common

C1: Common with MT-C1

C2: Common with MT-C1

C1/2: Common with MT-C1/2

Part Number	Description	Q'ty/ Unit	PM Interval	Unique or Common
Around the drum unit				
A0962057	Charge Corona Grid	1	300k	C1/2
B0702364	Charge Corona Wire	1	300k	C1/2
A0962063	Charge Wire Cleaning Pad	1	300k	C1/2
AD041083	Cleaning Blade	1	300k	C1/2
AD042038	Cleaning Brush	1	300k	C1/2
AA010114	Ozone Filter (TOP)	1	300k	C1/2
AA012060	Development Filter	2	300k	C1/2
B0653161	Used Toner Separation Unit	1	600k	C1/2
Paper feed unit				
AF031082	Feed Roller	3	1000k	C1/2
AF030081	Pick-up Roller	3	1000k	C1/2
AF032080	Separation Roller	4	1000k	C1/2
AF031083	By-pass Feed Roller	1	1000k	C1/2
AF030080	By-pass Pick-up Roller	1	1000k	C1/2
Transfer belt unit				
A2933899	Transfer Belt	1	450k	C1/2
AD041076	Transfer Roller Cleaning Blade	1	450k	C1/2
B0653947	Discharge Plate	1	300k	C1/2

Reissued: 8-Apr-05

Model: Martini-P1	Date: 2-Mar-05	No.: RG126001a
-------------------	----------------	----------------

Part Number	Description	Q'ty/ Unit	PM Interval	Unique or Common
Fusing unit				
AE045046	Cleaning WEB	1	300k	C1
AE040038	Cleaning WEB Pressure Roller	1	600k	C1
AE031026	Cleaning WEB Pressure Roller Bearing	2	600k	C1
AE011087	Hot Roller	1	500k	C1
AE030017	Hot Roller Bearing	2	500k	C1
B1104080	Stripper Pawls: Open and Close Unit	1	300k	C1
AE042052	Pressure Cleaning Roller	1	300k	C1
AE031024	Pressure Cleaning Roller Bearing	2	300k	C1
AE020112	Pressure Roller	1	300k	C1
AE030018	Pressure Roller Bearing	2	300K	C1

Peripherals

LCT: B473

Part Number	Description	Q'ty /Unit	PM Interval	Unique or Common
AF030080	Pick-up Roller	1	1000k	C1/2
AF031081	Feed Roller	1	1000k	C1/2
AF032080	Separation Roller	1	1000k	C1/2

Cover Interposer: B470

Part Number	Description	Q'ty /Unit	PM Interval	Unique or Common
A8061321	Pick-up Roller	1	60k	C1/2
A8061295	Feed Belt	1	60k	C1/2
A8592241	Separation Roller	1	60k	C1/2

Reissued: 8-Apr-05

Model: Martini-P1	Date: 2-Mar-05	No.: RG126001a
-------------------	----------------	----------------

3. REPLACEMENT AND ADJUSTMENT

- Procedures: **Same** for all three models.
- Components: (See the table below).

Components	Note	
EXTERIOR		
Upper Cover	Unique to this model	
Call Light	Unique to this model	
Model Name Plate	Unique to this model	
ELECTRICAL SECTION 1: BCU	Unique to this model	
ELECTRICAL SECTION 3: Controller	Unique to this model	

NOTE: See MB **MG126001** for the P/N and illustrations for the parts above.

Components	Note	
EXTERIOR		
Front, Side, Rear Cover	Common with MT-C1/C2	
LASER UNIT	Common with MT-C1/C2	
TANDEM TRAY	Common with MT-C1/C2	
UNIVERSAL TRAY	Common with MT-C1/C2	
BY-PASS FEED TRAY	Common with MT-C1/C2	
PAPER FEED UNIT	Common with MT-C1/C2	
LASER UNIT	Common with MT-C1/C2	
VERTICAL TRANSPORT	Common with MT-C1/C2	
PAPER REGISTRATION	Common with MT-C1/C2	
TONER HOPPER SECTION	Common with MT-C1/C2	
TONER SUPPLY	Common with MT-C1/C2	
DEVELOPMENT	Common with MT-C1/C2	
PCU	Common with MT-C1/C2	
TRANSFER BELT UNIT	Common with MT-C1/C2	
PAPER EXIT SECTION	Common with MT-C1/C2	
DUPLEX SECTION	Common with MT-C1/C2	
DRIVE SECTION	Common with MT-C1/C2	
TONER COLLECTION	Common with MT-C1/C2	
ELECTRICAL SECTION: PFC	Common with MT-C1/C2	
UPPER FRAME	Common with MT-C1/C2	
LOWER FRAME	Common with MT-C1/C2	

Components	Note	
FUSING UNIT	Common with MT-C1	

	1	2	3	4	5	6	7	8	9	10	11
1. LCT											
2. LG/B4 Option	M										
3. Cover Interposer											
4. 100 staple Finisher							X	X	X		
5. Punch unit for 4				M			X	X	X		
6. Jogger Option				M			X		X		
7. Booklet Finisher				X	X	X					
8. Punch unit for 7 and 8				X	X	X	M				
9. Copy Tray				X		X	X	X			
10. DLT/A3 Tray											
11. Tab sheet holder											

Reissued: 8-Apr-05

Model: Martini-P1

Date: 2-Mar-05

No.: RG126001a

1. LCT***LCIT RT43 (B473: Maui)*****2. LG/B4 Option*****81/2"x14" Paper Size Tray Type 1075 (B474)*****3. Cover Interposer*****Cover Interposer Tray Type 1075 (B470)*****4. 100-staple Finisher*****SR841 (B706: Victoria-D)*****5. Punch unit for 4*****Punch Unit Type 1075 NA 3/2 (B531)******Punch Unit Type 1075 EU 2/4 (B531)******Punch Unit Type 850 SC (A812)*****6. Jogger Option*****Output Jogger Unit Type 1075 (B513)*****7. Booklet Finisher*****SR861 (B674: Zaire-Z)*****8. Punch unit for 7 and 8*****Punch Kit Type 1045 NA (B377)******Punch Kit Type 1045 EU (B377)******Punch Kit Type 1045 SC (B377)*****9. Copy Tray*****Copy Tray Type 1075 (B476)*****10. DLT/A3 Tray*****A3/11"x17" Tray Unit Type 1075 (B475)*****11. Tab Sheet Holder*****Tab Sheet Holder Type 1075 (B499)*****7-2. General Specifications**

Configuration	Console	
Print Paper Size	Paper tray, Duplex	A3/11" x 17" – A5 SEF/5.5" x 8.5"
	By-pass tray	A3/11" x 17" – A6 SEF/5.5" x 8.5"
	Non-standard sizes	Width: 100 – 305 mm (4" x 12") Length: 140 - 458 mm (5.5" x 18")

Reissued: 8-Apr-05

Model: Martini-P1		Date: 2-Mar-05	No.: RG126001a
Print Paper Weight	Paper Tray	52.3 ~ 127.9 g/m ² (14 ~ 34 lb.)	
	Duplex	64 ~ 127.9 g/m ² (17 ~ 34 lb.)	
	By-pass: Standard Thick Paper	52.3 ~ 157 g/m ² (14 ~ 43 lb.)	
		52.3 ~ 216 g/m ² (14 ~ 58 lb.)	
Printing Speed	75 ppm (A4/11" x 8.5" LEF)		
First Print Time	5.5s (1st Tray, A4/11" x 8.5" LEF)		
Warm-up Time (under 20°C room temp.)	Less than 300s after main power is turned ON.		
Paper Capacity	Tray 1 (tandem tray)	3100 sheets (80 g/m ² , 20 lb.)	
	Tray 2	550 sheets (80 g/m ² , 20 lb.)	
	Tray 3	550 sheets (80 g/m ² , 20 lb.)	
	By-pass Tray	100 sheets (80 g/m ² , 20 lb.)	
Paper Output (Copy Tray)	A4/81/2" x 11" and smaller	500 sheets	
	B4 and larger	250 sheets	
Power Source	North America	120 V / 60 Hz 20 A or more	
	Europe/Asia	220 ~ 240 V / 50/60 Hz 10 A or more	
Allowed voltage fluctuation	10%		
Power Consumption (Max.)	North America	1.85KW	
	Europe/Asia	1.85KW	
Power Consumption (Energy saver)	North America	50W	
	Europe/Asia	50W	
Dimensions (W x D x H)	690 x 760 x 1005 mm (27.2" x 29.9" x 39.6")* *Without finisher and call light 690 x 760 x 1466 mm (27.2" x 29.9" x 57.7")* *With call light		
Weight	Approx. 185 kg (407.8 lb.)		
Resolution	1200/600/400/300 dpi		
Toner Replenishment	Cartridge exchange (1100 g)		
Total Counter	Electric Counter		

Reissued: 8-Apr-05

Model: Martini-P1	Date: 2-Mar-05	No.: RG126002a
-------------------	----------------	----------------

RTB Reissue

Two illustrations were corrected (pg. 10, pg. 65).

Subject: MT-P1 Installation Procedure		Prepared by: S. Watanabe	
From: 2nd Tech Support Sec. Service Support Dept.			
Classification:	<input type="checkbox"/> Troubleshooting <input type="checkbox"/> Mechanical <input type="checkbox"/> Paper path <input type="checkbox"/> Product Safety	<input type="checkbox"/> Part information <input type="checkbox"/> Electrical <input type="checkbox"/> Transmit/receive <input checked="" type="checkbox"/> Other ()	<input type="checkbox"/> Action required <input type="checkbox"/> Service manual revision <input type="checkbox"/> Retrofit information

This RTB contains the **Installation Procedure** for the MT-P1 (G126).

Note:

- The areas that are **highlighted in blue** are **unique to the MT-P1**.
- See the MT-C1/C2 Service Manual for replacements, adjustments and other procedures.
- Mass production for the MT-P1 begins in March 2005.

INSTALLATION PROCEDURE

Model MT-P1 (Machine Code: G126)



Reissued: 8-Apr-05

Model: Martini-P1

Date: 2-Mar-05

No.: RG126002a

IMPORTANT SAFETY NOTICES**PREVENTION OF PHYSICAL INJURY**

1. Before disassembling or assembling parts of the printer and peripherals, make sure that the power supply cord is unplugged.
2. The wall outlet should be near the machine and easily accessible.
3. Note that some components of the machine and the paper tray unit are supplied with electrical voltage even if the main power switch is turned off.
4. If any adjustment or operation check has to be made with exterior covers off or open while the main switch is turned on, keep hands away from electrified or mechanically driven components.
5. If data in before the machine completes the warm-up period, keep hands away from the mechanical and the electrical components as the printer starts making prints as soon as the warm-up period is completed.
6. The inside and the metal parts of the fusing unit become extremely hot while the printer is operating. Be careful to avoid touching those components with your bare hands.

HEALTH SAFETY CONDITIONS

1. Never operate the machine without the ozone filters installed.
2. Always replace the ozone filters with the specified ones at the specified intervals.
3. Toner and developer are non-toxic, but if you get either of them in your eyes by accident, it may cause temporary eye discomfort. Try to remove with eye drops or flush with water as first aid. If unsuccessful, get medical attention.

OBSERVANCE OF ELECTRICAL SAFETY STANDARDS

1. The printer and its peripherals must be installed and maintained by a customer service representative who has completed the training course on those models.
2. The NVRAM on the system control board has a lithium battery which can explode if replaced incorrectly. Replace the NVRAM only with an identical one. The manufacturer recommends replacing the entire NVRAM. Do not recharge or burn this battery. Used NVRAM must be handled in accordance with local regulations.
3. The danger of explosion exists if the battery on the controller board is incorrectly replaced. Replace the battery only with the equivalent type recommended by the manufacturer. Discard the used controller board battery in accordance with the manufacturers instructions and local regulations.

Reissued: 8-Apr-05

Model: Martini-P1

Date: 2-Mar-05

No.: RG126002a

SAFETY AND ECOLOGICAL NOTES FOR DISPOSAL

1. Do not incinerate toner bottles or used toner. Toner dust may ignite suddenly when exposed to an open flame.
2. Dispose of used toner, developer, and organic photoconductors in accordance with local regulations. (These are non-toxic supplies.)
3. Dispose of replaced parts in accordance with local regulations.
4. When keeping used lithium batteries in order to dispose of them later, do not put more than 100 batteries per sealed box. Storing larger numbers or not sealing them apart may lead to chemical reactions and heat build-up.

LASER SAFETY

The Center for Devices and Radiological Health (CDRH) prohibits the repair of laser-based optical units in the field. The optical housing unit can only be repaired in a factory or at a location with the requisite equipment. The laser subsystem is replaceable in the field by a qualified Customer Engineer. The laser chassis is not repairable in the field. Customer engineers are therefore directed to return all chassis and laser subsystems to the factory or service depot when replacement of the optical subsystem is required.

WARNING

Use of controls, or adjustment, or performance of procedures other than those specified in this manual may result in hazardous radiation exposure.

WARNING

WARNING: Turn off the main switch before attempting any of the procedures in the Laser Unit section. Laser beams can seriously damage your eyes.

CAUTION MARKING:

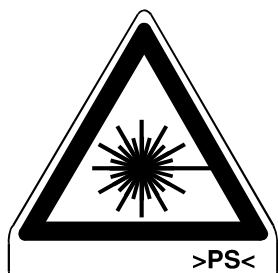

**CAUTION
VORSICHT**



>PS<

INVISIBLE LASER RADIATION WHEN OPEN.
AVOID EXPOSURE TO BEAM.
UNSICHTBARE LASERSTRAHLUNG
WENN ABDECKUNG GEÖFFNET.
NICHT DEM STRAHL AUSSETZEN.

Reissued: 8-Apr-05

Model: Martini-P1

Date: 2-Mar-05

No.: RG126002a

1. Installation Requirements

Operating Environment

1. Temperature Range: Recommended: 15°C to 25°C (59°F to 77°F)
Possible: 10°C to 32°C (50°F to 90°F)
2. Humidity Range: 15% to 80% RH (27°C 80%, 32°C 54%)
3. Ambient Illumination: Less than 1,500 lux (do not expose to direct sunlight or strong light.)
4. Ventilation: Room air should turn over at least 3 times per hour
5. Ambient Dust: Less than 0.10 mg/m³

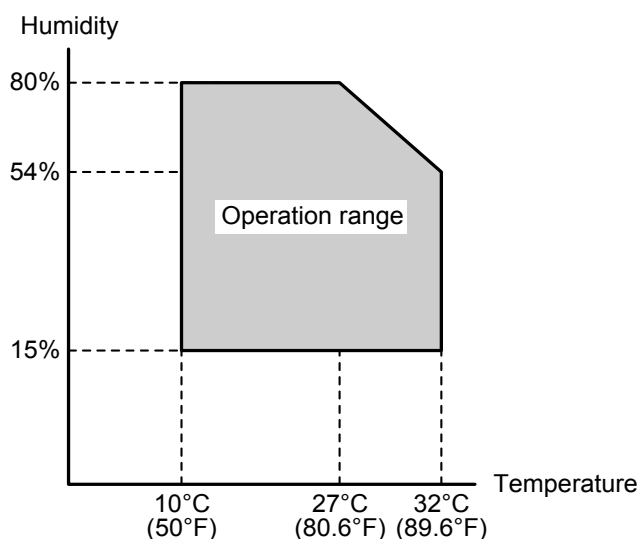

B064I502.WMF

6. If the place of installation is air-conditioned or heated, do not place the machine where it will be:
 - 1) Subjected to sudden temperature changes
 - 2) Directly exposed to cool air from an air-conditioner
 - 3) Directly exposed to heat from a heater
7. Do not place the machine where it will be exposed to corrosive gases.
8. Do not install the machine at any location over 2,000 m (6,500 feet) above sea level.

Reissued: 8-Apr-05

Model: Martini-P1

Date: 2-Mar-05

No.: RG126002a

9. Place the printer on a strong and level base with the front and back of the machine within ± 5 mm (0.2") of level.
10. Do not place the machine where it may be subjected to strong vibrations.
11. Do not connect the machine to a power source shared with another electrical appliance.
12. The machine can generate an electromagnetic field which could interfere with radio or television reception.

Machine Level

1. Front to back: Within ± 5 mm (0.2") of level
2. Right to left: Within ± 5 mm (0.2") of level

The machine legs may be screwed up or down in order to level the machine. Set a carpenter's level on the upper cover.

Reissued: 8-Apr-05

Model: Martini-P1

Date: 2-Mar-05

No.: RG126002a

Minimum Space Requirements

Place the printer near the power source, providing minimum clearance as shown below. The same amount of clearance is necessary when optional peripheral devices are installed.

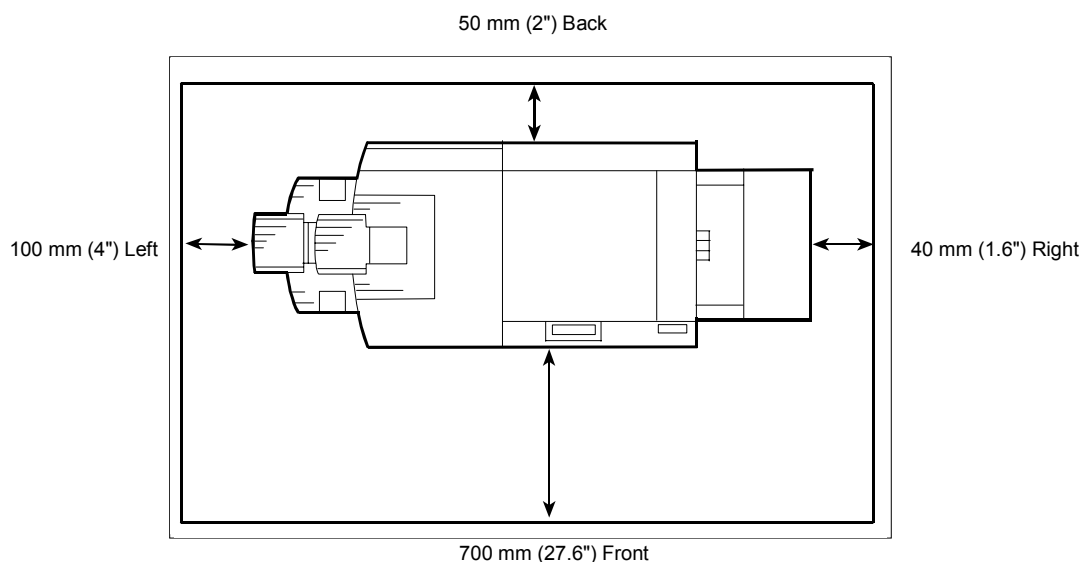

Dimensions

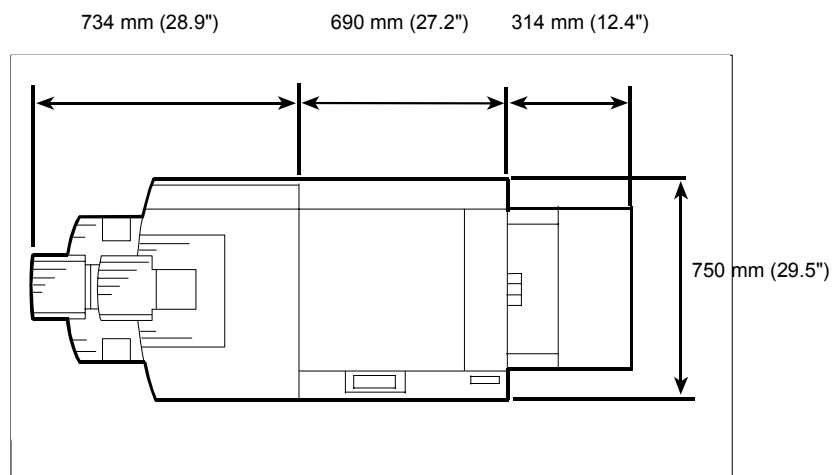

Reissued: 8-Apr-05

Model: Martini-P1	Date: 2-Mar-05	No.: RG126002a
-------------------	----------------	----------------

Power Requirements

CAUTION

1. Make sure that the wall outlet is near the main machine and easily accessible. Make sure the plug is firmly inserted in the outlet.
2. Avoid multi-wiring.
3. Be sure to ground the machine.
4. Never set anything on the power cord.

Input voltage level	North America 120 V, 60 Hz: 20 A or more
	Europe/Asia 220 V ~ 240 V, 50 Hz/60 Hz: 10 A or more
Permissible voltage fluctuation	±10%

CAUTION

Never turn off the main power switch when the power LED is lit or flashing. To avoid damaging the hard disk or memory, press the operation power switch to switch the power off, wait for the power LED to go off, and then switch the main power switch off.

- **Main Power Switch.**

Located on the front left corner of the machine and covered by a plastic cover. This switch should always remain on unless the machine is being serviced.

- **Rated Voltage of Output Connector**

Rated Voltage of Output Connector for Accessories: Max. DC 24 V

Reissued: 8-Apr-05

Model: Martini-P1	Date: 2-Mar-05	No.: RG126002a
-------------------	----------------	----------------

2. Main Machine (G126)

Accessory Check

Check the accessories and their quantities against this list:

Description	Q'ty
1. Model Name Decal (-22 Only)	1
2. Decal – Paper Size.....	1
3. Decal: caution chart: paper Set: Direction	1
4. Decal – Toner Supply - Multiple	1
5. Decal – D1/E1 Multiple (-22, -27 Only)	1
6. Stand Holder	2
7. Ferrite Core (For Ethernet cable)	1
8. Ferrite Core (For Parallel cable)	1
9. Leveling Stopper	2
10. O/I Holder	1

Reissued: 8-Apr-05

Model: Martini-P1

Date: 2-Mar-05

No.: RG126002a

Installation Procedure

Removing Tapes and Retainers

CAUTION

To avoid serious injury, do not connect the power plug to the machine until you are instructed to do so.

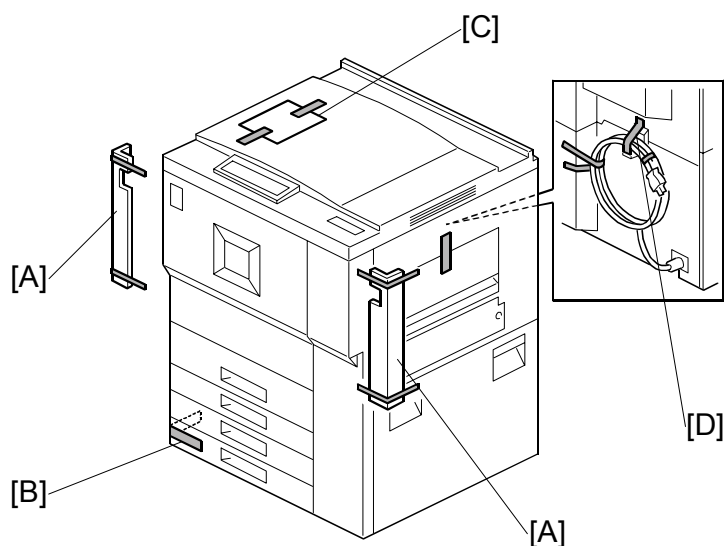

G1261151.WMF

1. Unpack the machine and remove all the wrapping.
2. Remove all filament tape from the front [A] of the machine.
3. Open the lower tray [B] and remove the operating instructions holder and foot risers.
4. Remove the data sheet [C].
5. Remove the tape from the back [D] of the machine.

NOTE: Save the filament tape and shipping retainers to prepare the machine for shipping in the future.

Reissued: 8-Apr-05

Model: Martini-P1

Date: 2-Mar-05

No.: RG126002a

6. Open the front door, open the toner bottle holder [C], then remove all tape and shipping retainers.

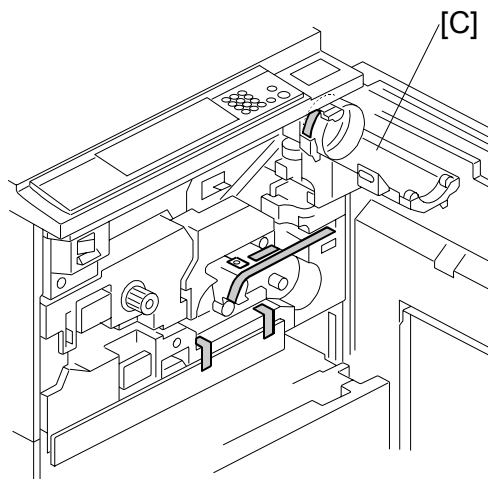

B064I007.WMF

7. Remove the PCU inner cover [D] (2 screws) and disconnect the fan motor [E] (1 connector).

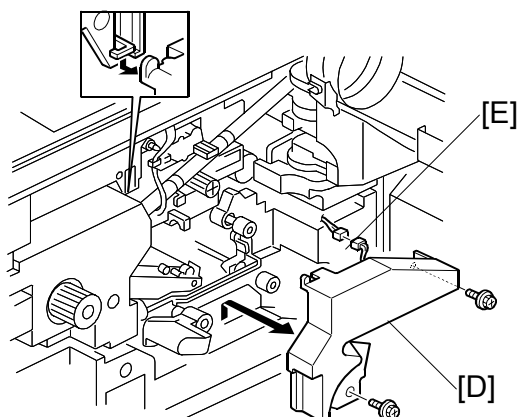

B064I008.WMF

Reissued: 8-Apr-05

Model: Martini-P1

Date: 2-Mar-05

No.: RG126002a

8. Lower the transfer unit by turning its knob [A].
9. Remove the bracket [B], and the red tag from the transfer belt (1 screw).
10. Remove the pin [C], and the red tag from the cleaning plate.

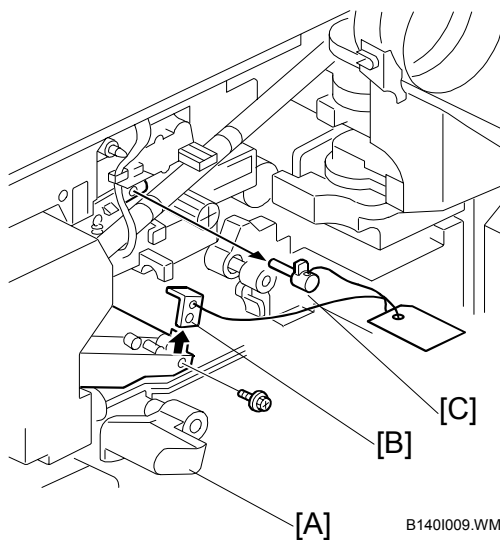

Reissued: 8-Apr-05

Model: Martini-P1

Date: 2-Mar-05

No.: RG126002a

11. Open the tandem tray (top paper tray) and remove the metal retainer bracket [D] (1 screw), wire, and red tag.

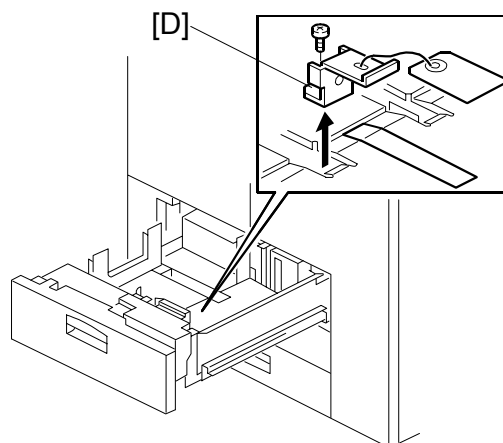

B064I401.WMF

Reissued: 8-Apr-05

Model: Martini-P1

Date: 2-Mar-05

No.: RG126002a

Removing and Filling the Development Unit

IMPORTANT: Before you begin, **remove the toner bottle** if it is installed.

Note: If the toner bottle is in the machine when you do this procedure, the toner bottle holder can be damaged.

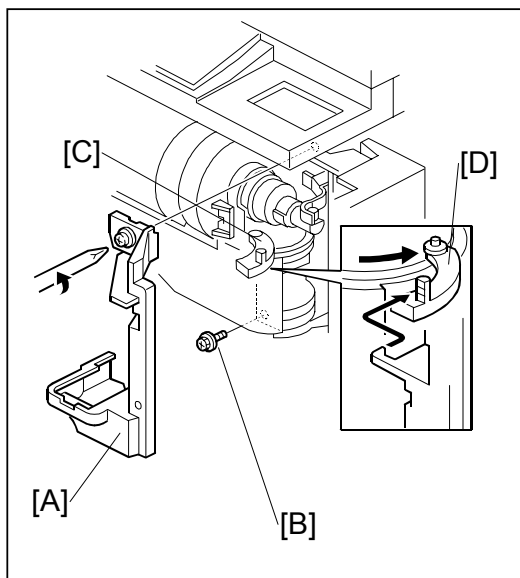

1. Remove the shutter cover [A] of the toner supply unit (1 screw).
2. Remove the lock screw [B] from the toner bottle open/close bracket.
3. Remove the shipping tape [C] if it is still there.
4. Pull the toner bottle holder and swing it to the right.
5. Remove the face plate [E] of the development unit (1 knob, 2 screws).

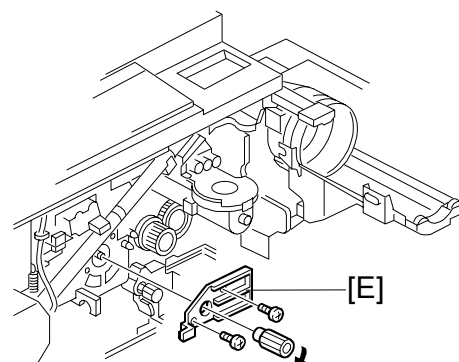

Reissued: 8-Apr-05

Model: Martini-P1

Date: 2-Mar-05

No.: RG126002a

6. Disconnect the development unit [F] (2 connectors).

NOTE: If the LCT is installed, you may need to disconnect it so the front door can open far enough to allow removal of the development unit.

7. Close the supply pipe shutter [G], and then while allowing the development unit [H] to slip to the right, slowly pull it out of the machine.

8. Remove the toner hopper [A] (2 screws).

9. Rotate the toner hopper [B] slightly 10° to 20° as you slide it up to remove it.

10. While turning the knob [C] slowly, pour in one pack of developer [D] from one end of the development unit to the other.

11. Make sure that the developer is evenly distributed. Note the developer lot number printed on the top edge of the bag. You will need the lot number when you execute SP2963 (Installation Mode).

12. Assembly the developer unit then re-install it in the machine.

13. Follow the instructions printed on the inside of the front door to install the toner bottle.

NOTE: If the door does not close, make sure that the pipeline shutter is rotated down. (See Step 7 above.)

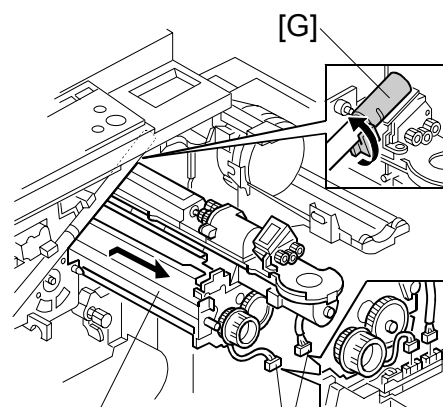

B0641303.WMF

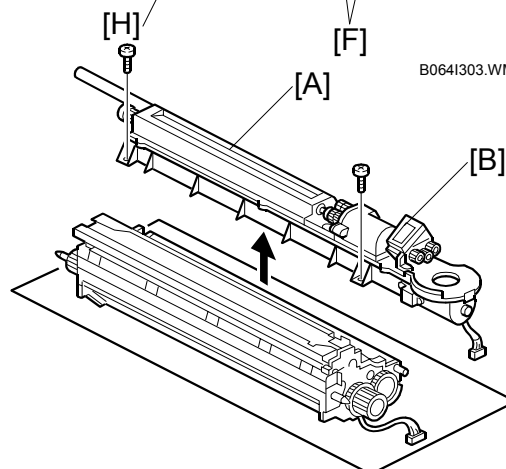

B0641304.WMF

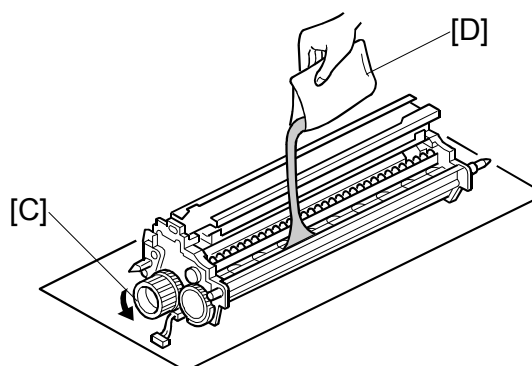

Reissued: 8-Apr-05

Model: Martini-P1

Date: 2-Mar-05

No.: RG126002a

Re-installing the Development Unit

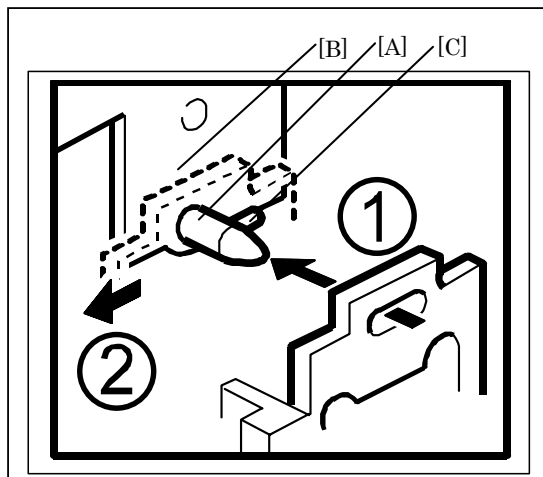

14. Push the development unit all the way to the right.
15. Continue to hold the unit to the right and push it into the machine.
IMPORTANT: Make sure the pin [A] goes into the left side of the hole in the development unit plate.
16. Push the development unit all the way in, so that the development unit plate touches the mainframe plate [B].
IMPORTANT: Make sure you can see the small pin [C] in front of the plate. If you cannot move the development unit plate behind the small pin, turn the front gear of the unit to the left, and try again.
17. Push the development unit to the left, until it contacts the PCU.
18. Make sure the pipeline shutter is rotated down to the open position.

Reissued: 8-Apr-05

Model: Martini-P1

Date: 2-Mar-05

No.: RG126002a

Initializing the Drum Settings

You must do SP2963 (Installation Mode) to 1) Initialize the developer and do a forced toner supply to the development unit, and 2) Initialize the auto process control settings.

- You must open the front door before you switch the machine on. If you do this, the machine does not do the short automatic process control procedure, which is usually done after the machine power is turned on.
- SP2963 must be done before you do sample copying or test printing.
- If you do not press “Enter” in Step 6, the auto process control items (potential sensor calibration, Vsg, Vref, etc.) will not initialize correctly.

1. Open the front door.
2. Connect the power cord.
3. Turn the main power switch on.
4. Go into SP mode.
 - Press the “Up/Down arrow” keys together for about 5 seconds, then press the “Enter” key.
5. Close the front door.
6. Do SP2963.
 - Input the Developer Lot No. with the key display, then press “Enter”.
Approximately four minutes is necessary to initialize toner supply and the auto process control settings.
7. Press “End” to go out of the SP mode.
8. Attach the applicable decals (supplied with the machine) to the paper trays.
9. Check the print quality and machine operation.

IMPORTANT

- At installation, use SP2963 to enter the lot number, initialize the developer, and to force toner supply to the toner hopper.
- After you replace developer in a machine that has been already installed, do not use SP2963; use SP2801 (TD Sensor Initial Setting) instead to enter the lot number and initialize the TD sensor.

Reissued: 8-Apr-05

Model: Martini-P1	Date: 2-Mar-05	No.: RG126002a
-------------------	----------------	----------------

Tandem Tray

Before shipping the machine, the tandem tray is set for A4 or LT LEF and must be adjusted if the customer wants to use the tandem tray for another paper size.

Feed Station	Allowed Size
Tandem Tray (Tray 1)	A4 LEF, LT LEF

1. Open the front cover.
2. Completely pull out the tandem feed tray [A] so that the right tandem tray [B] separates from the left tandem tray.

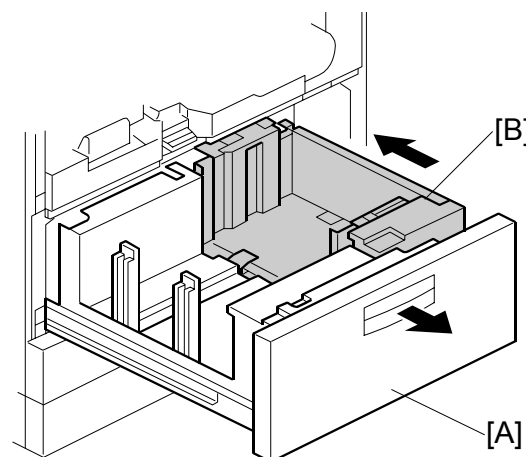

B0641564.WMF

3. Remove the right tandem inner cover [C].
4. Re-position the side fences [D] (2 screws).
The outer slot position is used when loading A4 size paper.
5. Re-install the right tandem inner cover [C].

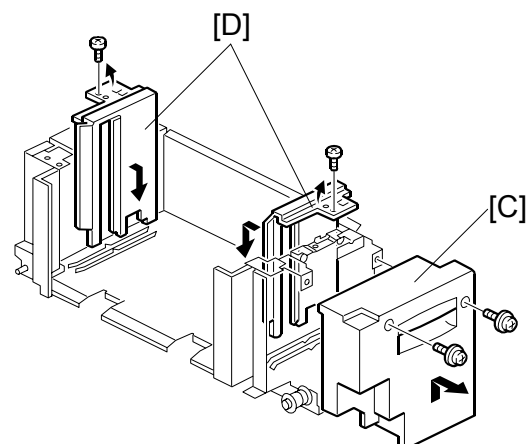

B0641565.WMF

Reissued: 8-Apr-05

Model: Martini-P1

Date: 2-Mar-05

No.: RG126002a

6. Remove the tray cover [A] (2 screws).
7. Remove the motor cover [B] (4 screws).

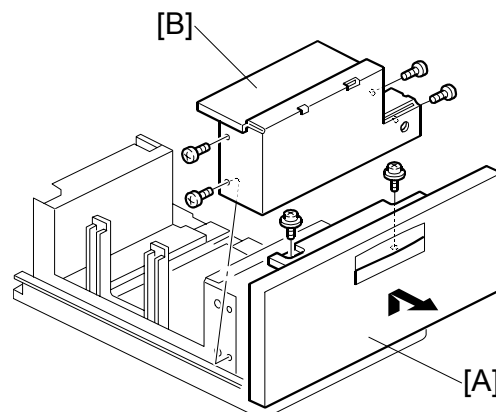

B0641566.WMF

8. Re-position the side fences [C] (8 screws). The outer slot position is used when loading A4 size paper.
9. Re-install the motor cover and the tray cover.

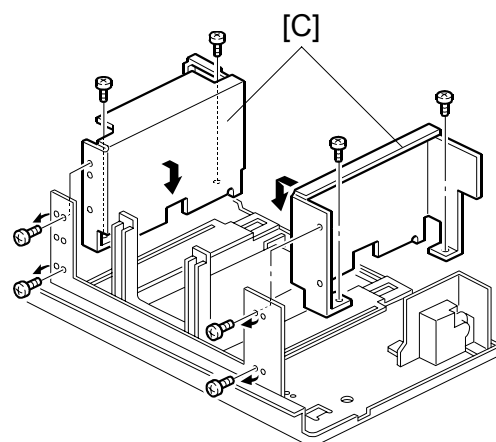

B0641523.WMF

10. Remove the rear bottom plate [D] (1 screw).
11. Re-position the return position sensor bracket [E] (1 screw). To use the paper tray for A4 size, put the screw in the left hole as shown. (For LT size, the screw should be placed on the right.)
12. Re-install the rear bottom plate.
13. Change the paper size using SP5959-001 (Paper Size – Tray 1).

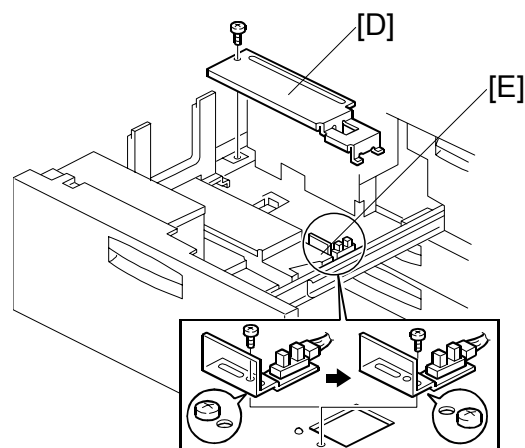

B0641024.WMF

Reissued: 8-Apr-05

Model: Martini-P1

Date: 2-Mar-05

No.: RG126002a

Machine Level

1. Set a stand [A] at each corner of the machine.
2. Place a level on the exposure glass and use a wrench to turn each nut [B] and level the machine to ± 5 mm of the horizontal.
3. Check the machine operation. With the customer, determine the best place to attach the cleaning reminder decal.

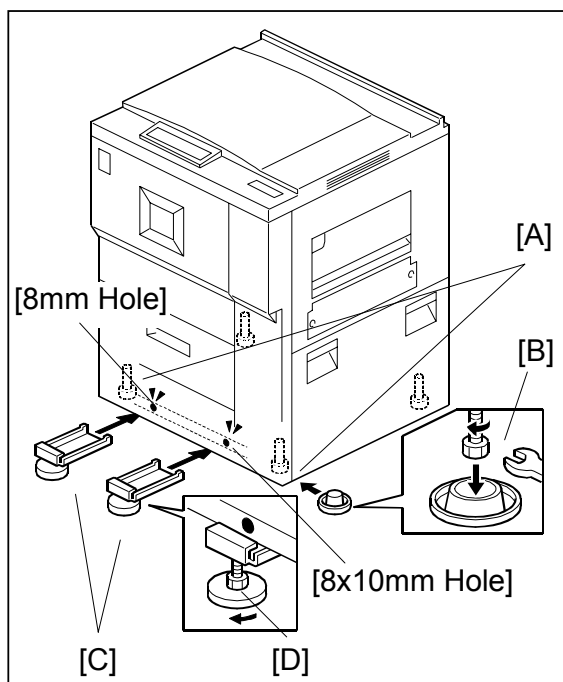

Leveling Stopper

1. Put the 2 leveling stoppers [C] under the paper bank frame.
Put one under the 8mm hole, and the other under the 8x10mm hole.
2. While you press the leveling stopper flat against the paper bank frame, turn the nuts [D] to increase the height of the leveling stopper.
IMPORTANT: Use a wrench to turn each nut.
3. Do Step 2 until the long part of the leveling stopper is tight against the underside of the paper bank frame.
4. Make sure the machine does not move when you try to push it left and right.
IMPORTANT: If it moves, repeat this procedure.

Model: Martini-P1	Date: 2-Mar-05	No.: RG126002a
-------------------	----------------	----------------

Call Light Setting

1. Do an accessory check.

Check the accessories and their quantities against this list:

Description	Q'ty
LED Stand	1
LED Stand Front Cover	1
LED Stand Rear Cover.....	1
Cable: SWB.....	1
Screw M4X8	1
Screw M4X14	4

2. Remove the rear upper right cover [A] (1 screw).

3. Connect one end of the long cable to the mainframe port [B].

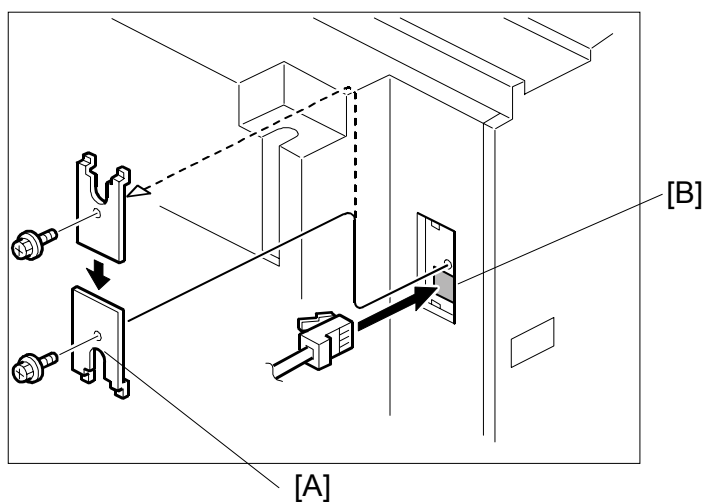

4. Reattach the rear upper right cover [A] so that the cut-in faces downward.

Reissued: 8-Apr-05

Model: Martini-P1

Date: 2-Mar-05

No.: RG126002a

5. Remove the right cap.
6. Attach the LED Stand (4 screws).
7. Connect one end of the long harness to the LED Stand Front Cover (CN592).

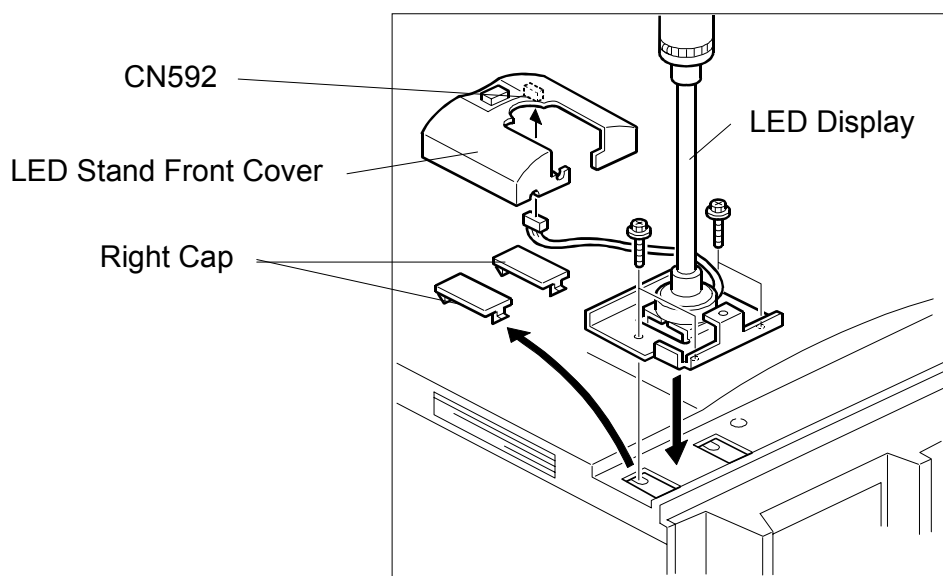

8. Connect the other end of the long cable to CN591.
9. Lead the cable through the ribs on the LED Stand Front Cover (see the photo).

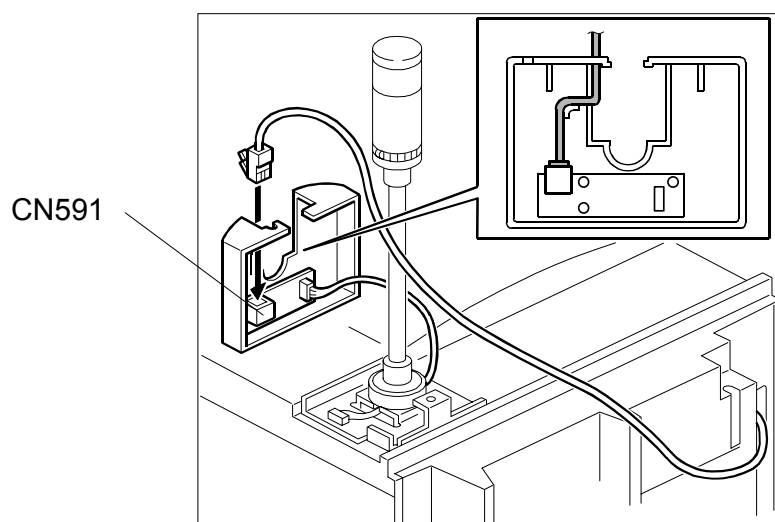

Reissued: 8-Apr-05

Model: Martini-P1

Date: 2-Mar-05

No.: RG126002a

- 10. Attach the LED Stand Front Cover.
- 11. Attach the LED Stand Rear Cover (1 screw).

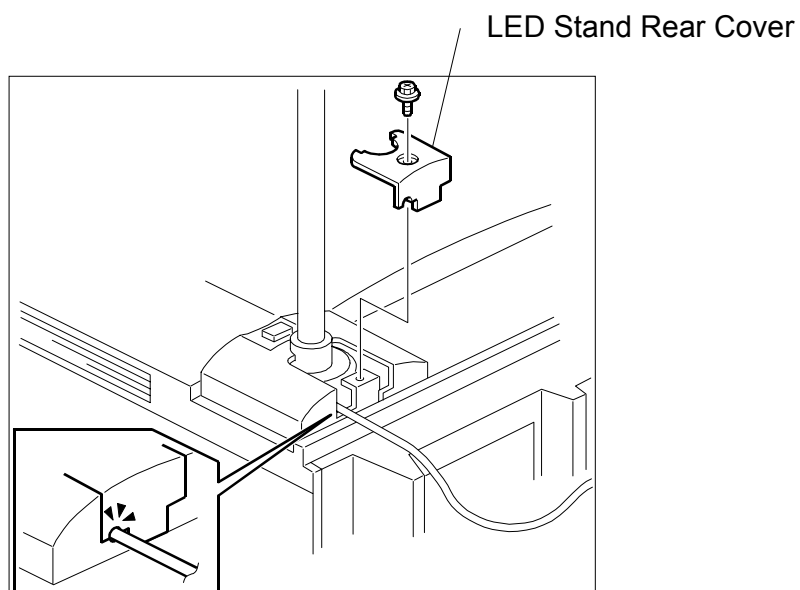

Reissued: 8-Apr-05

Model: Martini-P1

Date: 2-Mar-05

No.: RG126002a

3. A3/DLT Feeder Kit (B475)

Accessory Check

Check the accessories and their quantities against this list:

Description	Q'ty
1. A3/DLT Tray	1
2. Short connector	1
3. Page size decals	1

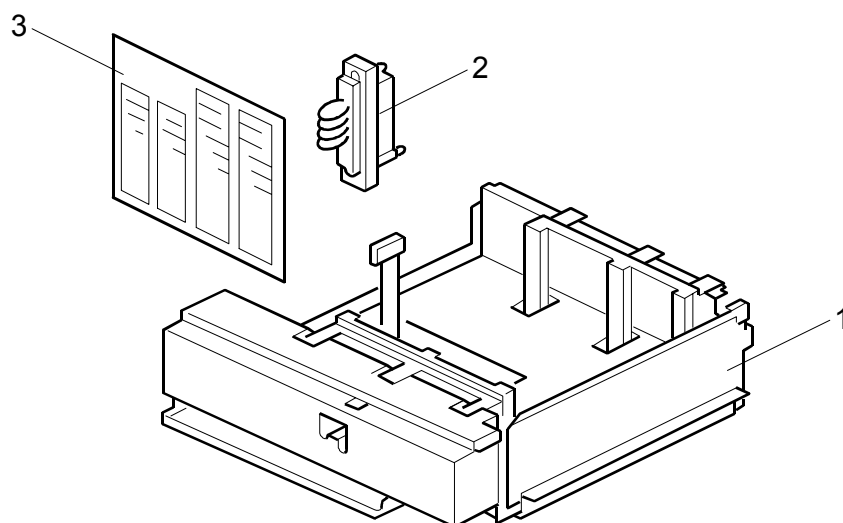

B475I001.WMF

Reissued: 8-Apr-05

Model: Martini-P1

Date: 2-Mar-05

No.: RG126002a

Installation Procedure

CAUTION

Switch the machine off and unplug the machine before starting the following procedure.

1. Draw out the tandem tray completely to separate the left and right sides of the tray, then remove the front cover [A] (2 screws).
2. Push in the right tandem tray [B].

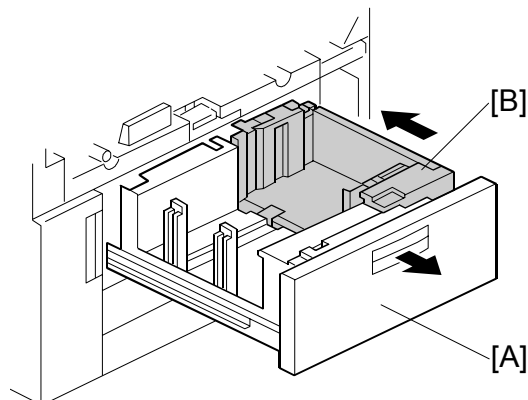

B4751707.WMF

3. Remove the left tandem tray [C] (5 screws). Save these screws.

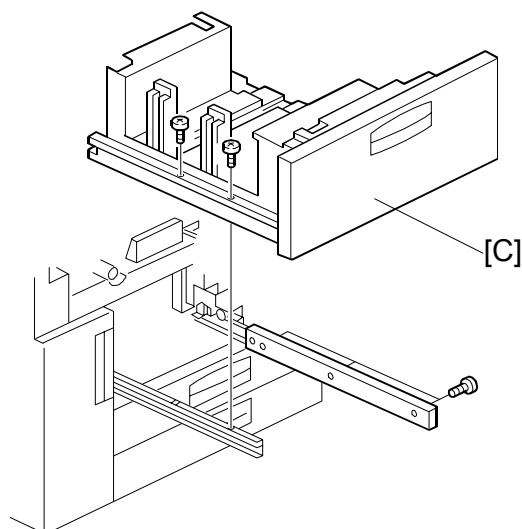

B4751708.WMF

Reissued: 8-Apr-05

Model: Martini-P1

Date: 2-Mar-05

No.: RG126002a

4. Remove the right tandem tray [A] (2 screws). Save these screws.

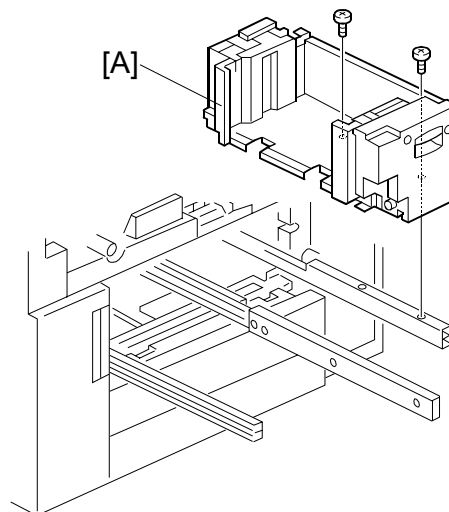

B4751709.WMF

5. Connect the short connector [B] to the left tandem tray terminal [C].

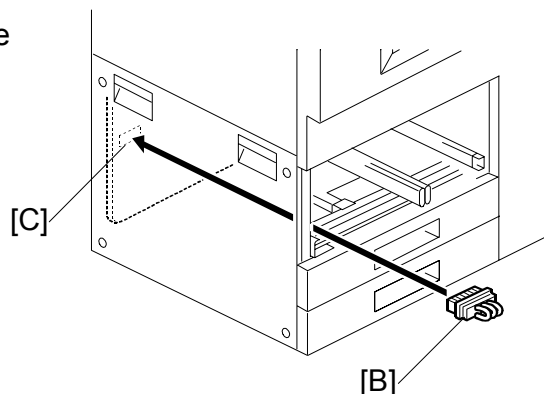

B4751201.WMF

6. Remove the stay [D] (2 screws) and re-install it.
7. Attach the A3/DLT tray [E], using the screws removed earlier.
8. Re-install the front cover.
9. Switch the machine on, enter the SP mode and select the paper size for Tray 1 with SP5959-001 (Paper Size – Tray).
10. Attach the appropriate decal for the selected paper size.

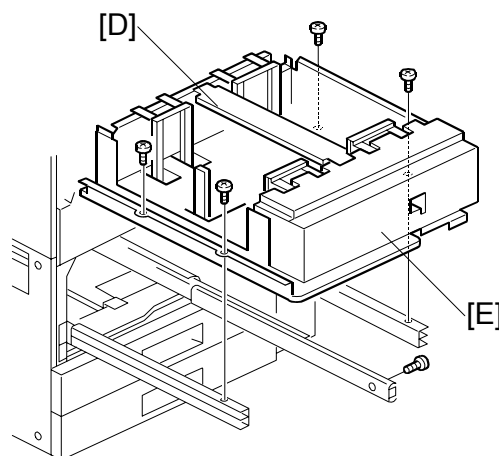

B4751202.WMF

Reissued: 8-Apr-05

Model: Martini-P1	Date: 2-Mar-05	No.: RG126002a
-------------------	----------------	----------------

4. LCT (B473)

Accessory Check

Check the accessories and their quantities against this list:

Description	Q'ty
1. Flat-head shoulder screw - M4 x 6	1
2. Upper docking pins (grooved)	2
3. Lower docking pin (not grooved)	1
4. Installation Instructions	1
5. Paper Set Decal	1

Reissued: 8-Apr-05

Model: Martini-P1

Date: 2-Mar-05

No.: RG126002a

Installation Procedure

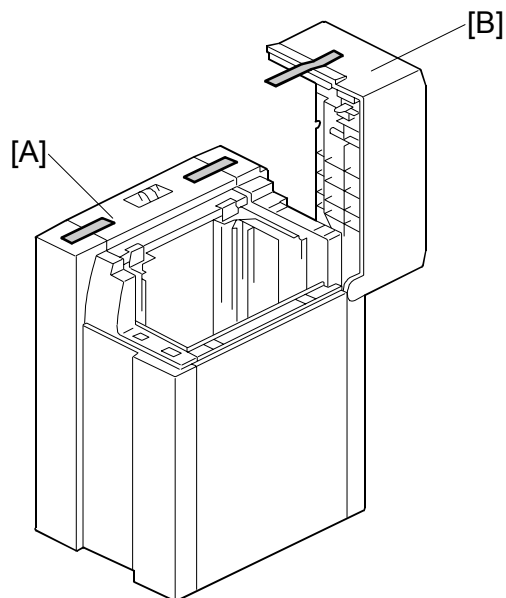

B473I001.WMF

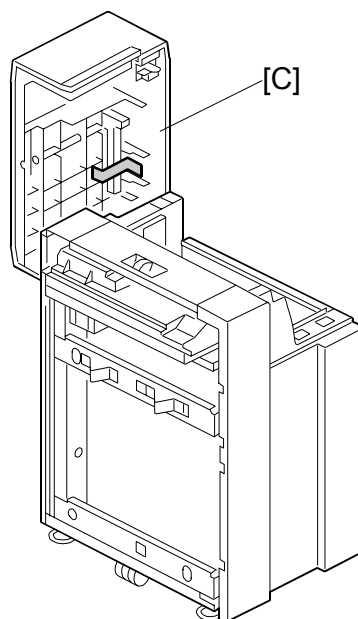

B473I002.WMF

Removing Tape

1. Remove the filament tape from the body [A] and top cover [B] of the LCT.
2. Remove the tape under the lid [C] of the LCT.

Reissued: 8-Apr-05

Model: Martini-P1

Date: 2-Mar-05

No.: RG126002a

Preparing the Main Machine

CAUTION

Switch the machine off and unplug the machine before starting the following procedure.

1. Remove the LCT installation cover [A] from the right side of the machine. (2 screws).
2. Save the screw on the left [B]. You will need it to install the LCT.
3. Remove the LCT connector cover [C] (x 1) and the covers over the holes for the docking pins [D]. (x 3)

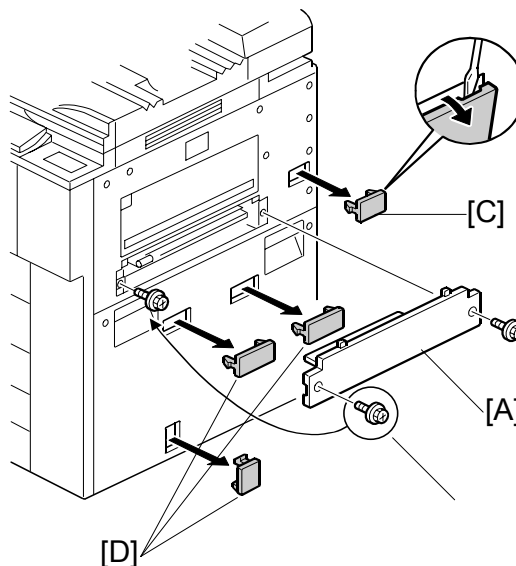

B473I003.WMF

Installing the LCT

1. Insert the two upper docking pins (grooved) [A] into the upper slots and the lower docking pin [B] into the lower slot.

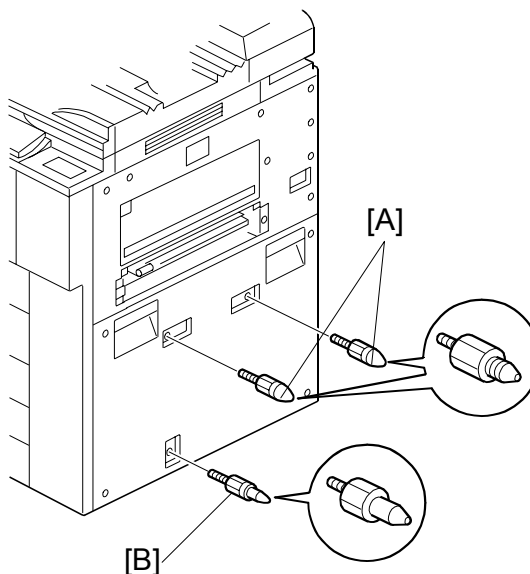

B473I004.WMF

Reissued: 8-Apr-05

Model: Martini-P1

Date: 2-Mar-05

No.: RG126002a

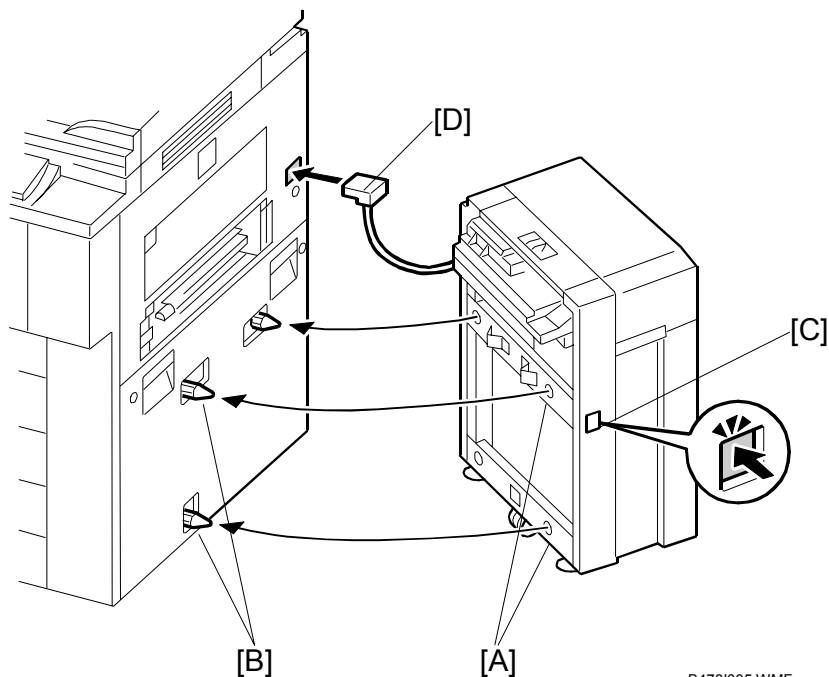

B473I005.WMF

2. Align the holes on the side of the LCT [A] with the docking pins on the side of the machine [B], then slowly push the LCT onto the pins.

NOTE: The release button [C] is used to unlock the LCT so it can be disconnected from the machine.

3. Connect the plug [D] of the LCT power cord to the side of the machine.
4. Insert the flat-head shoulder screw [E] into the hole and fasten it to lock the release lever in place.
For easier access to the hole for the screw [E], you can remove the right panel [F] (2 screws).

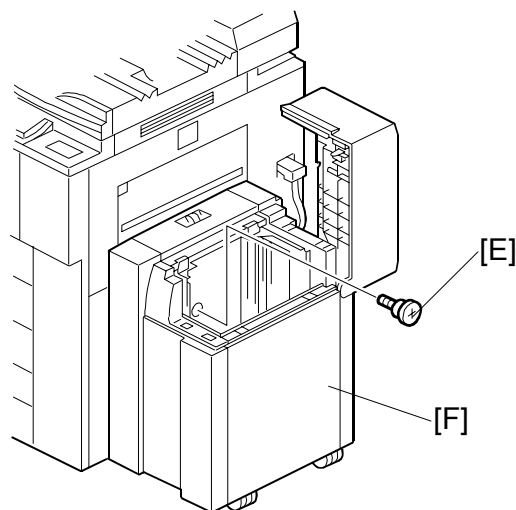

B473I006.WMF

5. Switch the machine on and execute SP5959 005 (Paper Size – Tray 4 (LCT)) to select the paper size.

Reissued: 8-Apr-05

Model: Martini-P1	Date: 2-Mar-05	No.: RG126002a
-------------------	----------------	----------------

5. LG/B4 Feeder Kit (B474)

ACCESSORY CHECK

Check the accessories and their quantities against this list:

Description	Q'ty
1. Tapping screws - M4 x 8	4
2. Tapping hex screws - M4 x 8.....	6
3. Harness clamp	1
4. B4/LG frame	1
5. Front bracket	1
6. Rear bracket.....	1
7. Bottom plate extension	1
8. Cover	1

Reissued: 8-Apr-05

Model: Martini-P1

Date: 2-Mar-05

No.: RG126002a

Installation Procedure

If the LCT is connected to the machine

1. Open the cover and remove the paper.
2. Lower the LCT tray. Cover the near end sensor [A], then press the tray down button [B] to lower the tray bottom plate.

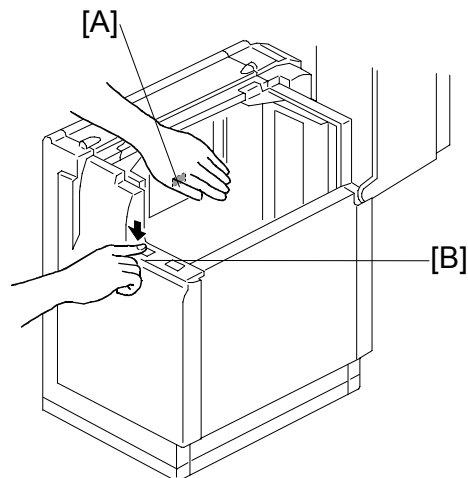

B474I507.WMF

CAUTION

Switch the machine off and unplug the machine before starting the following procedure.

3. Disconnect the LCT from the machine.
4. Remove the LCT upper cover [C].

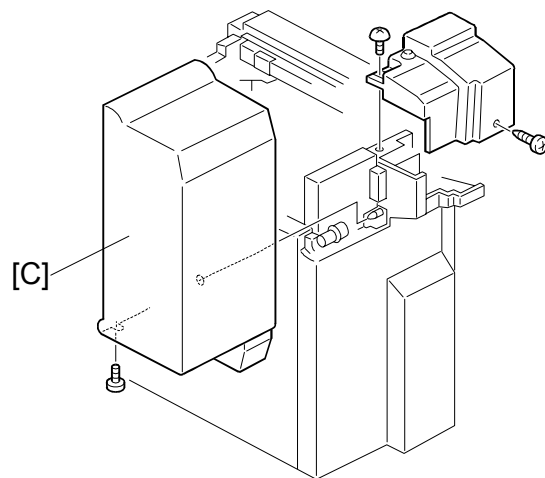

B474I504.WMF

Reissued: 8-Apr-05

Model: Martini-P1

Date: 2-Mar-05

No.: RG126002a

5. Remove the LCT cover [A] (1 screw).
6. Remove the right stay [B] and re-attach it below (2 screws).
7. Remove the right cover [C] (2 screws).

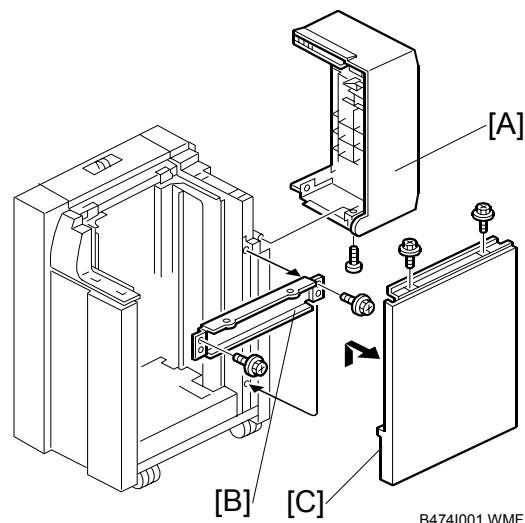

8. Attach the front bracket [D] with the beveled corner down (2 screws).
NOTE: If the brackets are difficult to install, raise the bottom plate with your hand.
9. Attach the rear bracket [E] with the beveled corner down (2 screws).
10. Attach the bottom plate extension [F] with the hex nuts (4 screws).

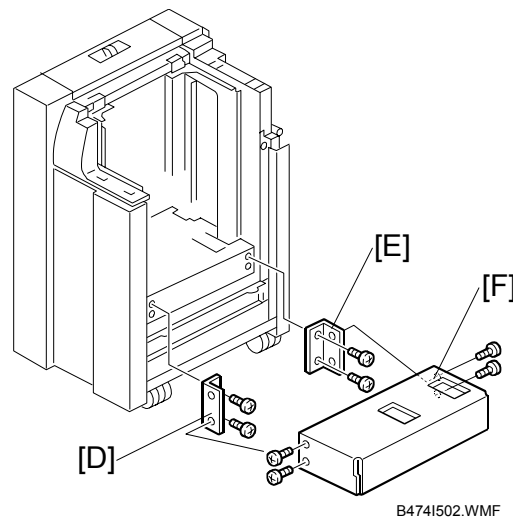

11. Align the positioning pin [G].
12. Attach the B4/LG frame [H] with the hex nuts (2 screws).

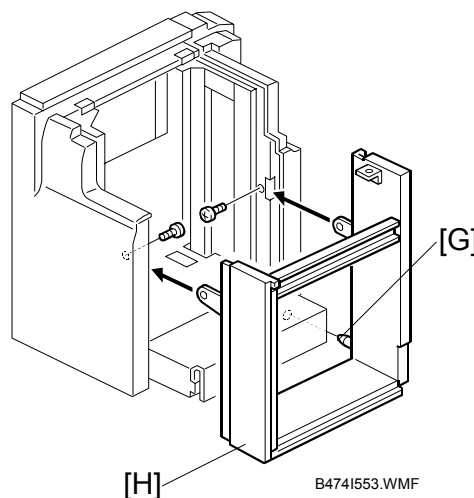

The kit is set for B4. If you need to change the paper size to LG, do the following steps.

Reissued: 8-Apr-05

Model: Martini-P1

Date: 2-Mar-05

No.: RG126002a

13. Move the front side fence [A] to the LG position and fasten (1 screw).
14. Move the rear side fence [B] to the LG position and fasten (1 screw).

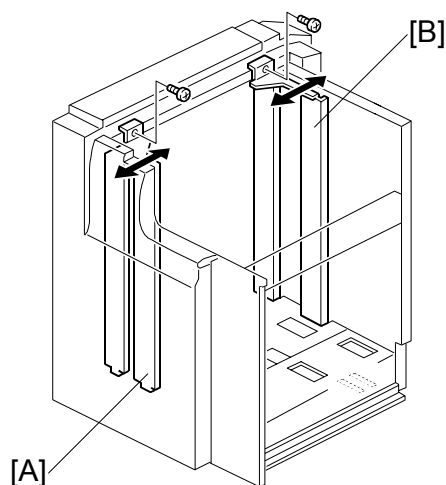

B474I555.WMF

15. Change the position of the lower limit sensor [C] (1 screw).
16. Attach the harness (not shown) to the back of the plate and secure the sensor connector wire.

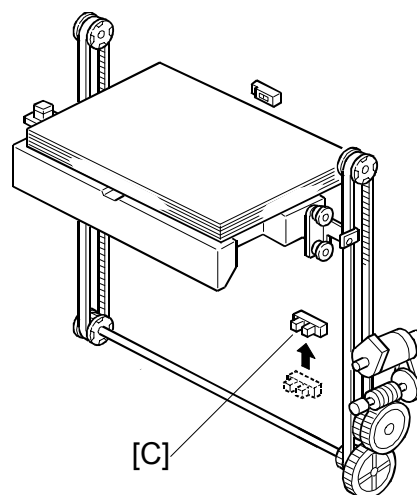

B474I508.WMF

17. Attach the LCT cover [D] provided with the kit (1 screw).
18. Re-attach the right cover [E] (2 screws).
19. Connect the LCT to the machine (0).
20. Switch the machine on, enter the SP mode, then use SP5959-005 (Paper Size – Tray 4 (LCT) to select the new paper size).

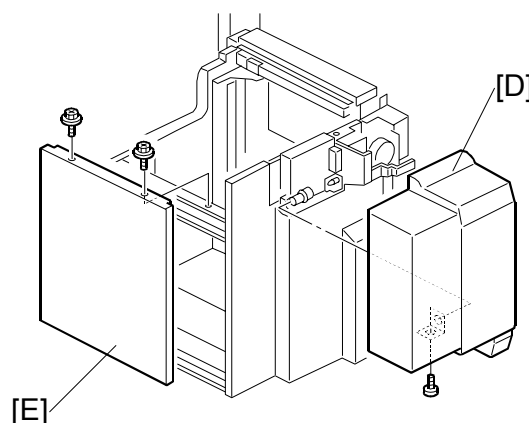

B474I506.WMF

Reissued: 8-Apr-05

Model: Martini-P1	Date: 2-Mar-05	No.: RG126002a
-------------------	----------------	----------------

6. 3000-Sheet Finishers (B674)

Accessory Check

Check the accessories and their quantities against this list:

Description	Q'ty
1. Rear joint bracket	1
2. Front joint bracket.....	1
3. Upper output tray.....	1
4. Lower output tray.....	1
5. Tapping screws - M3 x 6	2
6. Tapping screws - M4 x 8	4
7. Tapping screws - M4x 14	4
8. Cushion (with double-sided tape)	1
9. Ground (earth) plate	1
10. Installation Instructions	1

Reissued: 8-Apr-05

Model: Martini-P1

Date: 2-Mar-05

No.: RG126002a

Installation Procedure

This section describes the common installation instructions for these finishers:

- **B674 Booklet Finisher**, which can do punching, shifting, stapling, and saddle stitching with staples.

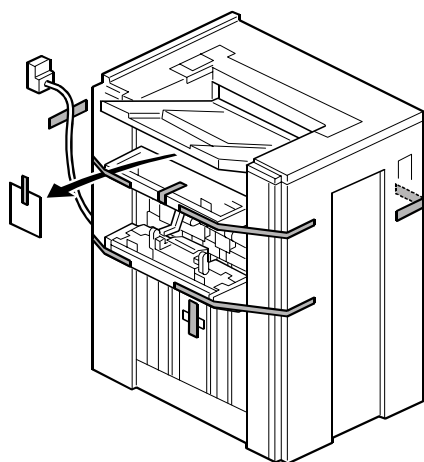

B468I001.WMF

Removing Tapes and Retainers

1. Unpack the machine and remove all the wrapping.
2. Remove all filament tape and shipping retainers from the front of the finisher.
3. Open the front door [A] and remove all the tape and shipping retainers from inside the finisher.

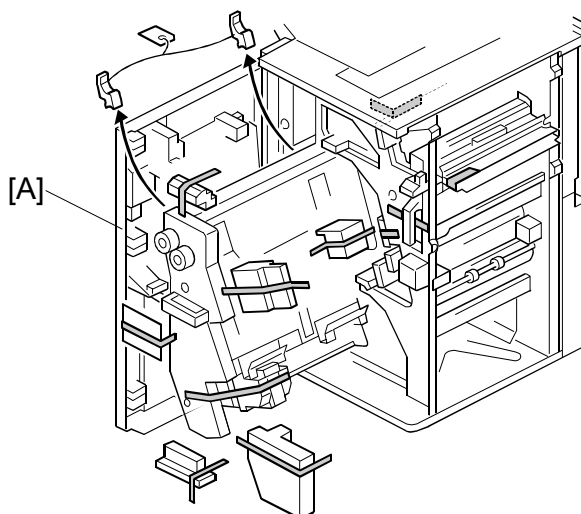

B468I002.WMF

Reissued: 8-Apr-05

Model: Martini-P1

Date: 2-Mar-05

No.: RG126002a

Installation**CAUTION**

Switch the machine off and unplug the machine before starting the following procedure.

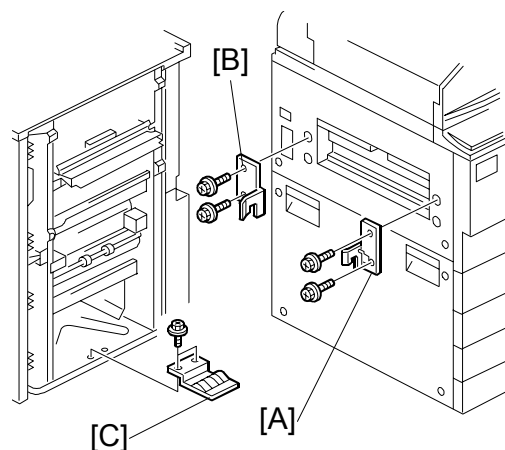

B468I003.WMF

1. Install the front [A] and rear [B] joint brackets (2 screws each, M4x 14).
2. Install the ground plate [C] (2 screws, M3 x 6).

Reissued: 8-Apr-05

Model: Martini-P1

Date: 2-Mar-05

No.: RG126002a

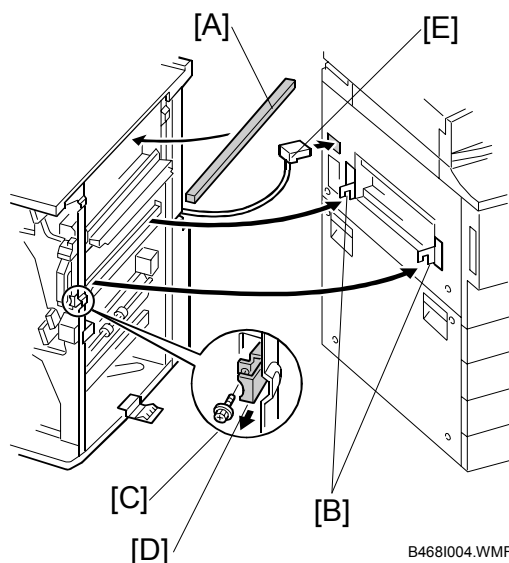

3. Peel the cover tape from the sponge cushion [A], then install it in the upper slot.
NOTE: If you will also install the cover interposer tray, do not attach the cushion here. Attach it to the cover interposer tray. The cover interposer tray must be installed on the finisher before you attach the finisher and tray to the main machine.
4. Align the brackets [B] with the slots in the finisher.
5. Slowly and carefully, to avoid bending the entrance guide plates of the finisher, push the finisher against the side of the machine until the brackets enter the slots.
6. Using the screw [C] removed above, secure the lock lever [D] (1 x 1).
7. Connect the plug [E] of the finisher power cord to the connector on the machine.

CAUTION

Always move the finisher slowly to avoid bending the entrance guide plates. Bent guide plates could interfere with paper transport from the machine to the finisher.

Reissued: 8-Apr-05

Model: Martini-P1

Date: 2-Mar-05

No.: RG126002a

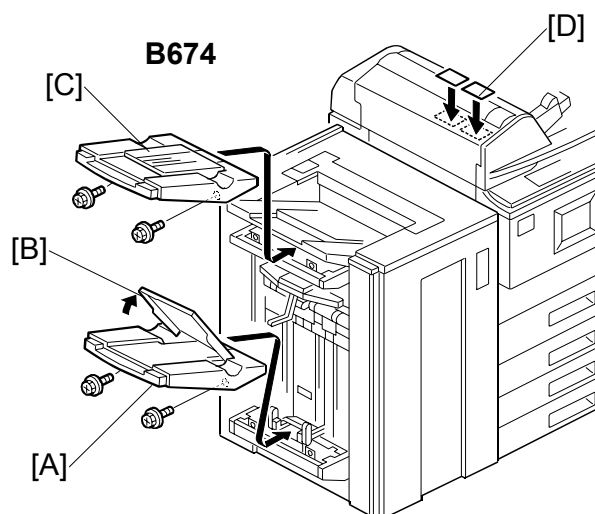

B468I005.WMF

1. Install the lower output tray [A] (2 screws).
NOTE: Only the lower output tray has a movable support tray [B].
2. Install the upper output tray [C] (2 screws).
3. Attach the staple position decal [D] to the upper cover.

Reissued: 8-Apr-05

Model: Martini-P1

Date: 2-Mar-05

No.: RG126002a

Enabling Booklet Binding

To enable booklet binding, you must select the 'center stapling' position.

These SP adjustments are available but not required at installation.

SP6902	Fold Position Adjustment	Use this SP to fine adjust the fold and staple positions if they are not aligned correctly.
SP6120	Staple Jogger Adjustment	Allows fine adjustment of the staple unit jogger fences for different paper sizes, if required.

Reissued: 8-Apr-05

Model: Martini-P1	Date: 2-Mar-05	No.: RG126002a
-------------------	----------------	----------------

7. Punch Unit (B377)

The Punch Unit B377 is installed in the 3000-Sheet Finishers B674.

Accessory Check

Check the accessories and their quantities against this list:

Description	Q'ty
1. Punch unit	1
2. Sensor arm.....	1
3. Hopper.....	1
4. Step screw.....	1
5. Spring	1
6. Spacer (2 mm).....	1
7. Spacer (1 mm).....	1
8. Tapping screw - M3 x 8	1
9. Tapping screw - M3x 10	2

Reissued: 8-Apr-05

Model: Martini-P1

Date: 2-Mar-05

No.: RG126002a

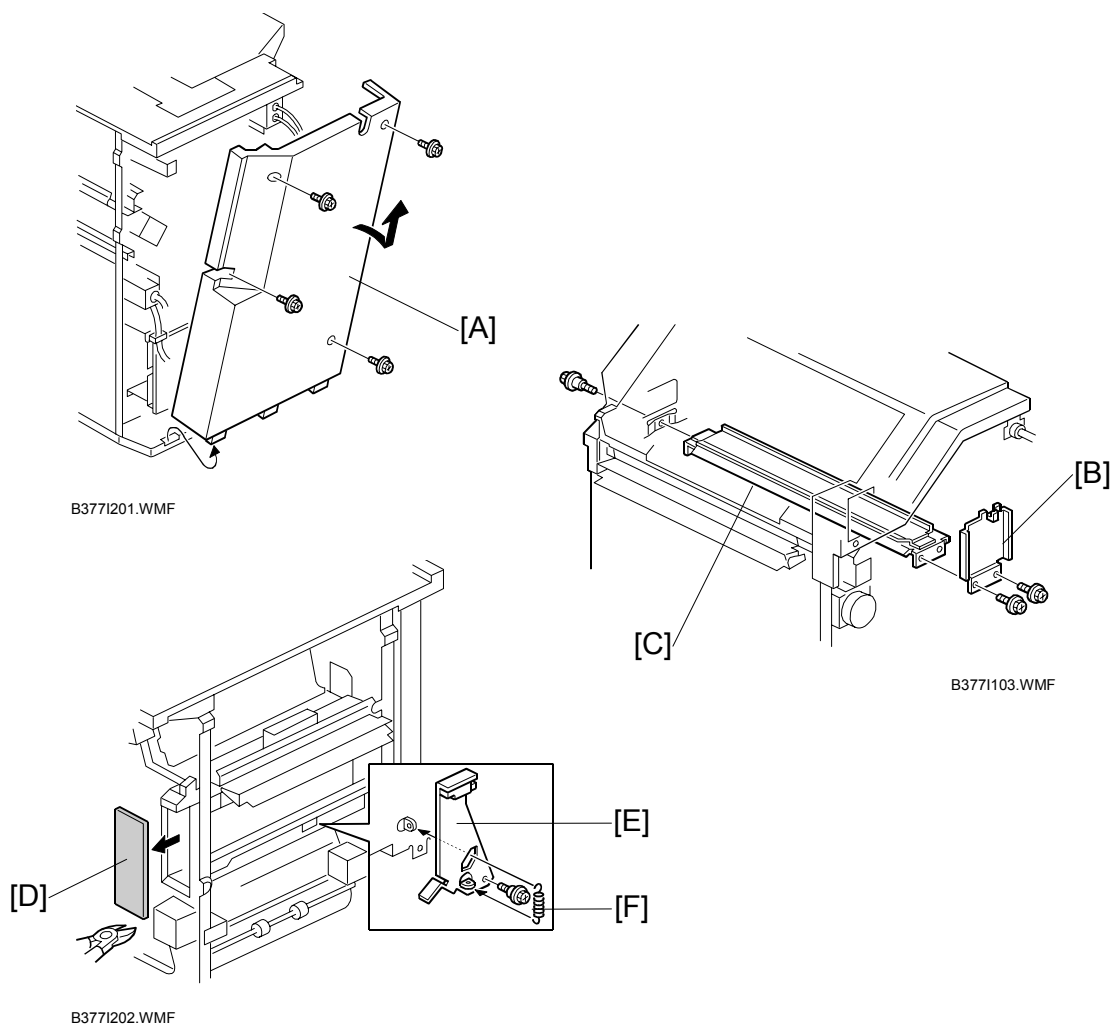

Installation Procedure

CAUTION

Switch off the main machine and unplug its power cord.

1. If the finisher is connected to the machine, disconnect it.
2. Unpack the punch unit and remove all tapes and shipping retainers.
3. Open the front door and remove the rear cover [A] (4 screws).
4. Remove the bracket [B] (2 screws) and paper guide [C] (1 screw).
5. Remove the plastic knockout [D].
6. Install the sensor arm [E] (1 screw).
7. Install the spring [F].

Reissued: 8-Apr-05

Model: Martini-P1

Date: 2-Mar-05

No.: RG126002a

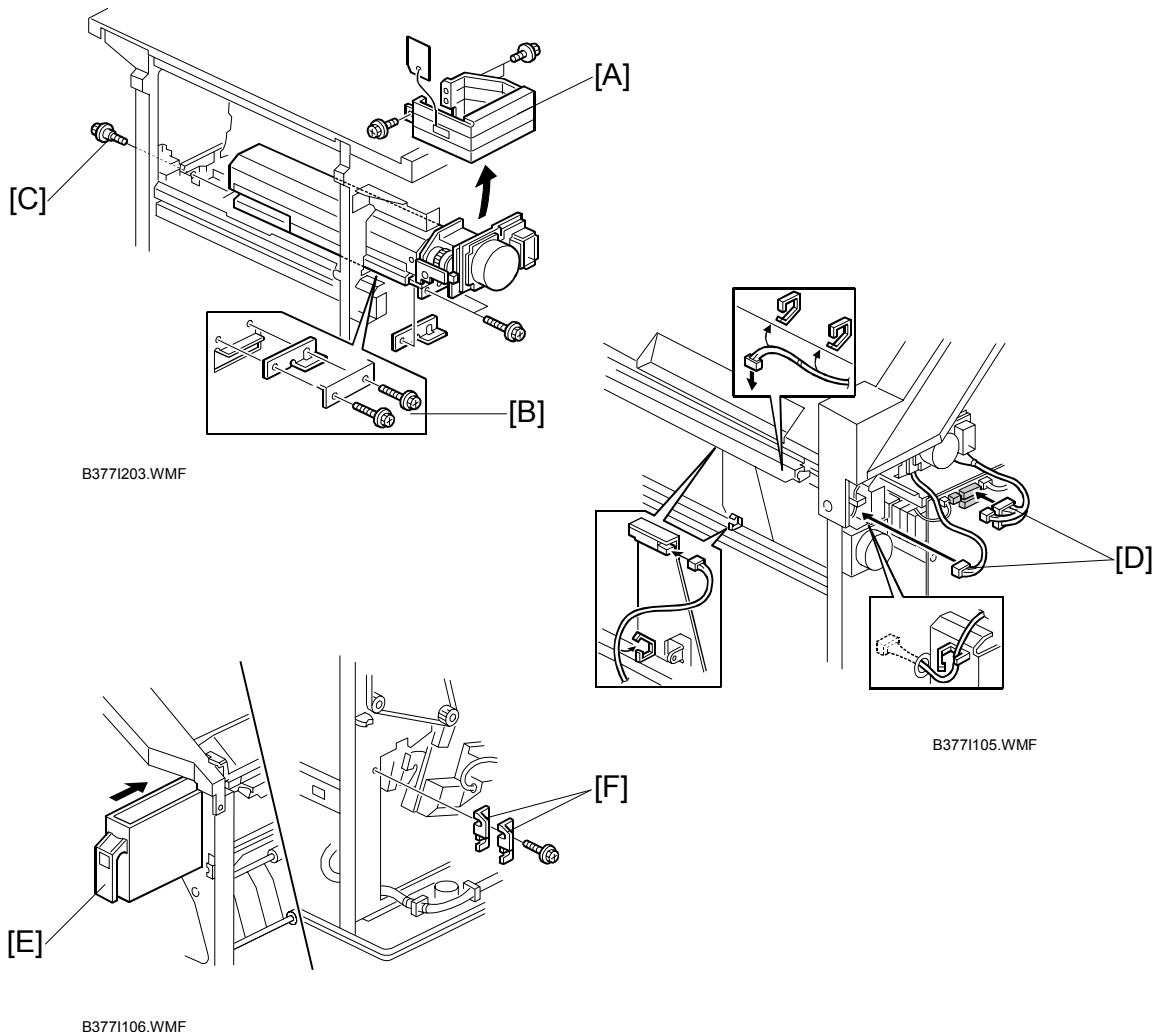

8. Remove the shipping bracket [A] (2 screws).
9. Position the 2 mm spacer [B] and secure the punch unit (2 screws).
10. Secure the punch unit at the front with the shoulder screw [C] (1 screw).
11. Connect the harnesses [D] and clamp them as shown.
NOTE: No special DIP switch settings are required for this punch unit. The punch unit sends an identification signal to the machine, so it knows what type of punch unit has been installed.
12. Slide the hopper [E] into the machine.
13. Fasten the two 1 mm spacers [F] to the rear frame. These may be used during future adjustments.
NOTE: The spacers are used to adjust the horizontal positioning of the holes.
14. Reassemble the finisher and check the punch operation.

Reissued: 8-Apr-05

Model: Martini-P1

Date: 2-Mar-05

No.: RG126002a

8. Cover Interposer Tray (B470)

Accessory Check

Check the accessories and their quantities against this list:

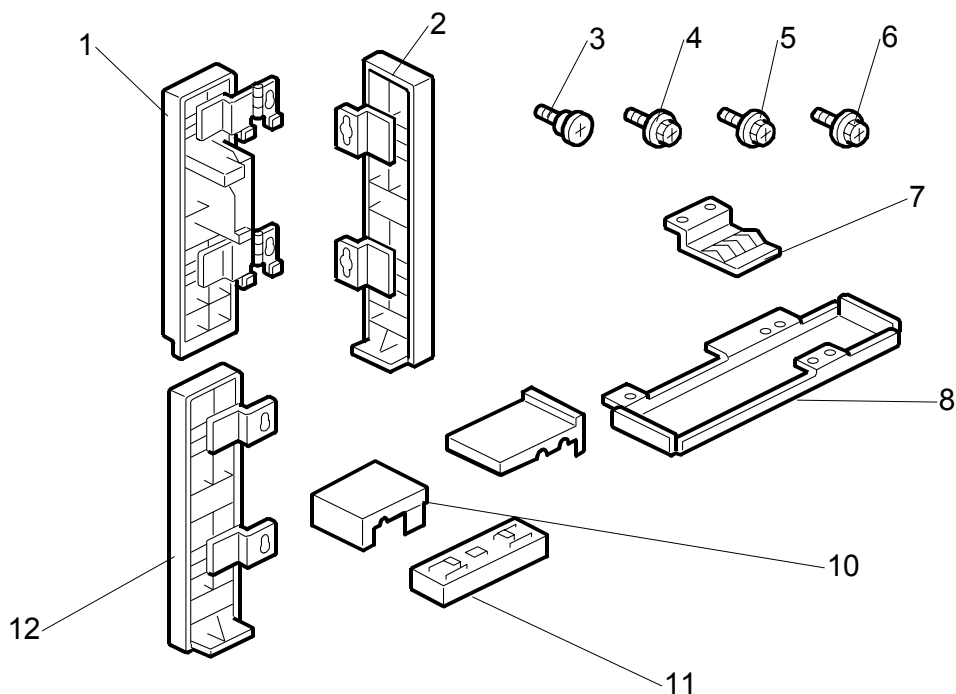

B470I006.WMF

Description

Q'ty

1. Front door extension (Top)	1
2. Rear cover extension (bottom)	1
3. Shoulder screws	3
4. Tapping screws – M4 x 8.....	7
5. Tapping screws – M3 x 6.....	2
6. Tapping screws – M3 x 6.....	5
7. Ground Plate	1
8. Plate extension (bottom).....	1
9. Right rear cover plate (for B706 only).....	2
10. Right front corner plate (for B706 only).....	2
11. Spacer (B674 only).....	1
12. Front door extension (bottom)	1

Reissued: 8-Apr-05

Model: Martini-P1	Date: 2-Mar-05	No.: RG126002a
-------------------	----------------	----------------

Installation Procedure

This procedure shows you how to install the Cover Interposer Tray B470 on the:

- 3000-sheet Finisher (Booklet Finisher) B674
- 3000-sheet Finisher B706.

NOTE: The B674 requires installation of only the front spacer.

The B706 requires installation of corner plates.

Removing Tapes and Retainers

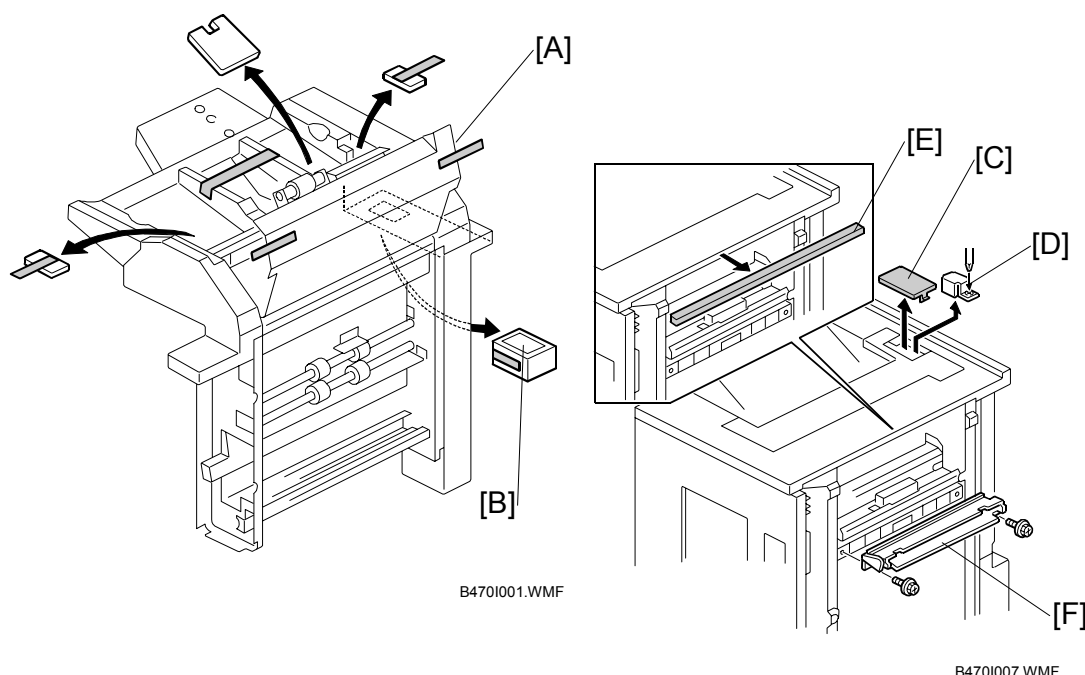

1. If the finisher is connected to the machine, disconnect it.
2. Remove all tape and retainers from the cover interposer tray [A].
3. Remove the tape and cardboard [B] from the ground connector.
4. Remove the cover [C] of the relay connector.
5. Loosen the screw of the bracket [D] (1 screw) then remove the bracket.
NOTE: If you will install the cover interposer tray with a finisher that was installed on the machine before this time (B706), remove the sponge strip [E] from the finisher. Keep it until you attach it again to the interposer tray.
6. Remove the guide plate [F].

Reissued: 8-Apr-05

Model: Martini-P1

Date: 2-Mar-05

No.: RG126002a

Attaching the Extensions

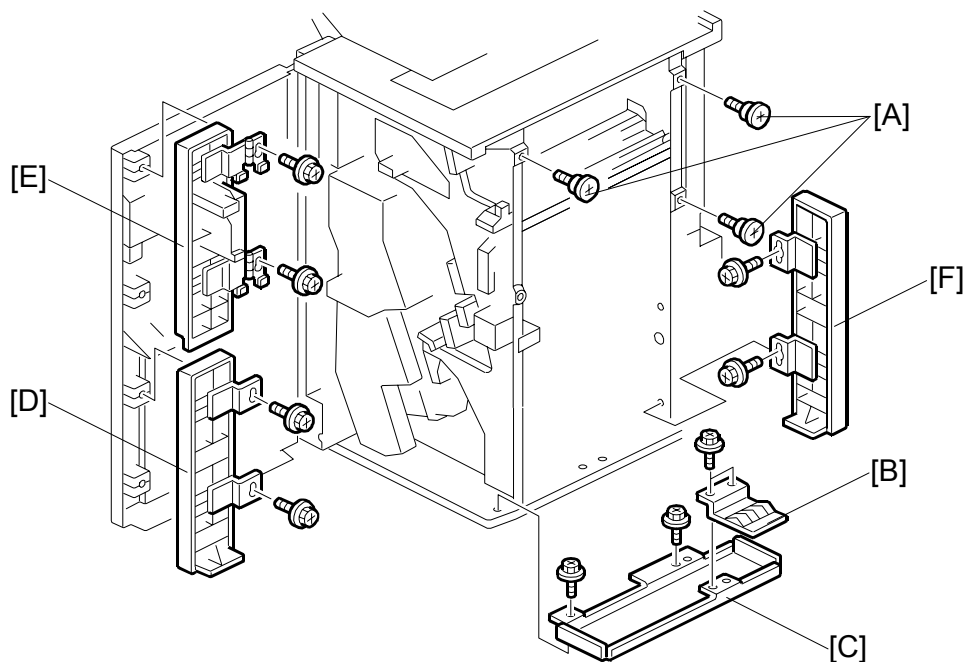

B470I003.WMF

CAUTION

Make sure that the finisher is disconnected from the main machine and that the machine is turned off and disconnected from the power outlet before you start the following procedure.

1. Attach the three shoulder screws [A] (3 screws).
2. Remove the ground plate [B] from the finisher, and keep the screws
3. Attach the bottom plate [C] (2 screws, M3 x 6). Then attach the ground plate [B] to the bottom plate (2 screws) with the screws that you removed in step 2.
4. Attach the bottom front door extension [D] (2 screws, M4 x 8).
5. Attach the top front cover extension [E] (2 screws, M4 x 8).
6. Attach the rear cover extension [F] (2 screws, M3 x 6).

Reissued: 8-Apr-05

Model: Martini-P1

Date: 2-Mar-05

No.: RG126002a

Attaching the Interposer Tray

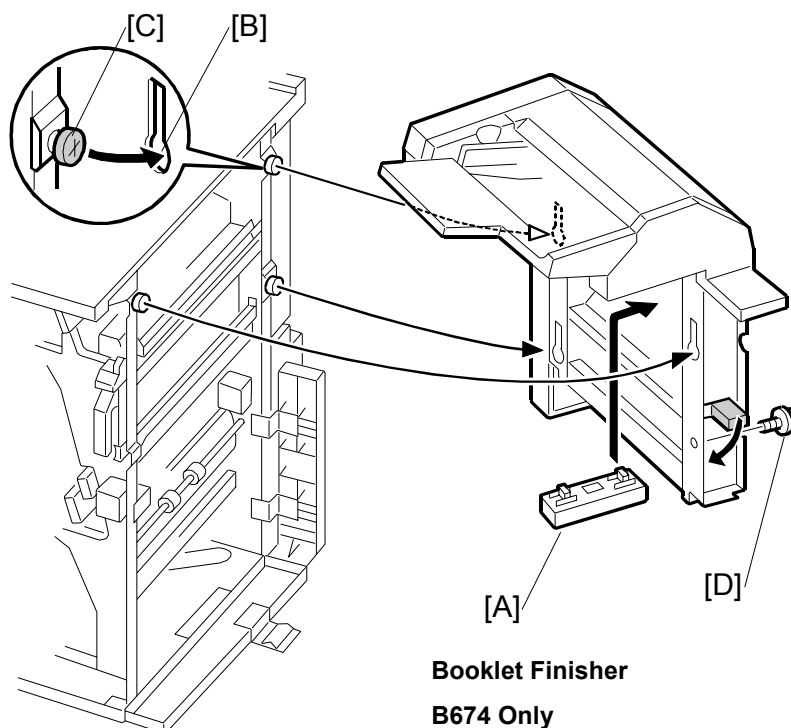

B470I004.WMF

1. If you install the cover interposer tray on the B674 finisher, install the spacer [A]. You will hear a click when it is installed correctly.
NOTE: If you install the cover interposer tray on the B706, do not install this spacer. This spacer is for the B674 installation only.
2. Lift the cover interposer tray, and align the keyholes [B] with the shoulder screws [C]. Then move the cover interposer down onto the screws.
3. Attach the cover interposer with the screw [D] (1 screw, M3 x 6).

IMPORTANT

- If you are installing the cover interposer tray on the B674, skip the next section and go directly to “Attaching the Finisher to the Machine” on page 50.
- If you are installing the cover interposer tray on the B706, go to the next section, install the corner plates on the B706, then go to “Attaching the Finisher to the Machine” on page 50.

Reissued: 8-Apr-05

Model: Martini-P1

Date: 2-Mar-05

No.: RG126002a

Attaching the Corner Plates for the B706

The corner plates are installed on the B706 only. Attach the cover interposer tray to the finisher before you attach the corner plates.

Right Rear Corner Plate (B706 only)

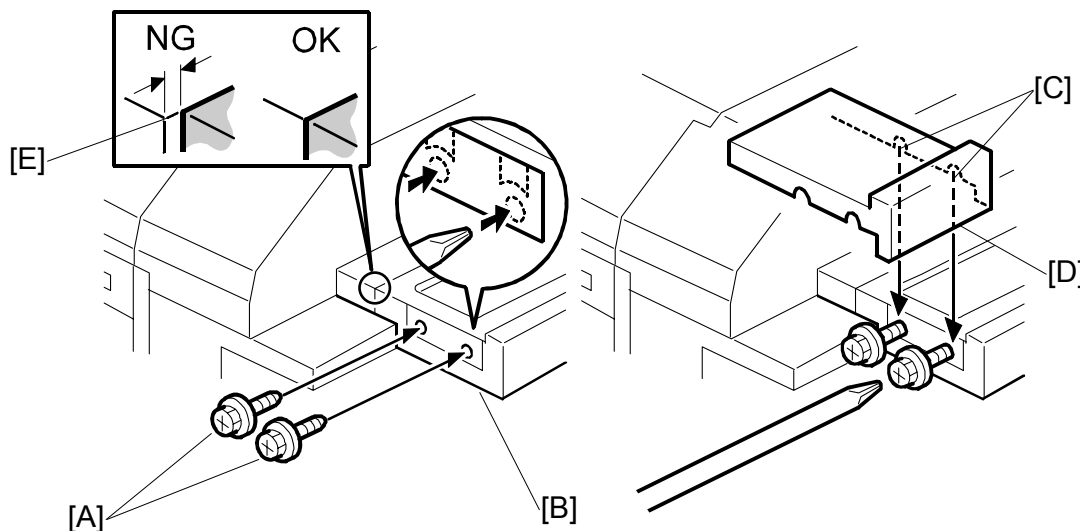

B470I009.WMF

1. Temporarily set the screws [A] (with approximately two turns) at the right end of the finisher extension table [B] (2 screws, tapping M4 x 8)
NOTE: You cannot see the holes, because there is tape on them. Punch the screws through the holes.
2. Align the notches [C] in the right rear corner plate [D] with the screws, and attach the plate.
3. If there is a gap [E] between the plate and the tray extension attached to the side of the finisher:
 - Loosen the two screws below the table extension (not shown)
 - Align the table extension with the corner of the finisher and the plate
 - Tighten the tray extension screws.
4. With a long screw driver inserted through the notches in the right rear corner plate [D], tighten the screws. This attaches the right rear corner plate to the table extension [B].

Reissued: 8-Apr-05

Model: Martini-P1

Date: 2-Mar-05

No.: RG126002a

Right Front Corner Plate (B706 only)

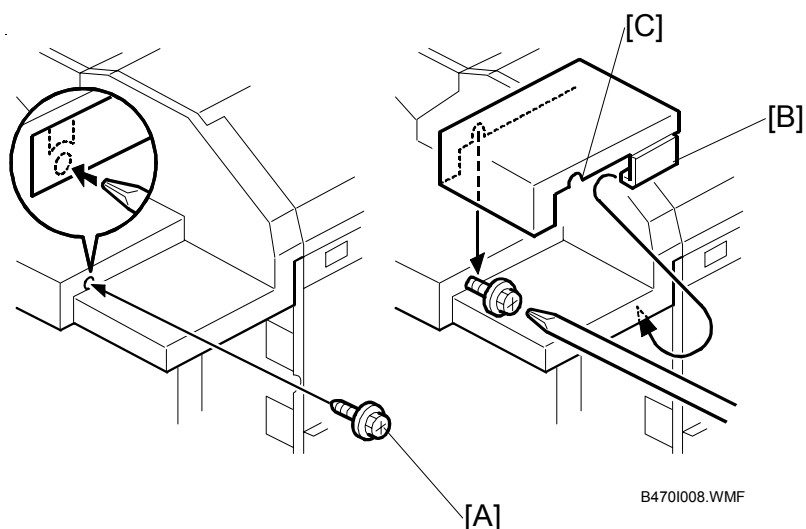

1. Temporarily set the screw [A] (1 screw, M4 x 8) (with approximately two turns) to attach the panel at the right front corner.
NOTE: You cannot see the hole, because there is tape on it. Punch the screw through the hole.
2. Align the notch in the right front corner plate [B] with the screw and install it. You hear a click when it is put into its correct position.
3. Put a long screwdriver into the plate cutout [C]. Then, tighten the screw to attach the right front corner plate.

Reissued: 8-Apr-05

Model: Martini-P1

Date: 2-Mar-05

No.: RG126002a

Attaching the Finisher to the Machine

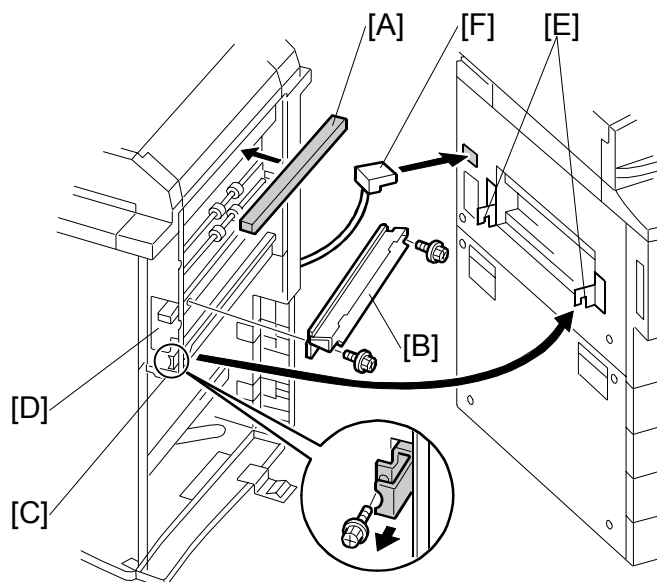

B470I005.WMF

1. Attach the sponge strip [A] (this is supplied with the finisher).
NOTE: If you will install the cover interposer tray with a finisher that was installed on the machine before this time, remove the strip from the finisher and attach it to the cover interposer tray.
2. Attach the guide plate [B] (removed from the finisher) to the cover interposer (2 screws).
NOTE: Make sure to use the two small tapping screws supplied with the machine, and not the machine screws that you removed from the finisher with the guide plate.
3. Release the lock lever [C] (1 screw).
4. Lower the transport guide plate [D].
5. Slowly push the finisher against the side of the machine until the brackets [E] go into the slots.
IMPORTANT: Do the above step carefully. Do not bend the entrance guide plates. Bent guide plates could cause a blockage for paper transport between the finisher and printer.
6. Attach the lock lever [C] (1 screw).
7. Lift the transport guide plate [D] to close it.
8. Connect the connector [E] into the printer.

Reissued: 8-Apr-05

Model: Martini-P1	Date: 2-Mar-05	No.: RG126002a
-------------------	----------------	----------------

9. Switch on the machine, and select the default paper size for the cover interposer.
IMPORTANT: Be sure to execute the correct SP code for the machine. Please refer to the table below.

Machine	Correct SP Code
G126 series	SP5158-001 to 008

Reissued: 8-Apr-05

Model: Martini-P1	Date: 2-Mar-05	No.: RG126002a
-------------------	----------------	----------------

9. 3000 Sheet Finisher (B706)

Accessory Check

Check the accessories and their quantities against this list:

Description	Q'ty
11. Cushion	1
12. Table Extension.....	1
13. Leveling Shoes	1
14. Rear Joint Bracket.....	1
15. Front Joint Bracket	1
16. Entrance Guide Plate	1
17. Grounding Plate	1
18. Auxiliary Tray Holder	2
19. Auxiliary Tray - Proof.....	2
20. Auxiliary Tray - Shift	2
21. Tapping Screws - M4 x 8.....	2
22. Tapping Screws - M3 x 6.....	4
23. Tapping Screws - M3 x 8.....	4
24. Phillips Screws w/washer - M4 x 14	4
25. Shift Tray	4
26. Installation Procedure.....	1

Reissued: 8-Apr-05

Model: Martini-P1

Date: 2-Mar-05

No.: RG126002a

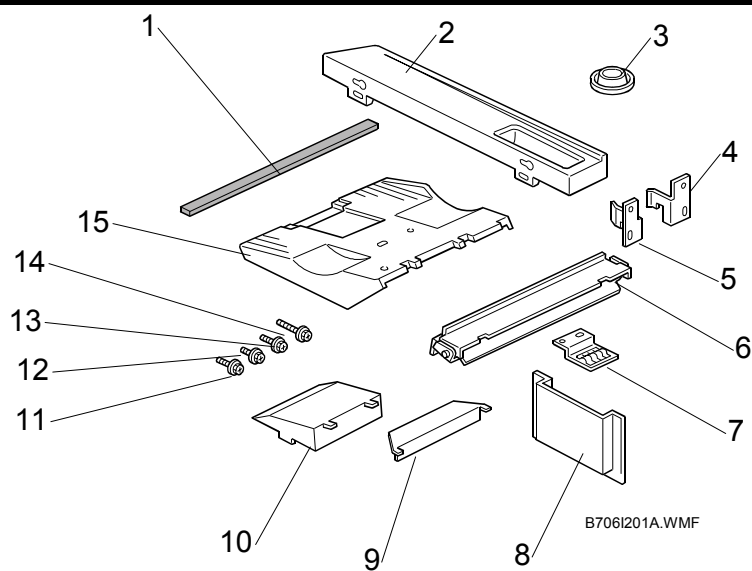

Reissued: 8-Apr-05

Model: Martini-P1

Date: 2-Mar-05

No.: RG126002a

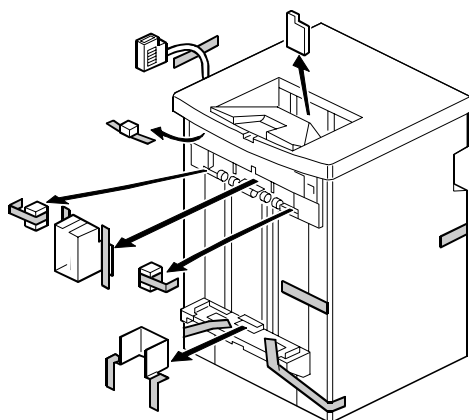

B478I002.WMF

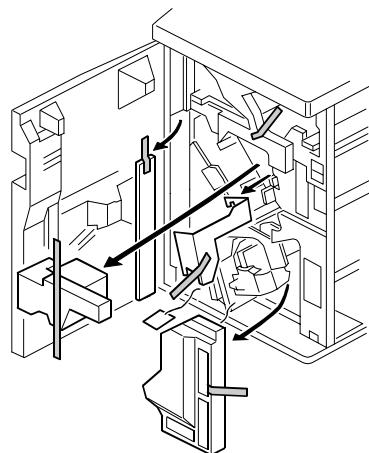

B478I003.WMF

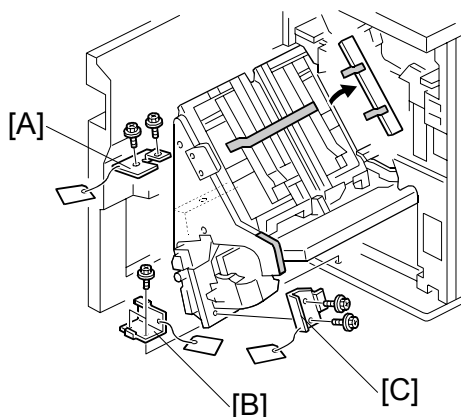

B478I014.WMF

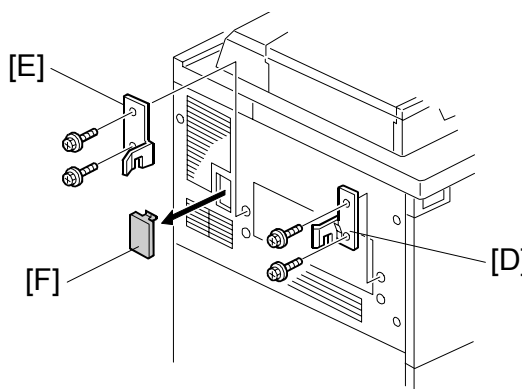

B478I019.WMF

Installation Procedure

CAUTION

Unplug the machine power cord before starting the following procedure.

1. Unpack the finisher and remove all tapes and shipping retainers.
2. Open the front door and remove the shipping retainers. Remove brackets [A], [B], and [C] (2 screws each).
3. Install the front joint bracket [D] and rear joint bracket [E] (2 screws each) (M4 x 14) on the left side of the copier.
4. Remove the connector cover [F].

Reissued: 8-Apr-05

Model: Martini-P1

Date: 2-Mar-05

No.: RG126002a

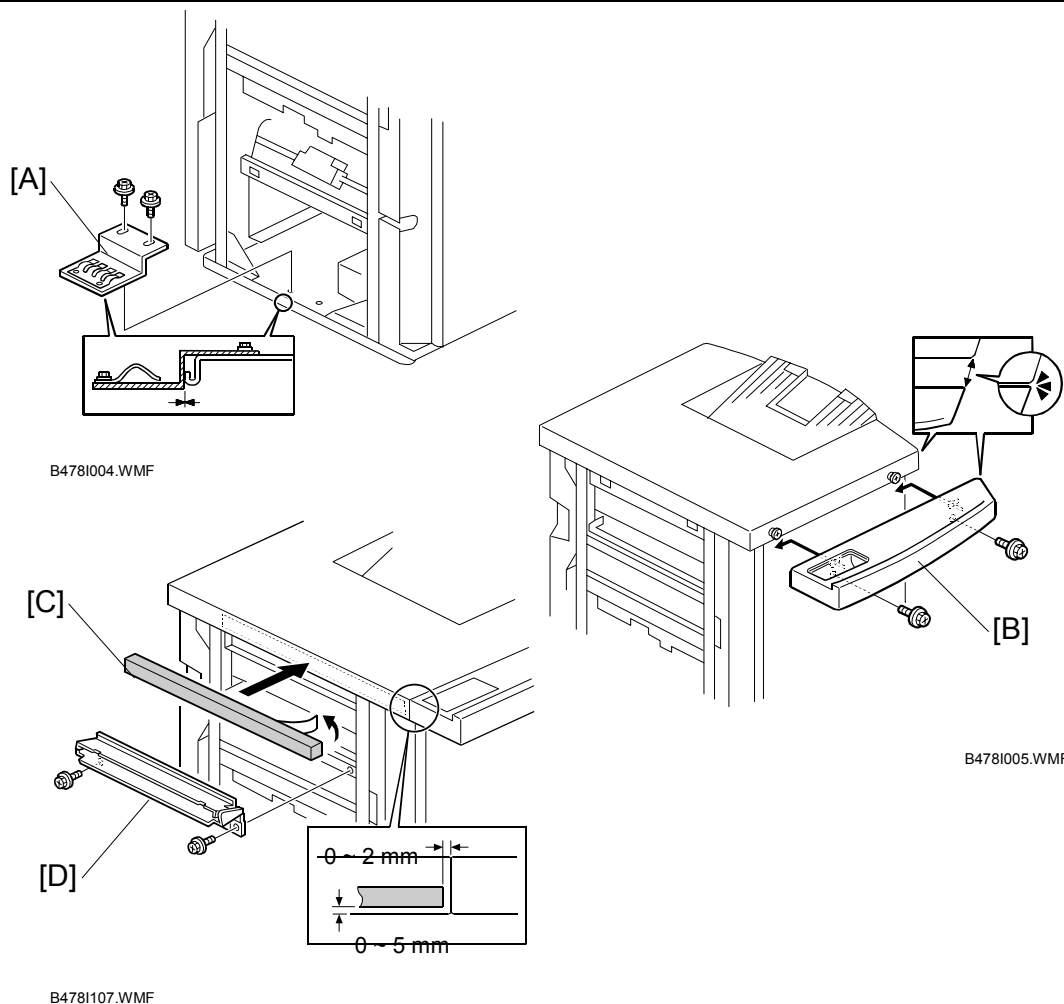

5. Install the grounding plate [A] (2 screws, M3 x 6).
NOTE: Set the grounding plate so that there is no gap between the grounding plate and the bottom frame of the finisher (as shown).
6. Install the table extension [B] as shown (2 screws, M4 x 8).
NOTE: The edge of the table extension should be aligned with the edge of the finisher (as shown).
7. Attach the cushion [C] to the right side of the upper cover.
NOTE: If you are installing the cover interposer tray, do not attach the cushion here. Attach it to the cover interposer tray. The cover interposer tray must be installed before you dock the finisher and tray with the main machine. For details, see the Cover Interposer Tray B470 installation instructions.
8. Install the entrance guide plate [D] (2 screws, M3 x 6).

Reissued: 8-Apr-05

Model: Martini-P1

Date: 2-Mar-05

No.: RG126002a

[C]

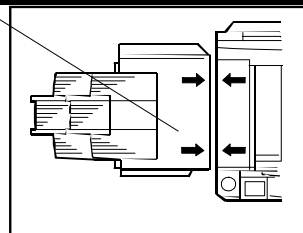

B478I534.WMF

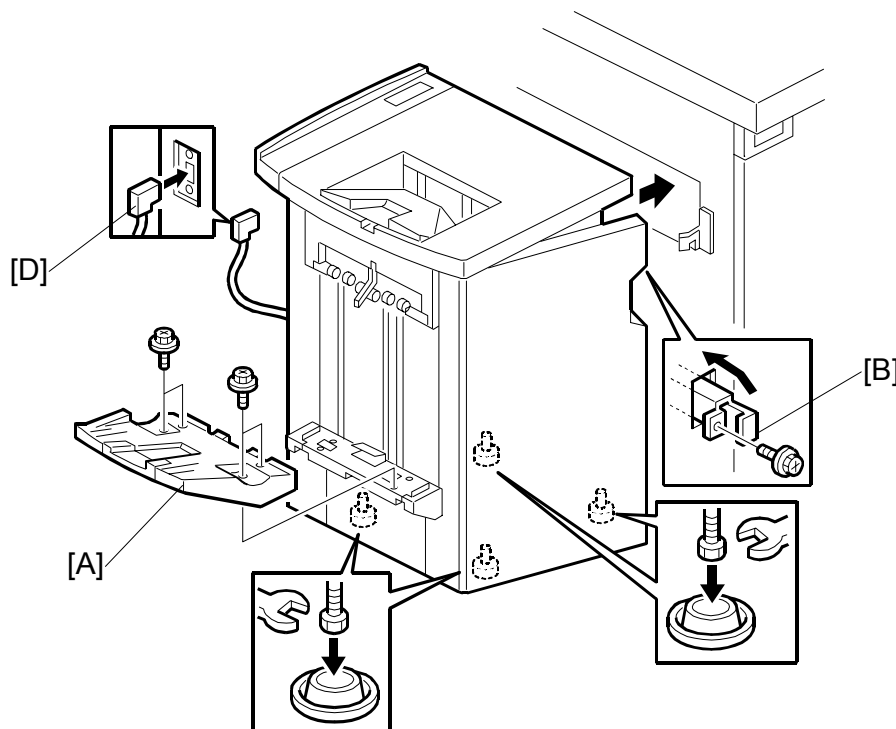

B478I006.WMF

9. Attach the shift tray [A] (4 screws, M3 x 8).
10. Open the front door of the finisher, and remove the screw from the locking lever, then pull out the locking lever [B].
11. Align the finisher on the joint brackets, and lock it in place by pushing in the locking lever [B].
NOTE: Before securing the locking lever, make sure that the top edges of the finisher and the copier are parallel from front to rear as shown [C].
12. Secure the locking lever [B] (1 screw) and close the front door.
13. Connect the finisher cable [D] to the copier.
14. Set the leveling shoes (x 4) under the feet and level the machine.

Reissued: 8-Apr-05

Model: Martini-P1

Date: 2-Mar-05

No.: RG126002a

When you move the finisher to a new location

Before you move the finisher, do SP6107-003. This moves the mechanisms to their home positions.

After you move the finisher, the mechanisms go back to the ready condition automatically, after you turn the power on.

Reissued: 8-Apr-05

Model: Martini-P1

Date: 2-Mar-05

No.: RG126002a

10. Punch Unit (B531/A812)

The Punch Unit B531/A812 is installed in the 3000-Sheet Finisher B706.

Accessory Check

Check the accessories and their quantities against this list:

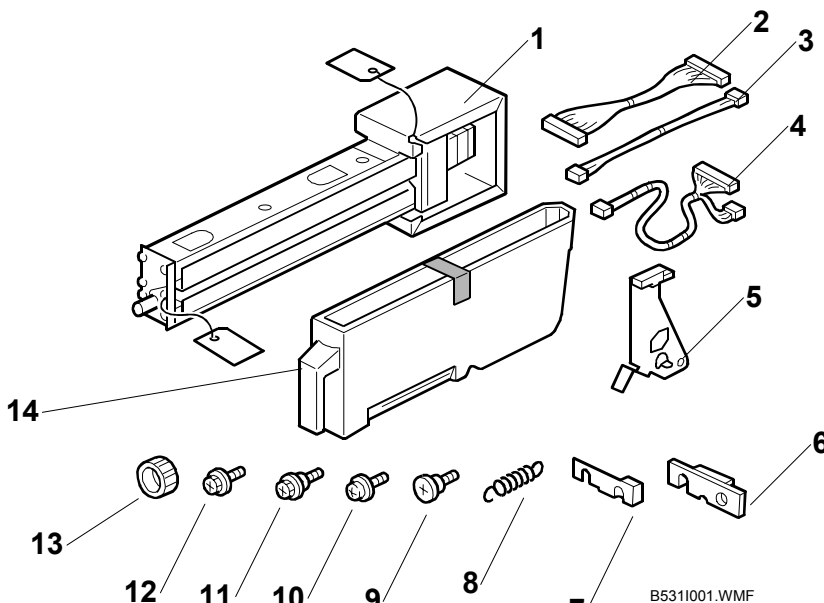

Description	Q'ty
1. Punch unit.....	1
2. Harness Connector Cable - PCB	1
3. Harness Connector Cable - HP Sensor 2.....	1
4. Harness Connector Cable - HP Sensor 1, Hopper Full.....	1
5. Sensor Arm and Sensor	1
6. Spacer (2 mm).....	1
7. Spacer (1 mm).....	2
8. Spring	1
9. Step Screw (large) (M4 x 11).....	1
10. Tapping Screw (M4 x 10).....	2
11. Step Screw (small) (M3 x 4)	1
12. Machine Screw, Washer (M4 x 6).....	1
13. Knob	1
14. Punch Waste Hopper.....	1

Reissued: 8-Apr-05

Model: Martini-P1	Date: 2-Mar-05	No.: RG126002a
-------------------	----------------	----------------

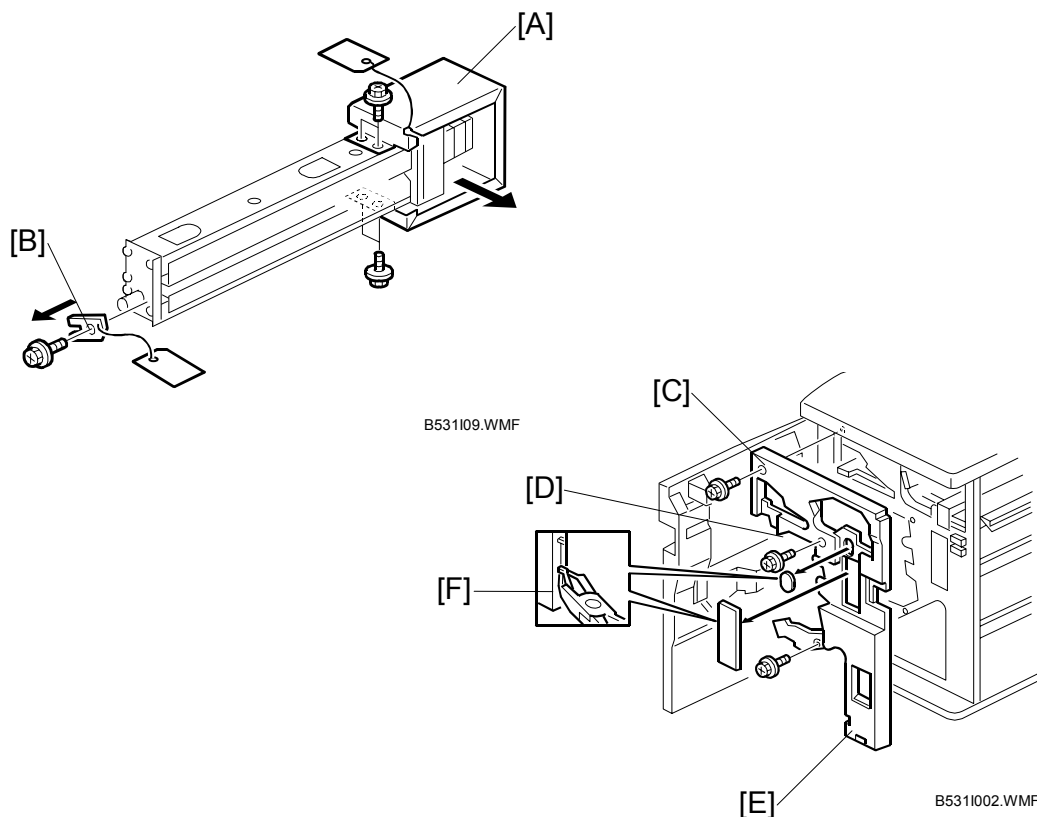

Installation Procedure

CAUTION

Switch the machine off and unplug the machine before starting the following procedure.

1. If the finisher is connected to the machine, disconnect it.
2. Open the front door and remove the rear cover (2 screws).
3. Unpack the punch unit and remove the motor protector plate [A] (🔩 x 4) and the cam lock plate [B] (1 screw).
4. Remove the inner cover [C] (3 screws).
5. Behind the inner cover at [D] and [E], press the lock tab to the right to release the inner cover from the frame.
6. Remove the plastic knockouts [F].

Reissued: 8-Apr-05

Model: Martini-P1

Date: 2-Mar-05

No.: RG126002a

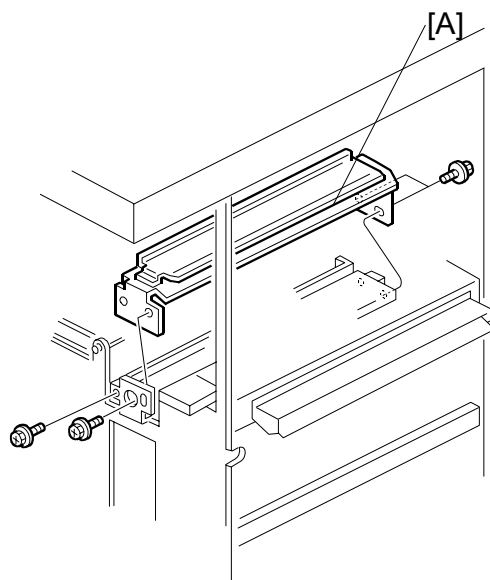

B531I003.WMF

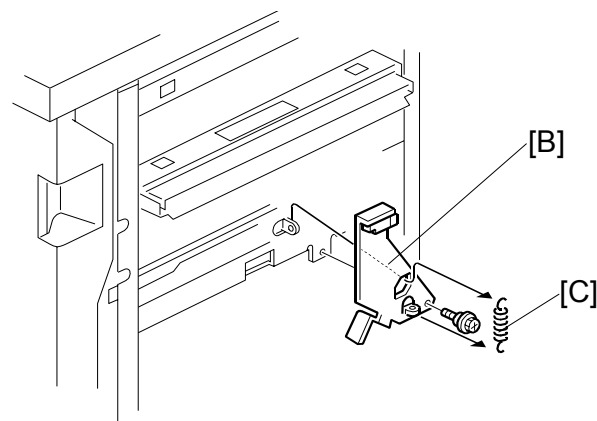

B531I004.WMF

7. Remove the paper guide [A] (4 screws).
8. Install the sensor arm [B] (1 screw, small step screw, M3 x 4).
NOTE: Make sure that the sensor arm swings freely on the step screw.
9. Attach the spring [C].

Reissued: 8-Apr-05

Model: Martini-P1

Date: 2-Mar-05

No.: RG126002a

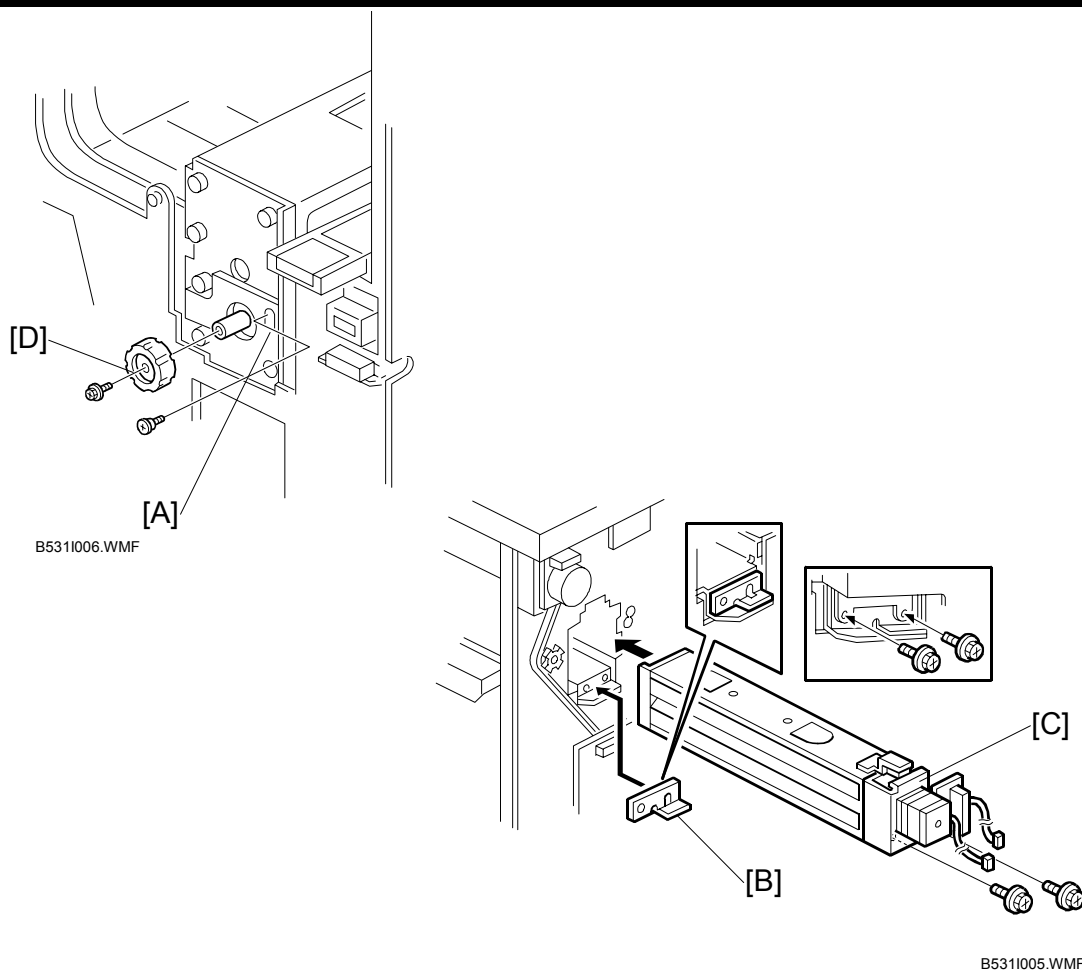

10. At the front, secure the punch unit [A] with the large step screw (1 screw, M4 x 10).

11. At the rear, position the 2 mm spacer [B] and attach the punch unit [C] (2 screws, M4 x 10).

NOTE: At the hole just above the lock lever, use one of the screws from the paper guide removed above to fasten the remaining two spacers to the frame. These extra spacers are used to adjust the horizontal position of the punch holes.

12. At the front, fasten the punch unit knob [D] (1 screw).

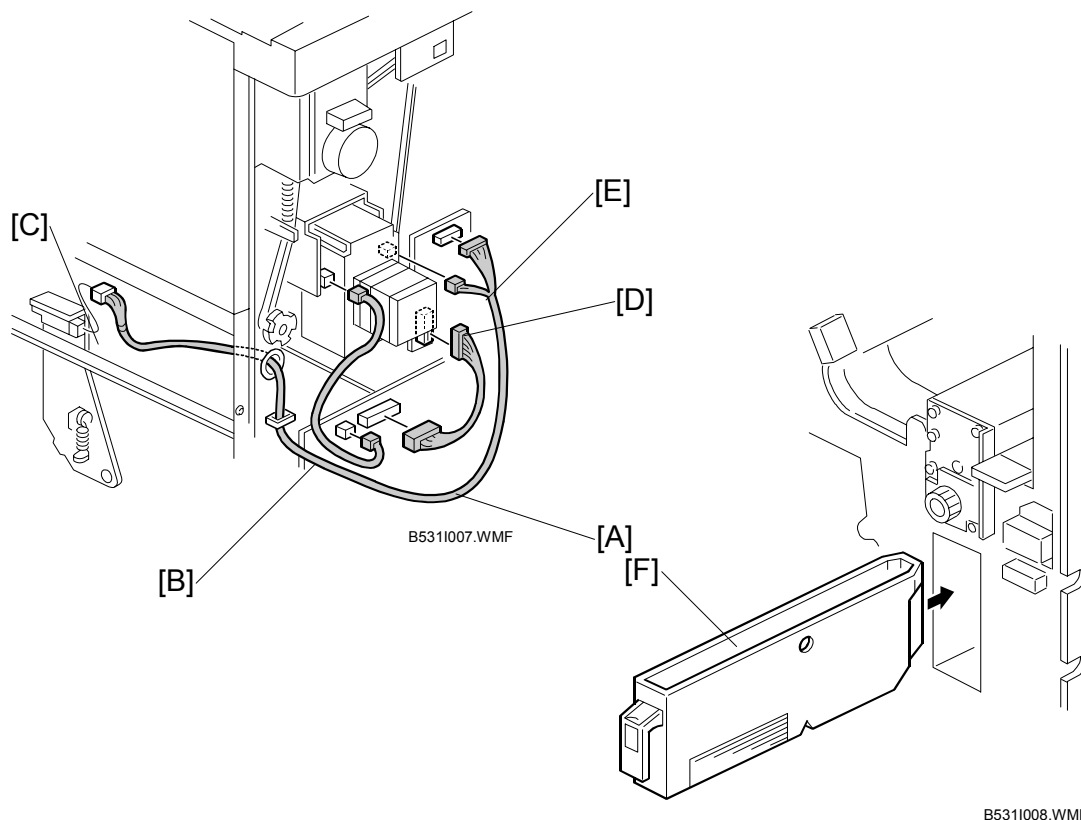
Reissued: 8-Apr-05
Model: Martini-P1
Date: 2-Mar-05
No.: RG126002a

13. Connect the PCB harness connector [A] to CN129 of the finisher PCB and to CN600 of the punch unit PCB.
14. Connect the HP Sensor 2 harness connector [B] to CN130 of the finisher PCB and to HP Sensor 2.
15. Connect the single end of the hopper full sensor connector cable [C] to the hopper full sensor on the arm (1 connector, 1 clamp), then connect the other two connectors to HP Sensor 1 [D] and CN620 [E] of the punch PCB.
NOTE: No special DIP switch settings are required for this punch unit. The punch unit sends an identification signal to the machine, so it knows what type of punch unit has been installed.
16. Slide the hopper [F] into the finisher.
17. Re-attach the inner cover and rear cover.
18. Close the front door and re-connect the finisher to the machine.

Reissued: 8-Apr-05

Model: Martini-P1	Date: 2-Mar-05	No.: RG126002a
-------------------	----------------	----------------

11. Jogger Unit (B513)

The Jogger Unit B531 is installed in the 3000-Sheet Finisher B706.

Accessory Check

Check the accessories and their quantities against this list:

Description	Q'ty
1. Jogger Unit B513.....	1
2. Tapping Screws - M3 x 6.....	2
3. Installation Procedure.....	1

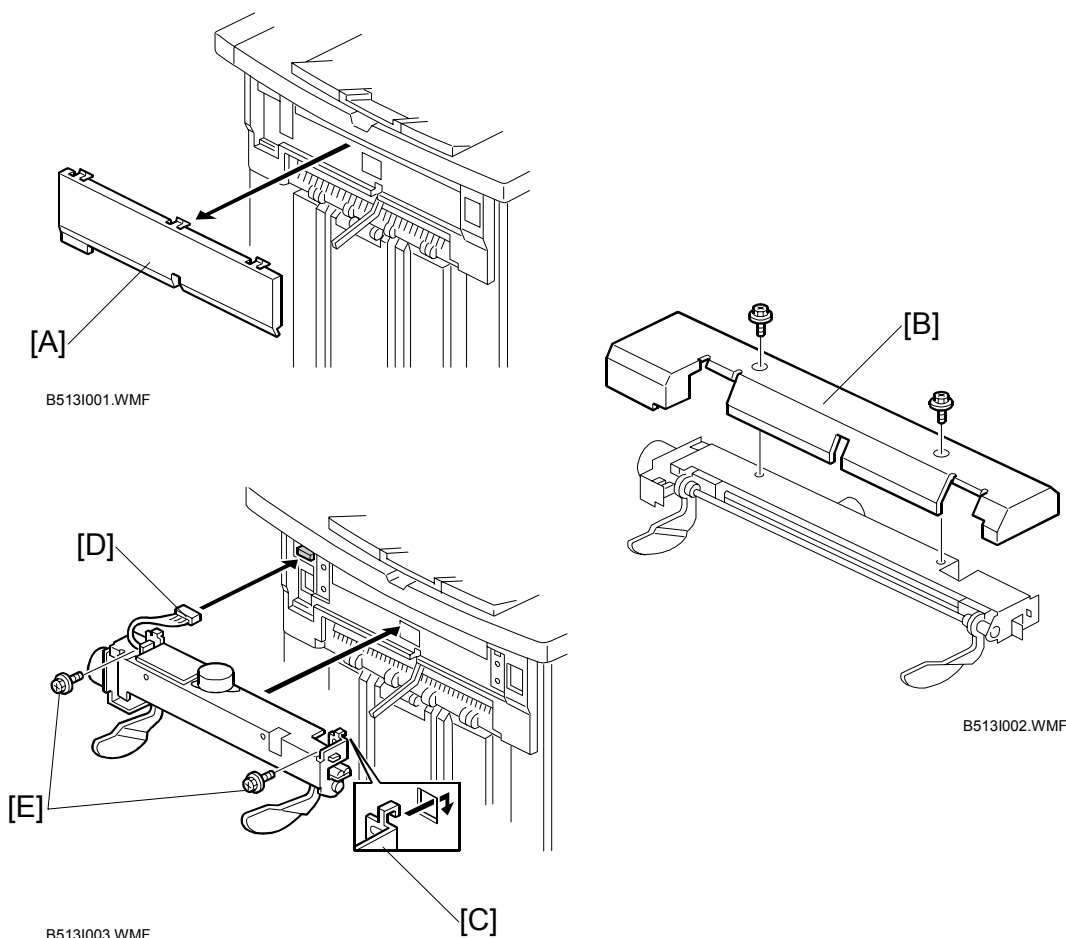

Installation Procedure

1. Turn the main machine switch off and disconnect the finisher from the main frame.
2. Use the flat head of a screwdriver to remove the left upper cover [A] from the finisher and discard it.
3. Remove the cover plate [B] from the jogger unit (2 screws). Save the screws.
4. With the jogger unit connector on the left side, hook the frame of the jogger unit [C] into the holes on the left and right side of the finisher frame.
5. On the left side, fasten the connector [D] to the socket (1 connector).
6. On the left and right side, attach the jogger unit frame to the side of the finisher with the screws [E] provided (2 screws).
7. Re-attach the jogger unit cover to its frame with the screws removed in step 2 (2 screws).

Reissued: 8-Apr-05

Model: Martini-P1	Date: 2-Mar-05	No.: RG126002a
-------------------	----------------	----------------

12. USB 2.0 interface Board (B596)

Accessory Check

Check the accessories and their quantities against this list:

Description	Q'ty
1. USB 2.0 Interface Board.....	1

Installation Procedure

You can only install one of these cards, because only one PCI slot (B4) is available for these options:

- USB 2.0
- IEEE 802.11b (Wireless LAN)

If a different card is installed in B4, you must remove it before you install USB 2.0 Interface Board.

1. Turn the machine off.
2. Remove the cover of Slot B4 (2 screws).
3. Install the USB 2.0 interface board [C] in Slot B4 and attach it with the screws.

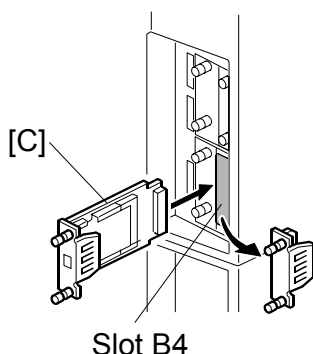

B5801108A.WMF

4. Print a configuration page to make sure that the machine can see the USB interface board.

Reissued: 8-Apr-05

Model: Martini-P1	Date: 2-Mar-05	No.: RG126002a
-------------------	----------------	----------------

13. IEEE 802.11b Interface Unit (G813)

Accessory Check

Check the accessories and their quantities against this list:

Description	Q'ty
1. IEEE 802.11b Interface Board	1
2. WLAN PIC Card	1
3. Antenna Cap	1

Installation Procedure

You can only install one of these cards, because only one PCI slot (B4) is available for these options:

1. Turn the machine off.
2. Remove the cover of Slot B4 (2 screws).
3. Remove the plastic cap [A] from the PCI card.
4. Connect the PCI card [B] to the wireless LAN board.
5. Install the wireless LAN board [C] in Slot B4 and attach it with the screws.

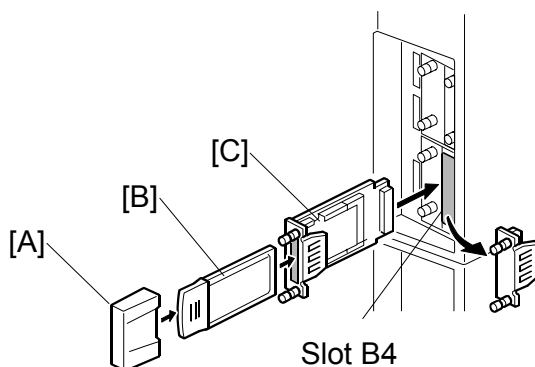

B5801108.WMF

6. Attach the antenna cap.
7. Turn the machine on and print a configuration page to make sure that the machine can see the installed IEEE 802.11b interface board.