

| | | | |
|--|--|--|--|
| Model: Stella-F1 | | Date: 13-Feb-02 | No.: MH555001 |
| Modified Article: Parts Catalog Correction | | Prepared by: A. Ishiyama | |
| From: Technical Services Dept., GTS Division | | | |
| Reason for Modification: | <input checked="" type="checkbox"/> Parts catalog correction <input type="checkbox"/> To facilitate assembly <input type="checkbox"/> Part standardization | <input type="checkbox"/> Vendor change <input type="checkbox"/> To improve reliability <input type="checkbox"/> Other () | <input type="checkbox"/> To meet standards () |
| Modification Schedule: | All new parts are available from the first mass production. | | |

Please make the following corrections to your Parts Catalogs.

| Incorrect part number | Correct part number | Description | Q'ty | Int | Page | Index | Note |
|-----------------------|---------------------|---|------|-----|------|-------|------|
| | H5558609 | Operating Instructions - Basic: Asia (Ricoh) | 0→1 | | 47 | 8 | |
| | H5558709 | Operating Instructions – Advanced: Asia (Ricoh) | 0→1 | | 47 | 8 | |
| | H5558629 | Operating Instructions – Basic: Asia (Ges) | 0→1 | | 47 | 8 | |
| | H5558729 | Operating Instructions – Advanced: Asia (Ges) | 0→1 | | 47 | 8 | |

| | | | |
|--|--|--------------------------|---------------|
| Model:S-F1 and S-F1.5 | | Date: 19-FEB-07 | No.: MH555021 |
| Modified Article: BY-PASS FEED COVER - EU | | Prepared by: T. Shintani | |
| From: 1st Tech. Support Sec. Service Support Dept. | | | |
| Reason for Modification: | <input checked="" type="checkbox"/> Parts catalog correction <input type="checkbox"/> Vendor change <input type="checkbox"/> Other <input type="checkbox"/> To facilitate assembly <input type="checkbox"/> To improve reliability <input type="checkbox"/> To meet standards (RoHs compliant) <input type="checkbox"/> Part standardization <input type="checkbox"/> Product Safety | | |

Please correct your Parts Catalogs as follows:

| New part number | Description | Q'ty | Page | Index | Note |
|-----------------|-------------------------|------|------|-------|------|
| H5554162 | BY-PASS FEED COVER - EU | 1 | 6 | 19 | |

3.BY-PASS FEED UNIT (H555)

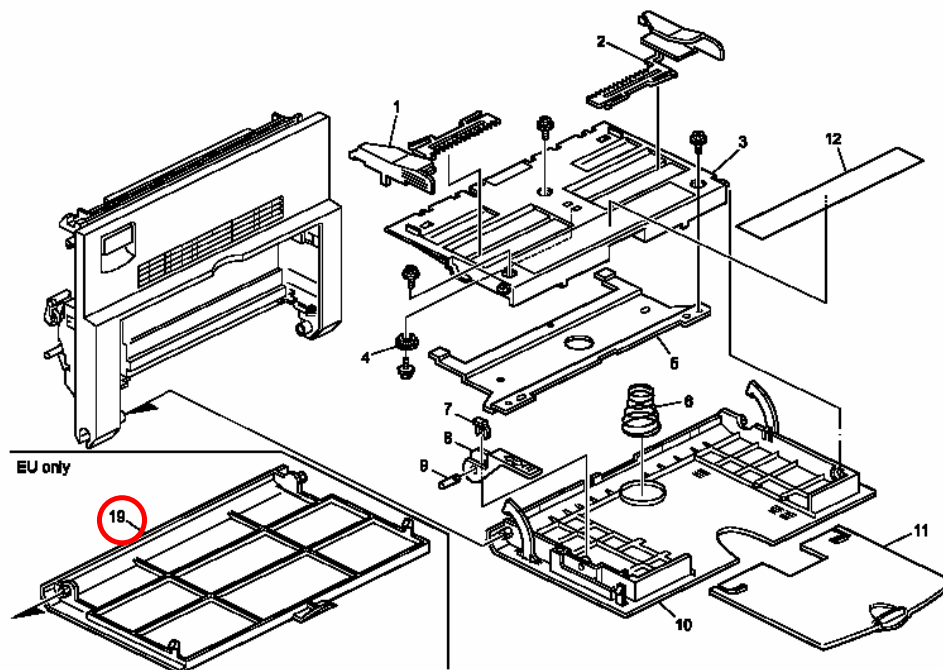

| | | | |
|--|--|--|---|
| Model: Model S-F1 | | Date: 6-Aug-02 | No.: MH555002 |
| Modified Article: Parts standardization with the new model | | Prepared by: A. Ishiyama | |
| From: Technical Services sec. Service Planning Dept. | | | |
| Reason for Modification: | <input type="checkbox"/> Parts catalog correction <input type="checkbox"/> To facilitate assembly <input checked="" type="checkbox"/> Part standardization | <input type="checkbox"/> Vendor change <input type="checkbox"/> To improve reliability <input type="checkbox"/> Other () | <input type="checkbox"/> To meet standards () |
| Modification Schedule: | When old parts are out of stock. | | |

The following parts have been changed and are compatible with the next model.

| Old part number | New part number | Description | Q'ty | Int | Page | Index | Note |
|-----------------|-----------------|---------------------|------|-----|------|-------|------|
| B0444105D | B0444104 | Pressure Frame | 1 | O/O | 25 | 36 | |
| B0444185E | B0444186 | Guide Plate | 1 | O/O | 25 | 4 | |
| B0444615E | B0444655 | Right Door | 1 | O/O | 11 | 22 | |
| B0444652B | B0444662 | Reverse Guide Plate | 1 | O/O | 11 | 18 | |
| H5553104C | H5553113 | Stud - Fusing | 1 | O/O | 9 | 2 | |

| | | | |
|--|---|---|---|
| Model: Stella-F1 | | Date: 25-Oct-02 | No.: MH555003 |
| Modified Article: Guide Plate Stopper | | Prepared by: M. Ishihara | |
| From: Technical Services sec. Service Planning Dept. | | | |
| Reason for Modification: | <input type="checkbox"/> Parts catalog correction <input type="checkbox"/> To facilitate assembly <input type="checkbox"/> Part standardization | <input type="checkbox"/> Vendor change <input checked="" type="checkbox"/> To improve reliability <input type="checkbox"/> Other () | <input type="checkbox"/> To meet standards () |
| Modification Schedule: | See below. | | |

| Old part number | New part number | Description | Q'ty | Int | Page | Index | Note |
|-----------------|-----------------|---------------------|------|-----|------|-------|------|
| - | B0442656 | Guide Plate Stopper | 0-1 | | 9 | | New |

A Stopper has been added to the Guide Plate shaft to ensure the Guide Plate pivot point does not come out of place, which can occur when paper jammed in the transport section is removed from the paper tray side with the right door closed (normally, paper jammed here should be removed after opening the right door).

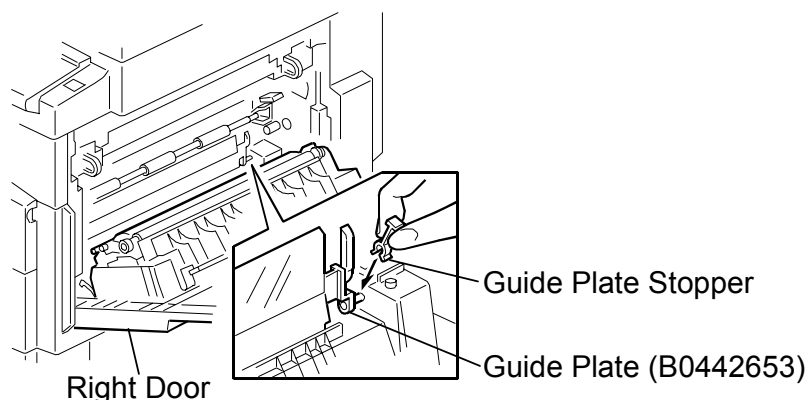

Machine cut-in serial number:

H555-17: A35291xxxxx-
 H555-22: A3529100701-
 H555-23: A35291xxxxx-
 H555-24: AL1152870001-
 H555-26: 4N78720001-
 H555-27: A3529100699-
 H555-29: A3529100801-

| | | | |
|--|--|--|---|
| Model: Stella-F1 | | Date: 10-Dec-02 | No.: MH555004 |
| Modified Article: Parts Catalog Correction | | Prepared by: A. Ishiyama | |
| From: Technical Services sec. Service Planning Dept. | | | |
| Reason for Modification: | <input checked="" type="checkbox"/> Parts catalog correction <input type="checkbox"/> To facilitate assembly <input type="checkbox"/> Part standardization | <input type="checkbox"/> Vendor change <input type="checkbox"/> To improve reliability <input type="checkbox"/> Other () | <input type="checkbox"/> To meet standards () |
| Modification Schedule: | All new parts are available from the first mass production. | | |

The following cover has been added to protect the IC Card slot.

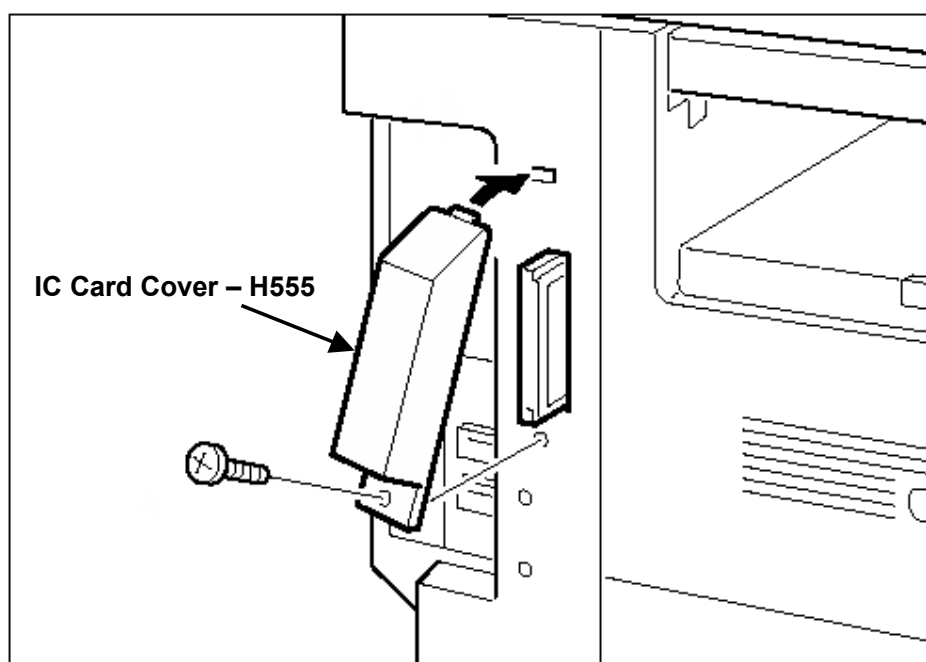
| Incorrect part number | Correct part number | Description | Q'ty | Int | Page | Index | Note |
|-----------------------|---------------------|----------------------|------|-----|------|-------|------|
| | H5554250A | IC Card Cover – H555 | 0→1 | | 3 | 25 | |



| | | | |
|--|---|---|---|
| Model: Stella-F1 | | Date: 9-Dec-03 | No.: MH555005 |
| Modified Article: Stripper Pawls | | Prepared by: M. Ishihara | |
| From: 1st Tech. Support Sec. Service Support Dept. | | | |
| Reason for Modification: | <input type="checkbox"/> Parts catalog correction <input type="checkbox"/> To facilitate assembly <input type="checkbox"/> Part standardization | <input type="checkbox"/> Vendor change <input checked="" type="checkbox"/> To improve reliability <input type="checkbox"/> Other () | <input type="checkbox"/> To meet standards () |
| Modification Schedule: | From the October 2002 mass-production machines onward. | | |

The fulcrum of the Stripper Pawls has been changed as shown below to eliminate squeaking noises coming from the pawls. In addition, pawl holders have been added for attachment to the pawls before installation in the fusing frame (frame remains unchanged).

| Old part number | New part number | Description | Q'ty | Int | Page | Index | Note |
|-----------------|-----------------|-----------------------|-------|------|------|-------|------|
| AE044036 | AE044045 | Stripper Pawl | 3 – 3 | X/O* | 25 | 21 | |
| AF022141 | | Turn Roller | 3 – 2 | | 25 | 6 | |
| B0444151 | B0444155 | Spring – Pickoff Pawl | 3 – 3 | X/O* | 25 | 20 | |
| | B0444179 | Holder – Pickoff Pawl | 0 – 3 | | 25 | New | |
| B0444144 | B0444143 | Electrode Plate Cover | 1 – 1 | X/O* | 25 | 15 | |

X/O*: **Interchangeability is X/O as a set.** In addition, whenever replacing the old with the new, be sure to install **all four** new parts above as a set.

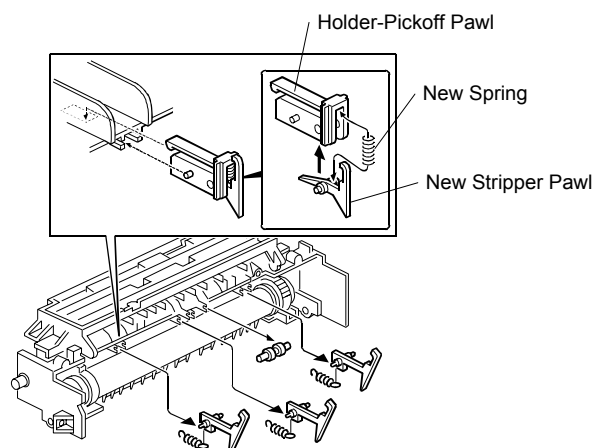
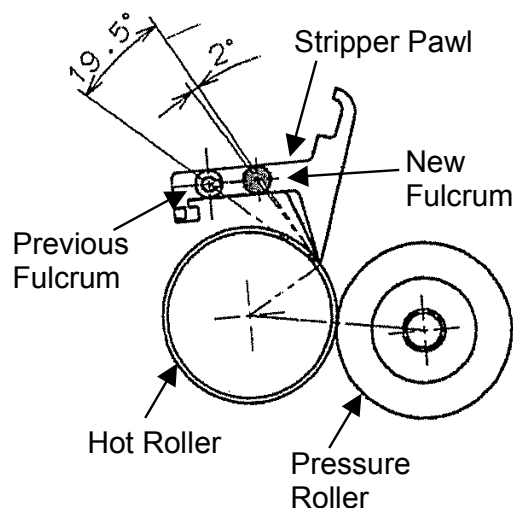
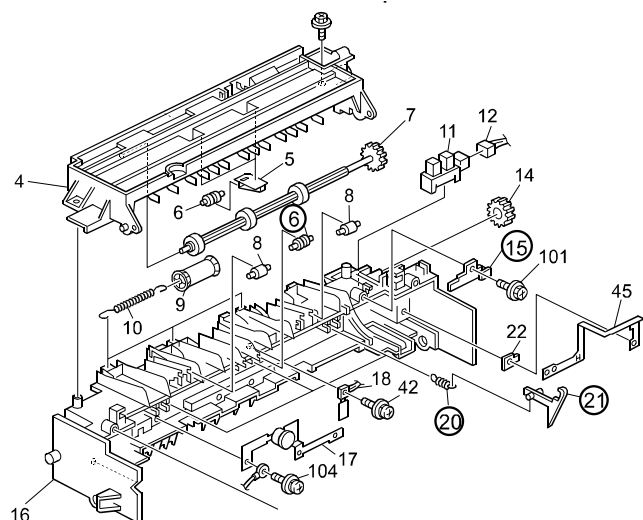

| | | | |
|--|---|---|--|
| Model: Stella-F1 | | Date: 31-Mar-04 | No.: MH555006 |
| Modified Article: Fusing Unit | | Prepared by: M. Ishihara | |
| From: 1st Tech. Support Sec. Service Support Dept. | | | |
| Reason for Modification: | <input type="checkbox"/> Parts catalog correction <input type="checkbox"/> To facilitate assembly <input type="checkbox"/> Part standardization | <input type="checkbox"/> Vendor change <input type="checkbox"/> To improve reliability <input checked="" type="checkbox"/> Other (To Facilitate servicing in the field) | <input type="checkbox"/> To meet standards () |
| Modification Schedule: | | | |

The fusing unit has been registered as a service part to facilitate servicing in the field.

| Old part number | New part number | Description | Q'ty | Int | Page | Index | Note |
|-----------------|-----------------|--------------------|------|-----|------|-------|------|
| - | B0444017 | Fusing Unit – 120V | 1 | - | 35 | * | |
| - | B0444027 | Fusing Unit – 230V | 1 | - | 35 | * | |



| | | | |
|--|--|---|---|
| Model: Stella-F1 | | Date: 25-Aug-04 | No.: MH555007 |
| Modified Article: Connector-OR/P17-14S-B | | Prepared by: M. Ishihara | |
| From: 1st Tech. Support Sec. Service Support Dept. | | | |
| Reason for Modification: | <input checked="" type="checkbox"/> Parts catalog correction <input type="checkbox"/> To facilitate assembly <input type="checkbox"/> Part standardization | <input type="checkbox"/> Vendor change <input type="checkbox"/> To improve reliability <input type="checkbox"/> Other () | <input type="checkbox"/> To meet standards () |
| Modification Schedule: | | | |

Please correct the parts catalog as follows.

| Part number | Description | Q'ty | Int | Page | Index | Note |
|-------------|------------------------------|------|-----|------|-------|------|
| B0445223 | Harness – Paper Feed Table | 1 | | 29 | 15 | |
| 11028534 | Connector – OR/P17 – 14S - B | 1 | | 29 | 105 | |

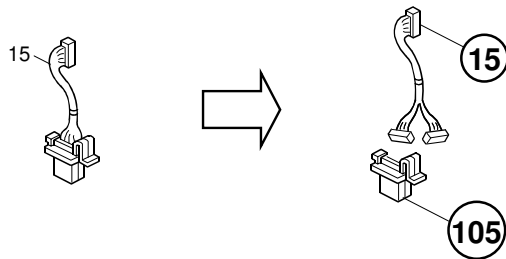

| | | | |
|--|---|---|--|
| Model: Model S-F1 Taiwan Model only | | Date: 20-Oct-04 | No.: MH555008 |
| Modified Article: Power Supply Cord – Taiwan | | Prepared by: A. Ishiyama | |
| From: 1st Tech. Support Sec. Service Support Dept. | | | |
| Reason for Modification: | <input type="checkbox"/> Parts catalog correction <input type="checkbox"/> To facilitate assembly <input type="checkbox"/> Part standardization | <input type="checkbox"/> Vendor change <input checked="" type="checkbox"/> To improve reliability <input type="checkbox"/> Other (To Facilitate servicing in the field) | <input type="checkbox"/> To meet standards () |
| Modification Schedule: | From November '04 production | | |

This bulletin is for the following models only:

- Model S-F1/S-F2 Taiwan models (H555/H556-19)

| Old part number | New part number | Description | Q'ty | Int | Page | Index | Note |
|-----------------|-----------------|----------------------------|------|-----|------|-------|------|
| H5555014 | H5555002 | Power Supply Cord : Taiwan | 1→1 | X/O | 29 | 13 | 1 |

Note:

1. For Taiwan models

Change: Changed the wiring of the power supply cord.

Reason: The hot and neutral wires were reversed.

NOTE: This will not cause any kind of safety issue (see RTB #RH555009 for details).

| | | | |
|--|--|--|---|
| Model: Model S-F1 | | Date: 16-Dec-04 | No.: MH555009 |
| Modified Article: Polygon Scanner Motor | | Prepared by: M. Ishihara | |
| From: 1st Tech. Support Sec. Service Support Dept. | | | |
| Reason for Modification: | <input type="checkbox"/> Parts catalog correction <input type="checkbox"/> To facilitate assembly <input checked="" type="checkbox"/> Part standardization | <input type="checkbox"/> Vendor change <input type="checkbox"/> To improve reliability <input type="checkbox"/> Other () | <input type="checkbox"/> To meet standards () |
| Modification Schedule: | | | |

Change/Reason: Parts standardization with the Stella-C2.

Note:

- 1) The thickness of the new rotation disc is 2mm (old: 3mm).
- 2) The new motor makes less noise than the old motor.
- 3) This parts standardization change was also made on the Stella-C1/F2.

| Old part number | New part number | Description | Q'ty | Int | Page | Index | Note |
|-----------------|-----------------|-----------------------|------|-----|------|-------|------|
| AX060227 | AX060284 | Polygon Scanner Motor | 1-1 | O/O | 21 | 5 | |

| | | | |
|--|--|--|---|
| Model: Model S-F1 Taiwan Model only | | Date: 17-Dec-04 | No.: MH555010 |
| Modified Article: Operation Panel – Taiwan | | Prepared by: A. Ishiyama | |
| From: 1st Tech. Support Sec. Service Support Dept. | | | |
| Reason for Modification: | <input type="checkbox"/> Parts catalog correction <input type="checkbox"/> To facilitate assembly <input checked="" type="checkbox"/> Part standardization | <input type="checkbox"/> Vendor change <input type="checkbox"/> To improve reliability <input type="checkbox"/> Other () | <input type="checkbox"/> To meet standards () |
| Modification Schedule: | After the old parts have become out of stock. | | |

Note: This bulletin is for the following models only:

Model S-F1 Taiwan model (H555-19)

| Old part number | New part number | Description | Q'ty | Int | Page | Index | Note |
|-----------------|-----------------|-----------------|------|-----|------|-------|------|
| H5553647 | H5553694 | Keytop – 10 key | 1→1 | O/O | 5 | 10 | 1 |

***Note:** For the Taiwan model only.

Change: The color of the ten-key pad.

Reason: Parts standardization with the next model (Model S-F1.5).

| | | | |
|--|--|--|---|
| Model: Model S-F1 | | Date: 17-Dec-04 | No.: MH555011 |
| Modified Article: Front Door | | Prepared by: A. Ishiyama | |
| From: 1st Tech. Support Sec. Service Support Dept. | | | |
| Reason for Modification: | <input type="checkbox"/> Parts catalog correction <input type="checkbox"/> To facilitate assembly <input checked="" type="checkbox"/> Part standardization | <input type="checkbox"/> Vendor change <input type="checkbox"/> To improve reliability <input type="checkbox"/> Other () | <input type="checkbox"/> To meet standards () |
| Modification Schedule: | After the old parts have become out of stock. | | |

Note: This bulletin is for the following models only.

Model S-F1/S-F2/S-F2L (H555-1x, 2x/H556-1x, 2x/H557-1x, 2x)

| Old part number | New part number | Description | Q'ty | Int | Page | Index | Note |
|-----------------|-----------------|-------------|------|-----|------|-------|------|
| H5554152 | H5554180 | Front Door | 1→1 | O/O | 3 | 5 | |

Change: A different tool is used to make the part.

Reason: Parts standardization with the next model (Model S-F1.5/S-F2.5/F2.5L).

Reissued: 28-Dec-04

| | | |
|------------------------|-----------------|----------------|
| Model: Model S-F1/F1.5 | Date: 17-Dec-04 | No.: MH555012a |
|------------------------|-----------------|----------------|

MB Correction

The items in bold italics have been corrected or added.

| | | | |
|--|--|---|--|
| Modified Article: ADF Base | | Prepared by: A. Ishiyama | |
| From: 1st Tech. Support Sec. Service Support Dept. | | | |
| Reason for Modification: | <input checked="" type="checkbox"/> Parts catalog correction <input type="checkbox"/> To facilitate assembly <input type="checkbox"/> Part standardization | <input type="checkbox"/> Vendor change <input type="checkbox"/> To improve reliability <input type="checkbox"/> Other () | <input type="checkbox"/> To meet standards () |
| Modification Schedule: | | | |

Note: This bulletin is for the following models only.

Model S-F1/F1.5, S-C1, S-C2 (H555, B049, B129, B130, B168, B444, B696)

| Old part number | New part number | Description | Q'ty | Int | Page | Index | Note |
|-----------------|-----------------|-------------|------|-----|------|-------|------|
| | B0444891 | Base | 0→1 | -/- | 19 | 33 | |

Change: This part was added.

Reason: It was missing from the Parts Catalog.

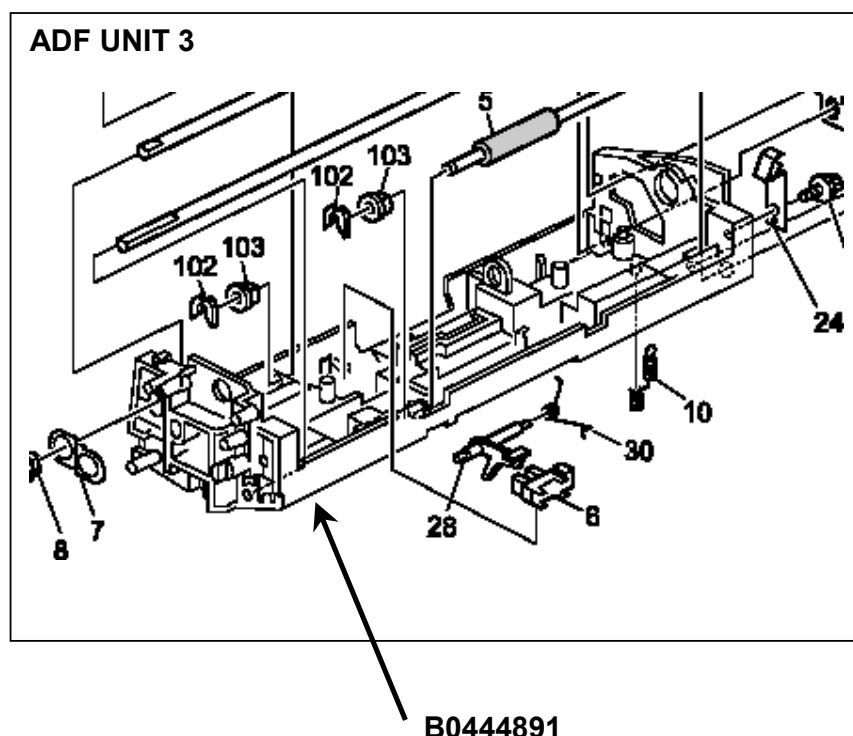

| | | | |
|--|--|--------------------------|---------------|
| Model: Model S-F1.5 | | Date: 12-Apr-06 | No.: MH555013 |
| Modified Article: Parts Catalog Correction | | Prepared by: T. Shintani | |
| From: 1st Tech. Support Sec. Service Support Dept. | | | |
| Reason for Modification: | <input checked="" type="checkbox"/> Parts catalog correction <input type="checkbox"/> Vendor change <input type="checkbox"/> Other <input type="checkbox"/> To facilitate assembly <input type="checkbox"/> To improve reliability <input type="checkbox"/> To meet standards <input type="checkbox"/> Part standardization <input type="checkbox"/> Product Safety () | | |

| OLD Part Number | NEW Part Number | Description | Q'ty | Int | Page | Index | Note |
|-----------------|-----------------|-----------------------------------|------|-------|------|-------|------|
| B0445790 | AZ320162 | POWER PACK:BCT:CL | 1 | ○ / ○ | 29 | 2 | - |
| H5555000 | AZ230205 | POWER SUPPLY UNIT:S-F1.5/2.5:200V | 1 | ○ / ○ | 29 | 17 | - |
| H5565000 | | | 1 | ○ / ○ | 29 | 17 | |
| H5565049 | AZ230204 | POWER SUPPLY UNIT:S-F1.5/2.5:100V | 1 | ○ / ○ | 29 | 17 | - |

Change: The materials used for these parts were changed.

Reason: To conform to the requirements of the RoHS Directive.

| | | | |
|--|--|-----------------------|---------------|
| Model: S-F1 | | Date: 04-Aug-06 | No.: MH555014 |
| Modified Article: Laser Unit Ass'y | | Prepared by: Y.Murata | |
| From: 1st Tech. Support Sec. Service Support Dept. | | | |
| Reason for Modification: | <input type="checkbox"/> Parts catalog correction <input type="checkbox"/> Vendor change <input type="checkbox"/> Other <input type="checkbox"/> To facilitate assembly <input type="checkbox"/> To improve reliability <input checked="" type="checkbox"/> To meet standards (RoHs compliant) <input type="checkbox"/> Part standardization <input type="checkbox"/> Product Safety | | |

| Old part number | New part number | Description | Q'ty | Int | Page | Index | Note |
|-----------------|-----------------|------------------|------|-----|------|-------|------|
| B0441901 | B0441902 | Laser Unit Ass'y | 1 | O/O | 21 | * | |

Change: The materials for these parts were changed.

Reason: To comply with the RoHS Directive.

| | | | |
|--|--|-----------------------|---------------|
| Model: S-F1 | | Date: 7-Aug-06 | No.: MH555015 |
| Modified Article: Transfer Roller | | Prepared by: Y.Murata | |
| From: 1st Tech. Support Sec. Service Support Dept. | | | |
| Reason for Modification: | <input type="checkbox"/> Parts catalog correction <input type="checkbox"/> Vendor change <input type="checkbox"/> Other <input type="checkbox"/> To facilitate assembly <input type="checkbox"/> To improve reliability <input checked="" type="checkbox"/> To meet standards (RoHS compliant) <input type="checkbox"/> Part standardization <input type="checkbox"/> Product Safety | | |

| Old part number | New part number | Description | Q'ty | Int | Page | Index | Note |
|-----------------|-----------------|-----------------|------|-----|------|-------|------|
| B0443802 | B2623802 | Transfer Roller | 1 | O/O | 11 | 8 | |

Change: The materials for these parts were changed.

Reason: To comply with the RoHS Directive.

Reissued:21-Aug-06

| | | |
|---------------------------------|----------------|----------------|
| Model: S-F1(only for 230V area) | Date: 7-Aug-06 | No.: MH555016a |
|---------------------------------|----------------|----------------|

MB Reissue

The items in bold italics have been corrected or added.

| | | | |
|--|---|---|--|
| Modified Article: Fusing Unit – 230V | | Prepared by: Y.Murata | |
| From: 1st Tech. Support Sec. Service Support Dept. | | | |
| Reason for Modification: | <input type="checkbox"/> Parts catalog correction | <input type="checkbox"/> Vendor change | <input type="checkbox"/> Other |
| | <input type="checkbox"/> To facilitate assembly | <input type="checkbox"/> To improve reliability | <input checked="" type="checkbox"/> To meet standards (RoHS compliant) |
| | <input type="checkbox"/> Part standardization | <input type="checkbox"/> Product Safety | |

| Old part number | New part number | Description | Q'ty | Int | Page | Index | Note |
|-----------------|-----------------|--------------------|------|-----|-----------|-------|------|
| B0444027 | B0444028 | Fusing Unit – 230V | 1 | O/O | 25 | * | |

Change: The materials for these parts were changed.

Reason: To comply with the RoHS Directive.

Reissued:21-Aug-06

| | | |
|-------------|----------------|----------------|
| Model: S-F1 | Date: 7-Aug-06 | No.: MH555017a |
|-------------|----------------|----------------|

MB Reissue

The items in bold italics have been corrected or added.

| | | | |
|---|---|---|--|
| Modified Article: <i>Guide Plate:Reverse:Ass'y</i> | | Prepared by: Y.Murata | |
| From: 1st Tech. Support Sec. Service Support Dept. | | | |
| Reason for Modification: | <input type="checkbox"/> Parts catalog correction | <input type="checkbox"/> Vendor change | <input type="checkbox"/> Other |
| | <input type="checkbox"/> To facilitate assembly | <input type="checkbox"/> To improve reliability | <input checked="" type="checkbox"/> To meet standards (RoHS compliant) |
| | <input type="checkbox"/> Part standardization | <input type="checkbox"/> Product Safety | |

| Old part number | New part number | Description | Q'ty | Int | Page | Index | Note |
|-----------------|-----------------|---------------------------|------|-----|------|-------|------|
| B0444651 | B0444653 | Guide Plate:Reverse:Ass'y | 1 | O/O | 11 | 26 | |

Change: The materials for these parts were changed.

Reason: To comply with the RoHS Directive.

| | | | |
|--|--|-----------------------|---------------|
| Model: S-F1 | | Date: 7-Aug-06 | No.: MH555018 |
| Modified Article: Contact Image Sensor:F1:Ass'y | | Prepared by: Y.Murata | |
| From: 1st Tech. Support Sec. Service Support Dept. | | | |
| Reason for Modification: | <input type="checkbox"/> Parts catalog correction <input type="checkbox"/> Vendor change <input type="checkbox"/> Other <input type="checkbox"/> To facilitate assembly <input type="checkbox"/> To improve reliability <input checked="" type="checkbox"/> To meet standards (RoHs compliant) <input type="checkbox"/> Part standardization <input type="checkbox"/> Product Safety | | |

| Old part number | New part number | Description | Q'ty | Int | Page | Index | Note |
|-----------------|-----------------|-------------------------------|------|-----|------|-------|------|
| H5551030 | H5551031 | Contact Image Sensor:F1:Ass'y | 1 | O/O | 15 | 16 | |

Change: The materials for these parts were changed.

Reason: To comply with the RoHS Directive.

| | | | |
|--|--|-----------------------|---------------|
| Model:S-F1 and S-F1.5 | | Date: 22-Sep-06 | No.: MH555019 |
| Modified Article: PCB | | Prepared by: Y.Murata | |
| From: 1st Tech. Support Sec. Service Support Dept. | | | |
| Reason for Modification: | <input type="checkbox"/> Parts catalog correction <input type="checkbox"/> Vendor change <input type="checkbox"/> Other <input type="checkbox"/> To facilitate assembly <input type="checkbox"/> To improve reliability <input checked="" type="checkbox"/> To meet standards (RoHs compliant) <input type="checkbox"/> Part standardization <input type="checkbox"/> Product Safety | | |

For S-F1 and F1.5

| Old part number | New part number | Description | Q'ty | Int | Page | Index | Note |
|-----------------|-----------------|------------------------------|------|-----|------|-------|------|
| H5556030 | H5556032 | PCB:Operation Sub-Unit:Ass'y | 1 | X/O | 5 | 14 | |

For only S-F1.5

| Old part number | New part number | Description | Q'ty | Int | Page | Index | Note |
|-----------------|-----------------|----------------------------------|------|-----|------|-------|----------|
| H5553639 | H5553696 | Operation Sub-Unit:H555-67:Ass'y | 1 | X/O | 5 | * | 1 |
| H5553638 | H5553695 | Operation Sub-Unit:H555-57:Ass'y | 1 | X/O | 5 | * | 2 |

Change: Material of this part has changed.

Reason: To comply with RoHs.

Note1: This change applies to H555-57, H555-69.

Note2: This change applies to H555-62, H555-64, H555-66, H555-67.

| | | | |
|--|--|-----------------------|---------------|
| Model:S-F1 and S-F1.5 | | Date: 29-Sep-06 | No.: MH555020 |
| Modified Article: Speaker:Ass'y | | Prepared by: Y.Murata | |
| From: 1st Tech. Support Sec. Service Support Dept. | | | |
| Reason for Modification: | <input type="checkbox"/> Parts catalog correction <input type="checkbox"/> Vendor change <input type="checkbox"/> Other <input type="checkbox"/> To facilitate assembly <input type="checkbox"/> To improve reliability <input checked="" type="checkbox"/> To meet standards (RoHs compliant) <input type="checkbox"/> Part standardization <input type="checkbox"/> Product Safety | | |

| Old part number | New part number | Description | Q'ty | Int | Page | Index | Note |
|-----------------|-----------------|---------------|------|-----|------|-------|------|
| H5555055 | H5555058 | Speaker:Ass'y | 1 | X/O | 3 | 3 | |

Change: The material for this part has changed.

Reason: To comply with the RoHs Directive.

| | | | |
|--|--|--------------------------|---------------|
| Model:S-F1 and S-F1.6 | | Date: 15-Jun-07 | No.: MH555022 |
| Modified Article: FRAME DRIVE | | Prepared by: T. Shintani | |
| From: 1st Tech. Support Sec. Service Support Dept. | | | |
| Reason for Modification: | <input checked="" type="checkbox"/> Parts catalog correction <input type="checkbox"/> Vendor change <input type="checkbox"/> Other <input type="checkbox"/> To facilitate assembly <input type="checkbox"/> To improve reliability <input type="checkbox"/> To meet standards (RoHs compliant) <input type="checkbox"/> Part standardization <input type="checkbox"/> Product Safety | | |

Please correct your Parts Catalogs as follows:

| New part number | Description | Q'ty | Page | Index | Note |
|-----------------|---------------|------|------|-------|------|
| B0441177 | FRAME - DRIVE | 1 | 27 | 24 | |

13.DRIVE SECTION (H555)

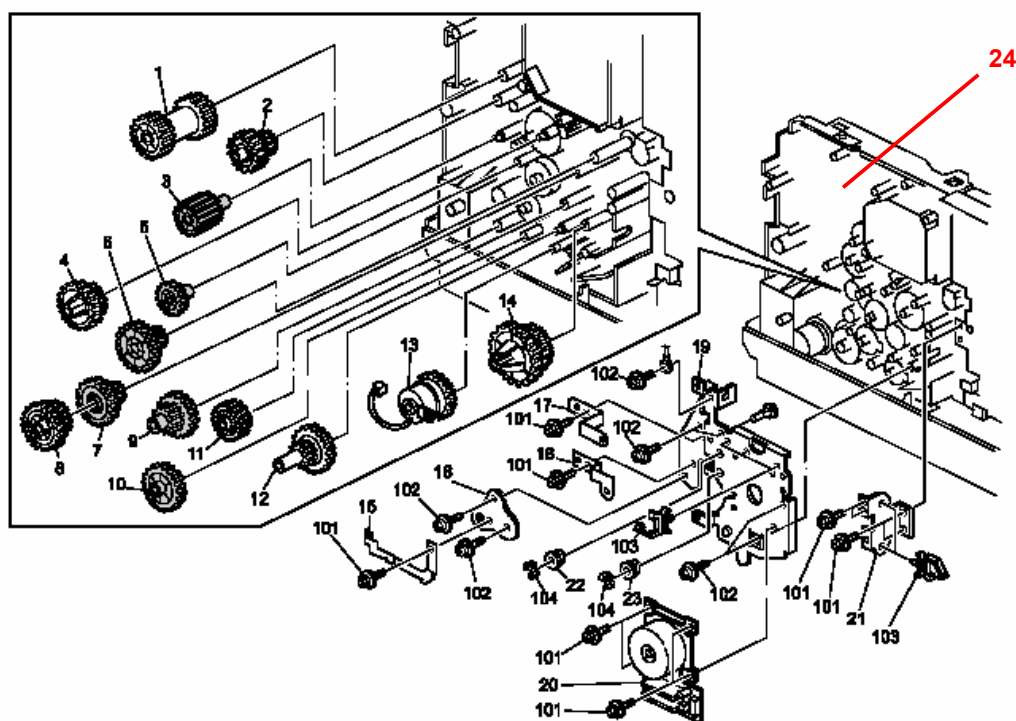

| | | | |
|--|--|--------------------------|---------------|
| Model:S-F1 and S-F1.6 | | Date: 2-Aug-07 | No.: MH555023 |
| Modified Article: SHAFT - PRESSURE | | Prepared by: T. Shintani | |
| From: 1st Tech. Support Sec. Service Support Dept. | | | |
| Reason for Modification: | <input checked="" type="checkbox"/> Parts catalog correction <input type="checkbox"/> Vendor change <input type="checkbox"/> Other <input type="checkbox"/> To facilitate assembly <input type="checkbox"/> To improve reliability <input type="checkbox"/> To meet standards (RoHs compliant) <input type="checkbox"/> Part standardization <input type="checkbox"/> Product Safety | | |

Mainframe (H555)

| Old part number | New part number | Description | Q'ty | Int | Page | Index | Note |
|-----------------|-----------------|------------------|------|-------|------|-------|------|
| AA140807 | AA140903 | Shaft - Pressure | 1 | O / O | 15 | 10 | |

Change: The materials used for these parts were changed.

Reason: To conform to the requirements of the RoHS Directive.

| | | | |
|--|--|--------------------------|---------------|
| Model:S-F1 and S-F1.6 | | Date: 4-Oct-07 | No.: MH555024 |
| Modified Article: GUIDE PLATE:REVERSE:ASS'Y | | Prepared by: T. Shintani | |
| From: 1st Tech. Support Sec. Service Support Dept. | | | |
| Reason for Modification: | <input checked="" type="checkbox"/> Parts catalog correction <input type="checkbox"/> Vendor change <input type="checkbox"/> Other <input type="checkbox"/> To facilitate assembly <input type="checkbox"/> To improve reliability <input type="checkbox"/> To meet standards (RoHs compliant) <input type="checkbox"/> Part standardization <input type="checkbox"/> Product Safety | | |

Mainframe (H555)

| New part number | Description | Q'ty | Int | Page | Index | Note |
|-----------------|---------------------------|------|-----|------|-------|------|
| B0444653 | GUIDE PLATE:REVERSE:ASS'Y | 1 | - | 10 | * | |

5.TRANSPORT SECTION (H555)

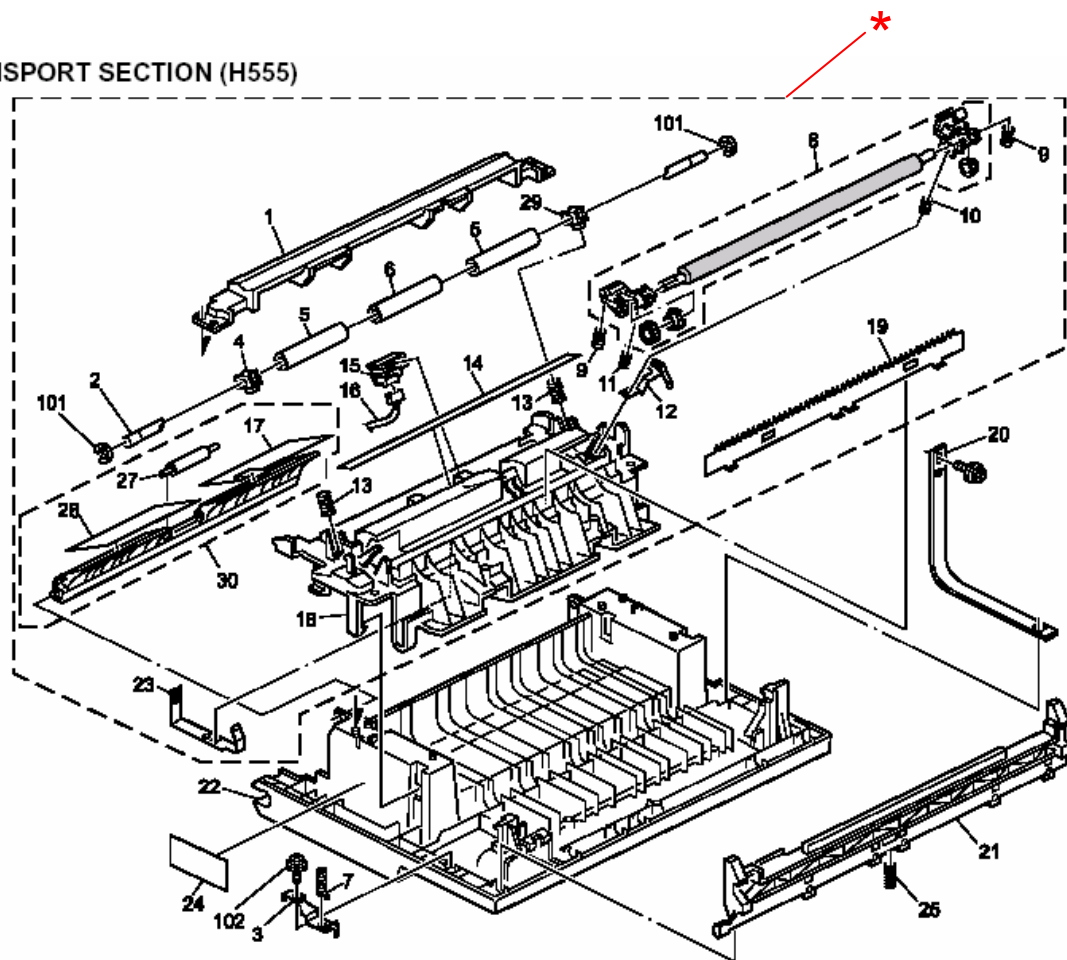

| | | | |
|--|--|--------------------------|---------------|
| Model:S-F1 and S-F1.6 | | Date: 13-Feb-08 | No.: MH555025 |
| Modified Article: Part Catalog Correction | | Prepared by: T. Shintani | |
| From: 1st Tech. Support Sec. Service Support Dept. | | | |
| Reason for Modification: | <input checked="" type="checkbox"/> Parts catalog correction <input type="checkbox"/> Vendor change <input type="checkbox"/> Other <input type="checkbox"/> To facilitate assembly <input type="checkbox"/> To improve reliability <input type="checkbox"/> To meet standards (RoHs compliant) <input type="checkbox"/> Part standardization <input type="checkbox"/> Product Safety | | |

Mainframe (H555)
1. Part numbers were changed from Model S-F1.5.

| Old part number | New part number | Description | Q'ty | Page | Index | Note |
|-----------------|-----------------|--------------------------------------|------|------|-------|------|
| B0442509 | B2622510 | Paper Tray Unit:Eu | 1 | 13 | 18 | |
| B0442701 | B2622511 | Paper Tray Unit:Na | 1 | 13 | 18 | |
| H5553695 | H5551404 | Operation Panel - Na | 1 | 5 | * | |
| H5553696 | H5551405 | Operation Panel - Eu | 1 | 5 | * | |
| H5556121 | H5556123 | Fcu Board - Na | 1 | 29 | 14 | |
| H5556122 | H5556124 | Fcu Board - Eu | 1 | 39 | 14 | |
| H5554240 | H5554232 | Model Name Plate - Ric | 1 | 3 | 7 | |
| H5554243 | H5554255 | Model Name Plate:H555-49:Lan:Aa | 1 | 3 | 7 | |
| H5554248 | H5554239 | Model Name Plate - Ges | 1 | 3 | 7 | |
| H5554180 | H5554189 | Front Door | 1 | 3 | 5 | |
| B0445208 | H5565208 | Harness-fusing-eu | 1 | 29 | 20 | |
| B0445209 | H5565209 | AC Harness - 120v | 1 | 29 | 20 | |
| H5554181 | H3104120 | Plate:Logotype:H555:Ric | 1 | 3 | 27 | |
| H5558400 | H5558200 | Operating Instructions - Na | 1 | 49 | 8 | |
| H5558409 | H5558209 | Operating Instructions - Basic Aa | 1 | 49 | 8 | |
| H5558700 | H5558301 | Operating Instructions - Advanced Aa | 1 | 49 | 8 | |
| B0442709 | B2622709 | Ground Plate:Tray Bottom Plate | 1 | 13 | 5 | |

2. New parts were added from Model S-F1.5.

| New part number | Description | Q'ty | Page | Index | Note |
|-----------------|---------------------------------|------|------|-------|------|
| B2706201 | Decal-environmental Symbol Mark | 1 | 49 | 9 | *1 |
| H5551406 | Operation Panel - Aa | 1 | 5 | * | |
| H5551407 | Operation Panel -chn | 1 | 5 | * | |
| H5556126 | Fcu Board - Chn | 1 | 29 | 14 | |
| H5554182 | Plate:Logotype:Sav | 1 | 3 | 27 | |
| H5554187 | Plate:Logotype:H555:Ges | 1 | 3 | 27 | |

*1:China model Only

| | | | |
|--|--|--------------------------|---------------|
| Model:S-F1 and S-F1.6 | | Date: 18-Feb-08 | No.: MH555026 |
| Modified Article: Part Catalog Correction | | Prepared by: T. Shintani | |
| From: 1st Tech. Support Sec. Service Support Dept. | | | |
| Reason for Modification: | <input checked="" type="checkbox"/> Parts catalog correction <input type="checkbox"/> Vendor change <input type="checkbox"/> Other <input type="checkbox"/> To facilitate assembly <input type="checkbox"/> To improve reliability <input type="checkbox"/> To meet standards (RoHs compliant) <input type="checkbox"/> Part standardization <input type="checkbox"/> Product Safety | | |

Please correct your Parts Catalogs as follows:

| Old part number | New part number | Description | Q'ty | Page | Index | Note |
|-----------------|-----------------|------------------|------|------|-------|------|
| 54886233 | 54886333 | NCU Board – NA | 1 | 29 | 19 | - |
| 54886243 | 54886343 | NCU Board – EU | 1 | 29 | 19 | - |
| 54886263 | 54886363 | NCU Board - ASIA | 1 | 29 | 19 | - |

| | | | |
|--|--|---|--|
| Model: Model S-F1.6 | | Date: 21-Feb-08 | No.: MH555027 |
| Modified Article: Part Catalog Correction | | Prepared by: T. Shintani | |
| From: 1st Tech. Support Sec. Service Support Dept. | | | |
| Reason for Modification: | <input checked="" type="checkbox"/> Parts catalog correction <input type="checkbox"/> To facilitate assembly <input type="checkbox"/> Part standardization | <input type="checkbox"/> Vendor change <input type="checkbox"/> To improve reliability <input type="checkbox"/> Other | <input type="checkbox"/> To meet standards () |

| Old part Number | New Part Number | Description | Q'ty | Page | Index | Note |
|-----------------|-----------------|--------------------|------|------|-------|------|
| H5554163 | H5554162 | By-pass Feed Cover | 1 | 3 | 19 | |

Change: The material of the cover was changed.

Reason: To minimize the change in color as time goes by (parts standardization with the EU model).

| | | | |
|--|--|---|--|
| Model: Model S-F1.6 | | Date: 23-May-08 | No.: MH555028 |
| Modified Article: Handset for China model | | Prepared by: T. Shintani | |
| From: 1st Tech. Support Sec. Service Support Dept. | | | |
| Reason for Modification: | <input checked="" type="checkbox"/> Parts catalog correction <input type="checkbox"/> To facilitate assembly <input type="checkbox"/> Part standardization | <input type="checkbox"/> Vendor change <input type="checkbox"/> To improve reliability <input type="checkbox"/> Other | <input type="checkbox"/> To meet standards () |

| New Part Number | Description | Q'ty | Page | Index | Note |
|-----------------|-------------------------------------|------|------|-------|------|
| H4534156 | Hand set – Holder (For China model) | 1 | 3 | 28 | - |
| H4535127 | Hand set (For China model) | 1 | 3 | 29 | - |

1.EXTERIOR (H555)

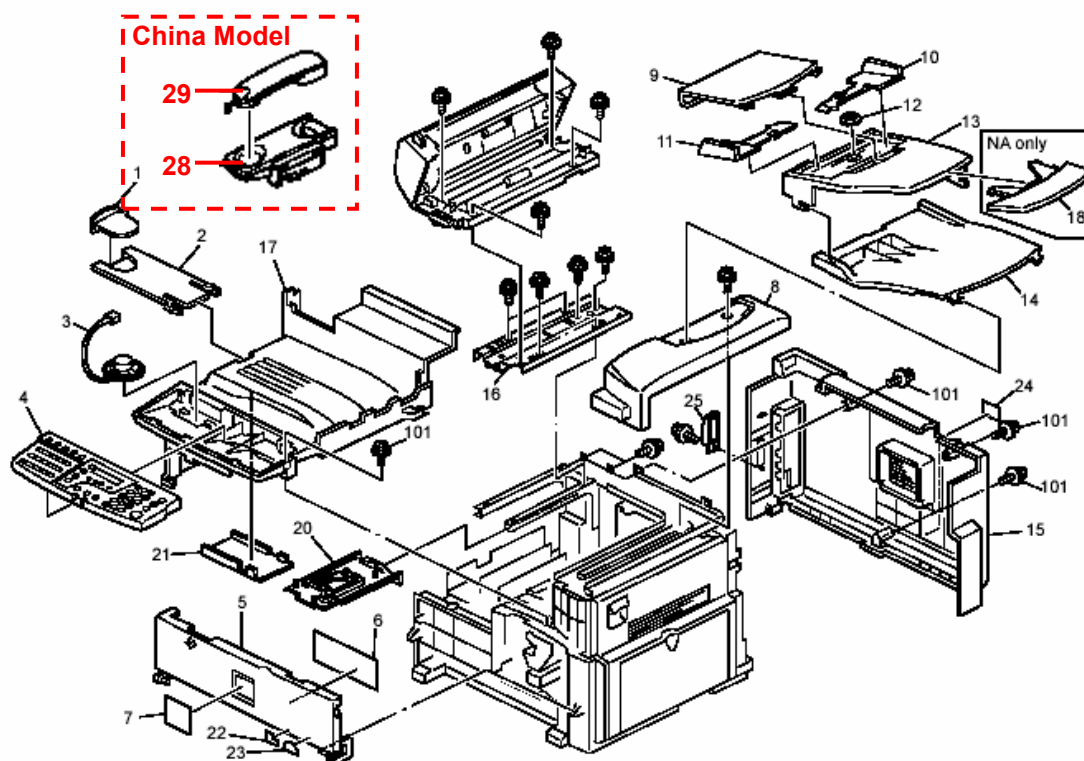

Change/Reason: These parts were missing from the Parts Catalog.

| | | | |
|--|--|---|--|
| Model: Model S-F1.6 | | Date: 6-Nov-08 | No.: MH555029 |
| Modified Article: Part Catalog correction | | Prepared by: T. Shintani | |
| From: 1st Tech. Support Sec. Service Support Dept. | | | |
| Reason for Modification: | <input checked="" type="checkbox"/> Parts catalog correction <input type="checkbox"/> To facilitate assembly <input type="checkbox"/> Part standardization | <input type="checkbox"/> Vendor change <input type="checkbox"/> To improve reliability <input type="checkbox"/> Other | <input type="checkbox"/> To meet standards () |

| Old Part Number | New Part Number | Description | Q'ty | Page | Index | Note |
|-----------------|-----------------|-----------------------|------|------|-------|------|
| 14030950 | 14031500 | PHOTOCOUPLER:TLP627-2 | 1 | 45 | 113 | - |



Part Change Information List



Date: March 18, 2009

| Model | Code | PCIL Number | PCIL Correction | Old part number | New part number | Description | Old Q'ty | New Q'ty | Int | 3DPC | Page | Index | Set | Set Int | RTB | Note | Ref Number |
|-----------|------|----------------|--------------------|--------------------|--------------------|----------------------------|----------|----------|-----|------|------|-------|-----|---------|-----|------|------------|
| Stella-F1 | H555 | 200903 | | AX060284 | AX060342 | POLYGON SCANNERMOTOR-DC24V | 1 | 1 | X/O | | 21 | 5 | | | | | V0803241 |
| Stella-F1 | H555 | 200903 | | AX060339 | AX060342 | POLYGON SCANNERMOTOR-DC24V | 1 | 1 | X/O | | 21 | 5 | | | | | V0803241 |



Part Change Information List

Date: April 30, 2009

| Model | Code | PCIL Number | PCIL Correction | Old part number | New part number | Description | Old Q'ty | New Q'ty | Int | 3DPC | Page | Index | Set | Set Int | RTB | Note | Ref Number |
|-----------|------|----------------|--------------------|--------------------|--------------------|----------------------------------|----------|----------|-----|------|---|-------|-----|---------|-----|------|------------|
| Stella-F1 | H555 | 200904 | | B0441068 | D0671068 | SHEET:BLOCK LIGHT:DISCHARGE LAMP | 1 | 1 | O/O | |  | 6 | | | | | V0804747 |
| Stella-F1 | H555 | 200904 | | B0444165 | D0674165 | DISCHARGE BRUSH:EXIT | 1 | 1 | O/O | |  | 1 | | | | | V0804747 |
| Stella-F1 | H555 | 200904 | | B0442710 | D0672710 | FRICTION PAD:ADHESION | 1 | 1 | O/O | | 13 | 13 | | | | | V0900680 |



Part Change Information List

Date: June 30, 2009

| Model | Code | PCIL Nr. | PCIL Correction | Old part number | New part number | Description | Old Q'ty | New Q'ty | Int | 3DPC | Page | Index | Set | Set Int | RTB | Note | Ref. Nr. | ECN Nr. |
|-------|------|----------|--------------------|--------------------|--------------------|----------------------|----------|----------|-----|------|------|-------|-----|---------|-----|------|----------|---------|
| S-F1 | H555 | 200906 | | B2622510 | D0672510 | PAPER TRAY UNIT:EU | 1 | 1 | O/O | | 13 | * | | | | | V0901249 | |
| S-F1 | H555 | 200906 | | B0445235 | D0675235 | GROUND WIRE:CASSETTE | 3 | 3 | O/O | | 31 | 3 | | | | | V0901372 | 9041099 |



Part Change Information List

Date: July 31, 2009

| Model | Code | PCIL Nr. | PCIL Correction | Old part number | New part number | Description | Old Q'ty | New Q'ty | Int | 3DPC | Page | Index | Set | Set Int | RTB | Note | Ref. Nr. | ECN Nr. |
|-------|------|----------|--------------------|--------------------|--------------------|--------------------------|----------|----------|-----|------|------|-------|-----|---------|-----|-----------|----------|---------|
| S-F1 | H555 | 200907 | | | H5553613 | SHEET:LCD:H555-41 | 0 | 1 | | | 5 | 1 | | | Y | for China | V0900933 | |
| S-F1 | H555 | 200907 | | | H5553614 | SHEET:FUNCTION:H555-41 | 0 | 1 | | | 5 | 2 | | | Y | for China | V0900933 | |
| S-F1 | H555 | 200907 | | H5555000 | AZ230225 | POWER SUPPLY UNIT - 230V | 1 | 1 | O/O | | 29 | 17 | | | | | V0901706 | |



Part Change Information List

Date: August 31, 2009

| Model | Code | PCIL Nr. | PCIL Correction | Old part number | New part number | Description | Old Q'ty | New Q'ty | Int | 3DPC | Page | Index | Set | Set Int | RTB | Note | Ref. Nr. | ECN Nr. |
|-------|------|----------|--------------------|--------------------|--------------------|--------------------------|----------|----------|-----|------|------|-------|-----|---------|-----|------|----------|---------|
| S-F1 | H555 | 200908 | | 14030598 | 14030620 | PHOTO COUPLER - PS2501-2 | 1 | 0 | O/O | | 43 | 109 | | | | | V0901886 | 9070389 |



Part Change Information List

Date: September 30, 2009

| Model | Code | PCIL Nr. | PCIL Correction | Old part number | New part number | Description | Old Q'ty | New Q'ty | Int | 3DPC | Page | Index | Set | Set Int | RTB | Note | Ref. Nr. | ECN Nr. |
|-------|------|----------|-----------------|-----------------|-----------------|-------------------------------------|----------|----------|-----|------|------|-------|-----|---------|-----|------|----------|---------|
| S-F1 | H555 | 200909 | | B0445214 | D0675214 | HARNESS:DENSITY SENSOR | 1 | 1 | O/O | | 11 | 16 | | | | | V0901372 | 9041099 |
| S-F1 | H555 | 200909 | | B0445223 | D0675223 | HARNESS:PAPER FEED TABLE:CONNECTING | 1 | 1 | O/O | | 29 | 15 | | | | | V0901372 | 9041099 |



Part Change Information List

Date: January 29, 2010

| Model | Code | PCIL Nr. | PCIL Correction | Old part number | New part number | Description | Old Q'ty | New Q'ty | Int | 3DPC | Page | Index | Set | Set Int | RTB | Note | Ref. Nr. | ECN Nr. |
|-------|------|----------|-----------------|-----------------|-----------------|-------------------|----------|----------|-----|------|------|-------|-----|---------|-----|------|----------|---------|
| S-F1 | H555 | 201001 | | H5554157 | H5554156 | FUSING COVER - EU | 1 | 1 | O/O | | 3 | 8 | | | | | V0902432 | |



Part Change Information List

Date: February 26, 2010

| Model | Code | PCIL Nr. | PCIL Correction | Old part number | New part number | Description | Old Q'ty | New Q'ty | Int | 3DPC | Page | Index | Set | Set Int | RTB | Note | Ref. Nr. | ECN Nr. |
|-------|------|----------|--------------------|--------------------|--------------------|--------------------|----------|----------|-----|------|------|-------|-----|---------|-----|------|----------|---------|
| S-F1 | H555 | 201002 | | B2622511 | D0672511 | PAPER TRAY UNIT:NA | 1 | 1 | O/O | | 13 | * | | | | | V0902210 | |



Part Change Information List

Date: May 31, 2010

| Model | Code | PCIL Nr. | PCIL Correction | Old part number | New part number | Description | Old Q'ty | New Q'ty | Int | 3DPC | Page | Index | Set | Set Int | RTB | Note | Ref. Nr. | ECN Nr. |
|-------|------|----------|--------------------|--------------------|--------------------|----------------------|----------|----------|-----|------|------|-------|-----|---------|-----|------|----------|---------|
| S-F1 | H555 | 201005 | | B0444165 | D0674165 | DISCHARGE BRUSH:EXIT | 1 | 1 | O/O | | 25 | 1 | | | | | V1000294 | |



Part Change Information List

Date: Jul 30, 2010

| Model | Code | PCIL Nr. | PCIL Correction | Old part number | New part number | Description | Old Q'ty | New Q'ty | Int | 3DPC | Page | Index | Set | Set Int | RTB | Note | Ref. Nr. | ECN Nr. |
|-------|------|----------|-----------------|-----------------|-----------------|-------------------|----------|----------|-----|------|------|-------|-----|---------|----------|------|----------|---------|
| S-F1 | H555 | 201007 | | | 11071186 | FUSE:FIH 6.3A(EM) | 0 | 1 | | | 29 | 105 | | | RH555018 | | V1000676 | |

RICOH**Part Change Information List**

Date: January 31, 2011

| Model | Code | PCIL Nr. | PCIL Correction | Old part number | New part number | Description | Old Q'ty | New Q'ty | Int | 3DPC | Page | Index | Set | Set Int | RTB | Note | Ref. Nr. | ECN Nr. |
|-------|------|----------|--------------------|--------------------|--------------------|-------------|----------|----------|-----|------|------|-------|-----|---------|-----|------|----------|---------|
| S-F1 | H555 | 201101 | | H5211350 | H3101360 | PAD:PICKUP | 1 | 1 | O/O | | 17 | 11 | | | | | V1002156 | |



Part Change Information List

Date: July 30, 2013

| Model | Code | PCIL Number | PCIL Correction | Old part number | New part number | Description | Old Q'ty | New Q'ty | Int | 3DPC | Page | Index | Set | Set Int | RTB | Note | Ref Number | ECN Number |
|-------|------|----------------|--------------------|--------------------|--------------------|-------------------------|-------------|-------------|-----|------|------|-------|-----|------------|-----|------|------------|---------------|
| S-F1 | H555 | 201307 | | H5554163 | H5554162 | BY-PASS FEED COVER - EU | 1 | 1 | O/O | | 7 | 19 | | | | | V1301344 | |



Part Change Information List

Date: December 27, 2013

| Model | Code | PCIL Number | PCIL Correction | Old part number | New part number | Description | Old Q'ty | New Q'ty | Int | 3DPC | Page | Index | Set | Set Int | RTB | Note | Ref Number | ECN Number |
|-------|------|-------------|-----------------|-----------------|-----------------|----------------------|----------|----------|-----|------|------|-------|-----|---------|-----|------|------------|------------|
| S-F1 | H555 | 201312 | | B2623802 | D1273802 | TRANSFER ROLLER:ASSY | 1 | 1 | O/O | | | | | | | | V1301610 | 13040074 |



Part Change Information List

Date: January 31, 2014

| Model | Code | PCIL Number | PCIL Correction | Old part number | New part number | Description | Old Q'ty | New Q'ty | Int | 3DPC | Page | Index | Set | Set Int | RTB | Note | Ref Number | ECN Number |
|-------|------|-------------|-----------------|-----------------|-----------------|----------------------|----------|----------|-----|------|------|-------|-----|---------|-----|------|------------|------------|
| S-F1 | H555 | 201401 | | B0444017 | B0444016 | FUSING UNIT:NA:ASS'Y | 1 | 1 | X/O | | 35 | * | | | | | V1303404 | 13081369 |



Part Change Information List

Date: April 30, 2014

| Model | Code | PCIL Number | PCIL Correction | Old part number | New part number | Description | Old Q'ty | New Q'ty | Int | 3DPC | Page | Index | Set | Set Int | RTB | Note | Ref Number | ECN Number |
|----------------|------|----------------|--------------------|--------------------|--------------------|-----------------|-------------|-------------|-----|------|------|-------|-----|------------|-----|------|------------|---------------|
| S-F1/F1.5/F1.6 | H555 | 201404 | | AX200234 | AX200312 | MAGNETIC CLUTCH | 2 | 2 | X/O | | 9 | 6 | | | | | | |
| S-F1/F1.5/F1.6 | H555 | 201404 | | AX200234 | AX200312 | MAGNETIC CLUTCH | 1 | 1 | X/O | | 27 | 13 | | | | | | |



Part Change Information List

Date: September 30, 2014

| Model | Code | PCIL Number | PCIL Correction | Old part number | New part number | Description | Old Q'ty | New Q'ty | Int | 3DPC | Page | Index | Set | Set Int | RTB | Note | Ref Number | ECN Number |
|-------|------|----------------|--------------------|--------------------|--------------------|-------------|-------------|-------------|-----|------|------|-------|-----|------------|-----|------|------------|---------------|
| S-F1 | H555 | 201409 | | G0291982 | G0291980 | DECAL - LD | 1 | 1 | X/O | | 21 | 11 | | | | | V1402526 | 14060659 |
| S-F1 | H555 | 201409 | | G0291982 | G0291980 | DECAL - LD | 1 | 1 | X/O | | 21 | 13 | | | | | V1402526 | 14060659 |
| S-F1 | H555 | 201409 | | G0291982 | G0291980 | DECAL - LD | 1 | 1 | X/O | | 49 | 7 | | | | | V1402526 | 14060659 |



Part Change Information List

Date: June 4, 2015

| Model | Code | PCIL Number | PCIL Correction | Old part number | New part number | Description | Old Q'ty | New Q'ty | Int | 3DPC | Page | Index | Set | Set Int | RTB | Note | Ref Number | ECN Number |
|-------|------|----------------|--------------------|--------------------|--------------------|------------------|----------|----------|-----|------|------|-------|-----|---------|-----|------|------------|---------------|
| S-F1 | H555 | 201505 | | G8005385 | B0445300 | PAPER END SENSOR | 1 | 1 | O/O | N | 30 | 8 | | | | | T0202779 | 02100005 |